

PLAN VIEW
(SHOWN WITHOUT TOP FOR CLARITY)

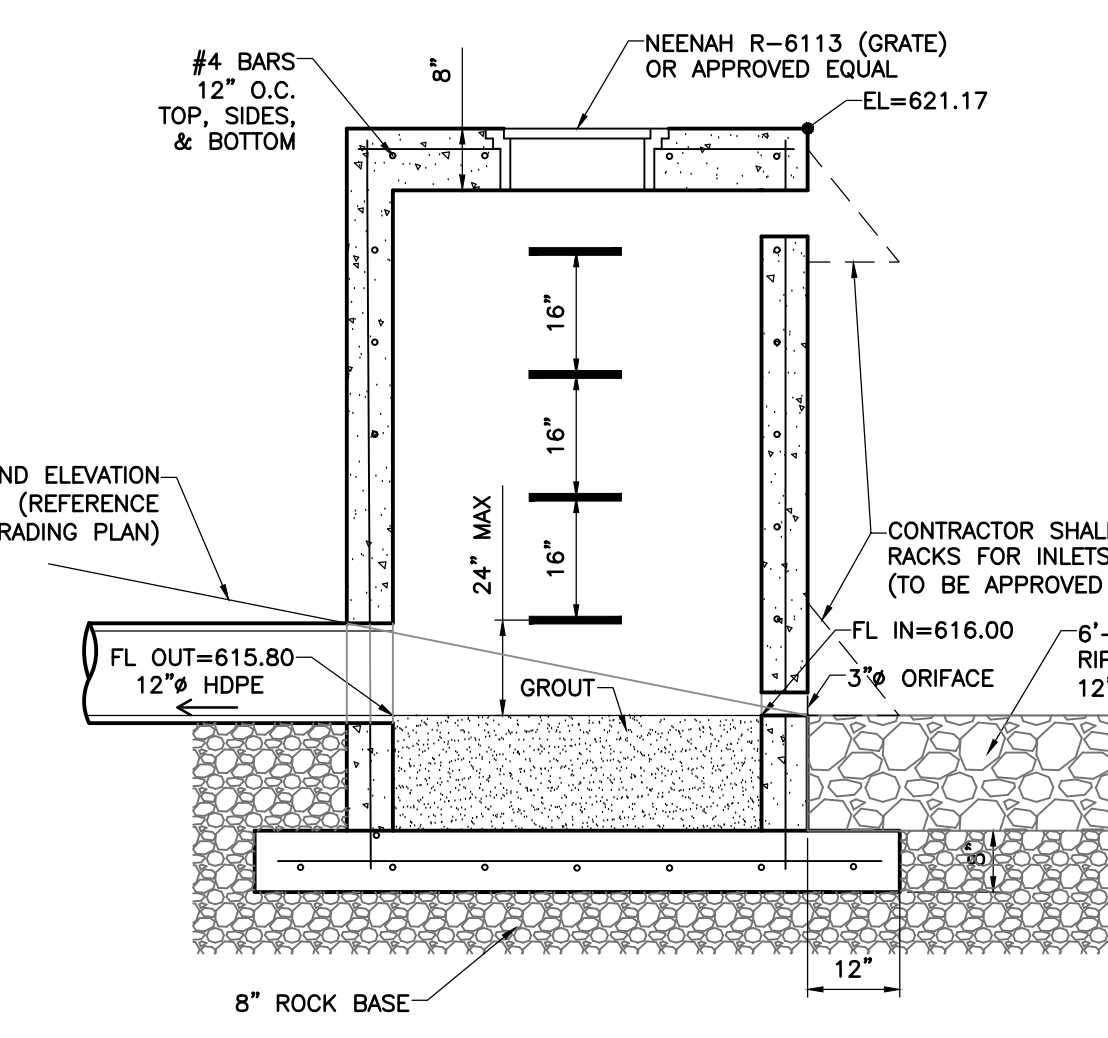

SECTION "A-A"

STS-15 CONTROL STRUCTURE No.3
NO SCALE

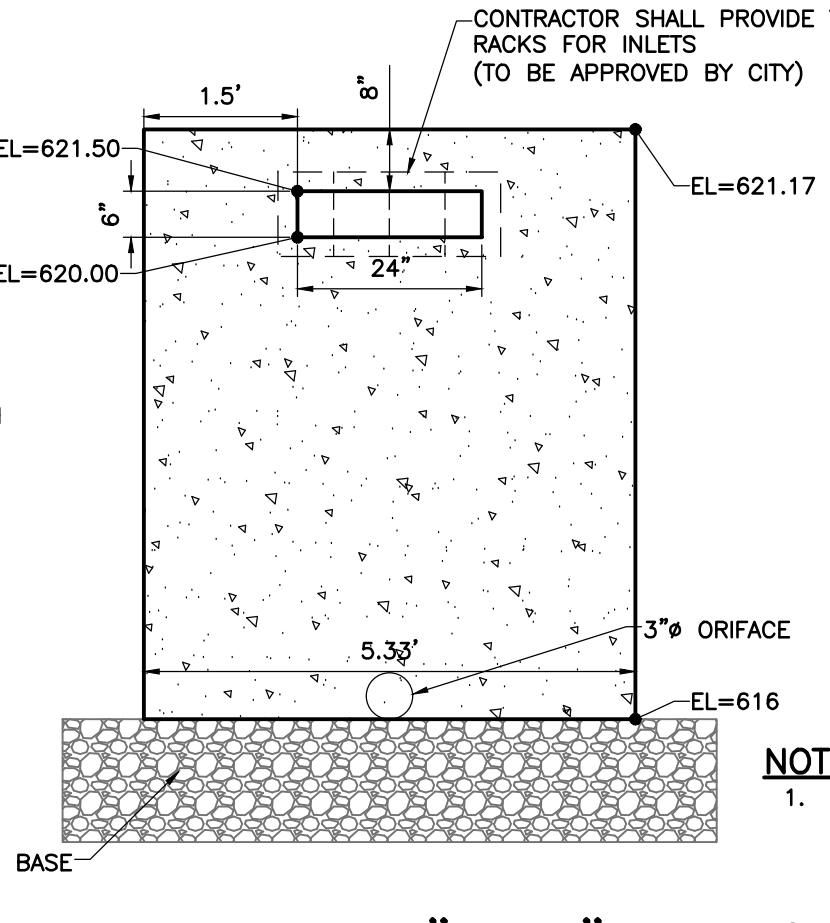

SECTION "B-B"

NOTE:
1. A 6" TALL X 24" WIDE ORIFACE SHALL BE LOCATED ON 1 SIDE OF CONTROL STRUCTURE.
2. CONTROL STRUCTURE SHALL HAVE A MINIMUM WALL THICKNESS OF 8" WITH STEEL REINFORCEMENT OF #14 BARS 12" O.C. TOP, SIDES, AND BOTTOM.

CP-1 STANDARD DUTY CONCRETE PAVEMENT (PARKING AREAS)
NO SCALE

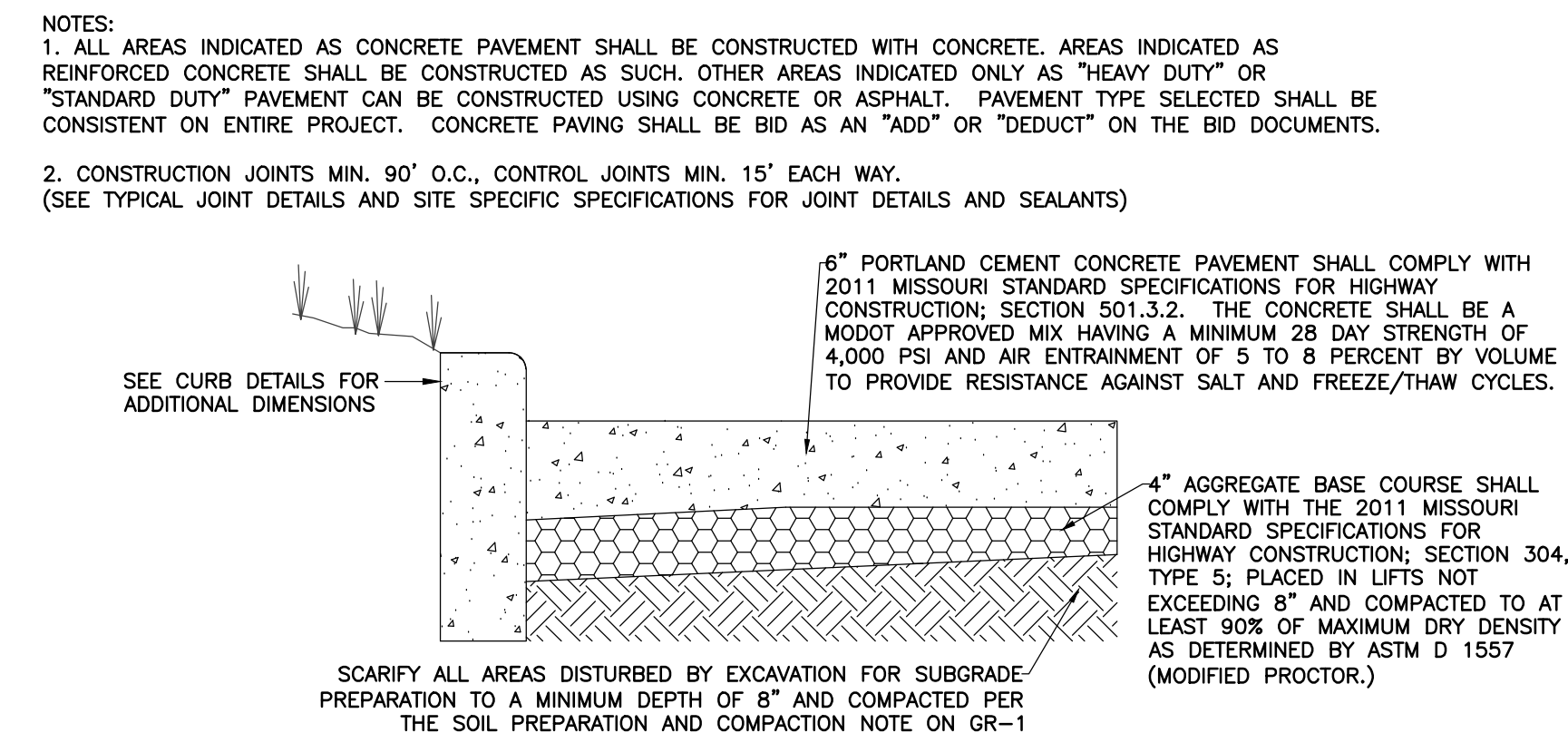

CP-2 HEAVY DUTY CONCRETE PAVEMENT
NO SCALE

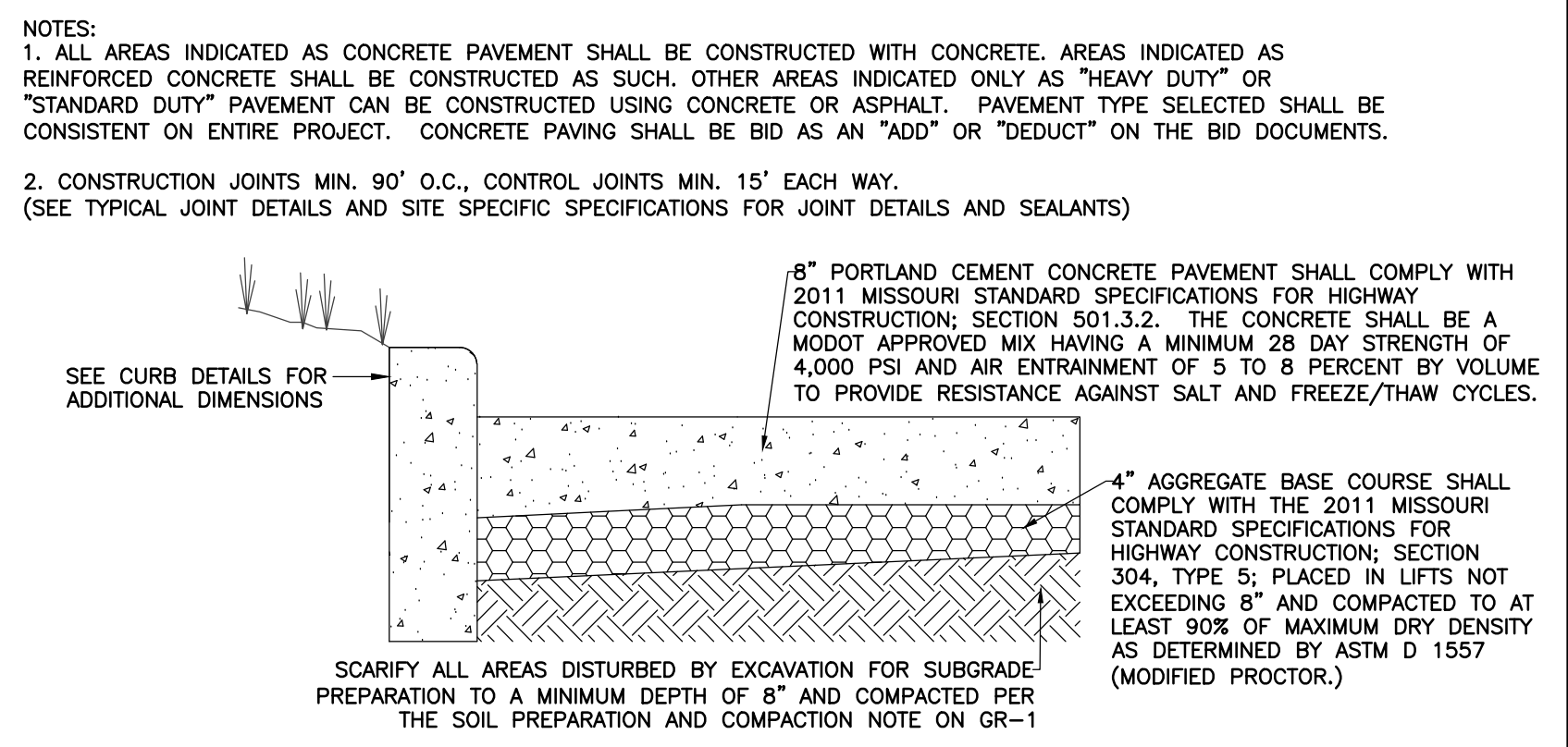

CNC-1 CURB DETAIL
NO SCALE

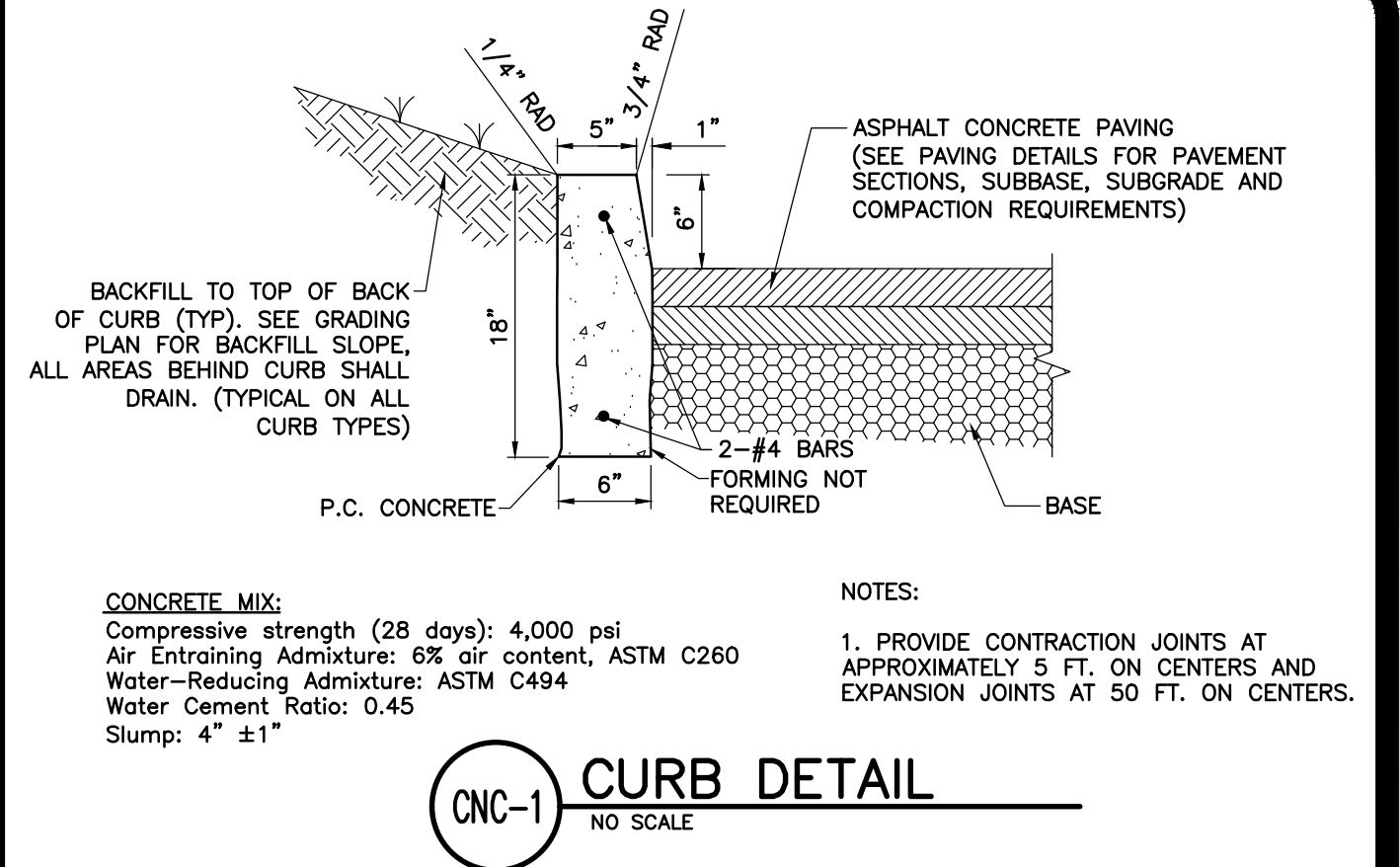

AP-1 STANDARD DUTY ASPHALT PAVEMENT
NO SCALE

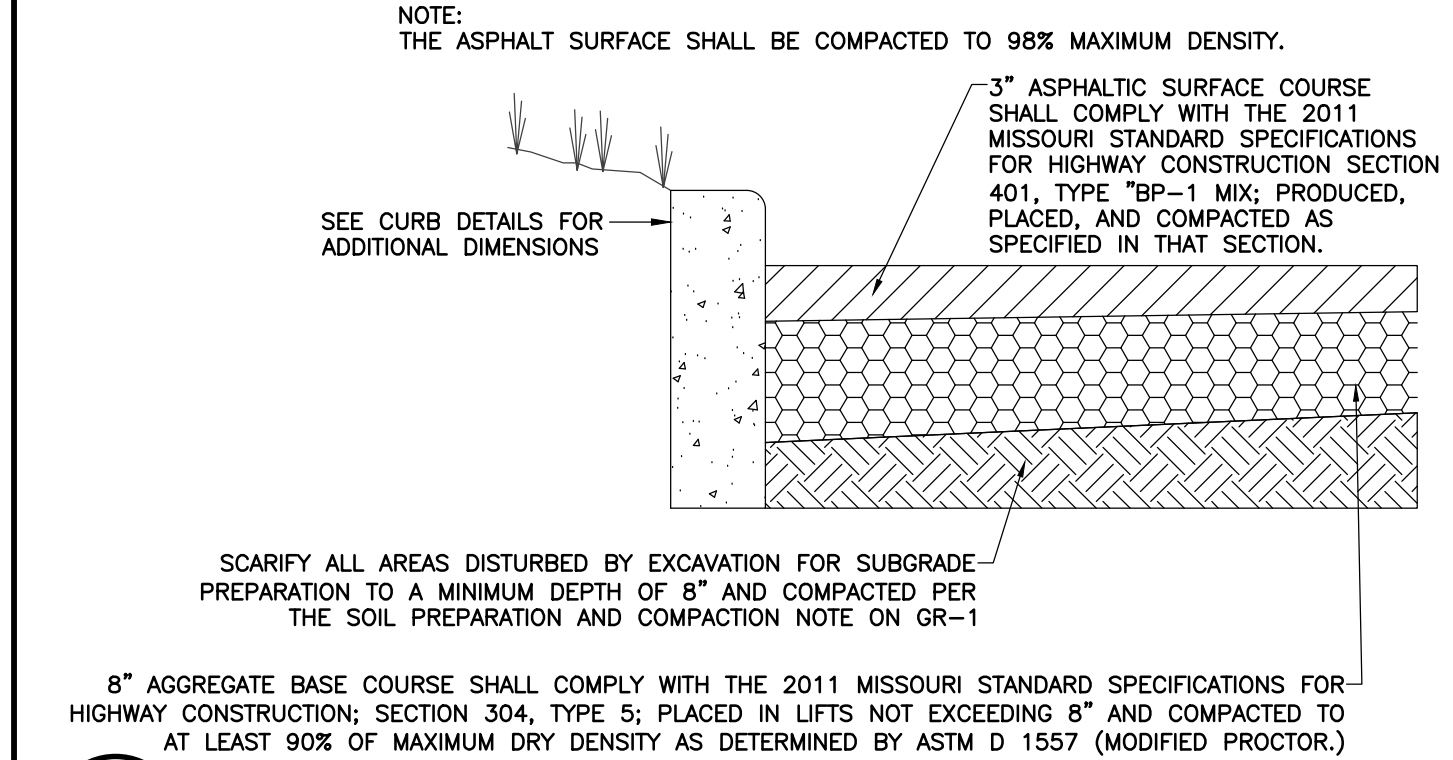

AP-2 HEAVY DUTY ASPHALT PAVEMENT
NO SCALE

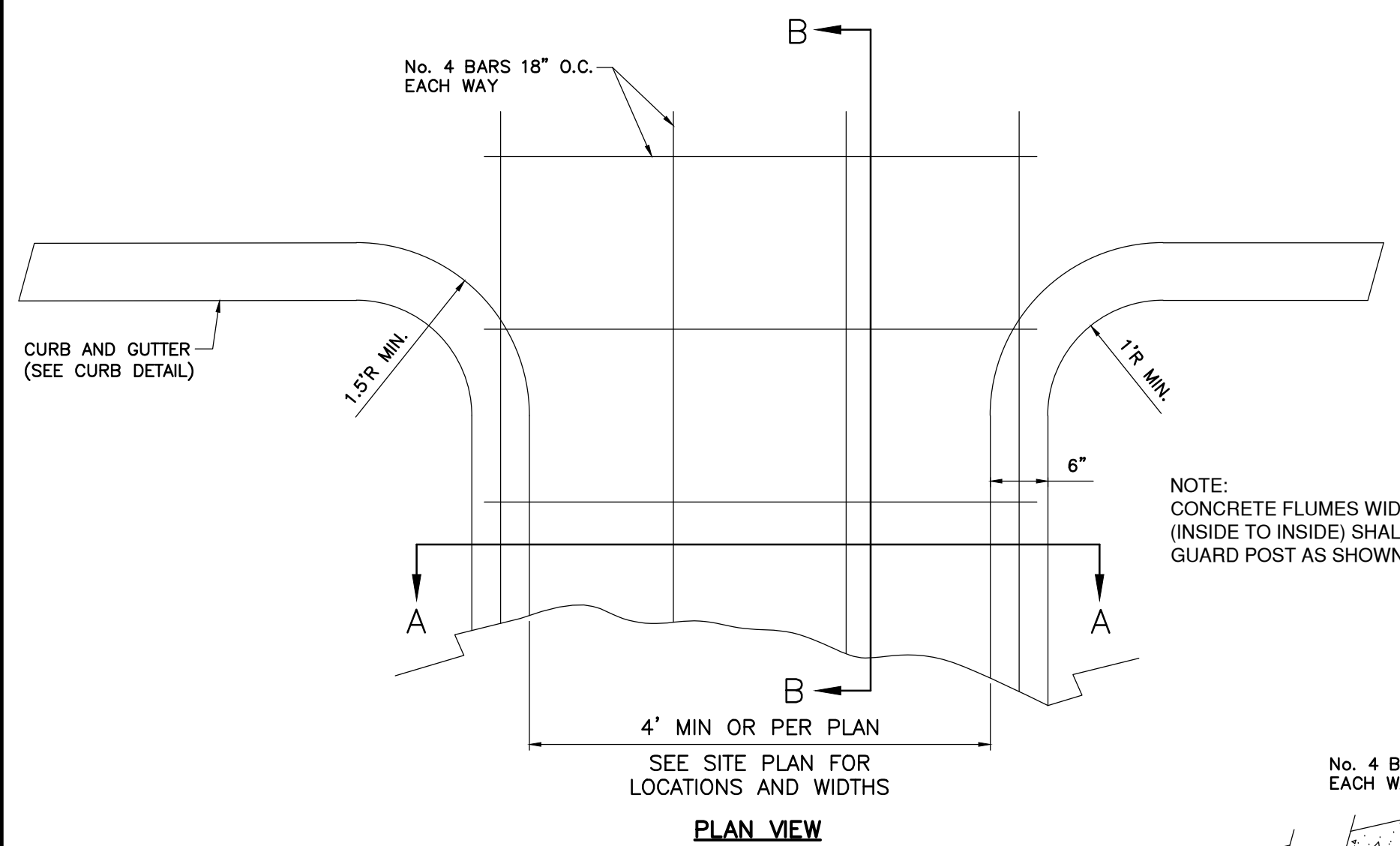
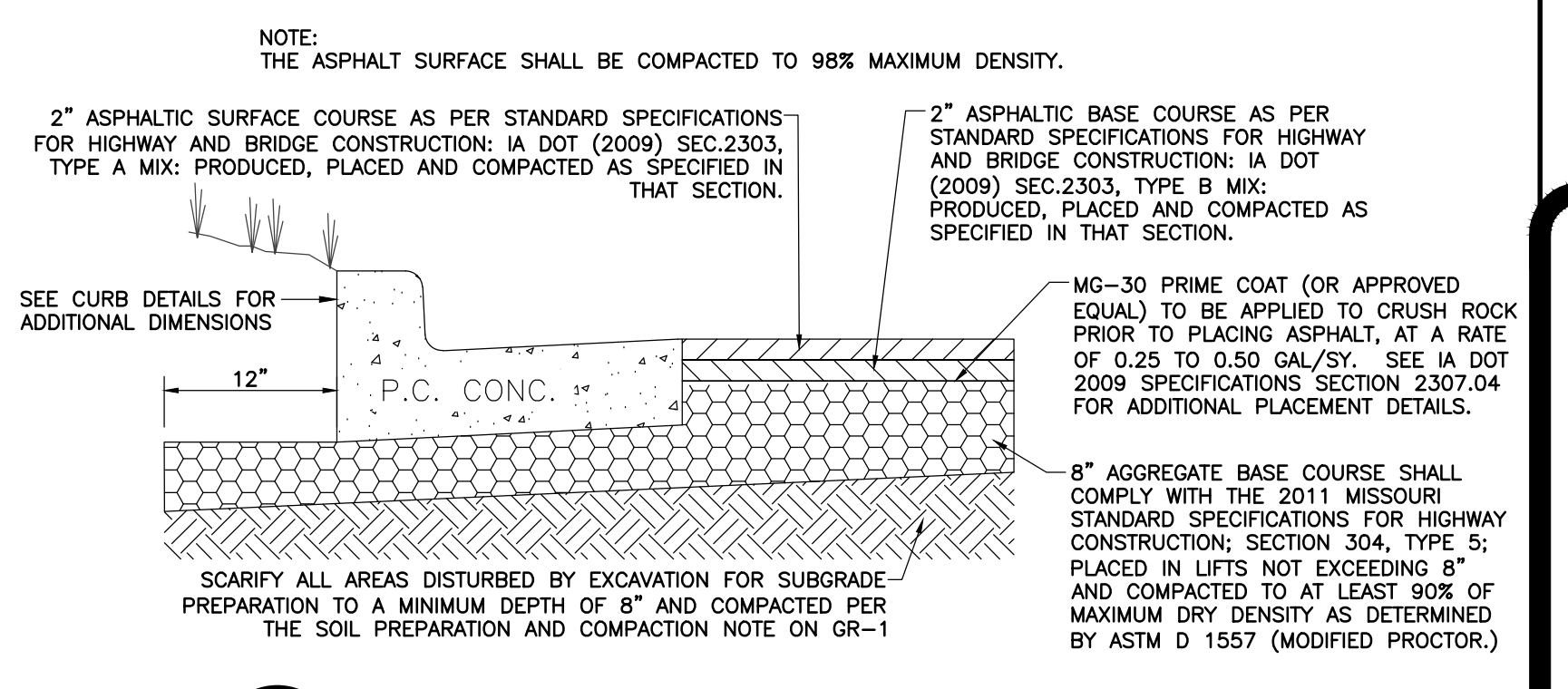

CONCRETE FLUME DETAIL
NO SCALE

CFE-1 CONCRETE FLUME DETAIL
NO SCALE

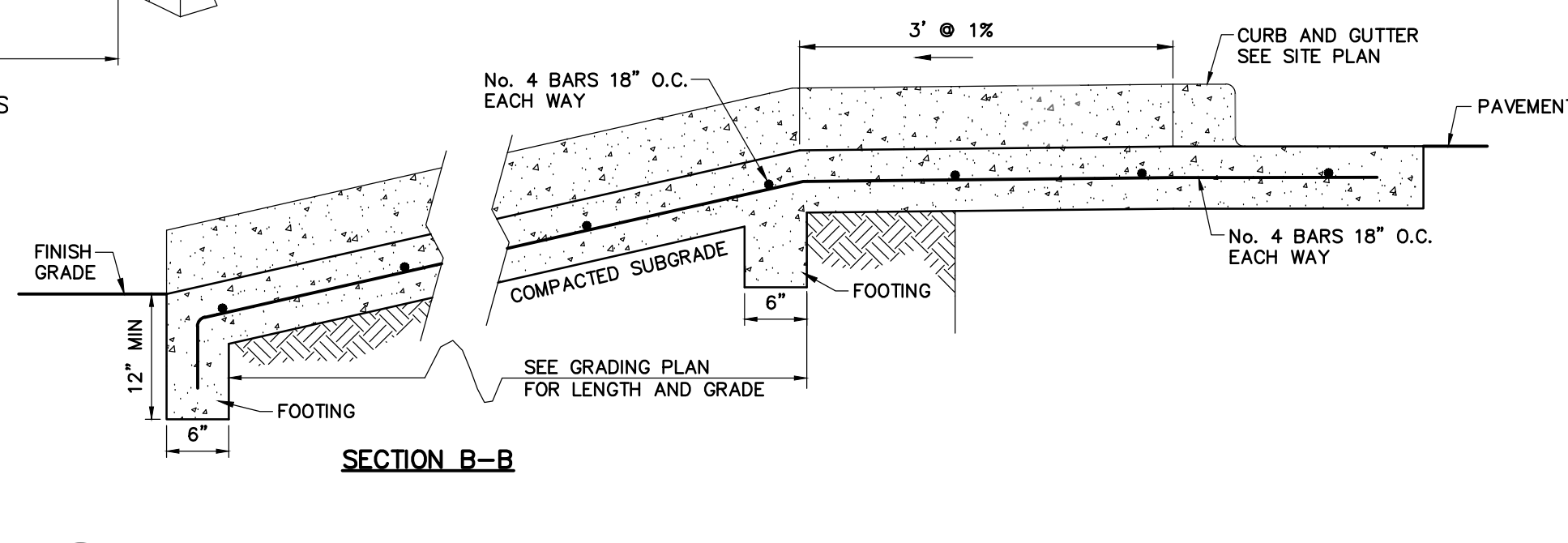

Three working days prior to the start of any excavation on this site the Contractor shall contact 1-800-344-7483 for utility location information.
The contractor shall verify and implement all the required Federal Occupational Safety and Health Administration (OSHA) and/or OSHA approved state-plan regulations established for the type of construction required by these plans.

TRL-1 MULTI-USE TRAIL DETAIL
NO SCALE

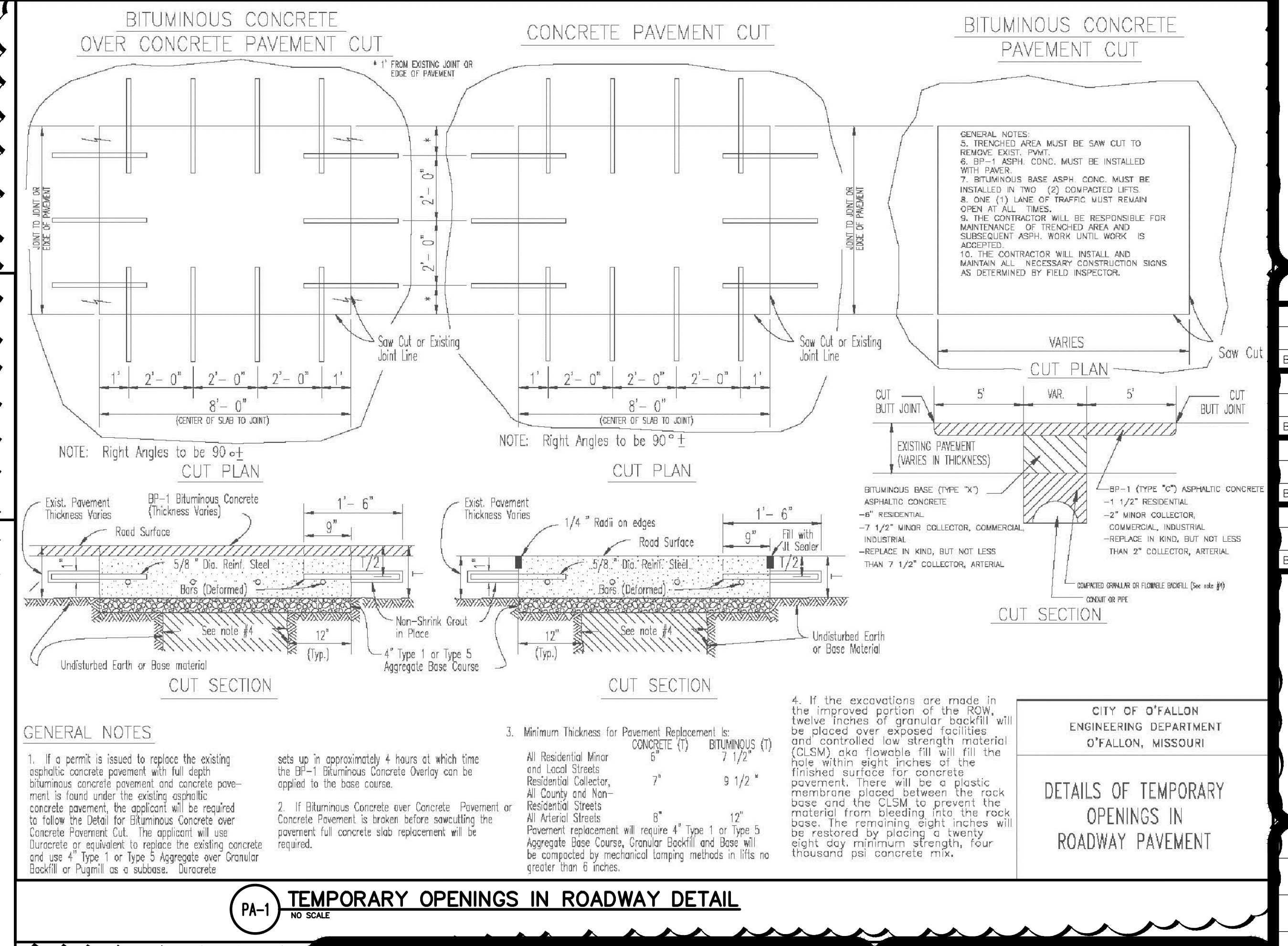
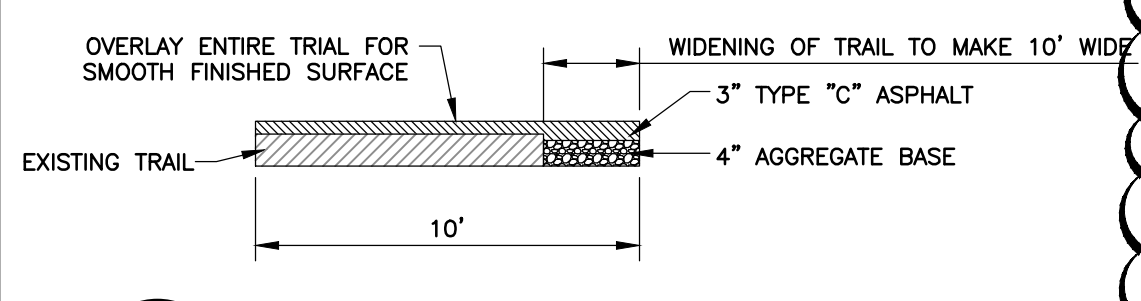

PA-1 TEMPORARY OPENINGS IN ROADWAY DETAIL
NO SCALE

PERMIT SET
Rick G. Rohlfing
12/15/20
Date

Rick G. Rohlfing, P.E. #E-29409
State of Missouri
Registered Professional Engineer
for BFA, Inc. Professional Engineer Corporation #000472

bfaeng.com TELEPHONE: (636) 239-4751

BFA
Engineering-Surveying

103 ELM STREET WASHINGTON, MISSOURI 63090

BRYAN CROSSING LOT 2, LLC
950 Bryan Road
O'Fallon, St. Charles County,
Missouri 63366

REVISIONS

NO.	DATE	DESCRIPTION
1	11-30-20	UPDATE PER CITY COMMENTS
2	12-15-20	ADDED TEMPORARY OPENING IN ROADWAY DETAIL
3		
4		

DETAILS OF TEMPORARY OPENINGS IN ROADWAY PAVEMENT

NO.	DATE	DESCRIPTION
1	12/15/2020	SCALE AS NOTED
2		JOB No. 5918
3		SHEET NAME DTL-SHEET 2

P:\Vault\5918 Starbucks O'Fallon MO\5918 Plan Sheets\5918 Detail Sheets.dwg
12/15/2020 6:45 AM