

S.W.P.P.P. PLAN - PHASE II

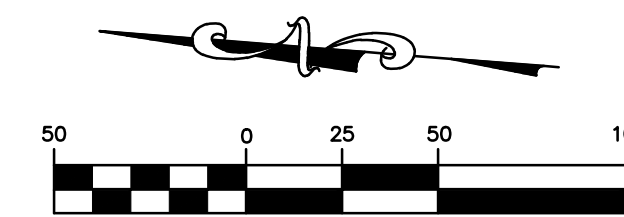

JANUARY, 2021

EXISTING		PROPOSED	
(---) 500	INDEX CONTOUR	(---) 500	INDEX CONTOUR
(---) 498	INTERMEDIATE CONTOUR	(---) 498	INTERMEDIATE CONTOUR
(---)	PROPERTY LINE	(---)	PROPERTY LINE
(---)	RIGHT-OF-WAY	(---)	RIGHT-OF-WAY
(---)	LOT LINE	(---)	LOT LINE
(---)	EASEMENT	(---)	EASEMENT
(---)	UTILITY POLE / GUY WIRE	(---)	UTILITY POLE / GUY WIRE
(---)	UNDERGROUND ELECTRIC	(---)	UNDERGROUND ELECTRIC
(---)	UNDERGROUND TELEPHONE	(---)	UNDERGROUND TELEPHONE
(---)	UNDERGROUND FIBER OPTIC	(---)	UNDERGROUND FIBER OPTIC
(---)	SANITARY SEWER	(---)	SANITARY SEWER
(---)	SANITARY MANHOLE	(---)	SANITARY MANHOLE
(---)	SANITARY FORCE MAIN	(---)	SANITARY FORCE MAIN
(---)	STORM SEWER	(---)	STORM SEWER
(---)	INLET	(---)	INLET
(---)	GRATED INLET	(---)	GRATED INLET
(---)	FLARED END SECTIONS	(---)	FLARED END SECTIONS
(---)	GAS LINE	(---)	GAS LINE
(---)	WATER LINE (SIZE)	(---)	WATER LINE (SIZE)
(---)	FIRE HYDRANTS	(---)	FIRE HYDRANTS
(---)	WATER VALVE	(---)	WATER VALVE
(---)	GUARDRAIL	(---)	GUARDRAIL
(---)	FENCE	(---)	FENCE
(---)	LIGHT	(---)	LIGHT
(---)	CONCRETE PAVEMENT	(---)	CONCRETE PAVEMENT
(---)	ASPHALT PAVEMENT	(---)	ASPHALT PAVEMENT
(---)	GRASS	(---)	GRASS
(---)	RIP-RAP	(---)	RIP-RAP

EROSION DETAILS	
(---) SF	TEMPORARY SILT FENCE (SEE DETAIL SHEET, C7.0)
(---) IP1	CURB INLET PROTECTION (SEE DETAIL, SHEET C7.0)
(---) IP2	AREA INLET PROTECTION (SEE DETAIL, SHEET C7.0)
(---) IP3	GRATED INLET PROTECTION (SEE DETAIL, SHEET C7.0)
(---)	STRAW WATTLE DITCH CHECK (SEE DETAIL SHEET, C7.01)
(---)	ROCK DITCH CHECK (SEE DETAIL SHEET, 7.01)

ADDITIONAL EROSION CONTROL MAY BE NECESSARY BASED ON FIELD CONDITIONS.

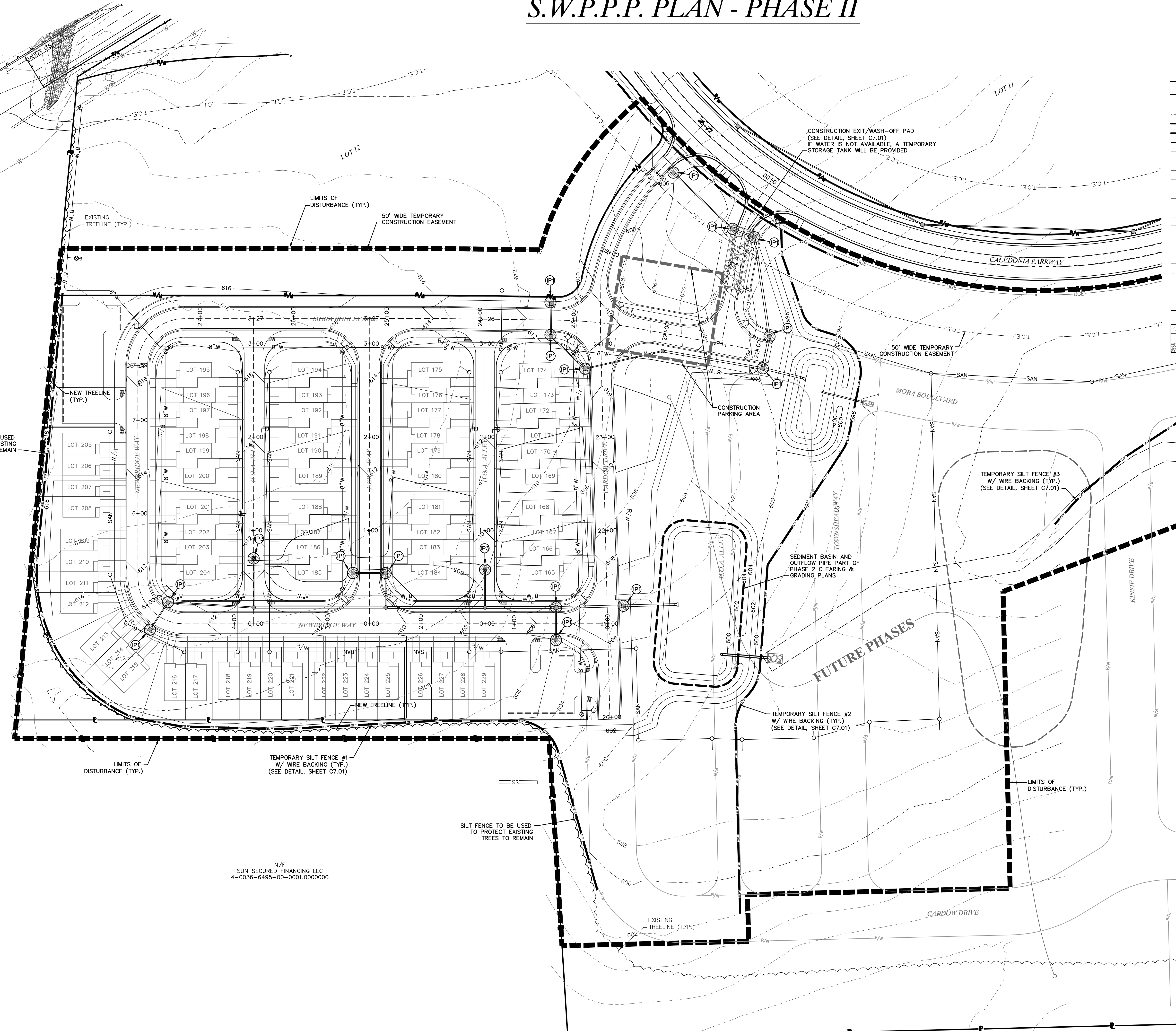

636-594-0540 (tel.)
636-594-0512 (fax)
mailto:ochran@ochran.com

UCHRAN

Civil Engineering
Land Surveying
Architecture
Site Development
General Consulting
Master Planning

530A E. Independence Dr.
Union, Missouri 63084

Missouri State Certificate of Authority Numbers:
Survey: 000380
Engineering: 001555
Architecture: 2002104240

Three working days prior to the start of any excavation call 1-800-463-RTTE for utility location information.

All OSHA rules & regulations and applicable state and local codes and construction required by these plans shall be strictly followed (ie. trenching, blasting, etc.)

STATE OF MISSOURI
JAMES R. HANCOCK
GOVERNOR

PROFESSIONAL ENGINEER
NUMBER PE-2006002845

THE STREETS OF CALEDONIA
PHASE II RESIDENTIAL
O'FALLON, MISSOURI

DATE	BY	DATE	BY
JAN. 13, 2021	JMM	JAN. 13, 2021	ERR

SCALE: 1" = 50'

PROJ. NO: 17-6821

DWG. NO: C6.01

OWNER/DEVELOPER:
DD LAND DEVELOPMENT, LLC
10407 BAUR BLVD, SUITE B
ST. LOUIS, MO 63132

N/F
ROLLING MEADOWS LTD
4-0036-2011-00-0002.3100000

Drawing name: E:\17-6821 - 860 Acre Tract along Hwy 40, O'Fallon, MO\AutoCad Drawings\6821 - Plan Sheets\Construction Drawings\PH2 Residential Plans\13_Phase 2 SWPP Plan Phase 2.dwg Tab: PH II SWPP PLAN PH2 Plotted on: Jan 13, 2021 11:58am Plotted by: tschow