

# STORM SEWER OVERALL DRAINAGE AREA MAP - PHASE 3

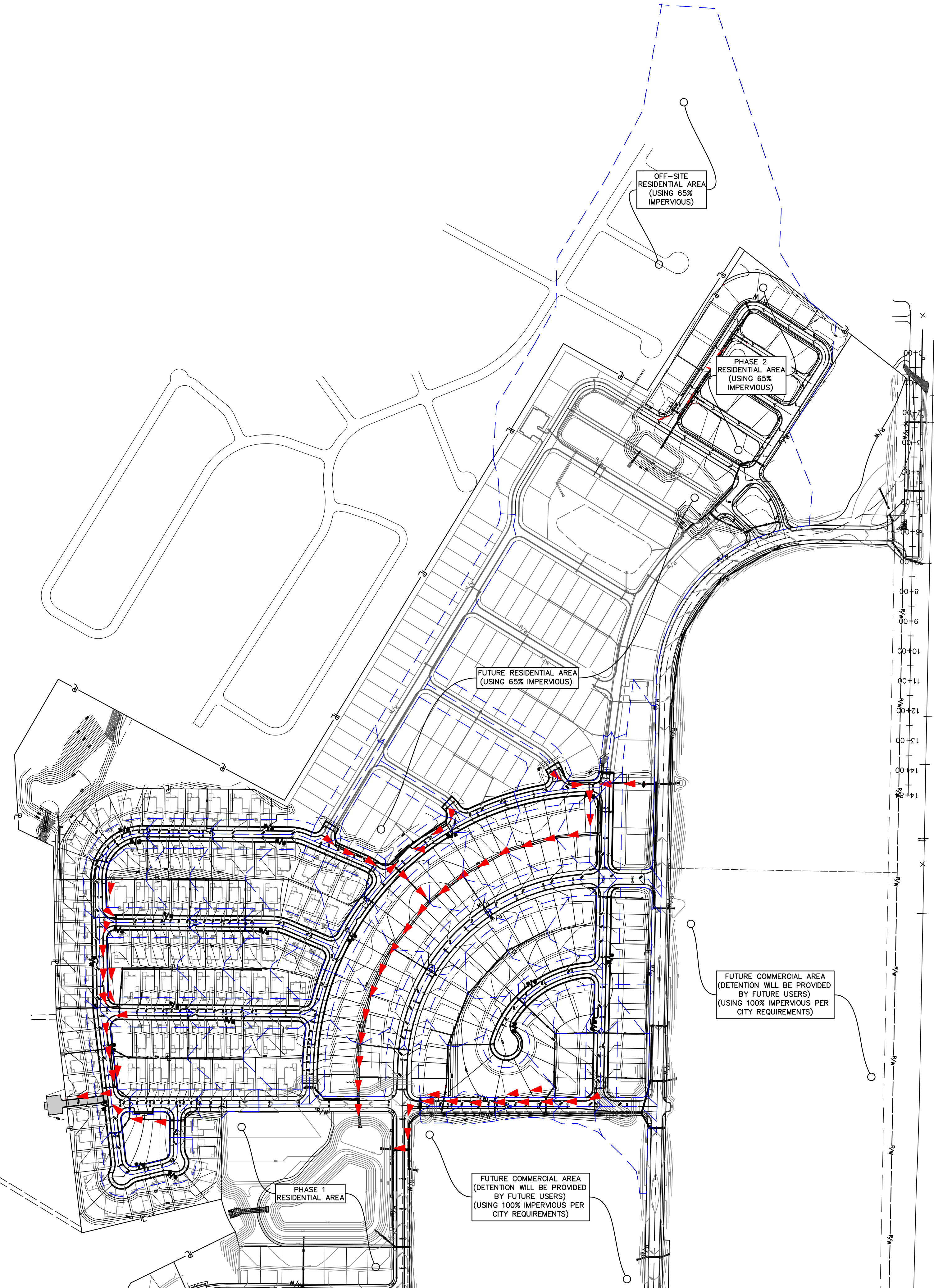
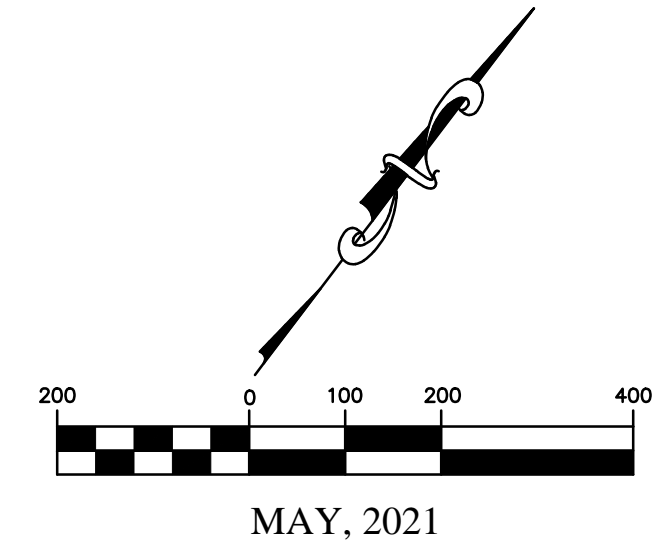

636-584-0540 (tel.)  
636-584-0512 (fax)  
mailto:ochran@ochran.com

**UCHRAN**  
Civil Engineering  
Land Surveying  
Architecture  
Site Development  
General Consulting  
Master Planning

530A E. Independence Dr.  
Union, Missouri 63084

Missouri State Certificate of Authority Numbers:  
Survey : 000380  
Engineering : 001655  
Architecture : 2002014240

Three working days prior to the start of any excavation work, the contractor shall call 1-800-485-8747 for utility location information.

All OSHA rules & regulations shall apply to all construction required by these plans and be strictly followed (i.e. trenching, blasting, etc.).

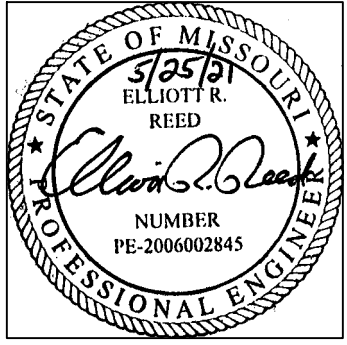

THE STREETS OF CALEDONIA  
PHASE 3 RESIDENTIAL  
O'FALLON, MISSOURI

STORM SEWER DRAINAGE AREA MAP - PHASE 3

DATE:	DESIGNED BY:	APPROVED BY:
	TES	ERR
DATE:	MAY 25, 2021	
SCALE:	1" = 200'	
PROJ. NO.:	17-6821	
DWG. NO.:	C8.03	

OWNER/DEVELOPER:  
DD LAND DEVELOPMENT, LLC  
10407 BAUR BLVD, SUITE B  
ST. LOUIS, MO 63132

DWG NAME: F:\17-6821 - 260 Acre Tract along Hwy 40, O'Fallon, MO\AutoCad Drawings\6821 - Plan Sheets\Construction Drawings\PH3 Residential Plans\14\_Storm Sewer Drainage Area Map Phase 3.dwg PLOTTED ON: May 25, 2021 - 4:00pm PLOTTED BY: jreyer  
Drawing name: F:\17-6821 - 260 Acre Tract along Hwy 40, O'Fallon, MO\AutoCad Drawings\6821 - Plan Sheets\Construction Drawings\PH3 Residential Plans\14\_Storm Sewer Drainage Area Map Phase 3.dwg Tab: STORM OVERVIEW PH3 OVERALL PLOTTED ON: May 25, 2021 - 4:00pm PLOTTED BY: jreyer