

WARPING DETAILS - PHASE 4

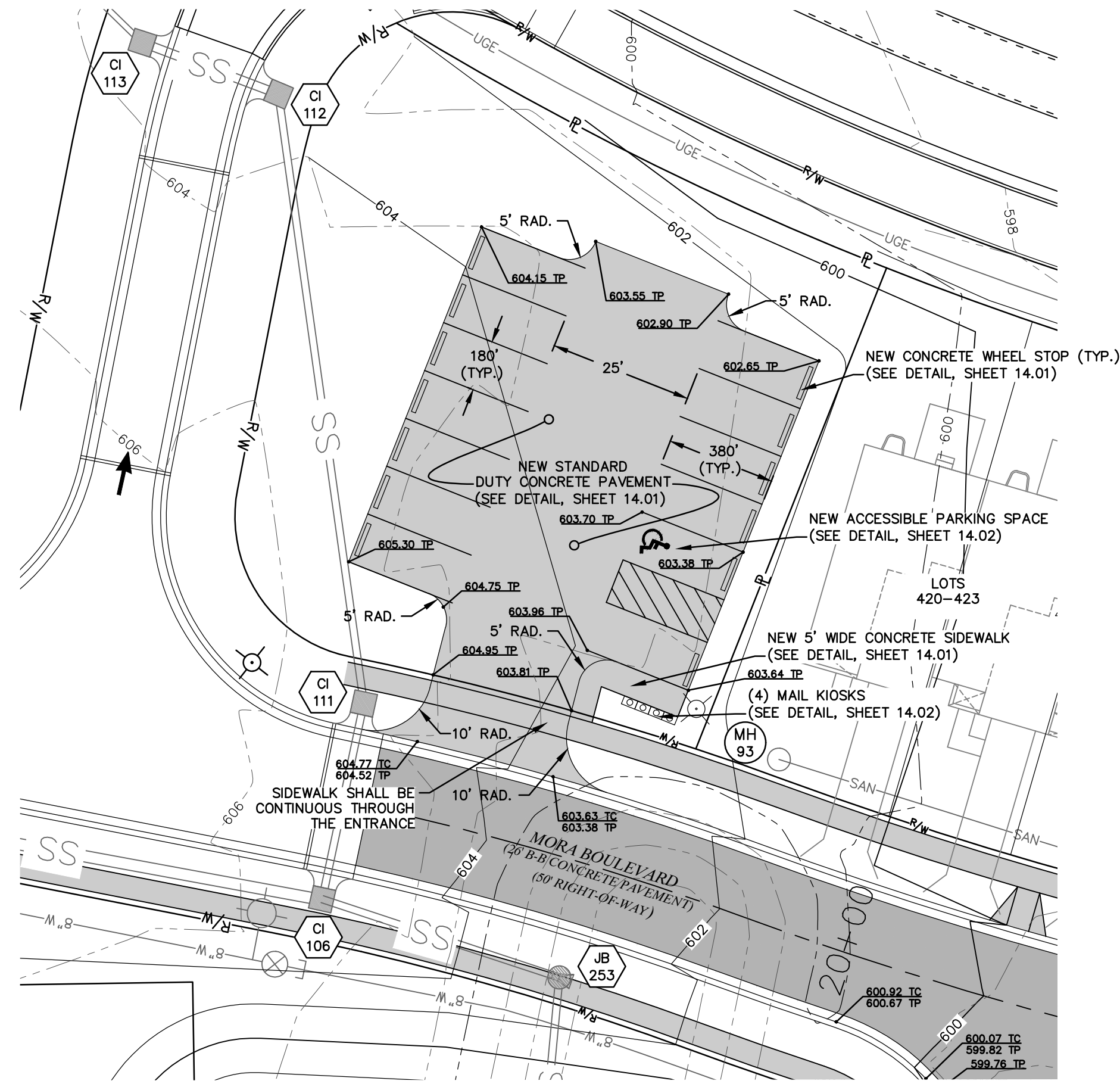

MORA BOULEVARD PARKING LOT #1
WARPING DETAIL

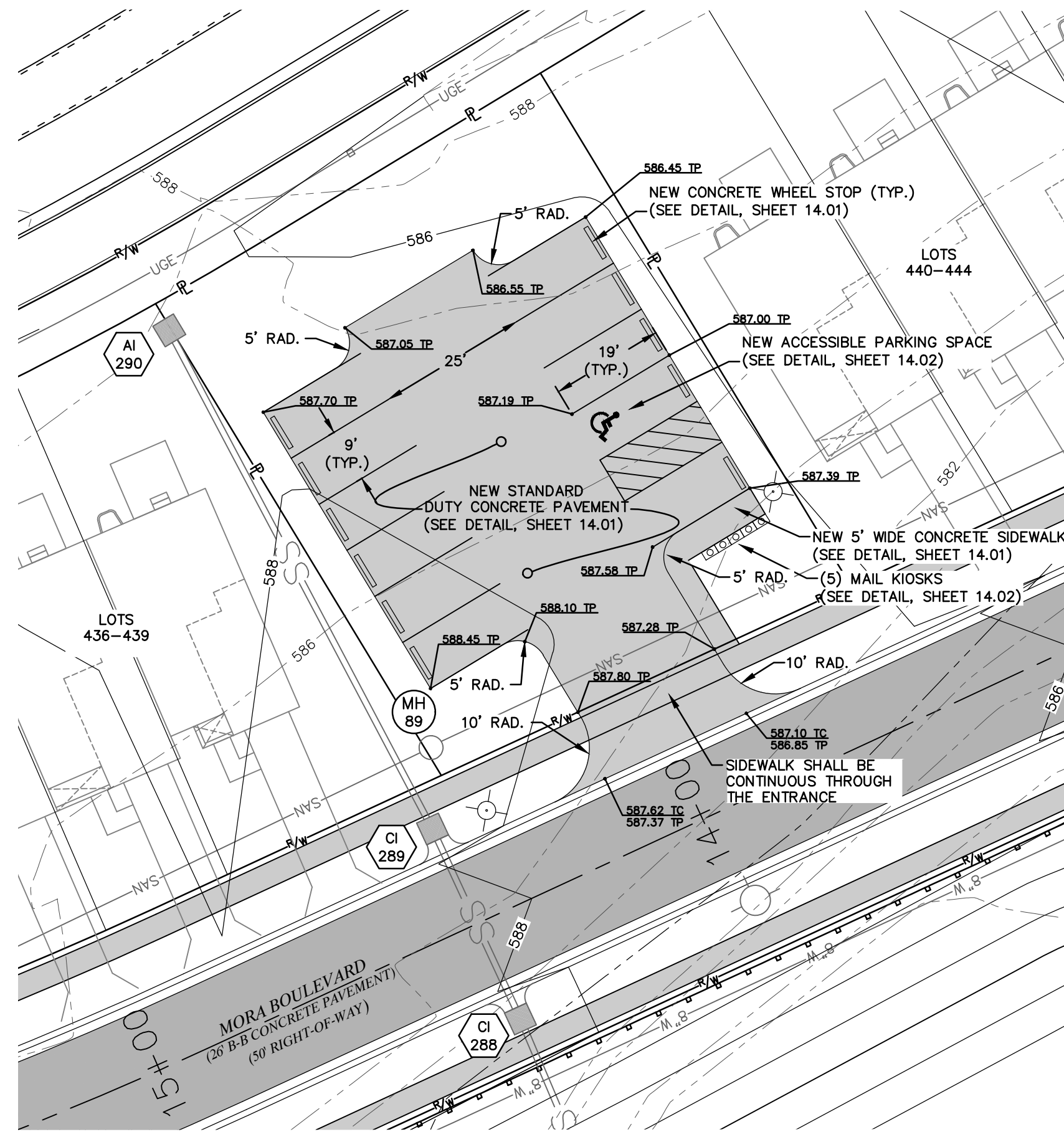

MORA BOULEVARD PARKING LOT #2
WARPING DETAIL

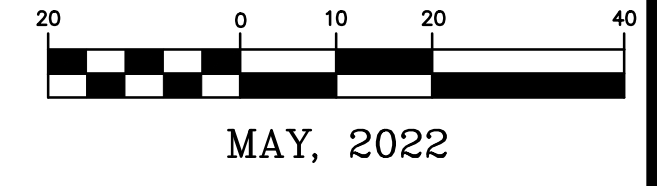

ALL ROUNDINGS AND CUL-DE-SACS SHALL BE CONSTRUCTED WITH THE PROPER SLOPE TO PREVENT STORM WATER PONDING.

OWNER/DEVELOPER:
DD LAND DEVELOPMENT, LLC
10407 BAUR BLVD. SUITE B
ST. LOUIS, MO 63132

636-584-0540 (tel.)
636-584-0512 (fax)
mail@ochran.com

CHORAN

- Civil Engineering
- Land Surveying
- Architecture
- Site Development
- General Consulting
- Master Planning

530A E. Independence Dr.
Union, Missouri 63084

Missouri State Certificate of Authority Numbers:
Survey: 000380
Engineering: 001655
Architecture: 2002014240

Three working days prior to the start of any excavation call 1-800-UGC-RTTE for utility location information.

All OSHA rules & regulations and construction required by these plans shall be strictly followed (ie. trenching, blasting, etc.)

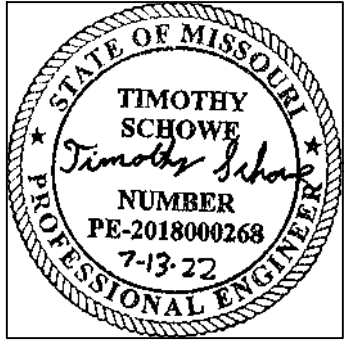

THE STREETS OF CALEDONIA
PHASE 4 RESIDENTIAL
O'FALLON, MISSOURI

DATE	BY	REVISION
06-22-22	JMM	CITY COMMENTS
07-13-22	JMM	SITE CHANGE DIRECTIVE #1

DATE	BY	REVISION
MAY 09, 2022	JMM	ERR
		ERR

SCALE: 1" = 20'

PROJ. NO: 17-6821

DWG. NO: **C13.01**

Drawing name: F:\17-6821 - 260 Acre Tract along Hwy 40, O'Fallon, MO\AutoCad Drawings\6821 - Plan Sheets\Construction Drawings\PH4 Residential Plans\38_Warping Details Phase 4.dwg Tab: 13.01 Plotted on: Jul 13, 2022 - 12:56pm Plotted by: jreyer