

WATER PLAN - PHASE 4

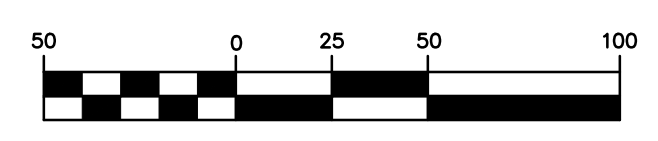

MAY, 2022

LEGEND

EXISTING	PROPOSED

- NOTES:**
1. WATER DISTRICT REQUIRES A MINIMUM OF 42" AND A MAXIMUM OF 72" OF COVER OVER ITS WATER MAINS.
 2. ALL STREET CROSSINGS SHALL HAVE FULL DEPTH COMPACTED GRANULAR BACKFILL.
 3. ALL VERTICAL BENDS TO INCLUDE RETAINER GLANDS.
 4. ALL METER PITS MUST BE INSTALLED IN GREEN SPACE PER PWS2 SPECIFICATIONS.
 5. ALL OFF-SITE WATER SYSTEM WORK MUST BE RESTORED WITH SOD UNLESS OTHER CONSIDERATION IS REQUESTED BY THE OFF-SITE PROPERTY OWNER.
 6. IT WILL BE CONTRACTOR'S RESPONSIBILITY TO OBTAIN ALL NECESSARY PERMITS. COPIES OF ALL REQUIRED PERMITS SHALL BE PROVIDED TO THE WATER DISTRICT PRIOR TO CONSTRUCTION.
 7. WATER EXTENSION AGREEMENTS WILL BE REQUIRED FOR EACH PHASE BEFORE CONSTRUCTION CAN BEGIN.
 8. WATER DISTRICT REQUIRES AT LEAST 18" OF HORIZONTAL SEPARATION BETWEEN CROSSINGS.
 9. WATER DISTRICT REQUIRES ONE (1) WEEK NOTICE BEFORE THE START OF CONSTRUCTION.
 10. ALL WATER MAINS, VALVES, FITTINGS, HYDRANTS, AND RELATED ITEMS ARE TO BE INSTALLED IN ACCORDANCE WITH THE CURRENT PWS2 OF ST. CHARLES COUNTY GUIDELINES AND SPECIFICATION AS APPROVED BY MODNR REVIEW NO. 6050805-13.
 11. ALL PROPOSED CONNECTIONS TO AN EXISTING PUBLIC WATER MAIN SHALL BE MADE PER THE WATER DISTRICT'S SPECIFICATIONS.
 12. ALL PUBLIC FIRE HYDRANTS SHALL BE PAINTED CHROME YELLOW PER THE WATER DISTRICTS SPECIFICATIONS.

PROVIDE GRANULAR BACKFILL TO ALL WATER MAIN TRENCHES THAT CROSS THE PAVEMENT, LIE WITHIN TEN (10) FEET OF THE EDGE OF PAVEMENT AND/OR THE 1:1 SHEAR PLANE OF THE ROAD.

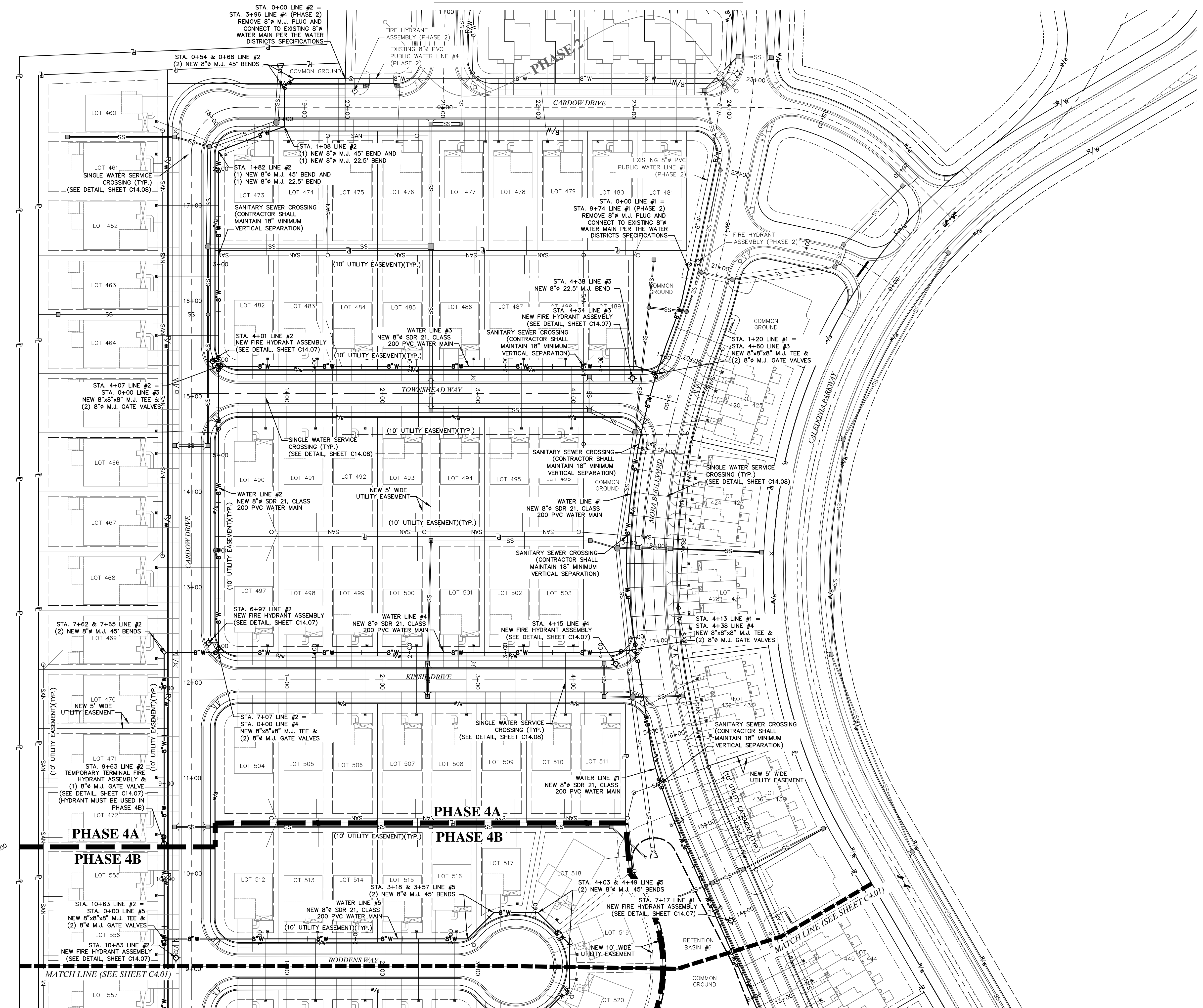

Drawing name: F:\17-6821 - 860 Acre Tract along Hwy 40, O'Fallon, MO\AutoCad Drawings\6821 - Plan Sheets\Construction Drawings\PH4 Residential Plans\09_Water Plan Phase 4.dwg Tab: WATER PLAN PH4-1 Plotted on: May 12, 2022 - 2:31pm Plotted by: jmeyer

636-584-0540 (tel.)
636-584-0512 (fax)
mail@ochran.com
www.ochran.com

530A E. Independence Dr.
Union, Missouri 63084

Civil Engineering
Land Surveying
Architecture
Site Development
General Consulting
Master Planning

Missouri State Certificate of Authority Numbers:
Survey: 000380
Engineering: 001655
Architecture: 2002014240

Three working days prior to the start of any excavation call 1-800-963-8376 for utility location information.

All OSHA rules & regulations and state & local construction regulations required by these plans shall be strictly followed (i.e. trenching, blasting, etc.)

STATE OF MISSOURI

TIMOTHY SCHOWE

Professional Engineer

NUMBER
PE-201800268
EXPIRES
6-9-22

PROFESSIONAL REGISTRY

WATER PLAN - PHASE 4

DATE:	MAY 09, 2022
SCALE:	1" = 50'
PROJ. NO.:	17-6821
DWG. NO.:	C4.0

OWNER/DEVELOPER:
DD LAND DEVELOPMENT, LLC
10407 BAUR BLVD, SUITE B
ST. LOUIS, MO 63132