

# Common Ground Amenities at Sunset Ridge Estates

COMMON GROUND OF SUNSET RIDGE ESTATES PHASE 1 PLAT 1 & PHASE 4,  
PART OF SECTION 36, TOWNSHIP 47 NORTH, RANGE 2 EAST,  
AS RECORDED IN PLAT BOOK 34, PAGE 134 AND PLAT BOOK 36, PAGE 5,  
CITY OF O'FALLON, ST. CHARLES COUNTY, MISSOURI

## SITE IMPROVEMENT PLANS

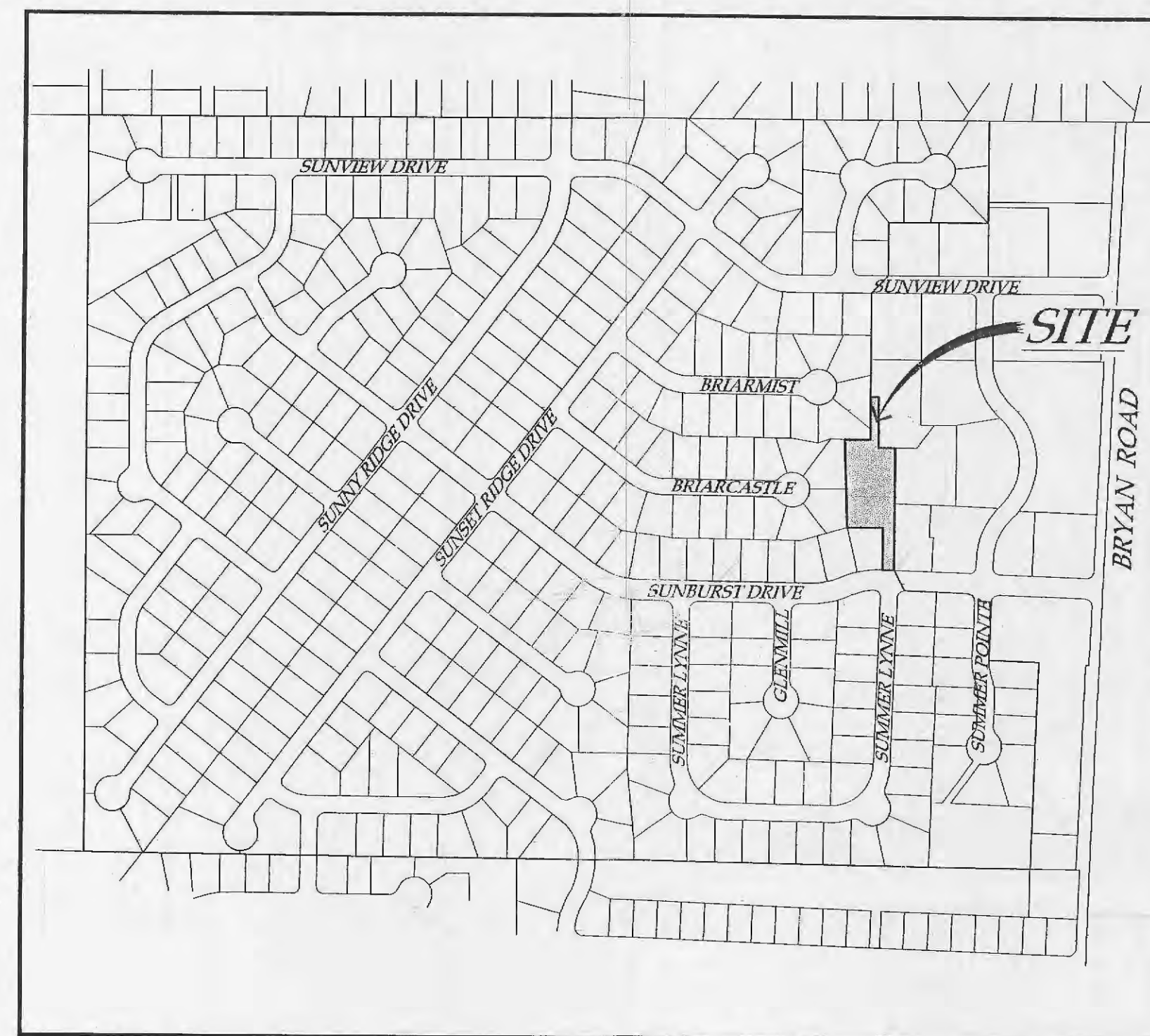

VICINITY MAP  
NOT TO SCALE

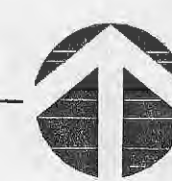

PREPARED FOR:

BRYAN ROAD ASSOCIATES, L.L.C.  
C/O - MR. GLENN NOTHUM  
7321 S. LINDBERGH BLVD. - SUITE 310  
ST. LOUIS, MO. 63125  
PHONE (314) 894-7768  
FAX (314) 894-7423

CIVIL ENGINEER:

**SITE DEVELOPMENT ENGINEERING, INC.**

12221 BIG BEND ROAD  
ST. LOUIS, MO 63122  
(314) 822-4800 FAX (314) 822-9266

### INDEX OF SHEETS

- C1 TITLE SHEET
- C2 SITEWORK CONSTRUCTION NOTES
- C3 SITE PLAN
- C4 GRADING PLAN
- C5 UTILITY PLAN
- C6 RETAINING WALL PLAN & DETAILS
- C7 LANDSCAPING PLAN
- C8 FENCE MANUFACTURER DETAILS
- C9 DRAINAGE AREA MAP

1-31-02 98  
APPROVED

Address of Site:  
1361 Sunburst Drive  
O'Fallon, MO 63366

<b>SDE</b> 12221 Big Bend Road St. Louis, Missouri 63122 314-822-4800 Fax 314-822-9266	<b>SITE DEVELOPMENT ENGINEERING, INC.</b> <small>PLANNING • SURVEYING • CIVIL ENGINEERING</small>		RECEIVED JAN 25 2002 CITY OF O'FALLON, MO
	<i>Common Ground Amenities at Sunset Ridge Estates</i>		
DATE : July 25, 2001	CHECKED BY : SDR	JOB NO. : 201-023	DRAWN BY : JJA SCALE : NOTED
<b>TITLE SHEET</b>			SHEET : <b>C1</b>
REV. : December 18, 2001 City of O'Fallon Comments January 4, 2002 City of O'Fallon Comments January 23, 2002 City of O'Fallon Comments			



Bldg. Inspector