

BOUNDARY LINE & CURVE TABLE

LINE	DIRECTION	DISTANCE
L1	N 02°04'00" W	135.00'
L2	S 03°58'20" W	50.00'
L3	N 03°58'20" E	245.00'
L4	N 03°58'20" E	14.96'
L5	S 07°01'40" E	50.00'
L6	S 03°58'20" W	24.23'
L7	S 03°58'20" W	48.48'
L8	N 00°01'40" W	80.00'
L9	S 07°01'40" E	505.01'
L10	S 03°58'20" W	152.36'
L11	S 07°01'40" E	50.00'
L12	N 03°58'20" W	50.00'
L13	S 11°21'35" W	50.00'
L14	N 00°01'40" W	552.66'
L15	S 00°01'40" E	500.01'
C1	RADIUS	LENGTH
C1	20.00'	31.42'
C2	20.00'	31.42'
C3	505.00'	46.25'
C4	555.00'	149.64'

BRYAN ROAD (VARIABLE WIDTH)

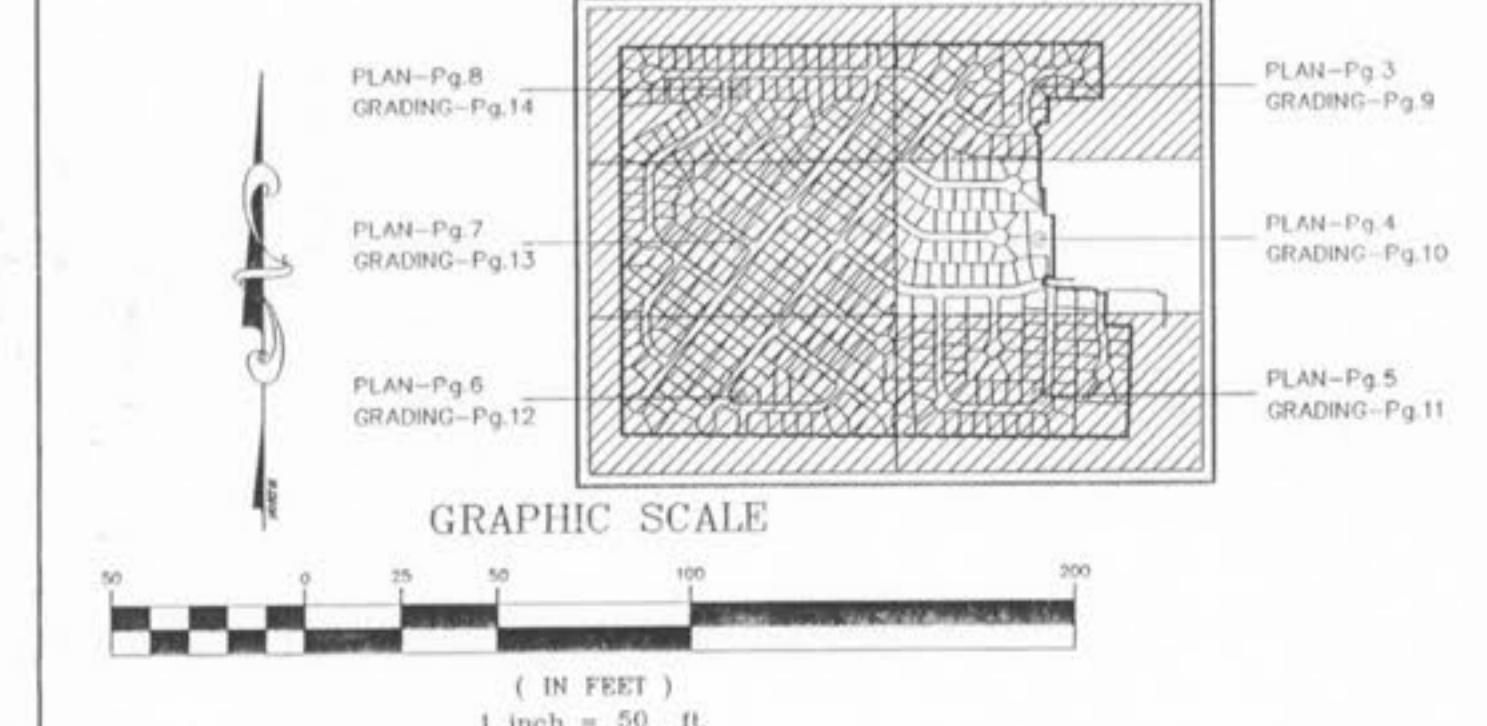

* - THESE LOTS ARE SUSCEPTIBLE TO STREET CREEP

The underground utilities shown herein were plotted from available information and do not necessarily reflect the actual existence, nonexistence, size, type, number, or location of these or other utilities. The general contractor shall be responsible for verifying the actual location of all underground utilities, shown or not shown, and shall utilities shall be located in the field prior to any grading, excavation or construction of improvements. These provisions shall in no way absolve any party from complying with the Underground Facility Safety and Damage Prevention Act, Chapter 318, RSMo.



ZIP CODE : 63366

Site Development Engineering, Inc.
 PLANNING SURVEYING CIVIL ENGINEERING
 12221 BIG BEND ROAD, ST. LOUIS, MISSOURI 63122 (314) 822-4800

SUNSET RIDGE ESTATES

DATE : 4/10/96 JOB NO. : 95-541 DRAWN BY : TWF
 DESIGN : JOY SCALE : 1" = 80'

PLAN SHEET

REV. : 8/30/96 per CLIENT REVISIONS
 11/21/96 per CITY COMMENTS
 1/7/97 per CITY COMMENTS
 0/1/97 per CLIENT REVISIONS

SHEET : 4 OF 58

05-541-95-541_P1_96.11.12.45.25.1928