

PROPOSED SANITARY

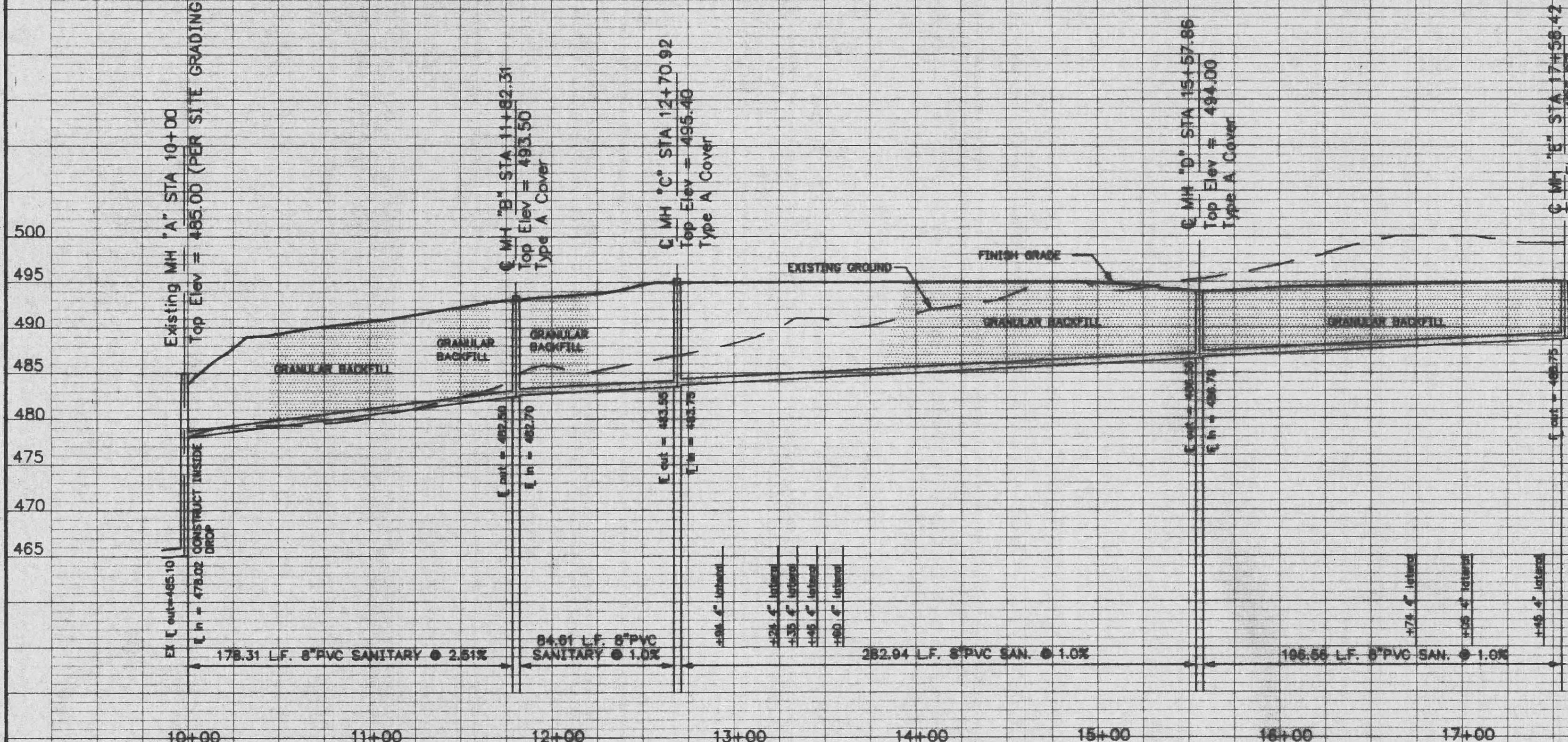

PROPOSED STORM AT LEFT FIELD GRASS BERM

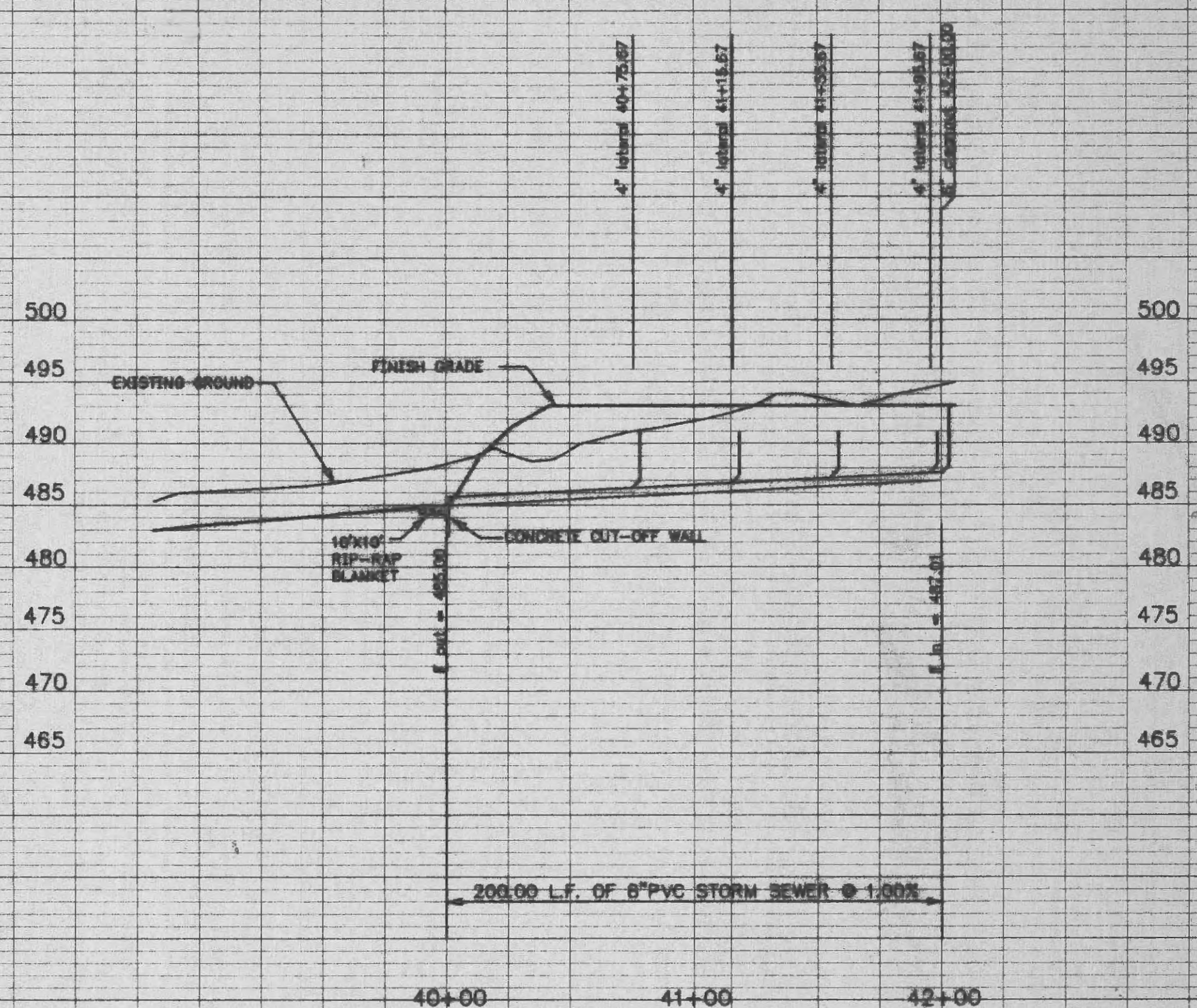

PROPOSED STORM TO DRAIN SEATING AREA

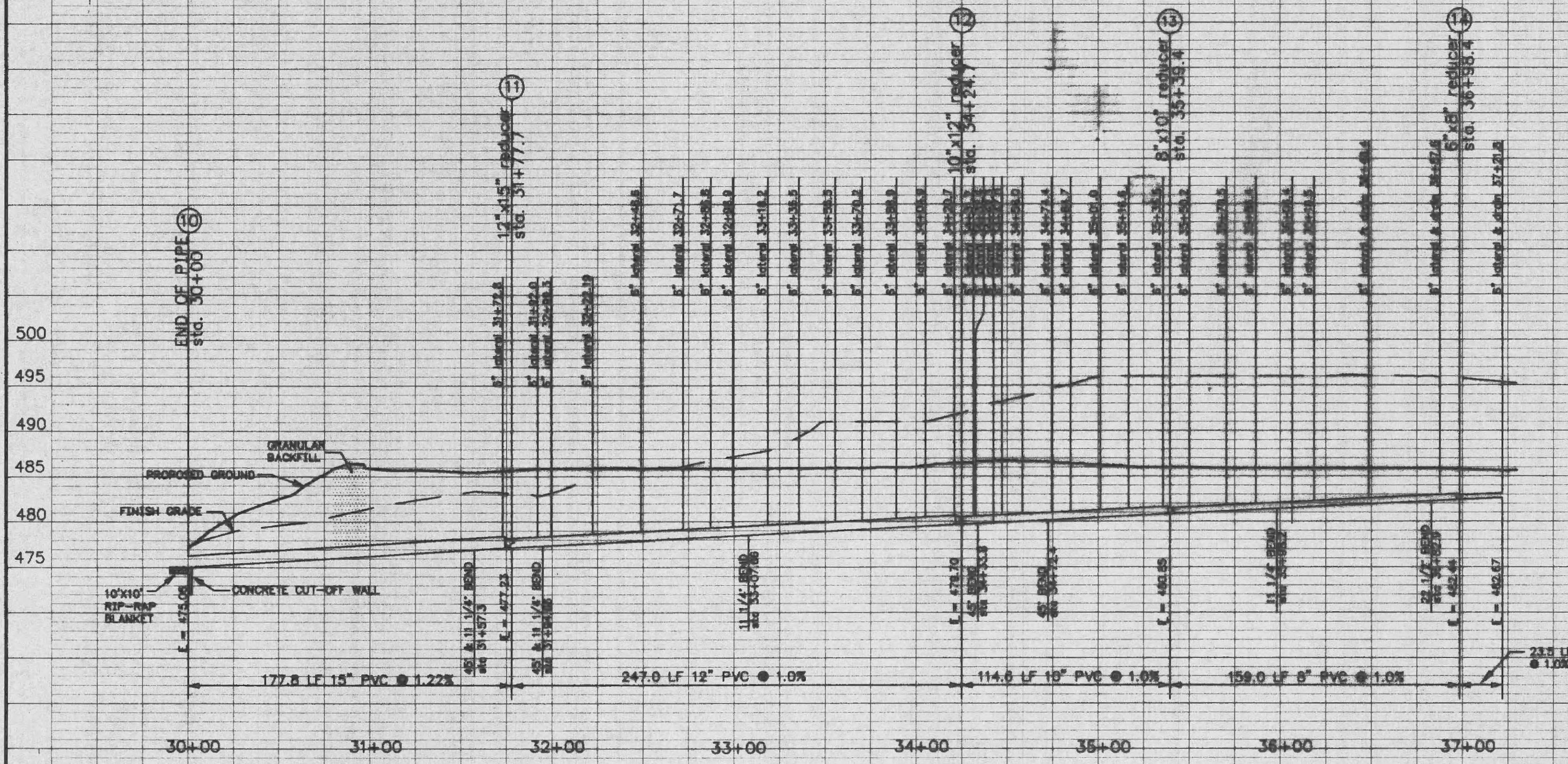

PROPOSED STORM TO DRAIN INFIELD/OUTFIELD

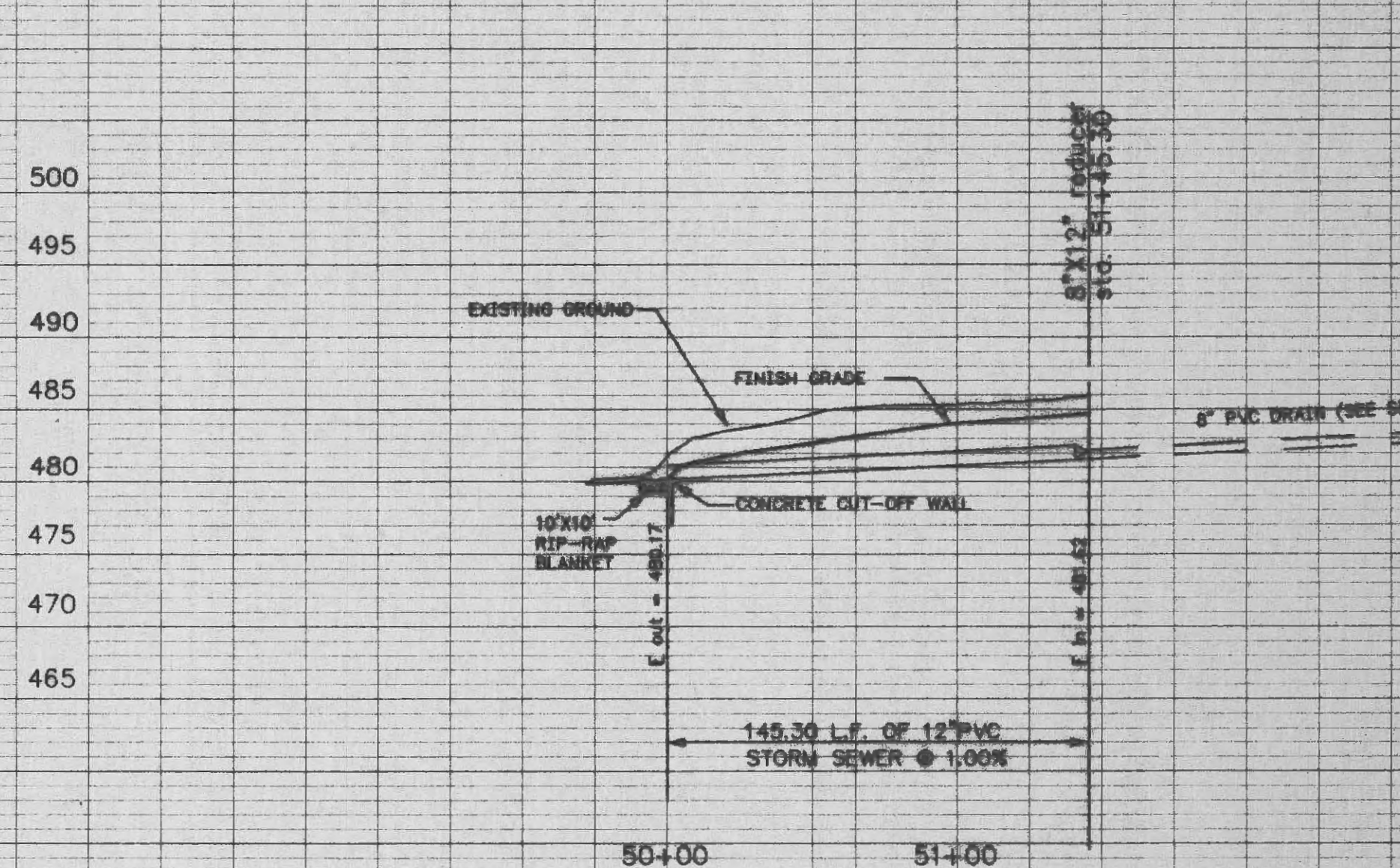

- KEYNOTES**
- DIVISION 2
    - 02200 EARTHWORK
    - 02282 TYPICAL CONTROL
    - 02310 ASPHALT CONCRETE PAVING
    - 02320 PORTLAND CEMENT CONCRETE PAVING
    - 02521 IMPROVED CONCRETE PAVING
    - 02831 CHAIN LINK FENCES AND GATE
    - 02910 NATURAL TURF PLAYING FIELD SYSTEM
  - DIVISION 3
    - 03300 CAST IN PLACE CONCRETE
    - 03350 CONCRETE TOPPING
    - 03450 ARCHITECTURAL PRECAST CONCRETE
  - DIVISION 4
    - 04200A UNIT MASONRY
    - 04200B UNIT MASONRY
    - 04200C UNIT MASONRY
  - DIVISION 5
    - 05120 STRUCTURAL STEEL
    - 05210 STEEL JOIST
    - 05310 METAL DECKING
    - 05400 COLD-FORMED METAL FRAMING
    - 05500 METAL FABRICATION
    - 05510 PIPE RAILINGS
    - 05530 GRATING
    - 05700 ORNAMENTAL METALWORK
    - 05720 ORNAMENTAL HANDRAILS AND RAILINGS
    - 05810 EXPANSION JOINT COVER ASSEMBLIES
  - DIVISION 6
    - 06105 MISC. CARPENTRY
    - 06400 ARCHITECTURAL WOODWORK
  - DIVISION 7
    - 07180 BITUMINOUS DAMPROOFING
    - 07182 WATER REPELLENTS
    - 07210 BUILDING INSULATION
    - 07511 EPDM SINGLE PLY MEMBRANE ROOFING
    - 07533 THERMOPLASTIC (PVC) SINGLE PLY MEMBRANE ROOFING
    - 07620 SHEET METAL FLASHING AND TRIM
    - 07710 MANUFACTURED ROOF SPECIALTIES
    - 07720 ROOF ACCESSORIES
    - 07901 JOINT SEALANTS
  - DIVISION 8
    - 08110 STEEL DOORS AND FRAMES
    - 08211 FLUSH WOOD DOORS
    - 08300 ACCESS DOORS
    - 08320 OVERHEAD COILING DOORS
    - 08335 OVERHEAD COILING SHUTTERS
    - 08410 ALUMINUM ENTRANCES AND STOREFRONT
    - 08520 ALUMINUM WINDOWS
    - 08550 WOOD WINDOWS
    - 08665 SECURITY WINDOWS
    - 08710 FINISH HARDWARE
    - 08800 GLAZING
    - 08830 MIRRORING GLASS
  - DIVISION 9
    - 09255 GYPSUM BOARD ASSEMBLIES
    - 09310 CERAMIC TILE
    - 09510 ACOUSTICAL CEILINGS
    - 09635 RESILIENT WALL BASE AND ACCESSORIES
    - 09680 CARPET
    - 09780 FLOOR SEALERS
    - 09800 SPECIAL COATINGS
    - 09810 FERROUS METAL SPECIAL COATINGS
    - 09815 HAZARD STRIPING
    - 09900 PAINTING
  - DIVISION 10
    - 10155 TOILET COMPARTMENTS
    - 10350 FLAPPOLES
    - 10522 FIRE EXTINGUISHERS, CABINETS & ACCESSORIES
    - 10800 TOILET ACCESSORIES
  - DIVISION 11
    - 11452 RESIDENTIAL EQUIPMENT
    - 11480 STADIUM GAME EQUIPMENT
    - 11481 FIELDHALL PADS
    - 11485 SCOREBOARDS
    - 11486 VIDEO BOARDS
  - DIVISION 12
    - 12610 STADIUM CHAIRS
    - 12620 BENCH SEATING
  - DIVISION 13
    - NONE INCLUDED
  - DIVISION 14
    - 14420 WHEELCHAIR LIFTS



**T. R. HUGHES BALLPARK**  
AT THE OZZIE SMITH SPORTS COMPLEX

for the River City Rascals

**HELLMUTH OBATA & KASSABAUM**  
Architecture, Engineering, Planning  
Interiors, Facility Programming  
323 West 8th Street, Suite 700  
Kansas City, Missouri 64105

**STRUCTURAL ENGINEER**  
Kear County Grading Associates, Inc.  
801 Walnut - Suite 301  
Kansas City, Missouri 64106

**MECHANICAL/ELECTRICAL/PLUMBING**  
Towles & Associates  
5503 Elm Street - Suite 214  
Raytown, Missouri 64133

**CIVIL ENGINEER**  
George Butler Associates, Inc.  
225 South Main Street - Suite 200  
O'Fallon, Missouri 63366-2892

BID PACKAGE #1

PACKAGE REVISIONS	NO.	DATE	DESCRIPTION

PROJECT NO. 97-0761-00 ISSUED BY: HOK SPO  
DRAWN BY: CDF REVIEWED BY: JJC  
ISSUED: 07-01-98  
SHEET TITLE

PROFILES

CATEGORY - SUB-CATEGORY - S

C1.03