

GENERAL NOTES:

- APPROXIMATE LOCATION OF FIELD LIGHTING POLES. SEE ARCHITECTURAL DRAWINGS FOR EXACT LOCATION.
- NO CONDUITS SHALL BE ROUTED THROUGH PLAYING FIELD.
- CENTER LINE OF LOWEST FIXTURE ROW ON ALL 'A' & 'B' POLES SHALL BE XXX' MEASURED ABOVE PLAYING FIELD SURFACE ALL OTHERS XXX FEET.
- NUMBER SHOWN ON PLAN INDICATE MINIMUM FOOTCANDLE LEVEL ON PLAYING FIELD SURFACE.
- FIELD LIGHTING SHALL BE CONTROLLED FROM SWITCHES LOCATED IN SOUND/ SCOREBOARD ROOM.



SPORT

HELLMUTH OBATA & KASSABAUM, INC.
Architecture, Engineering, Planning,
Interiors, Facility Programming
323 West 8th Street, Suite 700
Kansas City, Missouri 64105

STRUCTURAL ENGINEER
Ken Conrad Ombas Associates
801 Walnut - Suite 301
Kansas City, Missouri 64105

MECHANICAL/ELECTRICAL PLUMBING
Bridges & Associates
950 63rd Street - Suite 214
Raytown, Missouri 64133

CIVIL ENGINEER
George Butler Associates, Inc.
223 South Main Street - Suite 200
O'Fallon, Missouri 63366-2892

T. R. HUGHES BALLPARK
AT THE OZZIE SMITH SPORTS COMPLEX
for the River City Rascals
O'FALLON, MO.

PACKAGE REVISIONS

NO.	DATE	DESCRIPTION

PROJECT NO. 97-0761-00 ISSUED BY: HOK SPORT
DRAWN BY: JLD REVIEWED BY: AJO
ISSUED: 7-7-98
SHEET TITLE

FIELD LIGHTING
ALTERNATE 100/75

CATEGORY - SUB-CATEGORY - SHEET

E.1-5

PANELBOARD "PA1" LOCATION: POLE A1

AMPS: 100MAINS: 70A. MB 277/480V. 3PH. 4W. , GR. MOUNTING: SURFACE

BREAKER	LOAD	WATTS	CKT NO	PHASE LOADS			CKT NO	WATTS	LOAD	BREAKER	
A	P			A	B	C			P	A	
20	2	3300	1	6600			2	3300	FIELD LTG	2 20	
--	--	3300	3		6600		4	3300		-- --	
20	2	3300	5			4950	6	1650	FIELD LTG	2 20	
--	--	3300	7	4950			8	1650		-- --	
20	2	2475	9		4950		10	2475	FIELD LTG	2 20	
--	--	2475	11			4950	12	2475		-- --	
20	2		13	0			14		SPARE	2 20	
--	--		15		0		16			-- --	
			17			0	18		SPACE		
			19	0			20		SPACE		
			21		0		22		SPACE		
			23			0	24		SPACE		
TOTAL LOAD		33.00 KW		11550	11550	9900					
		39.76 AMPS							I. C. 1400RMS SYM. AMPS		

PANELBOARD "PA2" LOCATION: POLE A2

AMPS: 100MAINS: 70A. MB 277/480V. 3PH. 4W. , GR. MOUNTING: SURFACE

BREAKER	LOAD	WATTS	CKT NO	PHASE LOADS			CKT NO	WATTS	LOAD	BREAKER	
A	P			A	B	C			P	A	
20	2	3300	1	6600			2	3300	FIELD LTG	2 20	
--	--	3300	3		6600		4	3300		-- --	
20	2	3300	5			4950	6	1650	FIELD LTG	2 20	
--	--	3300	7	4950			8	1650		-- --	
20	2	2475	9		4950		10	2475	FIELD LTG	2 20	
--	--	2475	11			4950	12	2475		-- --	
20	2		13	0			14		SPARE	2 20	
--	--		15		0		16			-- --	
			17			0	18		SPACE		
			19	0			20		SPACE		
			21		0		22		SPACE		
			23			0	24		SPACE		
TOTAL LOAD		33.00 KW		11550	11550	9900					
		39.76 AMPS							I. C. 1400RMS SYM. AMPS		

PANELBOARD "PB1" LOCATION: POLE B1

AMPS: 100MAINS: 100A. MB 277/480V. 3PH. 4W. , GR. MOUNTING: SURFACE

BREAKER	LOAD	WATTS	CKT NO	PHASE LOADS			CKT NO	WATTS	LOAD	BREAKER	
A	P			A	B	C			P	A	
20	2	3300	1	6600			2	3300	FIELD LTG	2 20	
--	--	3300	3		6600		4	3300		-- --	
20	2	3300	5			6600	6	3300	FIELD LTG	2 20	
--	--	3300	7	6600			8	3300		-- --	
20	2	3300	9		6600		10	3300	FIELD LTG	2 20	
--	--	3300	11			6600	12	3300		-- --	
20	2	3300	13	6600			14	3300	FIELD LTG	2 20	
--	--	3300	15		6600		16	3300		-- --	
20	2		17			0	18		SPACE	2 20	
--	--		19	0			20			-- --	
			21		0		22		SPACE		
			23			0	24		SPACE		
TOTAL LOAD		52.80 KW		19800	19800	13200					
		63.61 AMPS							I. C. 1400RMS SYM. AMPS		

PANELBOARD "PB2" LOCATION: POLE B2

AMPS: 100MAINS: 100A. MB 277/480V. 3PH. 4W. , GR. MOUNTING: SURFACE

BREAKER	LOAD	WATTS	CKT NO	PHASE LOADS			CKT NO	WATTS	LOAD	BREAKER	
A	P			A	B	C			P	A	
20	2	3300	1	6600			2	3300	FIELD LTG	2 20	
--	--	3300	3		6600		4	3300		-- --	
20	2	3300	5			6600	6	3300	FIELD LTG	2 20	
--	--	3300	7	6600			8	3300		-- --	
20	2	1650	9		4125		10	2475	FIELD LTG	2 20	
--	--	1650	11			4125	12	2475		-- --	
20	2		13	0			14		SPARE	2 20	
--	--		15		0		16			-- --	
			17			0	18		SPACE		
			19	0			20		SPACE		
			21		0		22		SPACE		
			23			0	24		SPACE		
TOTAL LOAD		34.65 KW		13200	10725	10725					
		41.75 AMPS							I. C. 1400RMS SYM. AMPS		

Disclaimer of Responsibility
I hereby specify that the documents intended to be authenticated by my seal are limited to drawings and specifications containing my seal with signature and date, and I hereby disclaim any responsibility for all other plans, specifications, estimates, reports or other documents or instruments relating to or intended to be used for any part or parts of the architectural or engineering project or survey.

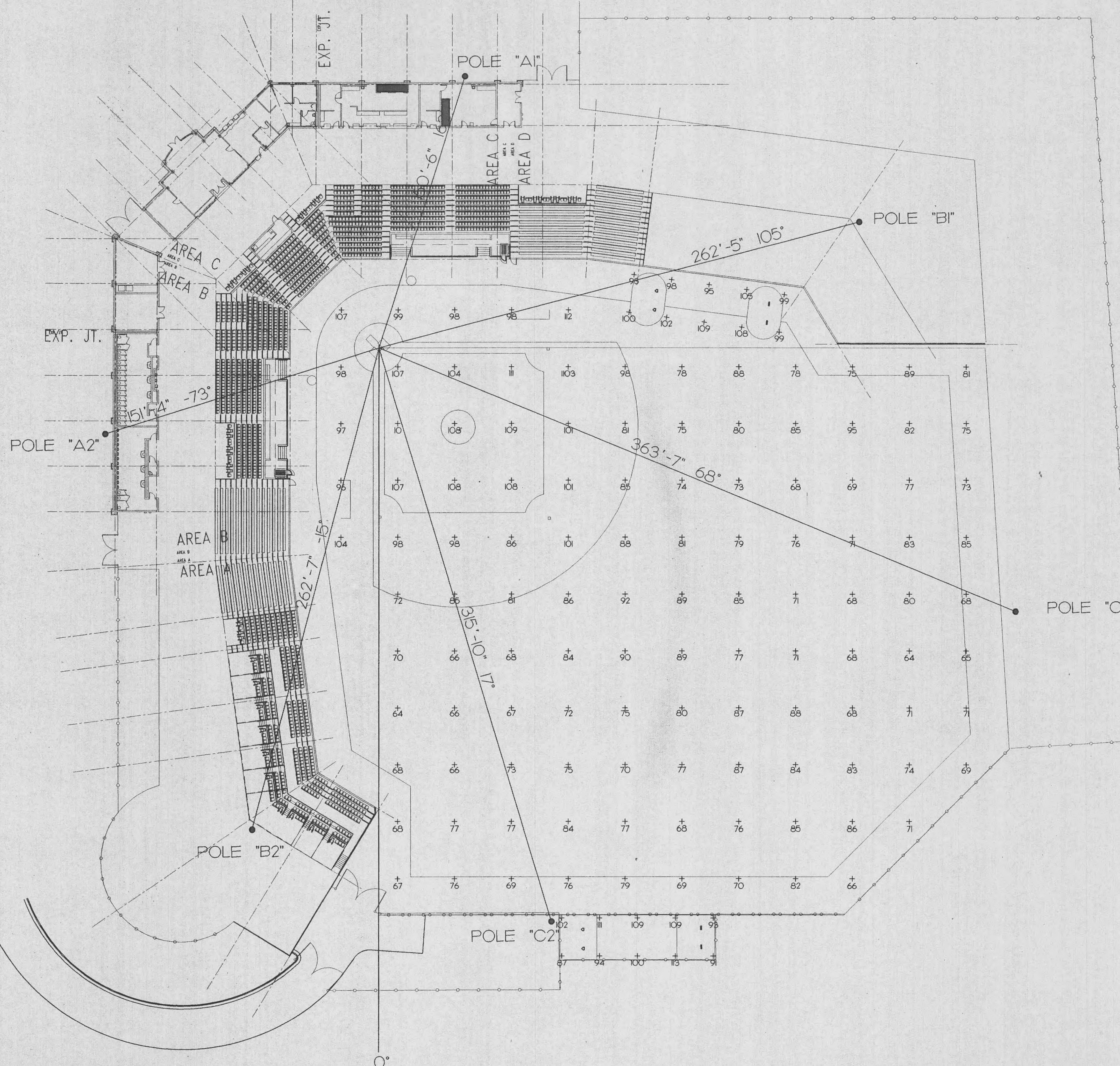

A FIELD LIGHTING
1"=30'-0"

es