



DISCLAIMER OF RESPONSIBILITY
I HEREBY SPECIFY THAT THE DOCUMENTS ATTACHED
TO BE APPROVED BY ME, ARE LIMITED
TO THIS SHEET, AND I HEREBY DISCLAIM ANY
RESPONSIBILITY FOR ALL OTHER DRAWINGS,
SPECIFICATIONS, ESTIMATES, REPORTS OR OTHER
DOCUMENTS OR INSTRUMENTS RELATING TO OR
INTENDED TO BE USED FOR ANY PART OR PARTS
OF THE ARCHITECTURAL OR ENGINEERING PROJECT
OR SURVEY.

STATE OF MISSOURI
REGISTERED PROFESSIONAL ENGINEER
CHRISTINE ANN
LOOK
NUMBER
E-000150007
SEAL 2/13/03

DESIGNED: CEM
CHECKED: CAL
DATE: 02/25/02
PROJECT NO.: 00-000

NOTE:
Underground utilities have been plotted from available information and therefore their locations shall be considered approximate only. The verification of the location of all underground utilities, either shown or not shown on these plans shall be the responsibility of the contractor, and shall be located prior to any grading or construction of the improvements.

THE INTENT OF THESE PLANS IS TO INDICATE A CHANGE IN PAVEMENT WIDTH DUE TO THE RECONFIGURATION OF THE INTERSECTION OF T.R. HUGHES BOULEVARD AND COOL SPRINGS INDUSTRIAL. THE EAST HALF OF T.R. HUGHES BOULEVARD SHALL BE CONSTRUCTED ACCORDING TO THE T.R. HUGHES BOULEVARD PLANS, EXCEPT FOR COOL SPRINGS CONNECTOR ROAD, AS NOTED.

①
N/F
City of O'Fallon
BOOK 338 PAGE 198

LIMITS OF MODIFICATION

CONSTRUCTION LIMIT

UNDER CONSTRUCTION

SEE T.R. HUGHES BOULEVARD EXTENSION PLANS FOR CONSTRUCTION LIMIT INFORMATION.

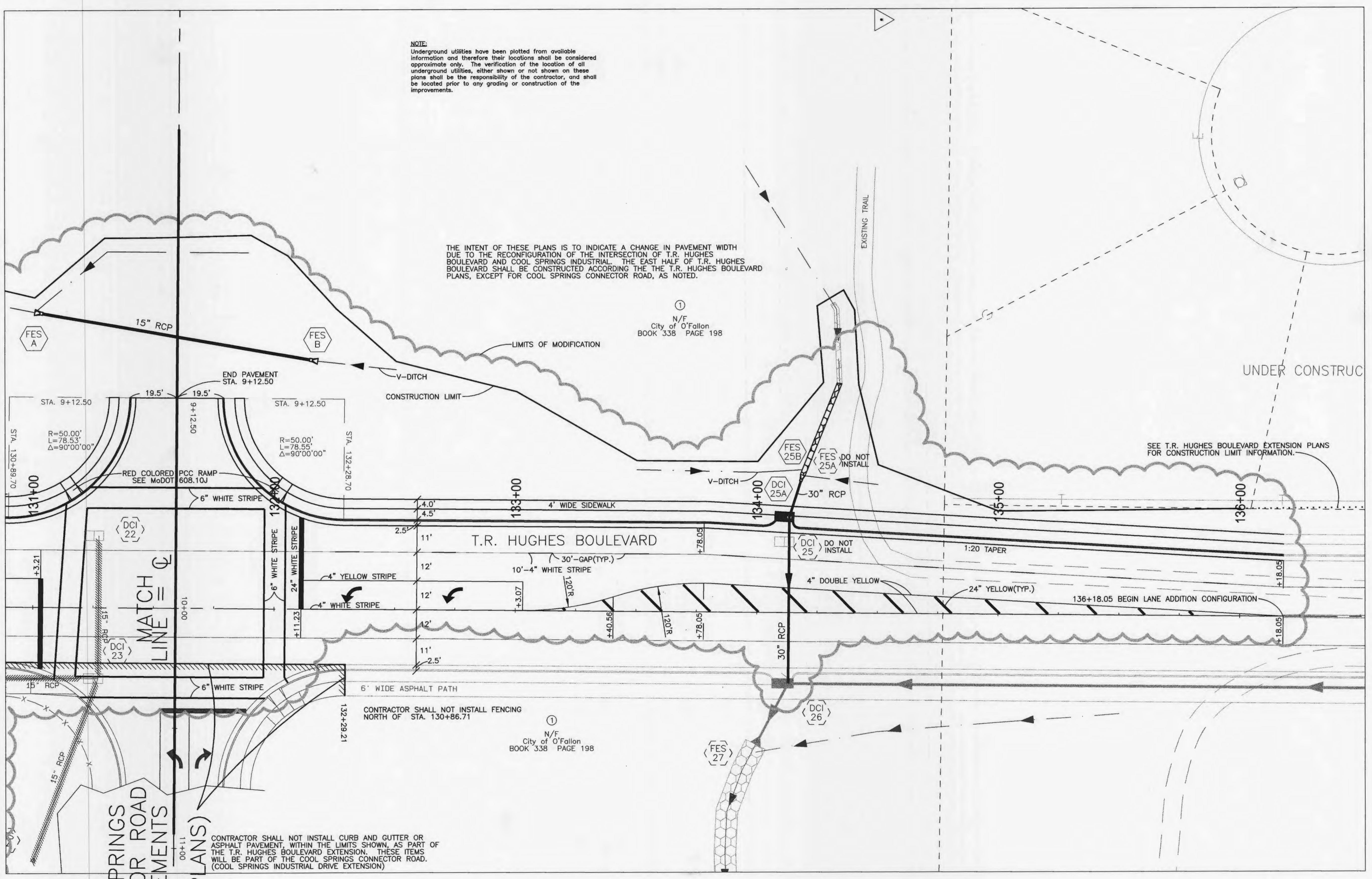

①
N/F
City of O'Fallon
BOOK 338 PAGE 198

CONTRACTOR SHALL NOT INSTALL CURB AND GUTTER OR ASPHALT PAVEMENT, WITHIN THE LIMITS SHOWN, AS PART OF THE T.R. HUGHES BOULEVARD EXTENSION. THESE ITEMS WILL BE PART OF THE COOL SPRINGS CONNECTOR ROAD. (COOL SPRINGS INDUSTRIAL DRIVE EXTENSION)

COOL SPRINGS CONNECTOR ROAD IMPROVEMENTS (SEE PLANS)

STORM SEWER RELOCATION AND LIMITS OF CONSTRUCTION

SCALE: 1" = 20'

GRAPHIC SCALE

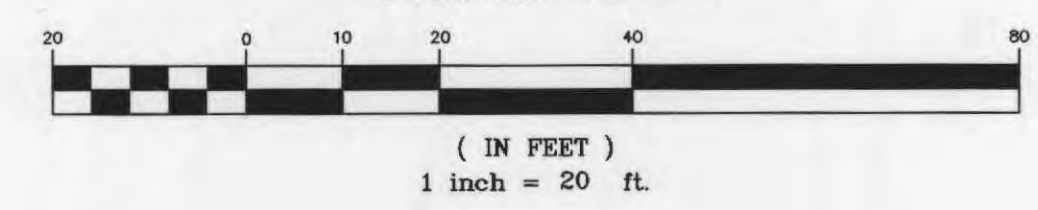

(IN FEET)
1 inch = 20 ft.