

T.R. HUGHES BOULEVARD

ROADWAY SECTIONS MODIFICATION

CITY OF O'FALLON
COMMUNITY DEVELOPMENT
DESIGN DIVISION
O'FALLON, MISSOURI



DISCLAIMER OF RESPONSIBILITY
I HEREBY SPECIFY THAT THE DOCUMENTS INTENDED TO BE REPRODUCED BY ANY MEANS ARE LIMITED TO THIS SHEET AND I HEREBY DISCLAIM ANY RESPONSIBILITY FOR ALL OTHER DRAWINGS, SPECIFICATIONS, ESTIMATES, REPORTS OR OTHER DOCUMENTS OR INSTRUMENTS RELATING TO OR INTENDED TO BE USED FOR ANY PART OR PARTS OF THE ARCHITECTURAL OR ENGINEERING PROJECT OR SURVEY.

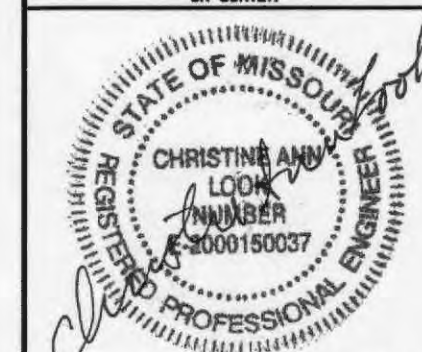

2-13-03
SEAL

DESIGNED: CEM
CHECKED: CAL
DATE: 02/13/03
PROJECT NO.: 01-064

SHEET
6 OF 14

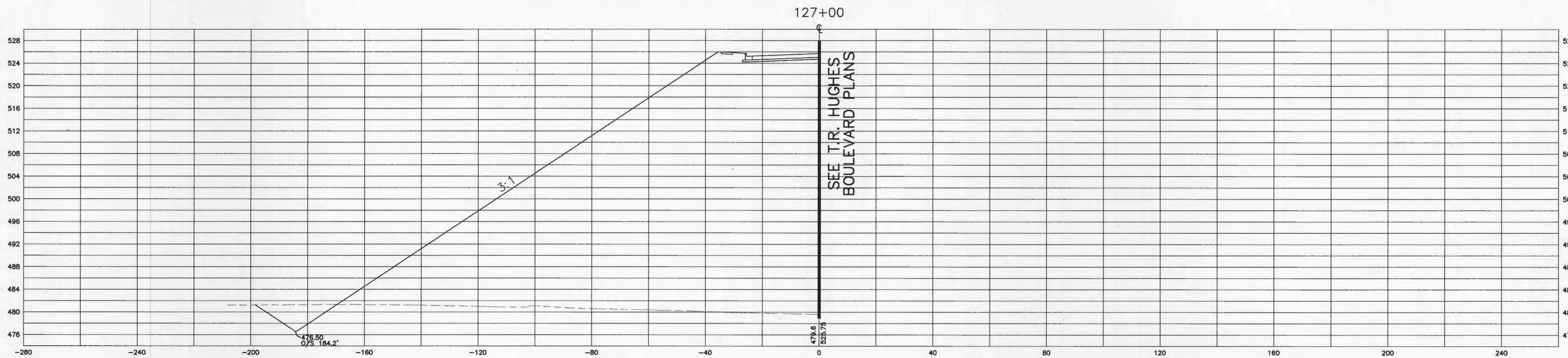
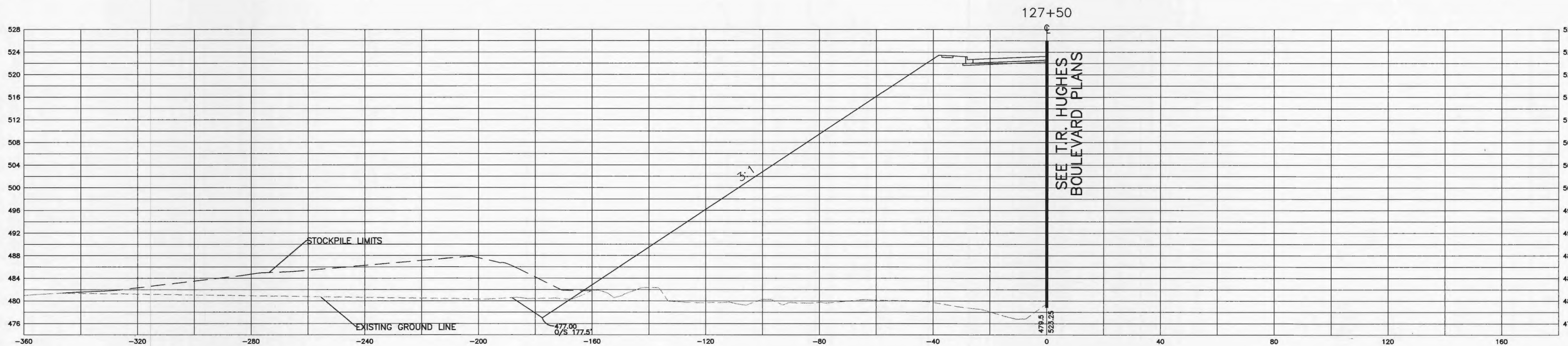
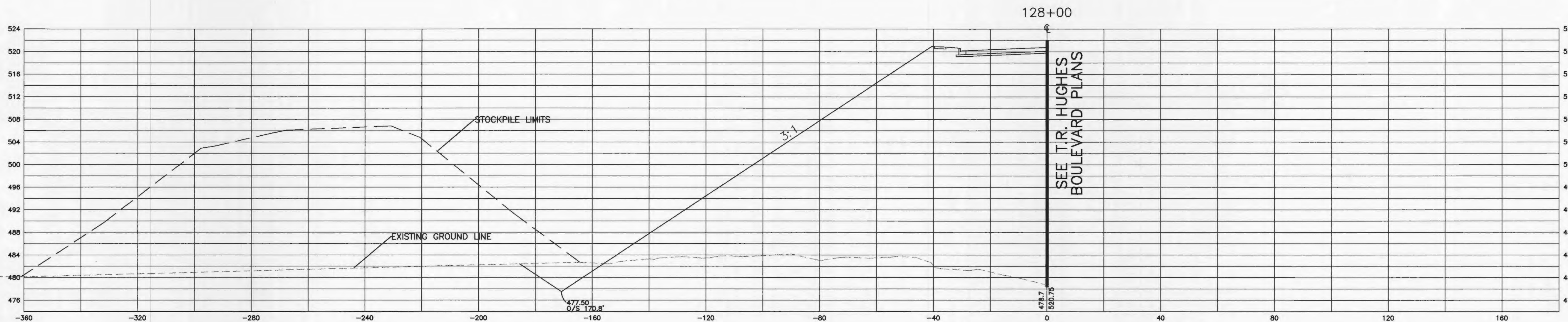

NOTE: EXISTING GRADE IS SHOWN EXCEPT WHERE NOTED OTHERWISE.

1"=10'
1"=20'