

GBA GEORGE BUTLER ASSOCIATES, INC. Engineers - Architects Kansas • Missouri • Illinois	DATE: APRIL, 2003
	DESIGN BY: DTS
	DRAWN BY: TMW
PROJECT NO.: 10081	SHEET NO.: 7
TRAFFIC SIGNAL MODIFICATION T.R. HUGHES AND WIDEL LANE O'FALLON, MISSOURI	
	TOTAL SHEETS: 7

WIRING DIAGRAM

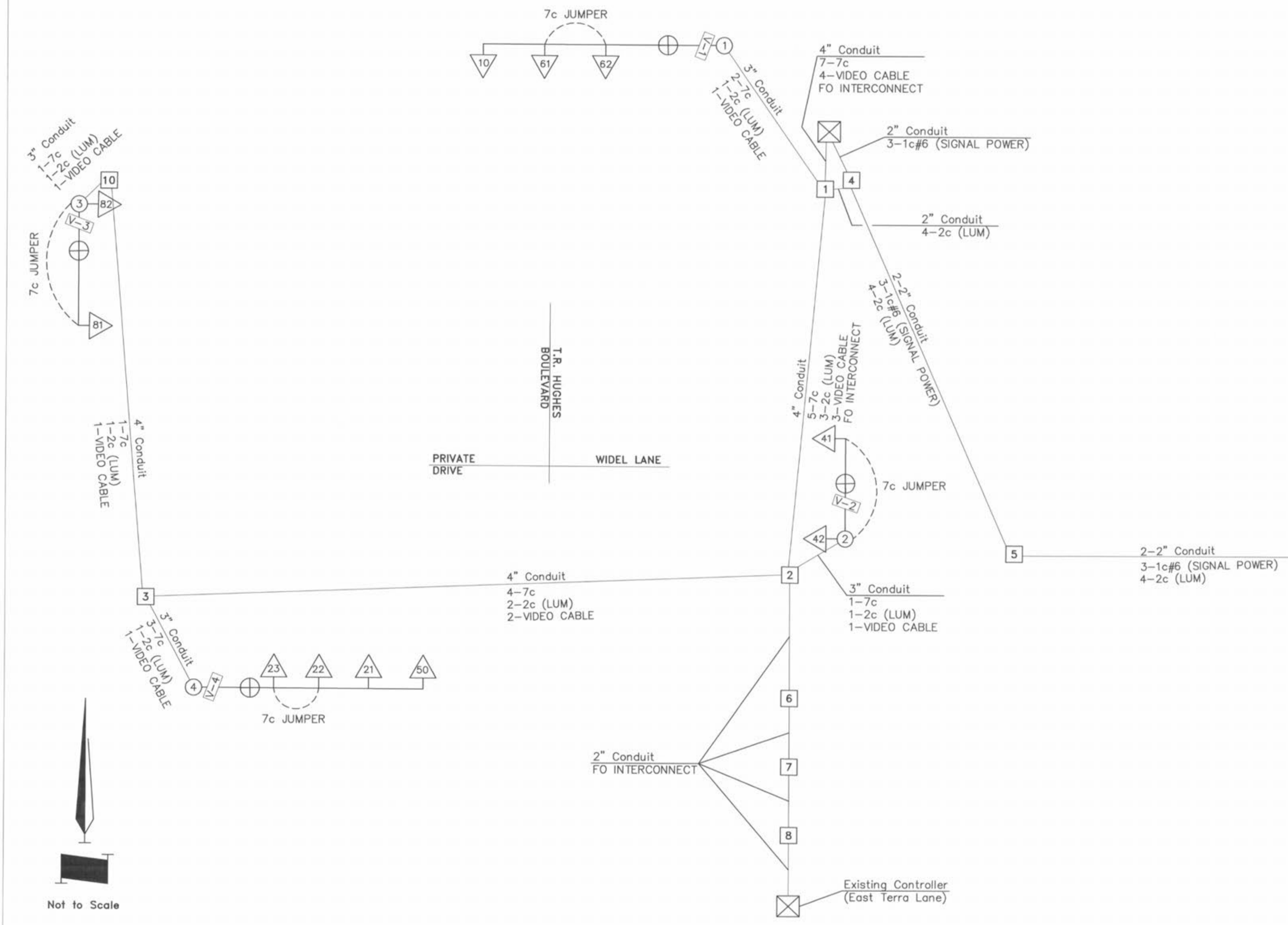

LEGEND

- 3" — CONDUIT CONTAINING CABLE WITH SIZE
- CABLE
- X-Xc MULTI-CONDUCTOR CABLE #12 AWG (UNLESS OTHERWISE INDICATED)
- LIC #14 AWG DETECTOR LEAD-IN CABLE (2C TWISTED SHIELDED)
- [X] PULL BOX WITH NUMBER
- [X] POST WITH NUMBER
- [X] POST WITH MAST ARM
- [X] POST WITH MAST ARM AND LUMINAIRE
- [X] DETECTOR WITH NUMBER
- [X] SIGNAL HEAD WITH NUMBER
- [X] SIGNAL CONTROLLER
- [X] POWER SUPPLY
- [X] LIGHTING CONTROLLER
- [X-X] VIDEO DETECTOR



Not to Scale

