

**STORM SEWER PROFILE (AS MODIFIED)**

SCALE: 1" = 5' VERTICAL  
1" = 20' HORIZONTAL

**NOTE:**  
Underground utilities have been plotted from available information and therefore their locations shall be considered approximate only. The verification of the location of all underground utilities, either shown or not shown on these plans shall be the responsibility of the contractor, and shall be located prior to any grading or construction of the improvements.

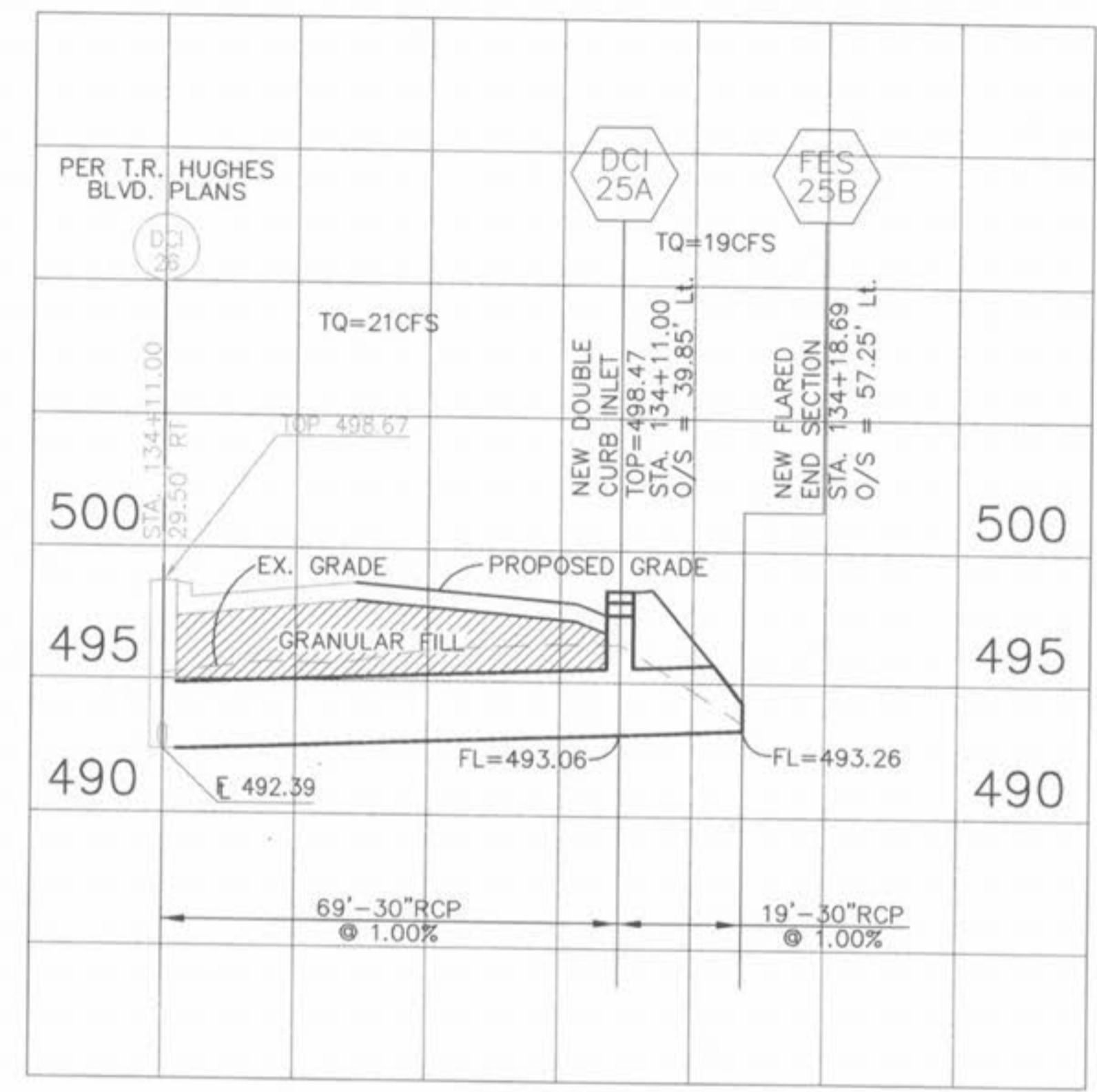

**STORM SEWER PROFILE**

SCALE: 1" = 5' VERTICAL  
1" = 20' HORIZONTAL

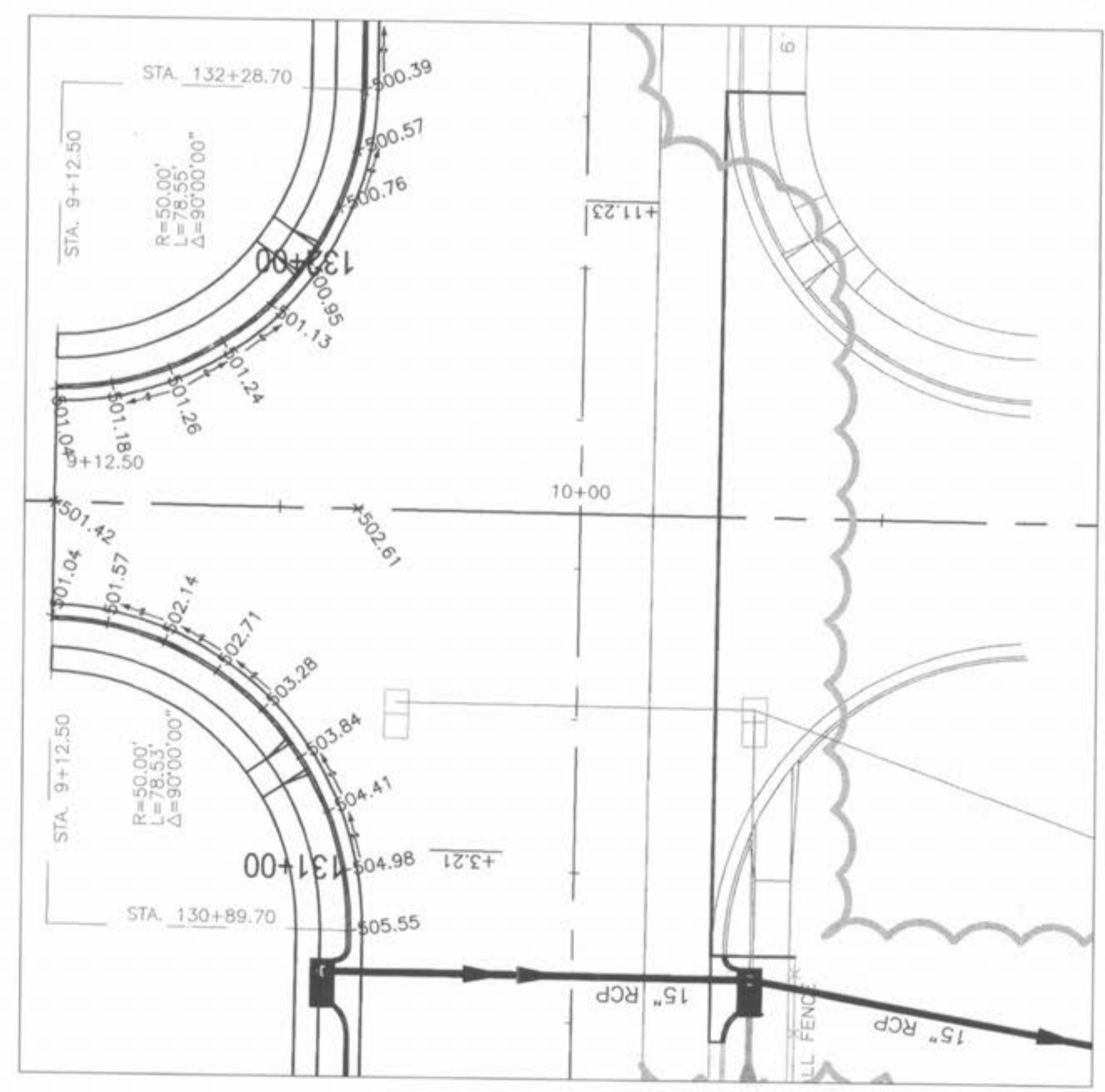

**INTERSECTION WARPING PLAN**

SCALE: 1" = 20'

**T.R. HUGHES BOULEVARD**

MODIFICATION

**CITY OF O'FALLON  
COMMUNITY DEVELOPMENT  
DESIGN DIVISION  
O'FALLON, MISSOURI**



**DISCLAIMER OF RESPONSIBILITY**  
I HEREBY CERTIFY THAT THE DOCUMENTS REFERRED TO IN THIS SHEET AND HERETOFORE ARE LIMITED TO THE DESIGN AND CONSTRUCTION OF THE PROJECT DESCRIBED HEREIN. I AM NOT RESPONSIBLE FOR ANY OTHER DOCUMENTS OR INSTRUMENTS RELATING TO OR REFERRED TO IN THIS SHEET OR ANY PART OF THE ARCHITECTURAL OR ENGINEERING PROJECT OR SHEET.

STATE OF MISSOURI  
REGISTERED PROFESSIONAL ENGINEER  
CHRISTINE ANN LUCK  
NUMBER E-2000180003  
2/15/03  
SEAL

DESIGNED: CEM  
CHECKED: CAL  
DATE: 02/25/02  
PROJECT NO.: 00-000