

PARKING LOTS FOR THE T.R. HUGHES STADIUM
DIMENSION PLAN

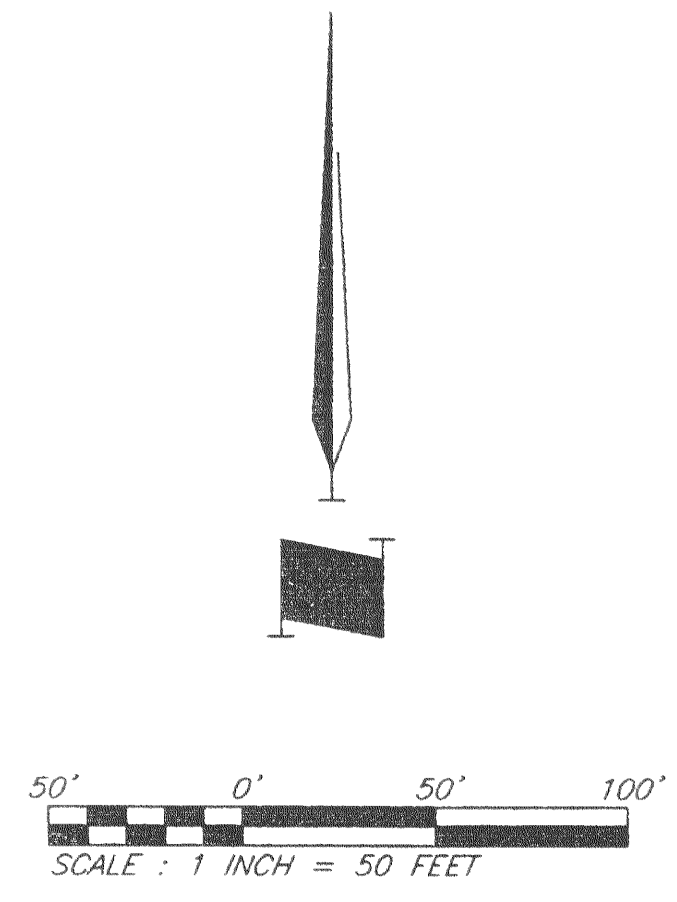

- NOTES**
1. DIMENSIONS SHOWN ARE TO BACK OF CURB
 2. ALL CURB RADII ARE TO THE INSIDE FACE.
 3. ALL CURB RAMP MUST MEET A.D.A. REQUIREMENTS.

TEMPORARY BENCHMARKS

GBA W.P. #7
 1/2" I.B. W/GBA CAP 21'+/- N. OF CENTERLINE OF TOM GINNEVER AVE., 61'+/- E. OF CENTERLINE OF TOM GINNEVER AVE. & CLOVER LN.
 ELEVATION: 503.72
 NORTHING: 1088241.950
 EASTING: 767384.5866

GBA W.P. #8
 1/2" I.B. W/GBA CAP 23'+/- S. OF CENTERLINE OF TOM GINNEVER AVE., 26'+/- N. OF ORANGE FENCE POST, 1269.09' E. OF W.P. #7
 ELEVATION: 502.11
 NORTHING: 1088177.026
 EASTING: 768652.0279

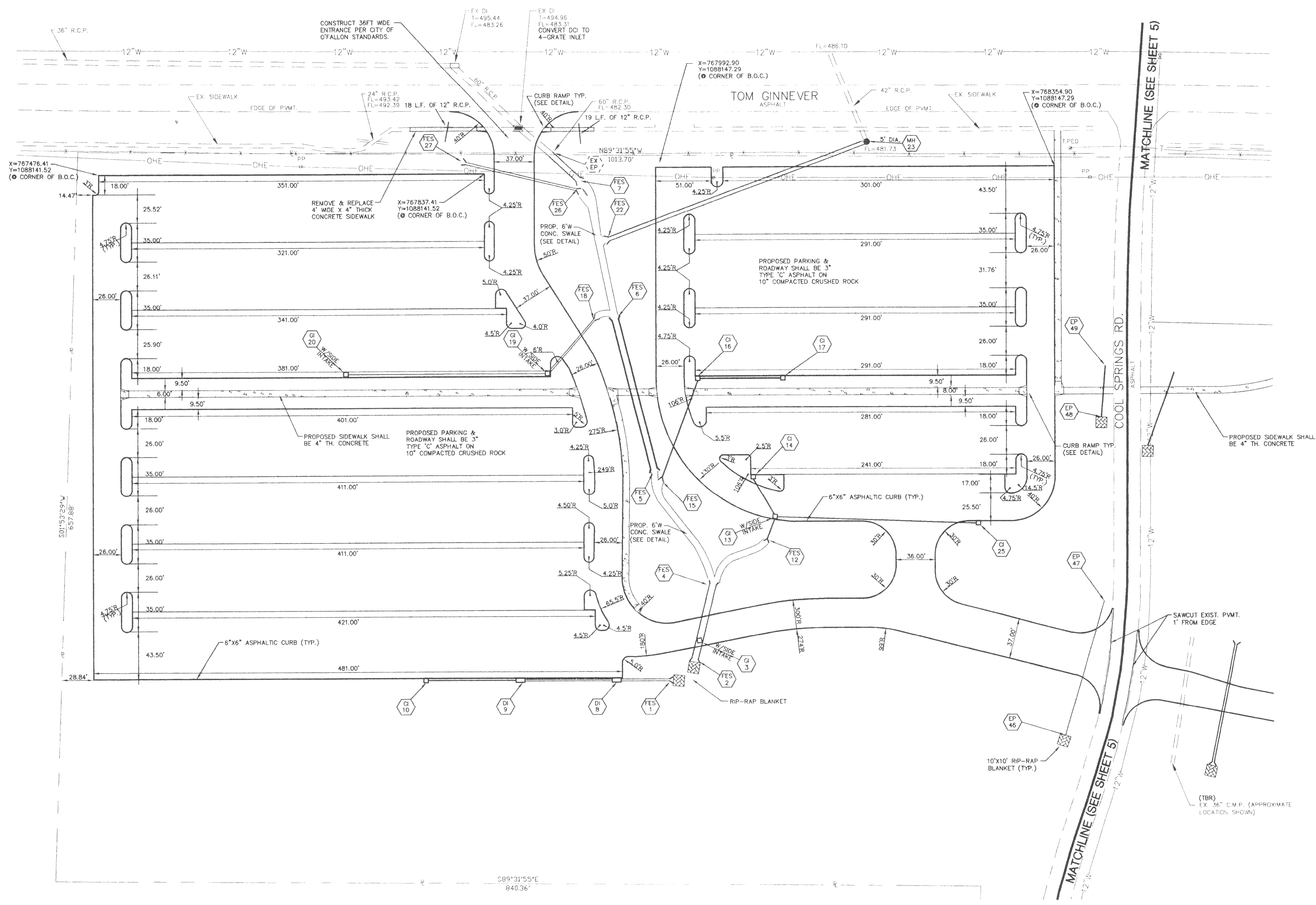

NOTE: THIS BID PACKAGE CONSISTS OF GRADING, SILTATION CONTROL, STORM SEWERS, AND ASSOCIATED WORK AS SHOWN AND/OR SPECIFIED. PAVEMENT, SIDEWALKS, ASPHALTIC CURB, SEED AND MULCH, HANDICAP SIGNS, STRIPING AND ASSOCIATED WORK AS SHOWN AND/OR SPECIFIED SHALL BE "ADDITIVE ALTERNATES" AND ARE TO BE CONSTRUCTED UNDER THIS CONTRACT IF AWARDED BY THE CITY OF O'FALLON. "ADDITIVE ALTERNATES" ARE NOT TO BE INCLUDED IN THE BASE BID FOR THIS CONTRACT.