

USER: Matt Stueber TAB: W1.2 RETAINING WALL PLAN  
 DATE: June 17, 2022 - 7:32:54 AM  
 DRAWING: S:\JOBS\Job2021\21-0154\CAD\Drawings\Plan\RetainingWall\W1.2.dwg

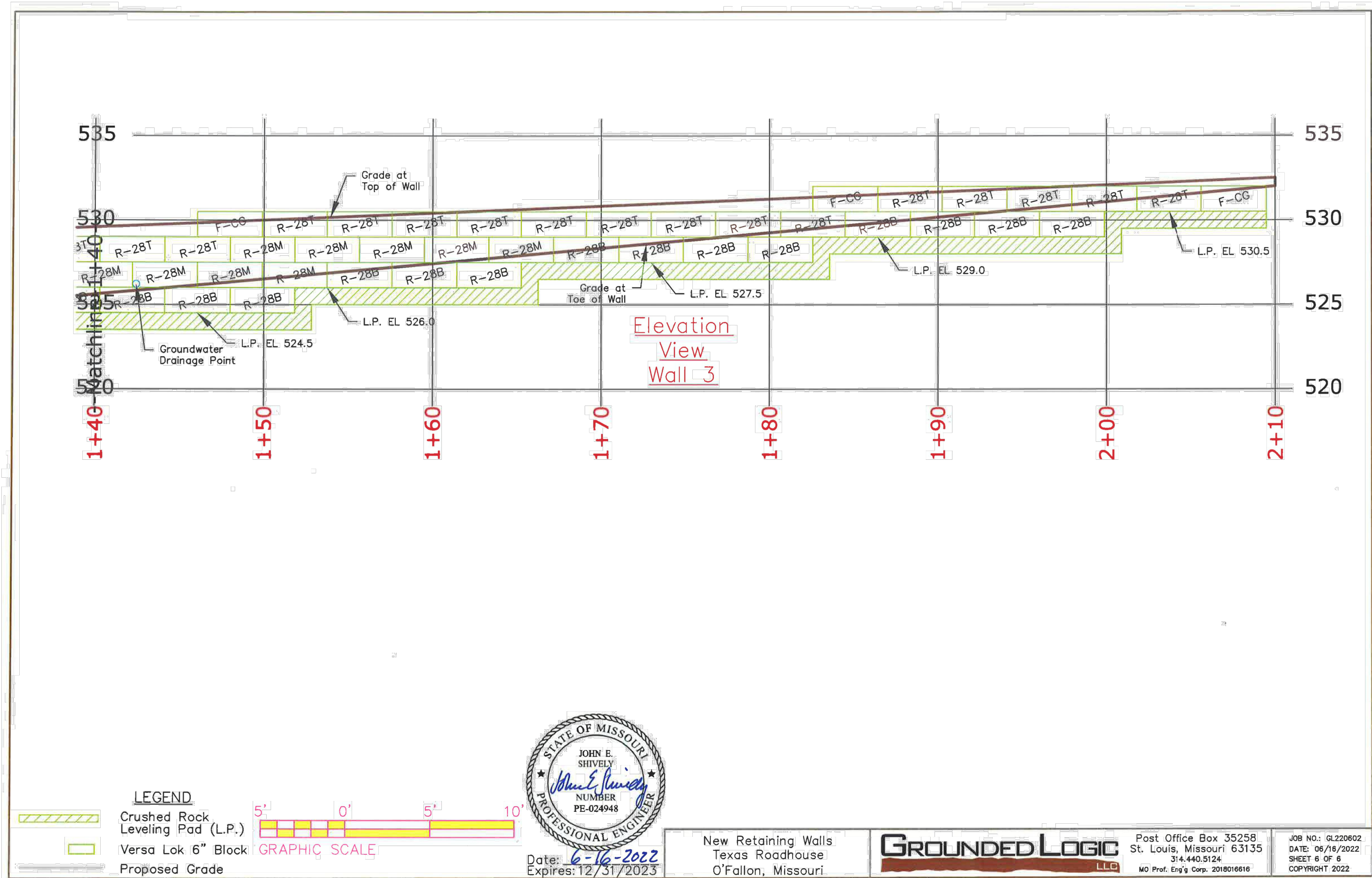
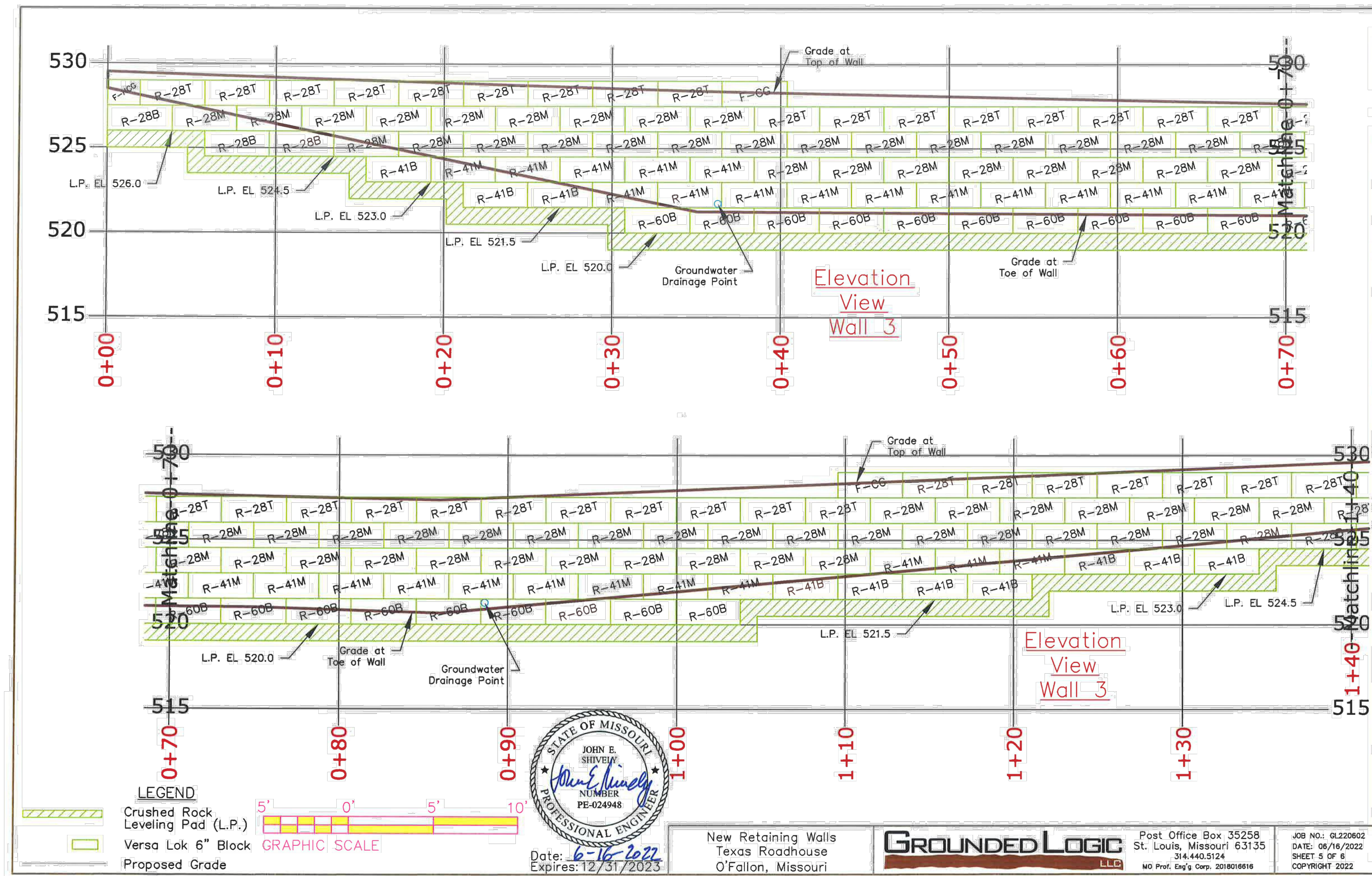

NO	DATE	REVISION DESCRIPTION
3	06/17/2022	CITY REVIEW COMMENTS #2

DEVELOPER/OWNER:  
**MOHR CAPITAL LLC**  
 14643 DALLAS PARKWAY SUITE 1000  
 DALLAS, TX 75254  
 (214) 801-9860

THE PROFESSIONAL WHOSE SIGNATURE AND PERSONAL SEAL APPEAR HEREON IS A LICENSED PROFESSIONAL ENGINEER IN THE STATE OF MISSOURI. HIS/HER SERVICES ARE LIMITED TO THE PROJECT AND DATE OF DESIGN. ANY OTHER DOCUMENTS OR INSTRUMENTS NOT SPECIFICALLY REFERENCED IN THESE PLANS ARE NOT PART OF THESE PLANS. FOR ANY PART OF THE PROJECT TO WHICH THIS SEAL APPLIES, THE USER SHALL BE RESPONSIBLE FOR OBTAINING ALL NECESSARY PERMITS AND APPROVALS FROM THE APPROPRIATE AGENCIES AND AUTHORITIES.

TEXAS ROADHOUSE  
 IMPROVEMENT PLANS

MEXICO ROAD  
 O'FALLON, MO 63368

RETAINING WALL PLAN

+ ST. CHARLES  
 300 5th Street  
 St. Charles, MO 63303  
 636.978.7508 tel  
 www.colerchicago.com

**COLE**  
 CIVIL ENGINEERING / SURVEYING / PLANNING / LANDSCAPE ARCHITECTURE  
 Civil & Architectural, Inc. is a Missouri Government Sub. Civil Design Group, Inc. is a Missouri & Texas Partner registered as a "sole"

DESIGN/CALC BY: JOHN SHIVELY  
 DRAWN BY: JOHN SHIVELY  
 CHECKED BY: JOHN SHIVELY  
 DRAWING SCALE: AS SHOWN  
 DATE: 06/17/2022  
 Job Number: 21-0154  
 Sheet Number: W1.2