

DETAILS SHOWN WITHIN AREA ARE TO BE USED ONSITE WITHIN THE HEAVY DUTY PAVEMENT SECTIONS AT THE DUMPSTER AREA AND UNDER THE ALTERNATE PAVING SECTION IN LIEU OF ASPHALT ONSITE. ALL LANDING CIRCLE CONSTRUCTION METHODS ARE TO FOLLOW CITY DETAILS AS OUTLINED ON SHEETS 20, AND 21.

DOWEL BARS—EPOXY COATED		
PAVEMENT THICKNESS	BAR SIZE	LENGTH
6"	1"	18"

- Do not scale drawing. Follow dimensions.
- The dowel supporting units shall be factory assembled and capable of holding the dowels in their required positions. In the completed joint installation, no dowels shall vary from its required position more than 1 in 36.
- The dowel bar spacing shall be 12 inches on centers, beginning 6 inches from outer edge of the pavement.
- Tie wires, bars, or clips used to strengthen dowel basket assemblies for shipment and installation shall be removed or cut prior to placing concrete.
- Staking pins shall be fabricated from Oga. (0.3065) wire minimum with suitable hook. Staking pins shall have a length of 18 inches Type A and Type B Assemblies unless otherwise directed by the engineer.
- Wires, bars, or clips shall be used as necessary to strengthen the assemblies.
- Minor variations in the configuration of the support units will be allowed.
- The wire end of each epoxy coated dowel shall be marked with a spot of paint at least one inch in diameter and contrasting in color with the epoxy coating.
- The free end of the dowel bar for a length of at least 11 inches shall be coated with an approved graphite grease.

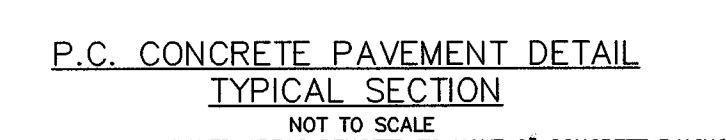

- GENERAL NOTES:**
- TYPE "G" TRANSVERSE JOINT IS REQUIRED ON ALL CONCRETE PAVEMENT FOR PROJECT.
  - ALL DEFORMED BARS FOR JOINTS SHALL BE BILLET STEEL BARS CONFORMING TO A.S.T.M. 615-75 GRADE 40.
  - TRANSVERSE OR LONGITUDINAL CONSTRUCTION JOINTS IN SLIP FORMED PAVEMENTS MAY BE MADE WITH A GROOVER OR TOOL.
  - THE FREE END OF THE DOWEL BAR FOR A LENGTH OF AT LEAST 11 INCHES SHALL BE COATED WITH AN APPROVED GRAPHITE GREASE (TYPE D AND G JOINTS).
  - ALL SMOOTH DOWEL BARS SHALL BE EPOXY COATED.
  - THE DOWEL SUPPORTING UNITS SHALL BE FACTORY ASSEMBLED AND CAPABLE OF HOLDING THE DOWELS IN THEIR REQUIRED POSITIONS. IN THE COMPLETED JOINT INSTALLATION, NO DOWELS SHALL VARY FROM ITS REQUIRED POSITION MORE THAN 1 IN 36.
  - THE DOWEL BAR SPACING SHALL BE 12 INCHES ON CENTERS, BEGINNING 6 INCHES FROM OUTER EDGE OF THE PAVEMENT.
  - THE WIRES, BARS, OR CLIPS USED TO STRENGTHEN DOWEL BASKET ASSEMBLIES FOR SHIPMENT AND INSTALLATION SHALL BE REMOVED OR CUT PRIOR TO PLACING CONCRETE.
  - STAKING PINS SHALL BE FABRICATED FROM O GA. (0.3065) WIRE MINIMUM WITH SUITABLE HOOK. STAKING PINS SHALL HAVE A LENGTH OF 18 INCHES.
  - WIRES, BARS OR CLIPS SHALL BE USED AS NECESSARY TO STRENGTHEN THE ASSEMBLIES.
  - ALL SPOT ELEVATIONS ARE TO THE TOP OF FINISH PAVEMENT OR GRADE.

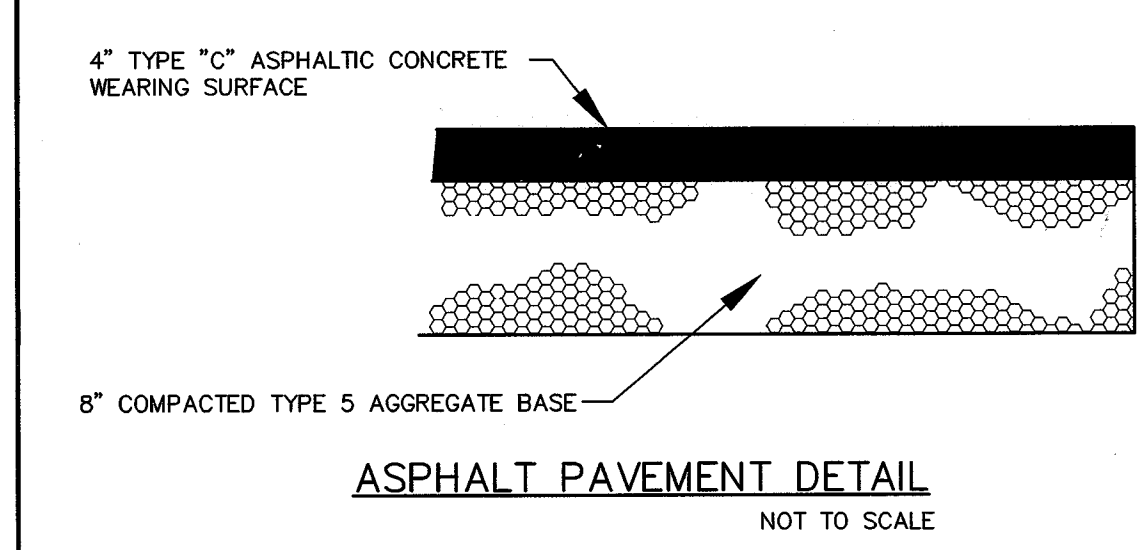
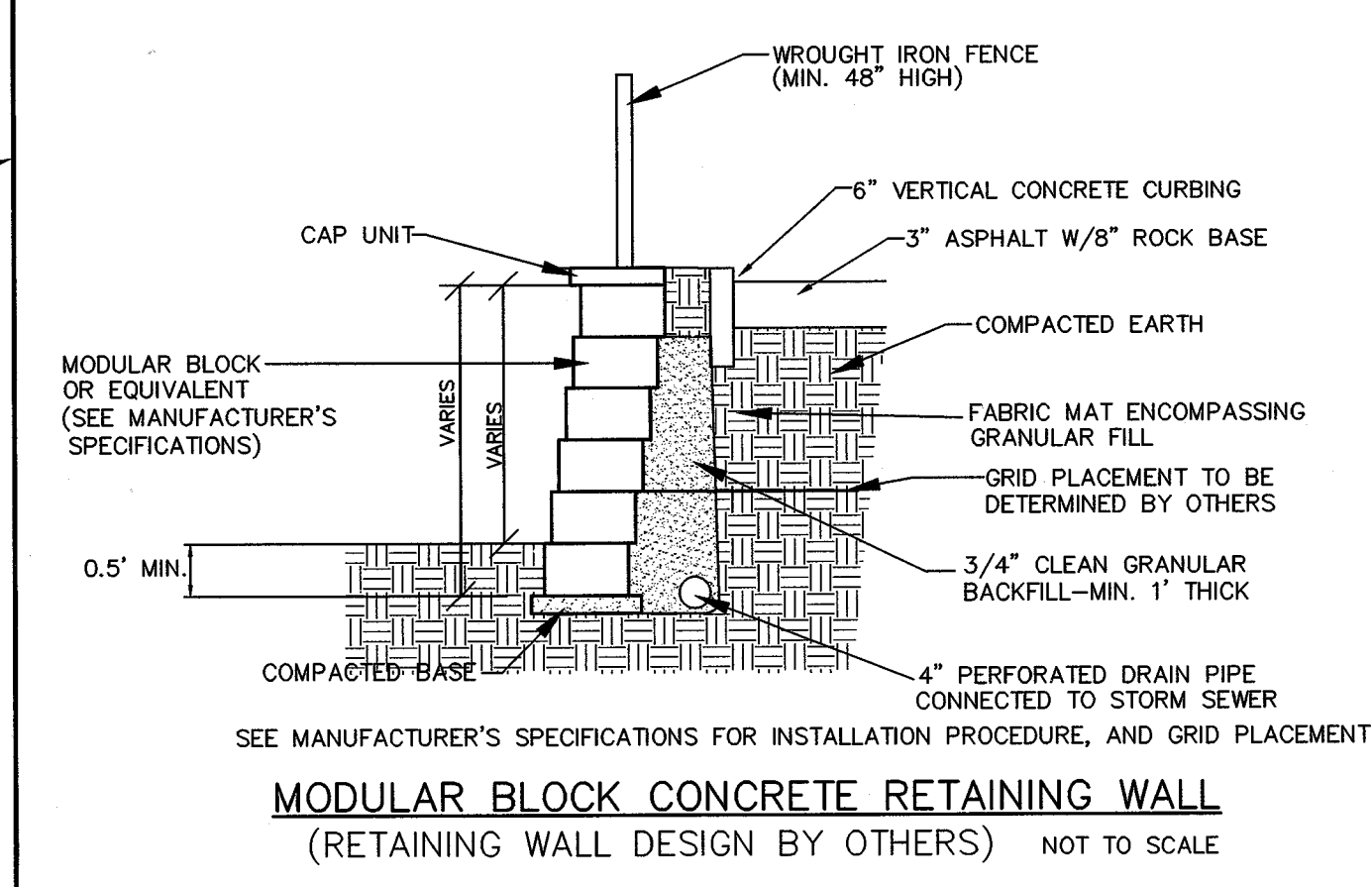

- THE ASPHALT SURFACE SHALL BE COMPACTED TO 98% MAXIMUM DENSITY.
- ALL GRANULAR ROLLED STONE BASE UNDER PROPOSED CONCRETE MUST BE COMPACTED TO 100% OF THE MAXIMUM DENSITY AS DETERMINED BY THE STANDARD PROCTOR TEST AASHTO T-99.

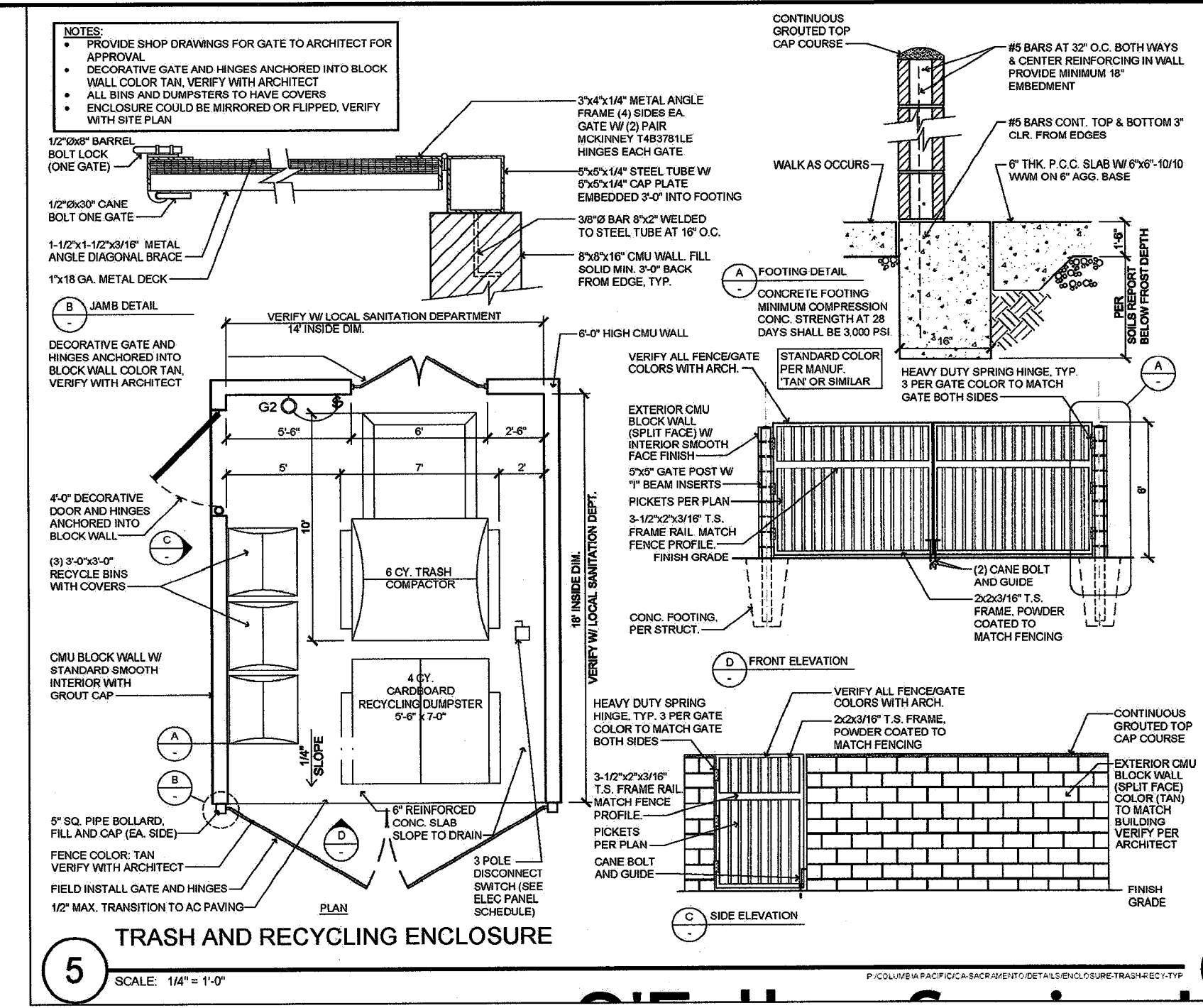
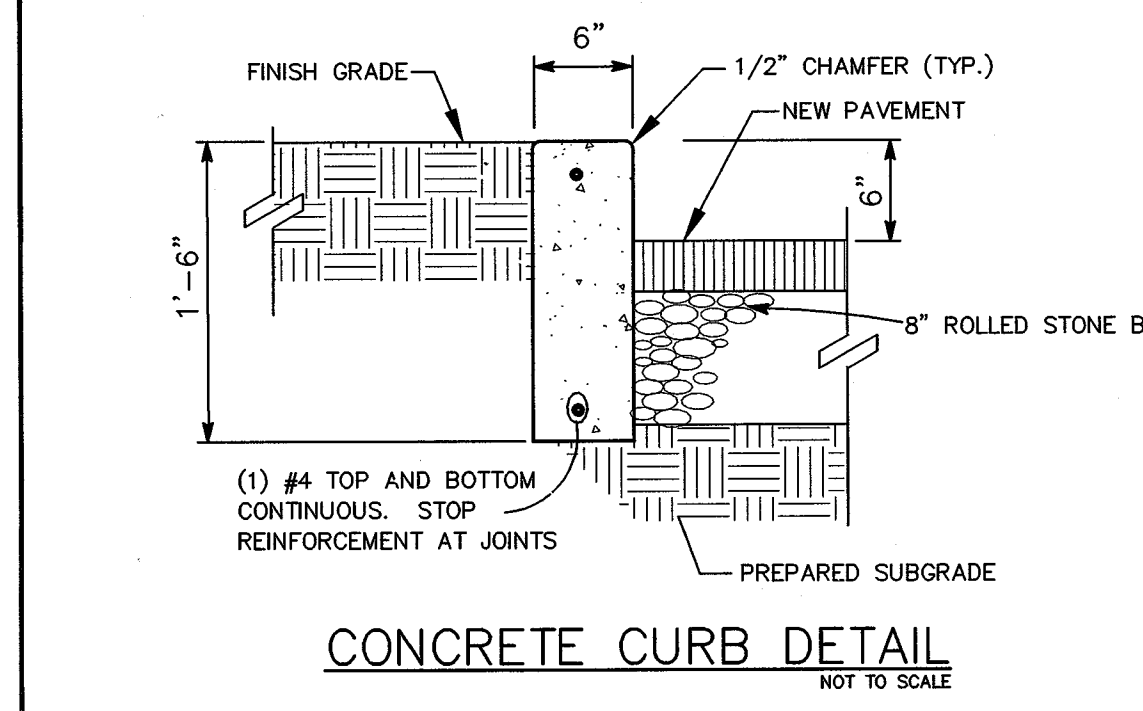

REFER TO ARCHITECTURAL PLANS AND SPECS

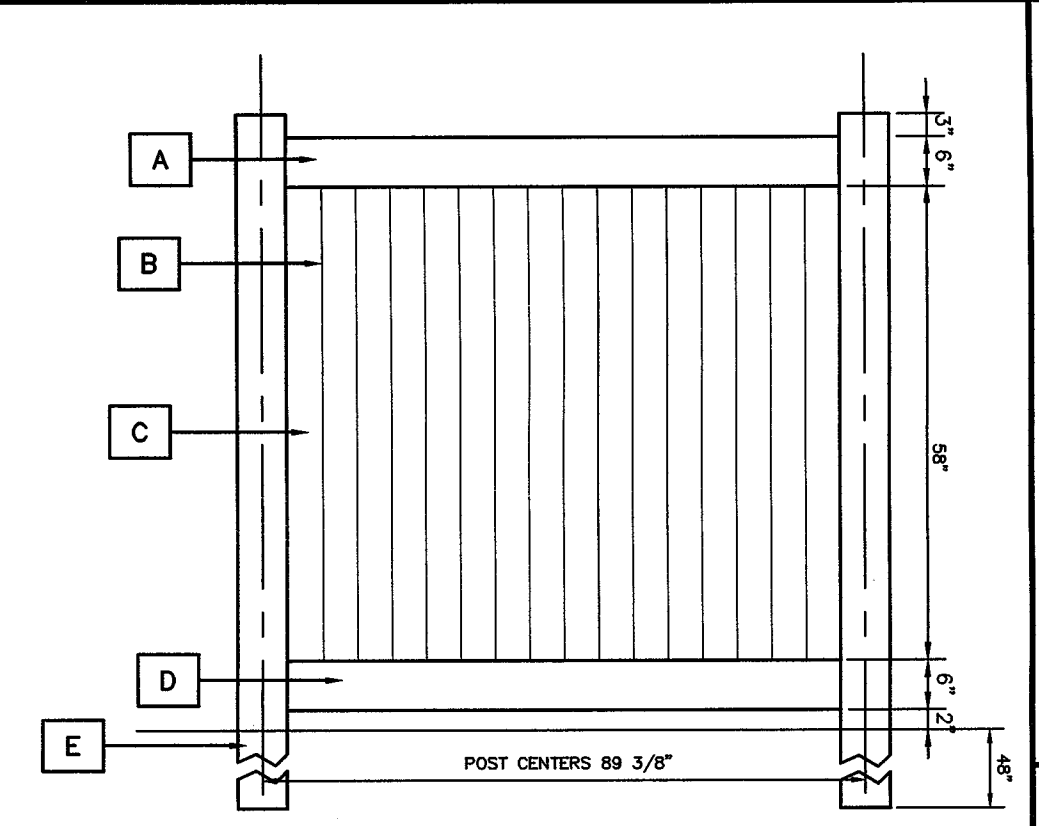
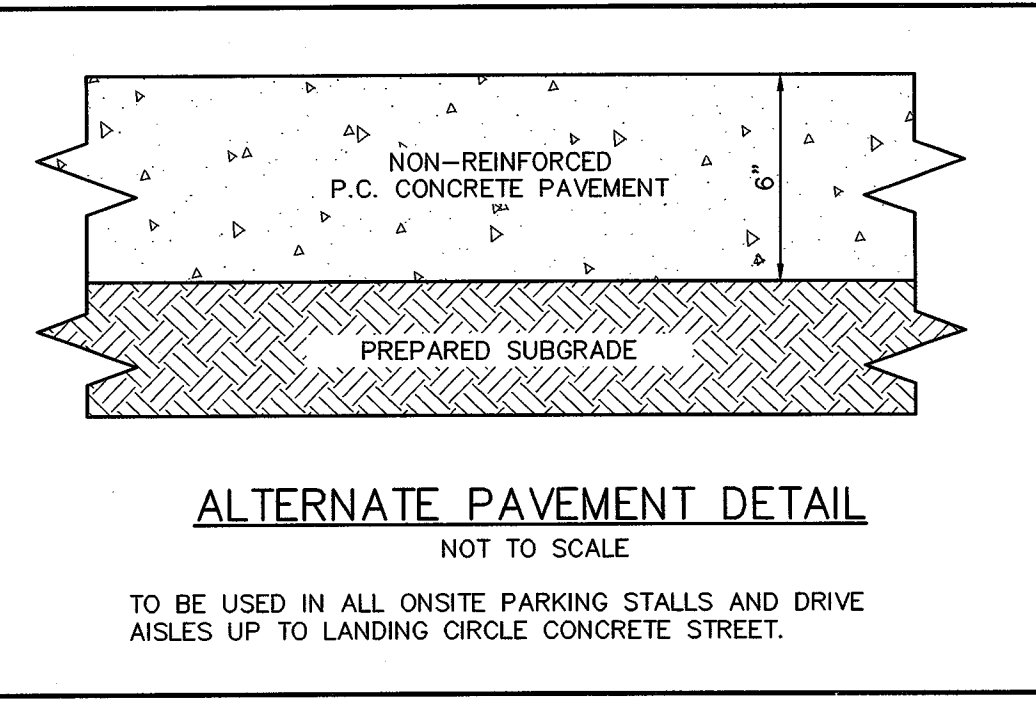
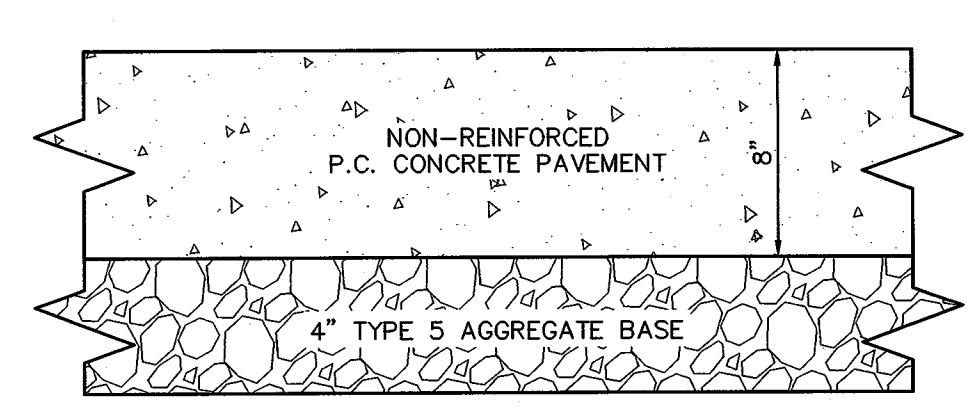
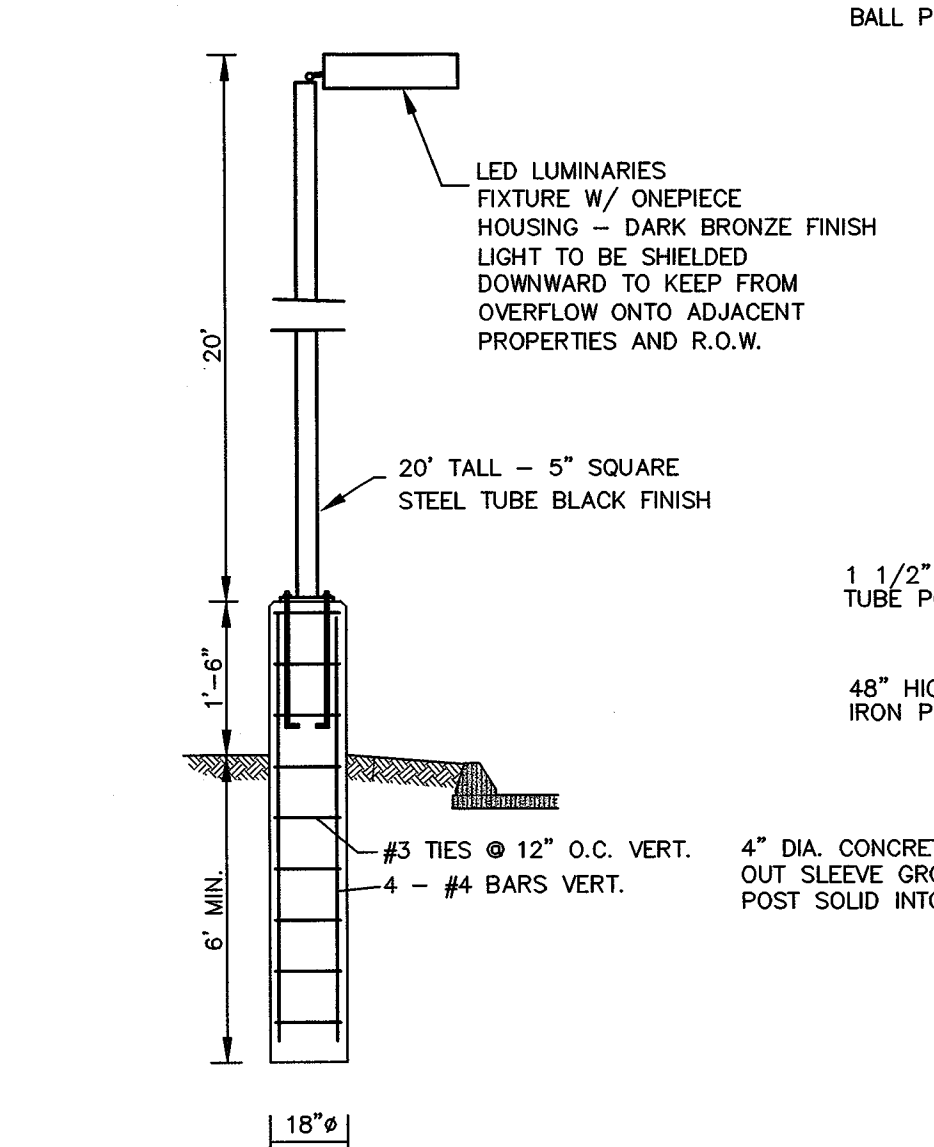

- TOP RAIL: 2" X 6" X 98" RIBBED CHANNELLED TO ACCEPT PICKETS INCLUDES REINFORCING CHANNEL
- PICKET SPACING: NONE
- PICKETS: 28 PIECES OF 7/8" X 6" X 30-1/2"
- BOTTOM RAIL: 2" X 6" X 98" RIBBED CHANNELLED TO ACCEPT PICKETS INCLUDES REINFORCING CHANNEL
- POST: 5 1/2" X 1 1/2" FOR IN GROUND INSTALLATION 5" X 6" X 84" FOR ABOVE GROUND INSTALLATION

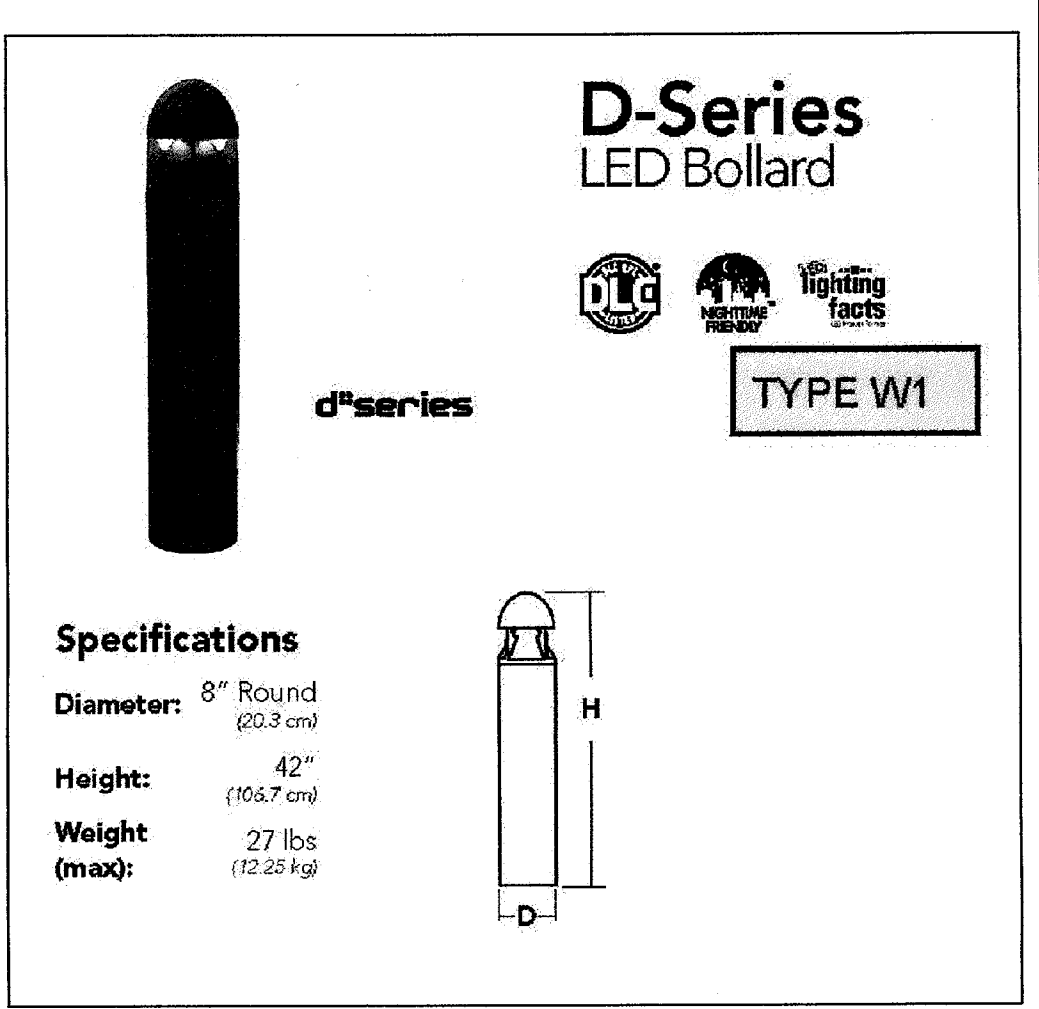
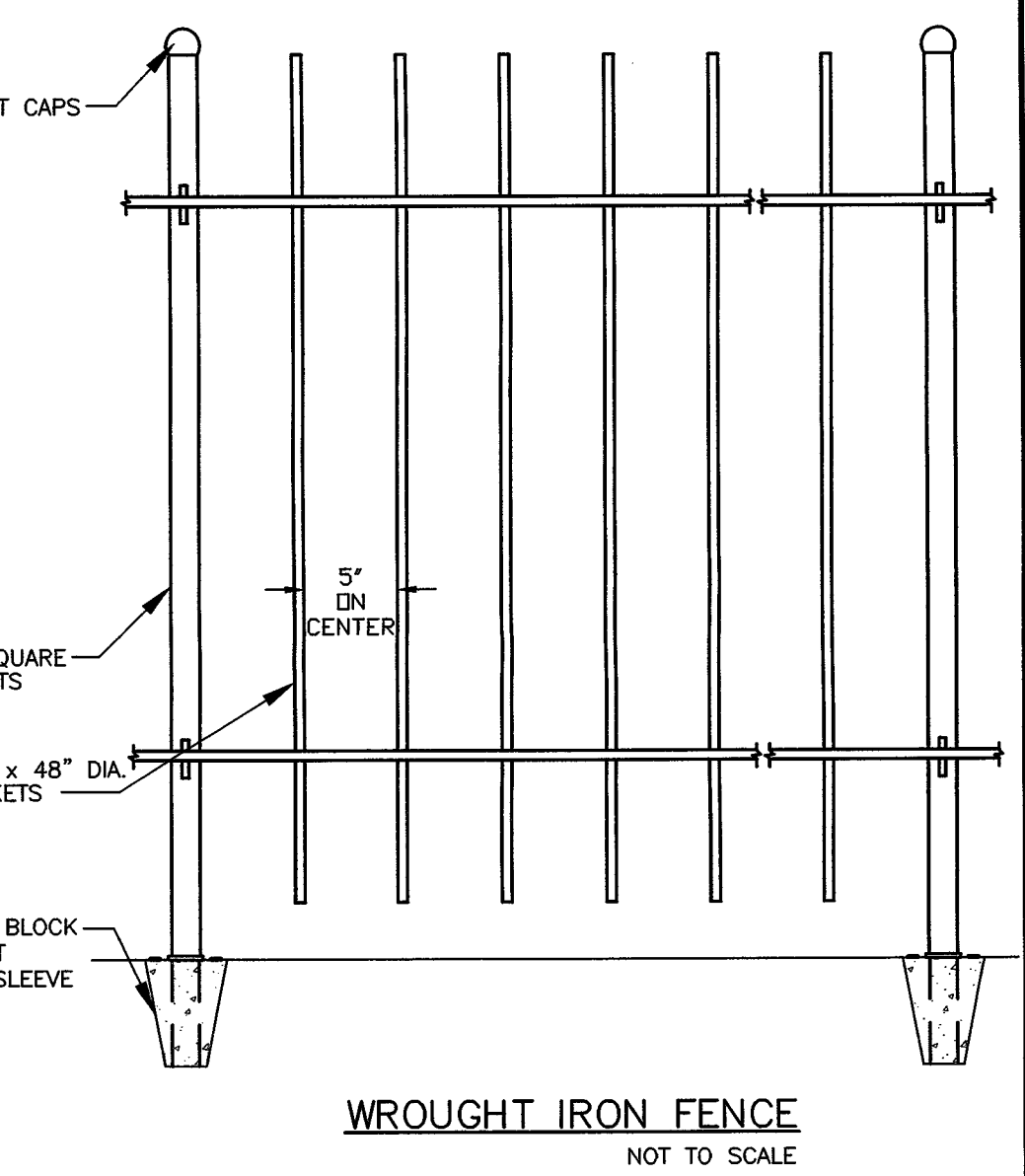

**LED BOLLARD LIGHT**  
NOT TO SCALE  
REFER TO ELECTRICAL PLANS AND SPECS

**PROJECT TITLE:**  
THE LANDING OF OFALLON

**ENGINEERING PLANNING SURVEYING**  
221 Point West Blvd.  
St. Charles, MO 63301  
636-928-5562  
FAX 928-1718

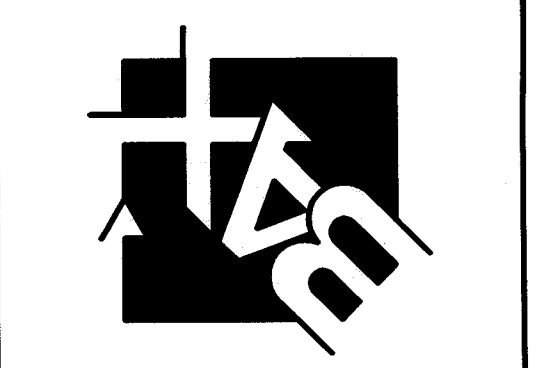

**DISCLAIMER OF RESPONSIBILITY:**  
I hereby specify that the documents intended to be authorized by my seal are limited to this sheet, and I hereby disclaim any responsibility for all other Drawings, Specifications, Estimates, Reports or other documents or instruments relating to or intended to be used for any part or parts of the architectural or engineering project or survey.

**REVISIONS**

10-14-16	CITY COMMENTS
10-24-16	CITY COMMENTS

**Developer / Owner:**  
LENTY ARCHITECTURE  
3150 KETTLE COURT SE  
SALEM, OREGON 97301  
1-503-399-1090

**Site Details**

**P+Z No.**  
20-16.02

**City No.**  
16-010424

**Page No.**  
22 of 31