

\\VAULTSERVER\Civil 3d Projects\13901B OFALLON SENIOR LIVING\Construction\13901B Con.dwg, 11/2/2016 1:57:02 PM, 1:1

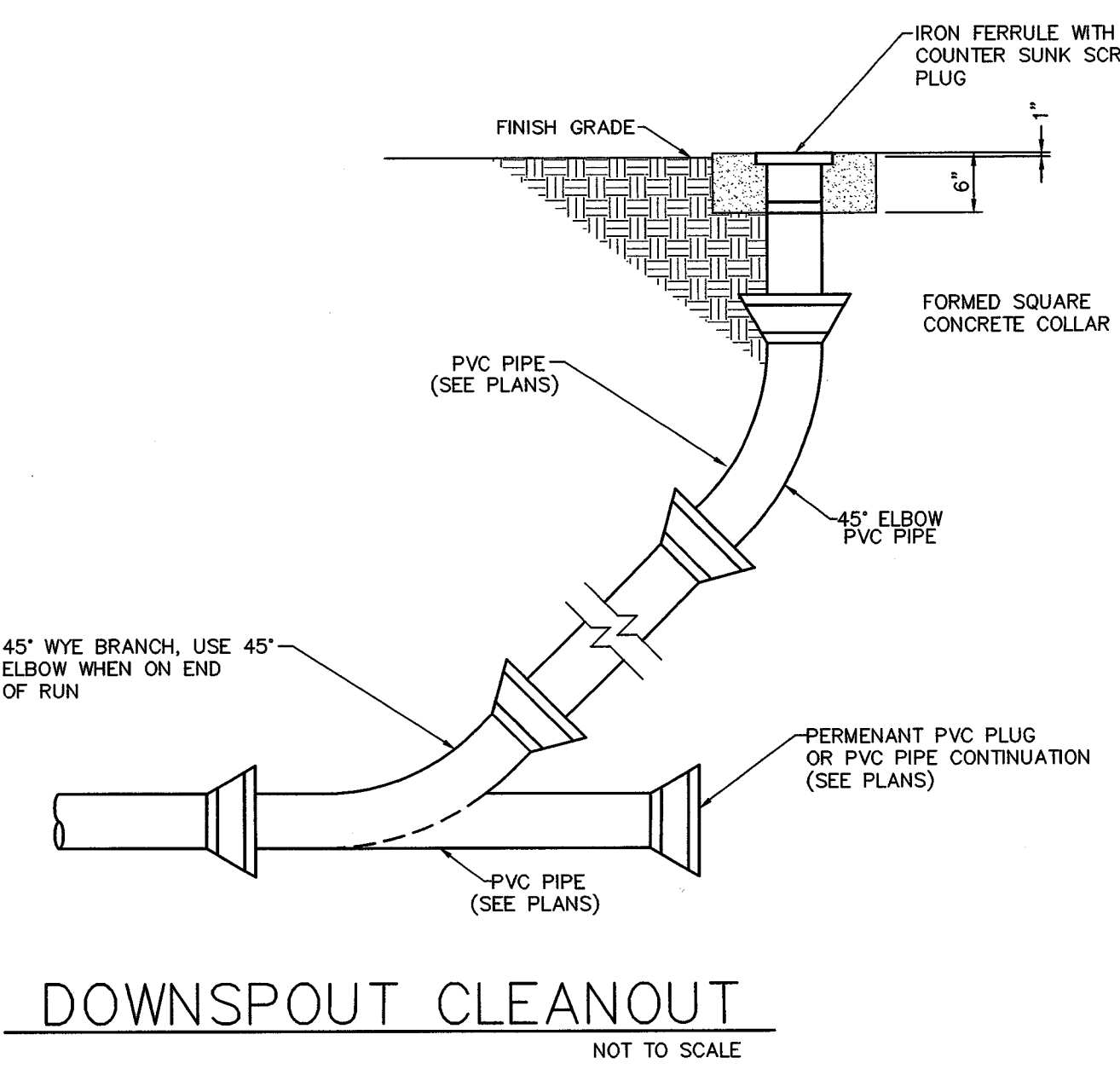

**PROJECT TITLE:**  
THE LANDING OF OFALLON

**ENGINEERING  
PLANNING  
SURVEYING**  
221 Point West Blvd.  
St. Charles, MO 63301  
636-628-6562  
FAX 636-628-1718

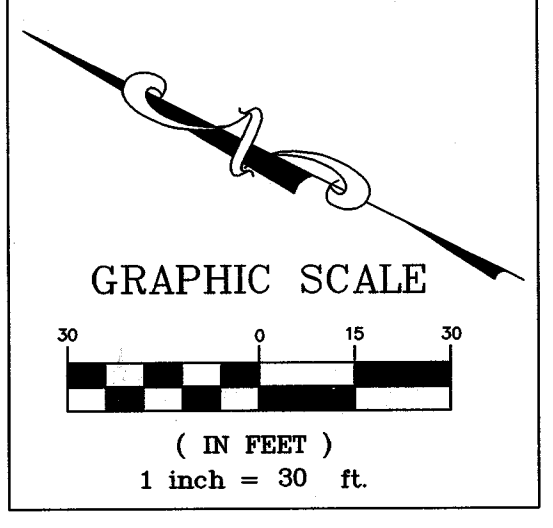
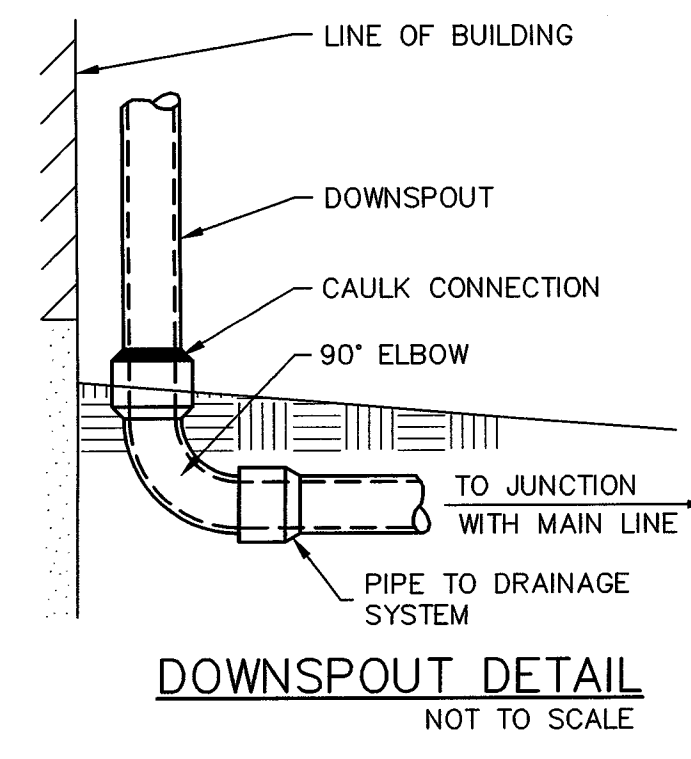
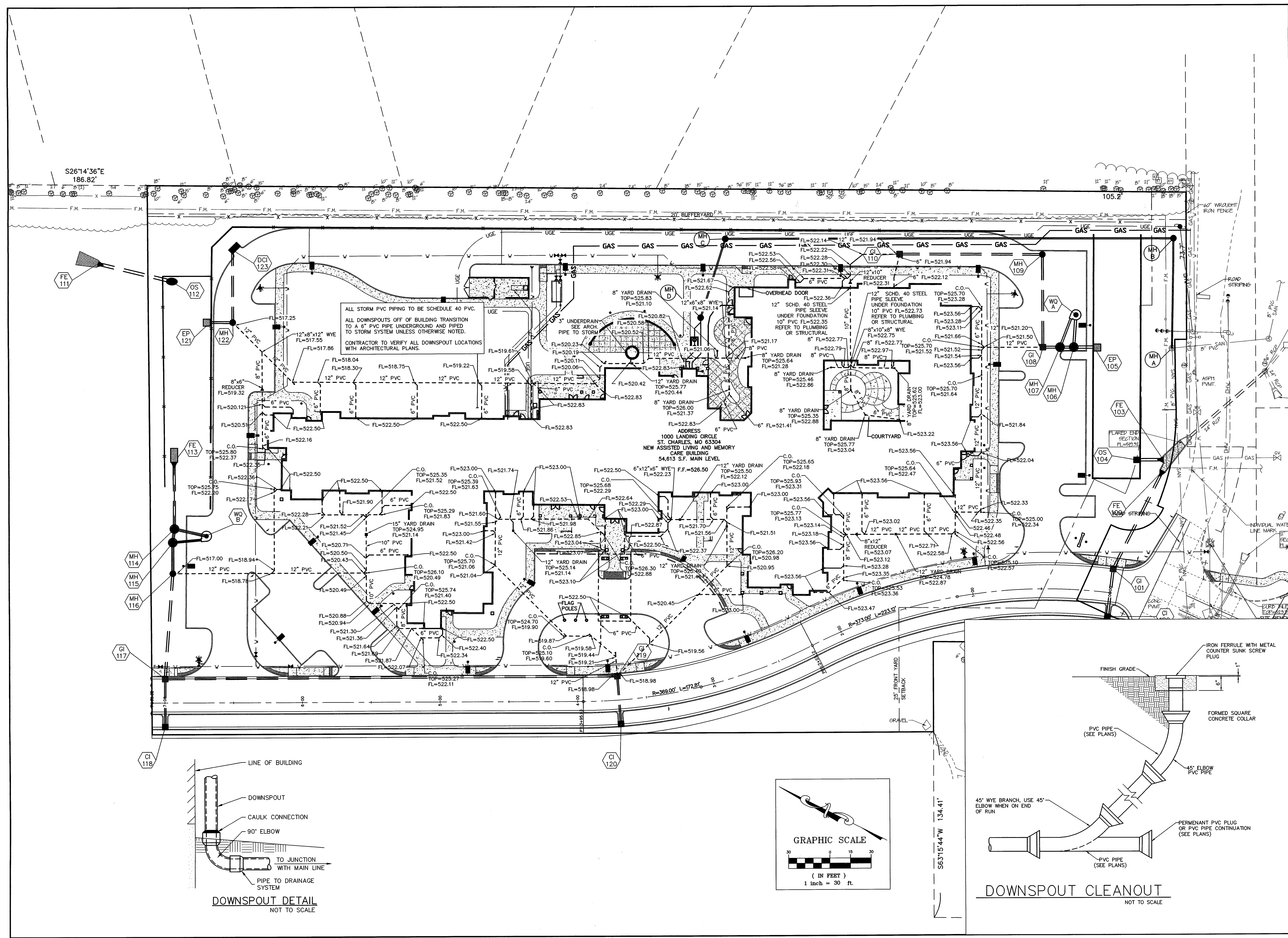
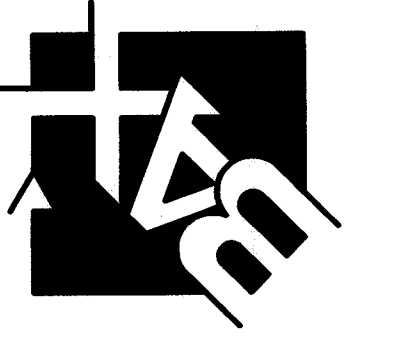

**DISCLAIMER OF RESPONSIBILITY**  
I hereby specify that the documents intended to be authorized by my seal are limited to this sheet, and I hereby disclaim any responsibility for all other drawings, specifications, estimates, reports or other documents or instruments relating to or intended to be used for any part or parts of the architectural or engineering project.

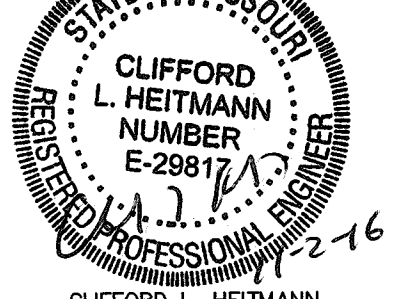

Copyright 2016  
Box Engineering Company, Inc.  
Engineering Authority No. 000655  
Surveying Authority No. 000144  
All Rights Reserved

**REVISIONS**

10-14-16	CITY COMMENTS
10-24-16	CITY COMMENTS

**Developer / Owner:**  
LENTY ARCHITECTURE  
3150 KETTLE COURT SE  
SALEM, OREGON 97301  
1-503-399-1090

**P+Z No.** 20-16.02  
**City No.** 16-010424

**Page No.**  
28 of 31

Box Project # 06-18001B Issue Date: 08/29/2016

**DOWNSPOUT DETAIL PLAN**