

Section 2722

Engineered Surface Drainage Products

GENERAL
PVC surface drainage inlets shall be of the inline drain type as indicated on the contract drawing and referenced within the contract specifications. The ductile iron grates for each of these fittings are to be considered an integral part of the surface drainage inlet and shall be furnished by the same manufacturer. The surface drainage inlets shall be as manufactured by Nyloplast a division of Advanced Drainage Systems, Inc. or prior approved equal.

MATERIALS
The inline drain required for this contract shall be manufactured from PVC pipe stock, utilizing a thermo-molding process to reform the pipe stock to the furnished configuration. The drainage pipe connection stubs shall be manufactured from PVC pipe stock and formed to provide a watertight connection with the specified pipe system. This joint tightness shall conform to ASTM D3212 for joints for drain and sewer plastic pipe using flexible elastomeric seals. The flexible elastomeric seals shall conform to ASTM F427. The pipe bell spigot shall be joined to the inline drain body by use of a swage mechanical joint. The raw material used to manufacture the pipe stock that is used to manufacture the inline drain body and pipe stubs of the surface drainage inlets shall conform to ASTM D1784 cell class 12454.

The grates furnished for all surface drainage inlets shall be ductile iron grates for sizes 8", 10", 12", 15", 18", 24" and 30" shall be made specifically for each fitting so as to provide a round bottom flange that closely matches the diameter of the surface drainage inlet. Grates for inline drains shall be hinged to the frame using pins. Metal used in the manufacture of the castings shall conform to ASTM A536 grade 70-50-05 for ductile iron. Grates shall be provided painted black.

INSTALLATION
The specified PVC surface drainage inlet shall be installed using conventional flexible pipe backfill materials and procedures. The backfill material shall be crushed stone or other granular material meeting the requirements of class 1, class 2, or class 3 material as defined in ASTM D2321. Bedding and backfill for surface drainage inlets shall be well placed and compacted uniformly in accordance with ASTM D2321. The drain basin body will be cut at the time of the final grade. No brick, stone or concrete block will be required to set the grate to the final grade height. For H-20 load rated installations, a concrete ring will be poured under and around the grate and frame. The concrete slab must be designed taking into consideration local soil conditions, traffic loading, and other applicable design factors. For other installation considerations such as migration of fines, ground water, and soft foundations refer to ASTM D2321 guidelines.

NON TRAFFIC INSTALLATION

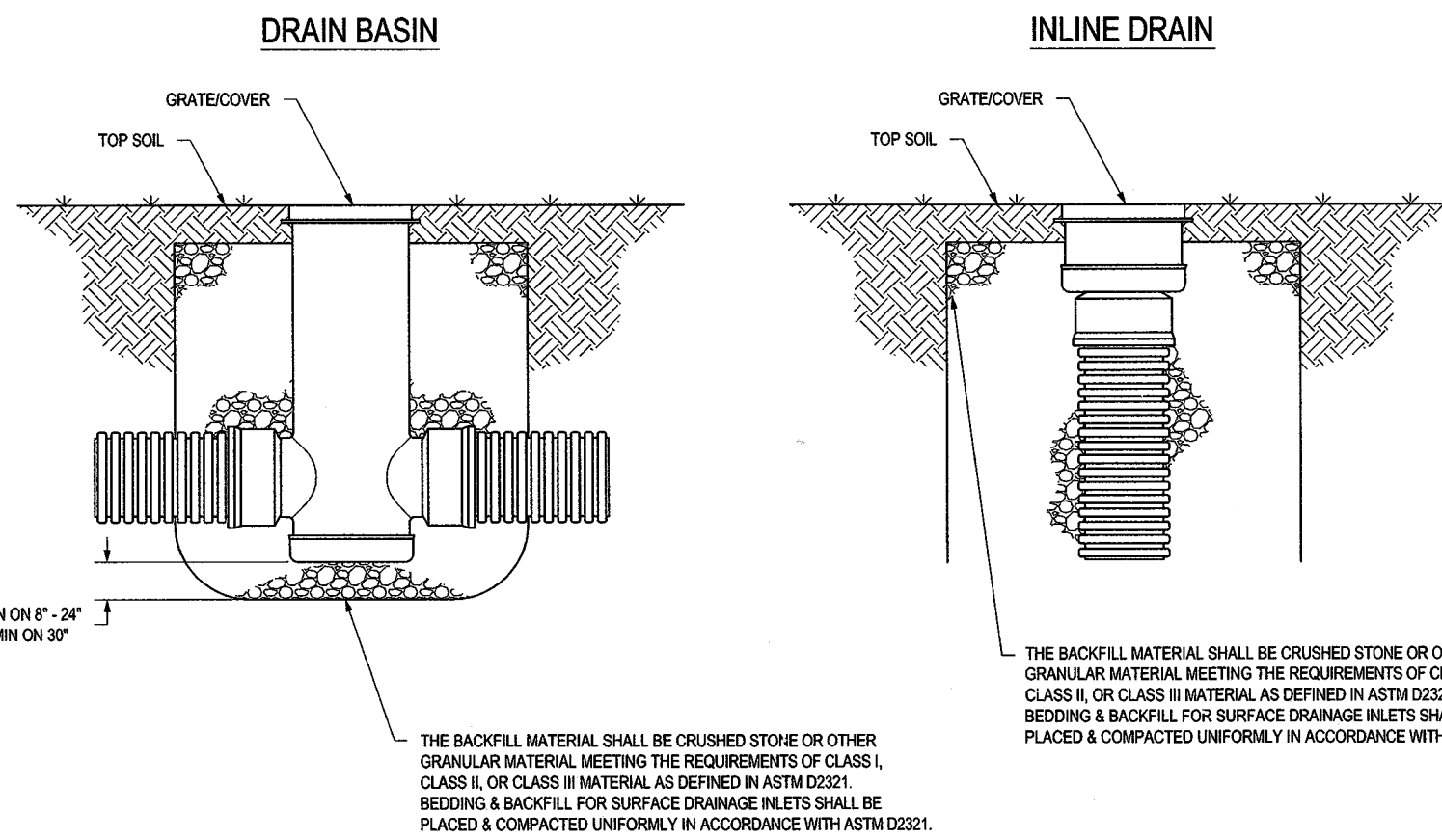

THE BACKFILL MATERIAL SHALL BE CRUSHED STONE OR OTHER GRANULAR MATERIAL MEETING THE REQUIREMENTS OF CLASS I, CLASS II, OR CLASS III MATERIAL AS DEFINED IN ASTM D2321. BEDDING & BACKFILL FOR SURFACE DRAINAGE INLETS SHALL BE PLACED & COMPACTED UNIFORMLY IN ACCORDANCE WITH ASTM D2321.

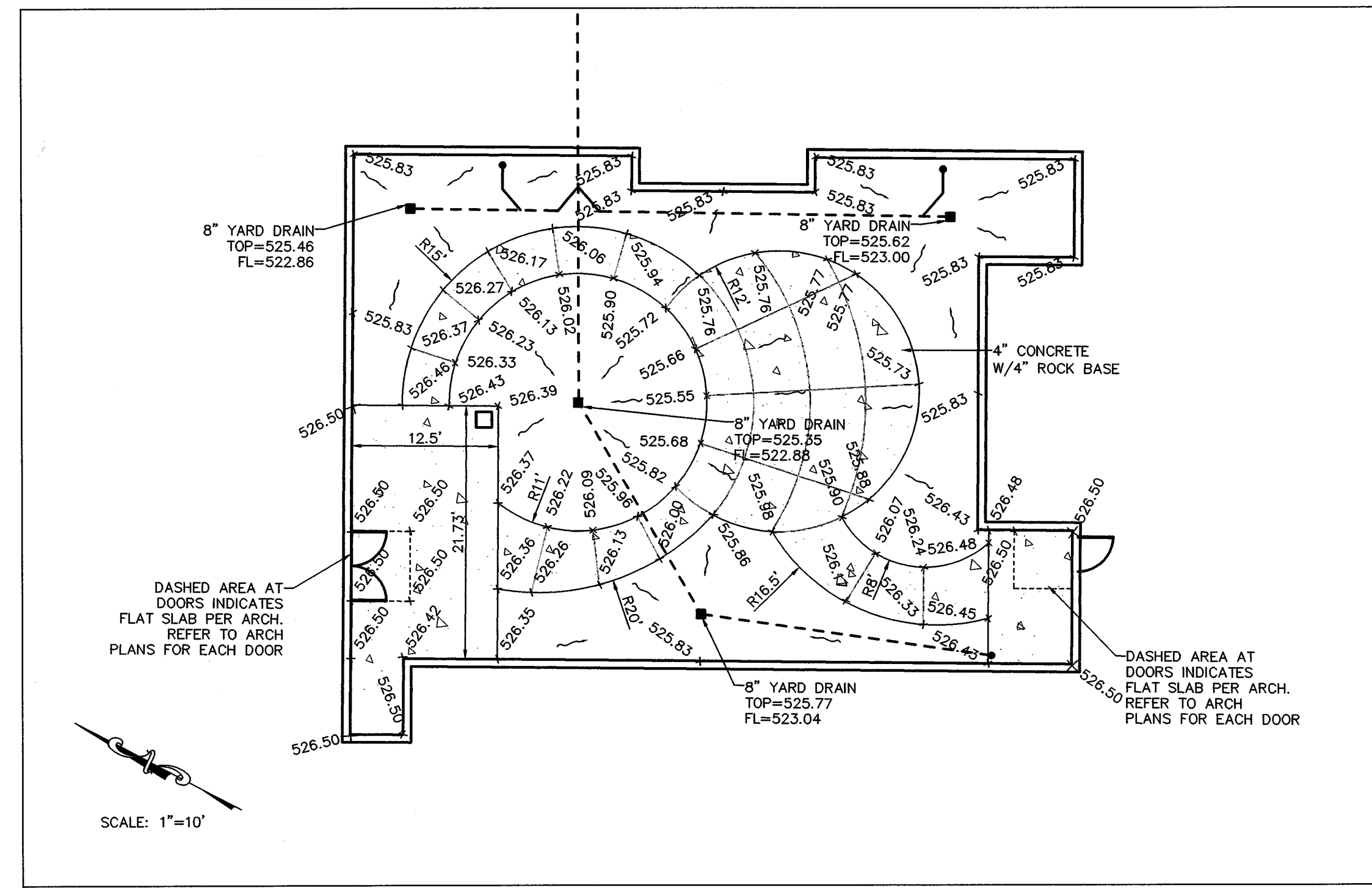

COURTYARD DETAIL

| | | | |
|--|--------------------------------------|---|--|
| THIS PRINT DISCLOSES SUBJECT MATTER IN WHICH NYLOPLAST HAS PROPRIETARY RIGHTS. THE RECEIPT OR POSSESSION OF THIS PRINT DOES NOT CONFER, TRANSFER, OR LICENSE THE USE OF THE DESIGN OR TECHNICAL INFORMATION SHOWN HEREIN. REPRODUCTION OF THIS PRINT OR ANY INFORMATION CONTAINED HEREIN, OR MANUFACTURE OF ANY ARTICLE HEREFROM, FOR THE DISCLOSURE TO OTHERS IS FORBIDDEN, EXCEPT BY SPECIFIC WRITTEN PERMISSION FROM NYLOPLAST. | DATE: 03-14-16 REVISION: 03-15-16 | PROJECT NO. NAME: 11N - 38 IN INLINE DRAIN SPECIFICATIONS | NYLOPLAST 3130 VERONA AVE BURLINGTON, GA 30606 PH: (770) 832-2443 FAX: (770) 832-2440 WWW.NYLOPLAST.COM |
|--|--------------------------------------|---|--|

| | | | |
|--|-------------------------------------|---|--|
| THIS PRINT DISCLOSES SUBJECT MATTER IN WHICH NYLOPLAST HAS PROPRIETARY RIGHTS. THE RECEIPT OR POSSESSION OF THIS PRINT DOES NOT CONFER, TRANSFER, OR LICENSE THE USE OF THE DESIGN OR TECHNICAL INFORMATION SHOWN HEREIN. REPRODUCTION OF THIS PRINT OR ANY INFORMATION CONTAINED HEREIN, OR MANUFACTURE OF ANY ARTICLE HEREFROM, FOR THE DISCLOSURE TO OTHERS IS FORBIDDEN, EXCEPT BY SPECIFIC WRITTEN PERMISSION FROM NYLOPLAST. | DATE: 9-30-09 REVISION: 03-11-16 | PROJECT NO. NAME: DRAIN BASIN & INLINE DRAIN NON TRAFFIC INSTALLATION | NYLOPLAST 3130 VERONA AVE BURLINGTON, GA 30606 PH: (770) 832-2443 FAX: (770) 832-2440 WWW.NYLOPLAST.COM |
|--|-------------------------------------|---|--|

WHEN ARE INLINE DRAINS USED?

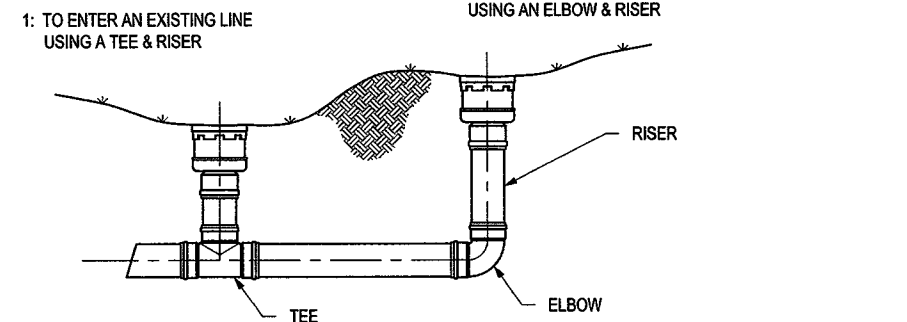

TYPICAL INSTALLATIONS

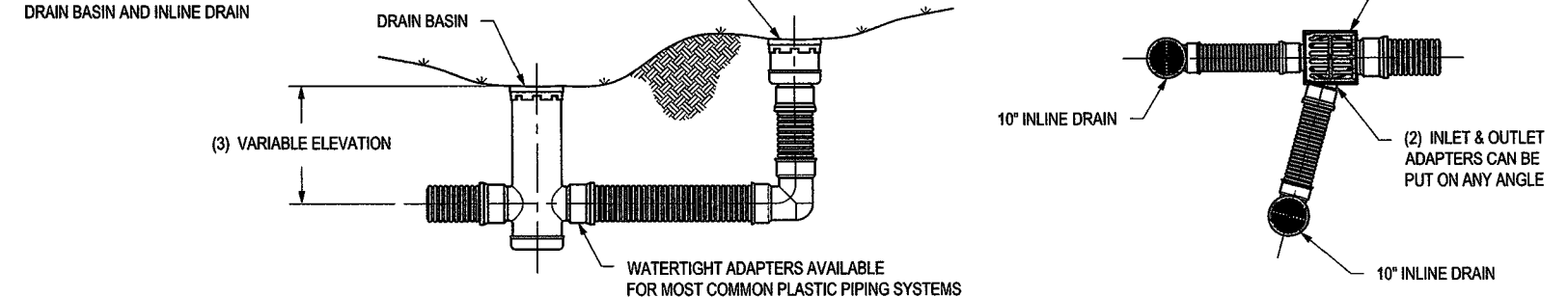

WHEN ARE DRAIN BASINS USED?

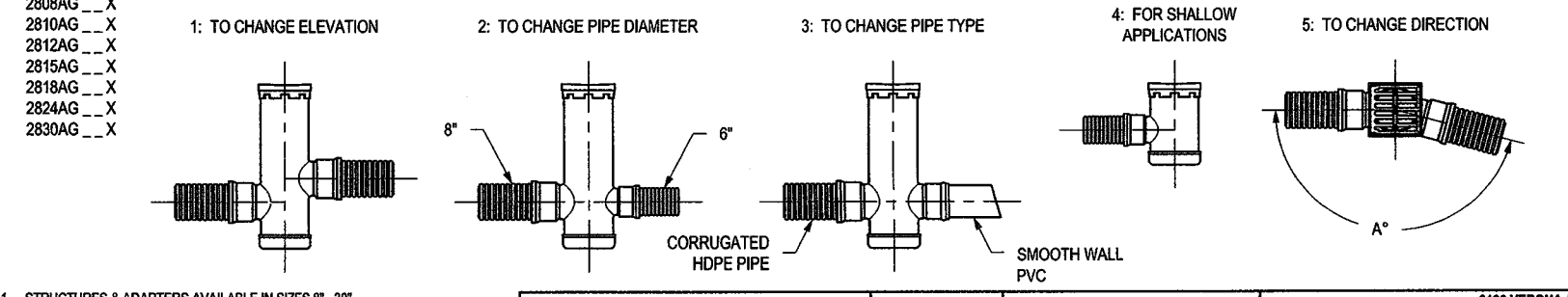

| | | | |
|---|--------------------------------------|---|--|
| 1. STRUCTURES & ADAPTERS AVAILABLE IN SIZES 8" - 30" 2. ADAPTERS CAN BE MOUNTED ON ANY ANGLE UP TO 30° TO DETERMINE NUMBER ANGLE BETWEEN ADAPTERS (SEE DRAWING NO. 7001-110-12) 3. DRAIN BASIN TO BE CUSTOM MANUFACTURED ACCORDING TO PLAN DETAILS. HOLES ARE NEEDED FOR WASHERS OVER 1/2" DIA TO SHIPPING RESTRICTIONS (SEE DRAWING NO. 7001-110-16) | DATE: 03-14-16 REVISION: 03-15-16 | PROJECT NO. NAME: 8 IN - 38 IN TYPICAL INSTALLATION OPTIONS | NYLOPLAST 3130 VERONA AVE BURLINGTON, GA 30606 PH: (770) 832-2443 FAX: (770) 832-2440 WWW.NYLOPLAST.COM |
|---|--------------------------------------|---|--|

NYLOPLAST 8" INLINE DRAIN: 2708AG __ X

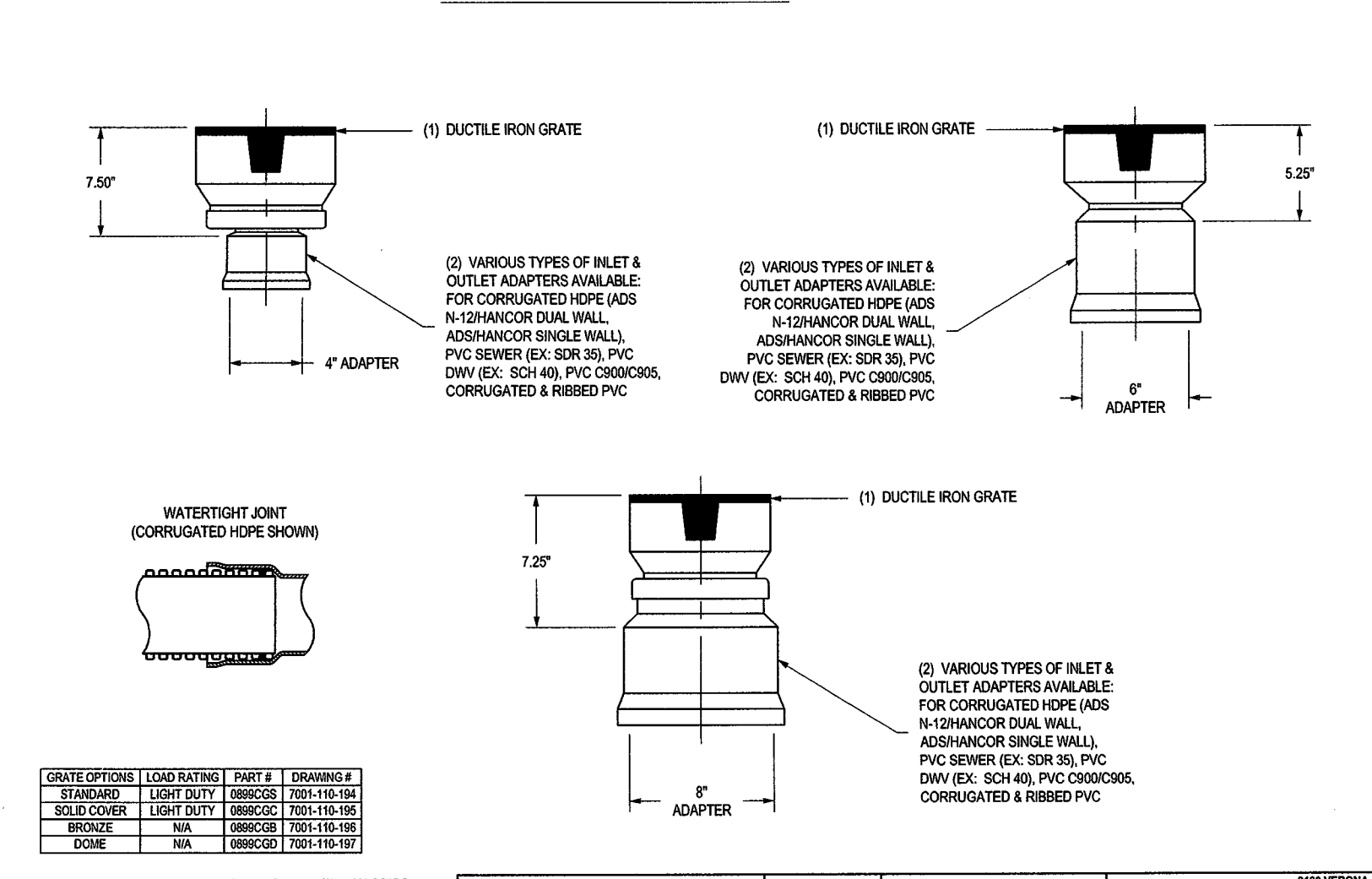

| | | | |
|--|--------------------------------------|--|--|
| 1. GRATE/SLAB COVER SHALL BE DUCTILE IRON PER AREA AND GRADE TO MATCH WITH THE ELEVATION OF THE BRIDGE/GRATE. 2. DRAINAGE CONNECTION STUB JOINT THICKNESS SHALL CONFORM TO ASTM D3212 FOR CORRUGATED HDPE ADS & HANGAR DUAL WALL & SCH 40 PVC. 3. DIMENSIONS ARE FOR REFERENCE ONLY. 4. ACTUAL DIMENSIONS MAY VARY. | DATE: 03-14-16 REVISION: 03-15-16 | PROJECT NO. NAME: 8 IN INLINE DRAIN DESIGN DETAILS | NYLOPLAST 3130 VERONA AVE BURLINGTON, GA 30606 PH: (770) 832-2443 FAX: (770) 832-2440 WWW.NYLOPLAST.COM |
|--|--------------------------------------|--|--|

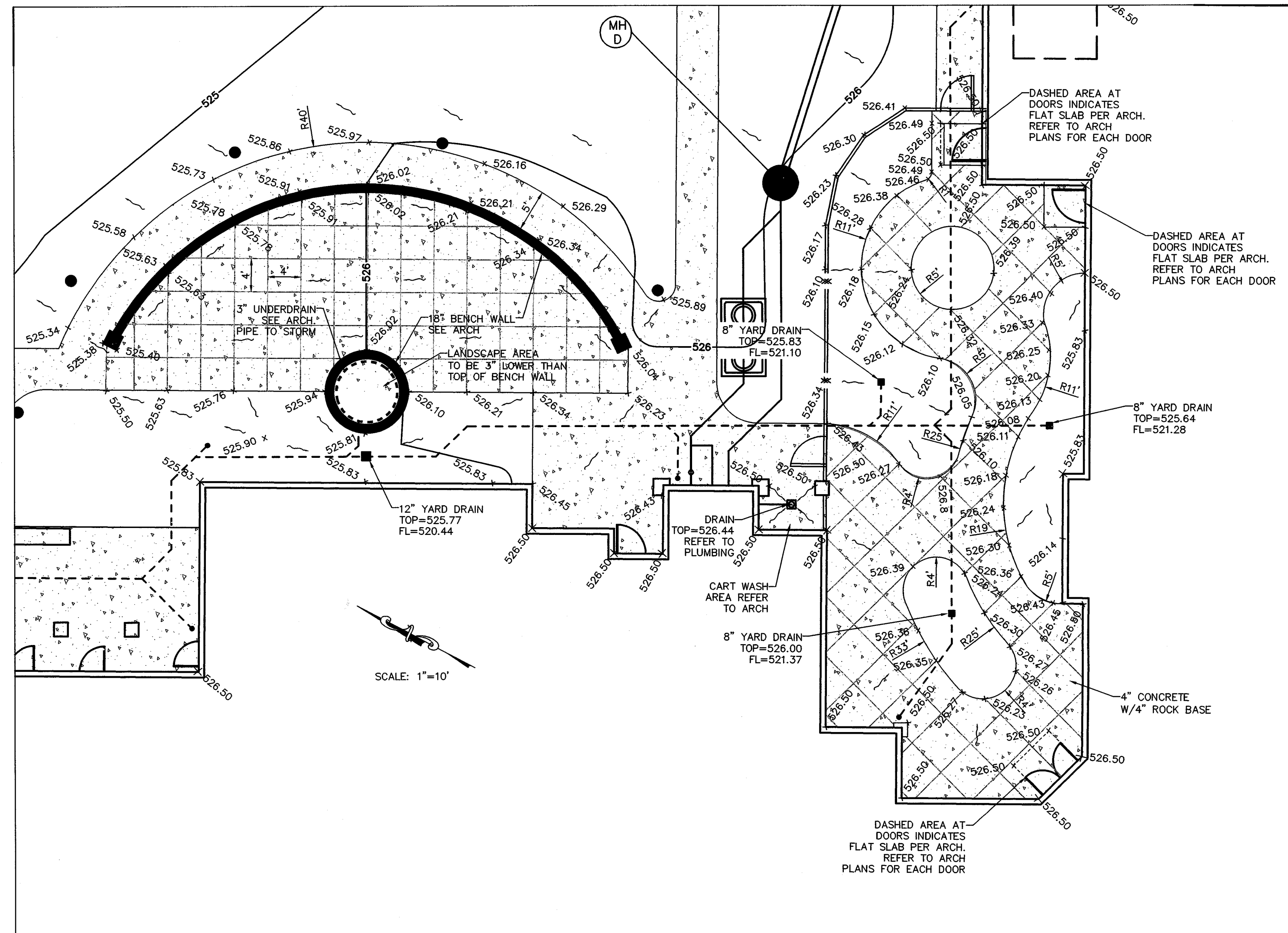

PATIO DETAILS

PROJECT TITLE:
THE LANDING OF OFALLON

ENGINEERING
PLANNING
SURVEYING
221 Point West Blvd.
St. Charles, MO 63301
636-929-6552
FAX 636-929-1710

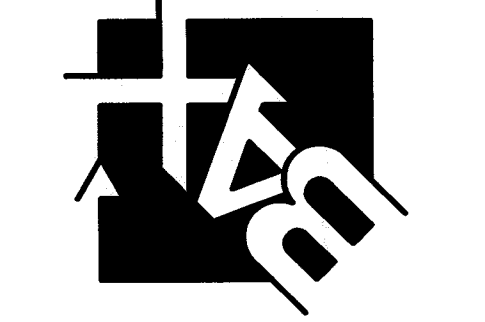

DISCLAIMER OF RESPONSIBILITY
I hereby specify that the documents intended to be authenticated by my seal are limited to this sheet, and I hereby disclaim any responsibility for all other drawings, specifications, estimates, reports or other documents or instruments relating to or intended to be used for any part or parts of the architectural or engineering project.

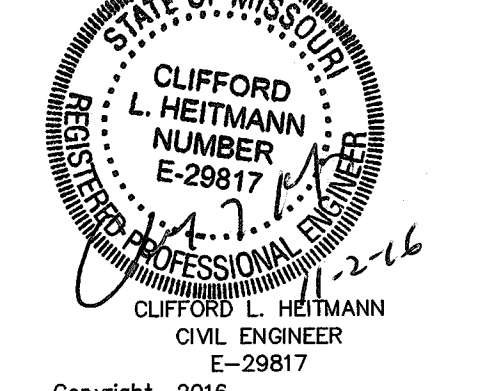

Copyright 2016
Box Engineering Company, Inc.
Engineering Authority No. 000655
Surveying Authority No. 000144
All Rights Reserved

| REVISIONS |
|------------------------|
| 10-14-16 CITY COMMENTS |
| 10-24-16 CITY COMMENTS |
| |
| |
| |
| |

Developer / Owner:
LENTY ARCHITECTURE
3150 KETTLE COURT SE
SALEM, OREGON 97301
1-503-399-1090

P+Z No. 20-16.02
City No. 16-010424
Page No. 31 of 31

Bar Project # 06-13001B Issue Date: 08/26/2016

COURTYARD/PATIO DETAILS

VAULTSERVER\Civil 3d Project\13901B OFALLON SENIOR LIVING\Construction\13901B Con.dwg, 11/2/2016 1:56:40 PM, 1:1