

**STORM SEWER PROFILE**  
 SCALES:  
 HORIZ. 1"=40'  
 VERT. 1"=10'

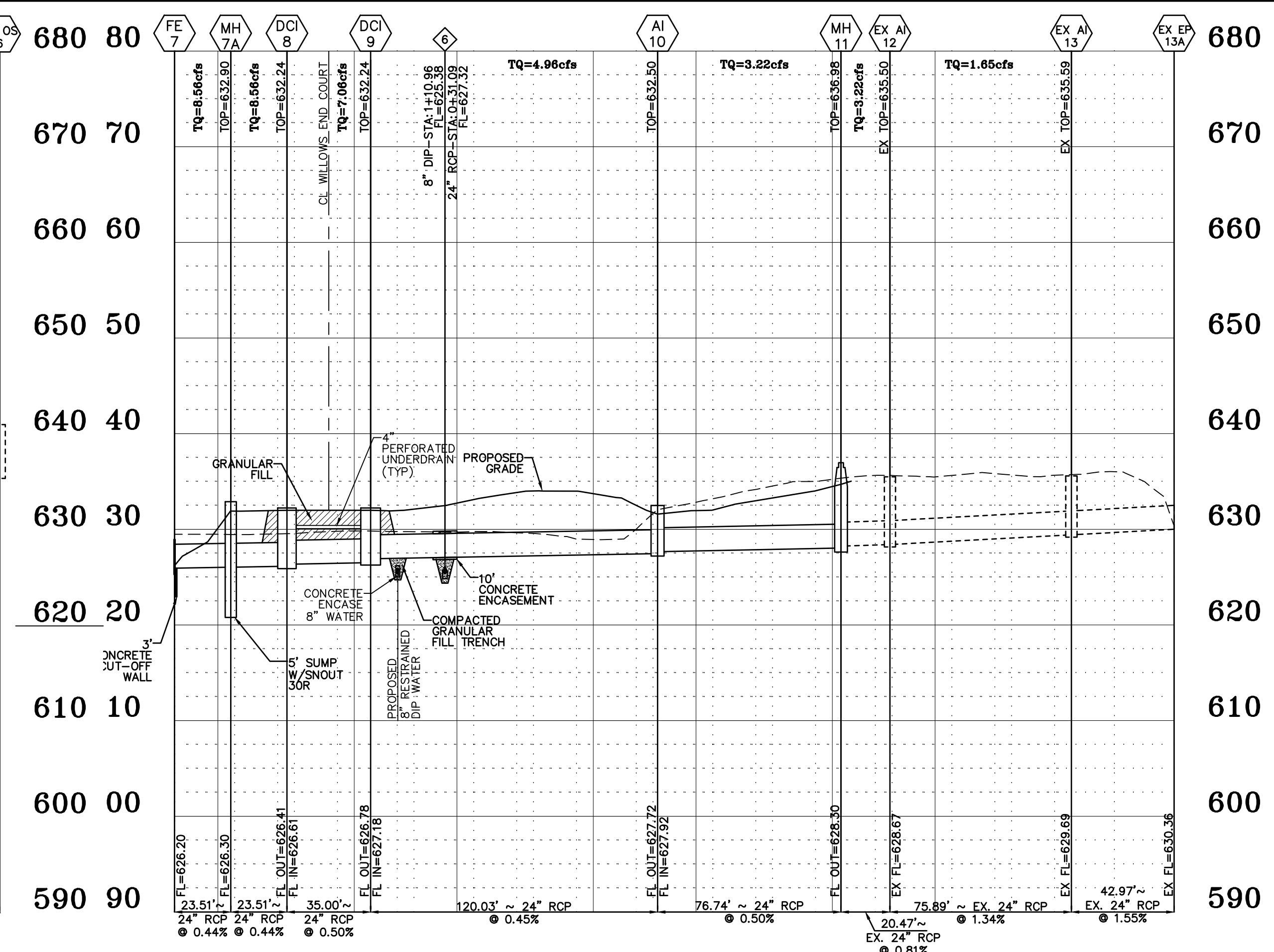

**STORM SEWER PROFILE**  
 SCALES:  
 HORIZ. 1"=40'  
 VERT. 1"=10'

St Charles County Government  
 Hydraulic Review Output Data

W:\AULTSERVER\File\Folders\1800018154 - 8760 Hwy N. O'Fallon\Engineering\Hydraulics\18154 RG  
 7/1/2022  
 Calculations Under Full Flow

Upp Str	Low Str	PL	S	Upp FL LN	Low FL LN	PS	Upp ST EL	Depth HY GR	Upp HY EL	Low HY EL	Hydr Grade	FR Head	VEL Head	Junc Loss	Turn Loss	Curve STR Loss	DR Grade	DR Cap	DR Area	P.I.	Q	TQ	Pipe Cap	Remarks		
1	EP13A	EXAI13	43	24	630.36	629.69	1.56	632.36	0.67	631.69	631.69	0.00000	0.00	0.00	0.00	0.00	0.00	0.00	4.92	2.55	0.00	0.01	28.26	NO FUTURE FLOW		
2	EXAI13	EXAI12	76	24	629.69	628.67	1.34	635.59	4.91	630.68	630.67	0.00010	0.01	0.53	0.00	0.00	0.00	2.5%	1.75	0.88	2.43	1.65	1.65	26.19	0	
3	EXAI12	MH11	20	24	628.67	628.50	0.83	635.50	5.00	630.50	630.50	0.00020	0.00	1.02	0.02	0.00	0.00	2.5%	1.75	0.58	2.71	1.57	3.22	20.61	0	
4	MH11	AI10	77	24	628.30	627.92	0.50	636.96	7.03	629.95	629.92	0.00020	0.02	1.02	0.02	0.01	0.00	MH	0.00	0.00	0.00	0.00	3.22	16.00	0	
5	AI10	DCI9	120	24	627.72	627.18	0.45	632.50	3.25	629.25	629.18	0.00050	0.06	1.58	0.04	0.00	0.01	4S	9.35	0.58	3.00	1.74	4.98	15.18	0	
6	DCI9	DCI8	35	24	626.78	626.61	0.49	632.24	3.58	628.68	628.61	0.00100	0.04	2.25	0.08	0.00	0.03	0.00	3.6%	3.54	0.70	3.00	2.10	7.06	15.84	0
7	DCI8	AI7A	24	24	626.41	626.30	0.47	632.24	3.90	628.34	628.30	0.00140	0.03	2.72	0.11	0.00	0.01	0.00	3.6%	3.54	0.50	3.00	1.50	8.56	15.51	0
8	AI7A	FE7	24	24	626.30	626.20	0.43	632.90	4.67	628.23	628.20	0.00140	0.03	2.72	0.11	0.00	0.00	0.00	MH	0.00	0.00	0.00	0.00	8.56	14.83	ITP=628.2
9	EXOS6	AI5	62	30	635.92	635.35	0.92	641.05	2.73	638.32	637.85	0.00280	0.17	4.39	0.30	0.30	0.00	0.00	OS	0.00	0.00	0.00	21.54	21.54	39.34	From SC Plans
10	AI5	MH4	62	30	634.05	632.19	3.00	639.50	4.48	635.02	634.69	0.00300	0.19	4.55	0.32	0.00	0.00	0.00	4S	9.35	0.27	3.00	0.81	22.35	71.04	0
11	MH4	MH3	375	30	631.99	624.72	1.94	639.78	6.89	633.09	627.25	0.00300	1.13	4.55	0.32	0.00	0.10	0.00	MH	0.00	0.00	0.00	0.00	22.35	57.13	0
12	MH3	OS2	85	30	624.52	624.10	0.50	630.51	3.28	627.25	626.86	0.00300	0.25	4.55	0.32	0.00	0.14	0.00	MH	0.00	0.00	0.00	0.00	22.35	29.00	0
13	OS2	EP1	80	36	623.90	623.60	0.50	627.86	1.00	626.86	626.60	0.00280	0.16	4.84	0.36	0.00	0.10	0.00	OS	0.00	1.10	3.00	3.30	34.20	47.16	ITP=626.60

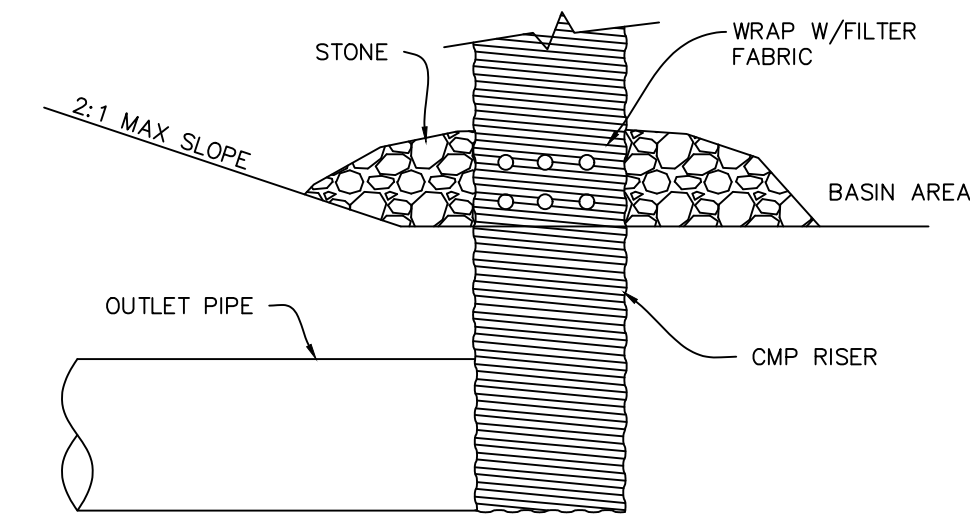

**SEDIMENT RISER/PIPE CONNECTION**  
 N.T.S.

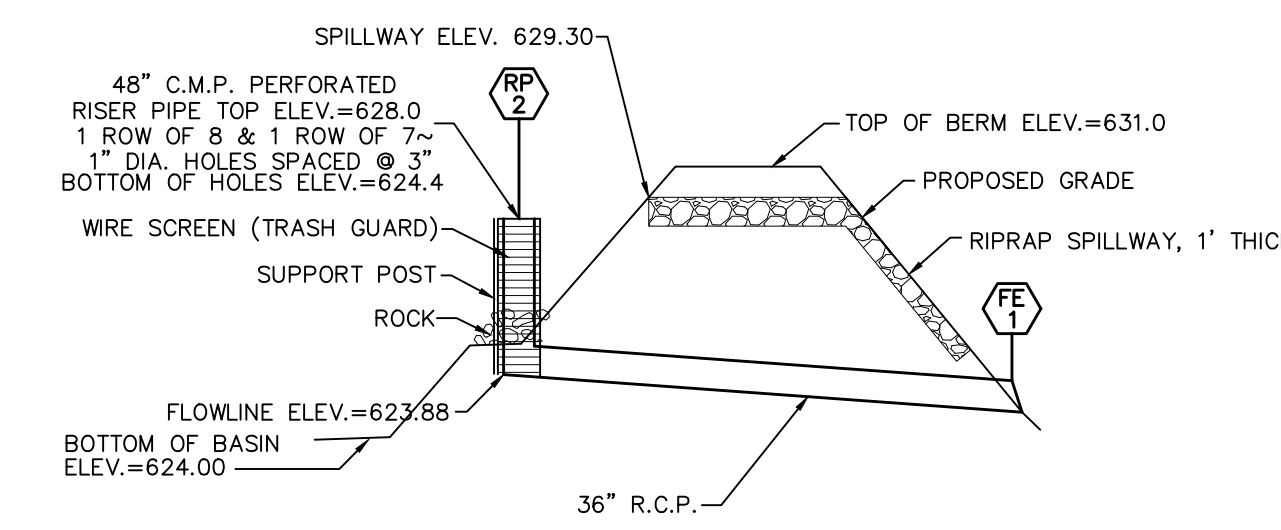

**TEMPORARY SEDIMENT BASIN E**  
 NOT TO SCALE

NOTES:  
 1. SEE PLANS FOR SPILLWAY ELEVATION.  
 2. FOLLOWING SITE STABILIZATION, ALL BASINS SHALL BE EXCAVATED TO FINAL PROPOSED GRADES AND RISER PIPE REPLACED WITH OCS.

NOTE:  
 SPILLWAY ELEVATION: 629.3  
 PAINT MARK @ ELEVATION 624.85 FOR CLEANOUT OF SEDIMENT BASIN.

**PROJECT TITLE:**  
**The Willows**

**ENGINEERING FIRM:**  
 PLANNING SURVEYING  
 221 Point View Blvd.  
 St. Charles, MO 63301  
 636-928-5562  
 FAX 928-1718

**DISCLAIMER OF RESPONSIBILITY:**  
 I hereby specify that the documents intended to be authorized by my seal are limited to this sheet, and I hereby disclaim any responsibility for all other drawings, specifications, estimates, reports or other documents or instruments relating to or intended to be used for any part or parts of the architectural or engineering project or projects.

**STATE OF MISSOURI**  
 JEFFREY B. SIMMONS  
 NUMBER FE-2007030831  
 PROFESSIONAL ENGINEER  
 11/22

**JEFFREY B. SIMMONS**  
 CIVIL ENGINEER  
 2007030831  
 Copyright 2022  
 Box Engineering Company, Inc.  
 Authority No. 000655  
 All Rights Reserved

REVISIONS	CITY COMMENTS
03/02/22	CITY COMMENTS
03/30/22	CITY COMMENTS
04/18/22	CITY COMMENTS
07/01/22	CITY COMMENTS

**Developer / Owner:**  
 KAPB, L.L.C.  
 410 Crestview Drive  
 O'Fallon, MO 63366  
 636-272-4200

**STORM SEWER PROFILES, HYDRAULICS AND DETAILS**

**P+Z No.** #21-08053  
**Approval Date:** 03/24/2022  
**City No.** GR22-000004  
**Page No.** 10 of 12