

WARPING DETAILS
SCALE: 1" = 30'

NOTE: ALL ELEVATIONS ARE AT GUTTER UNLESS NOTED OTHERWISE.

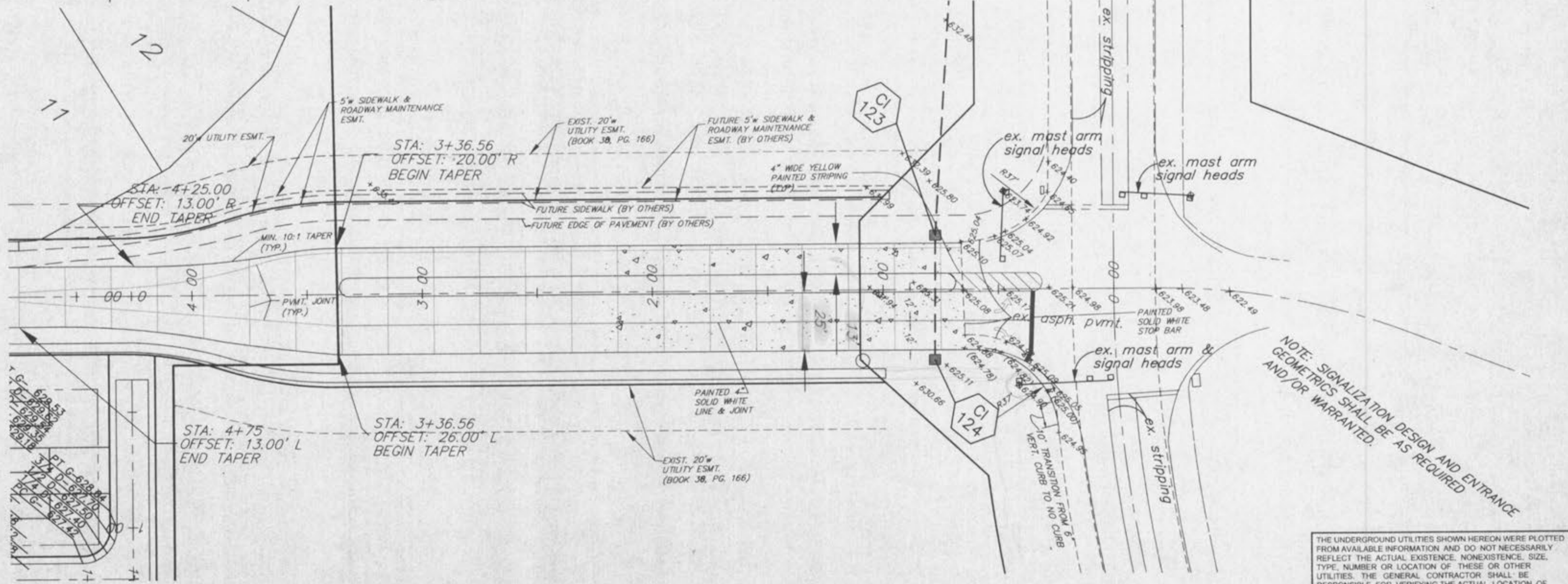
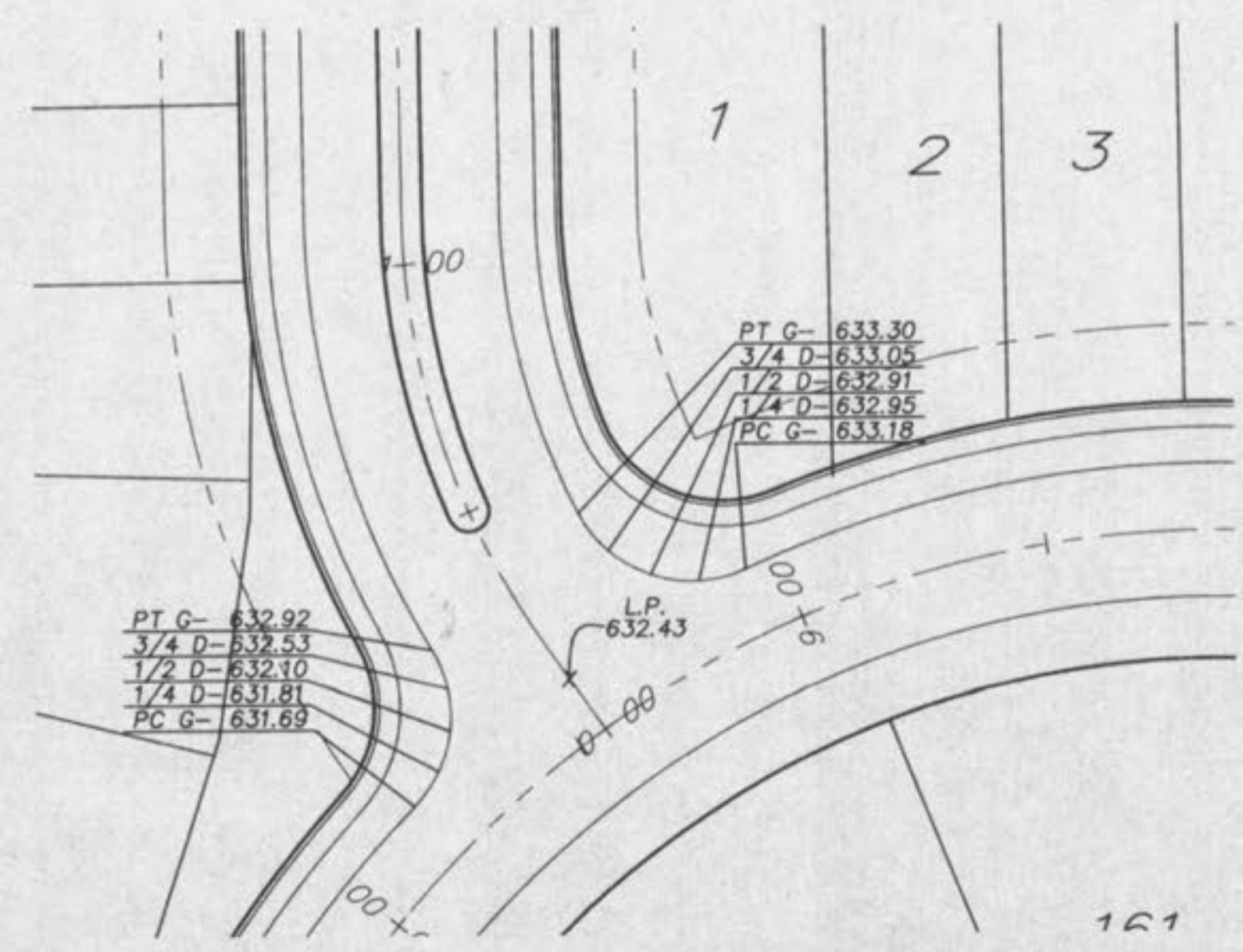

NOTE: SIGNALIZATION DESIGN AND ENTRANCE GEOMETRICS SHALL BE AS REQUIRED AND/OR WARRANTED.

THE UNDERGROUND UTILITIES SHOWN HEREON WERE PLOTTED FROM AVAILABLE INFORMATION AND DO NOT NECESSARILY REFLECT THE ACTUAL EXISTENCE, NONEXISTENCE, SIZE, TYPE, NUMBER OR LOCATION OF THESE OR OTHER UTILITIES. THE GENERAL CONTRACTOR SHALL BE RESPONSIBLE FOR VERIFYING THE ACTUAL LOCATION OF ALL UNDERGROUND UTILITIES, SHOWN OR NOT SHOWN, AND SAID UTILITIES SHALL BE LOCATED IN THE FIELD PRIOR TO ANY GRADING, EXCAVATION OR CONSTRUCTION OF IMPROVEMENTS. THESE PROVISIONS SHALL IN NO WAY ABSOLVE ANY PARTY FROM COMPLYING WITH THE UNDERGROUND FACILITY SAFETY AND DAMAGE PREVENTION ACT, CHAPTER 319, RSMo.

ISSUE	REMARKS/DATE
1	7/25/01
2	10/15/01
3	11/7/01
4	11/14/01

PREPARED FOR:
McBride & Son Homes, Inc.
#1 McBride & Son Center Drive
Chestertfield, Missouri 63005
(636) 537-2000



THE **STERLING** CO.
ENGINEERS & SURVEYORS
5055 NEW BALMARTNER ROAD
ST. LOUIS, MISSOURI 63129
(314) 487-0440 FAX 487-3944
E-Mail: Sterling@stern-st.net

DRAWN:	DESIGNED:	CHECKED:
THORNBURY CROSSING		
WARPING DETAILS		
PROJECT:	NO. 00 11 289	SHEET 32 OF 33