

**PLAN VIEW**  
SCALE: 1"=60'

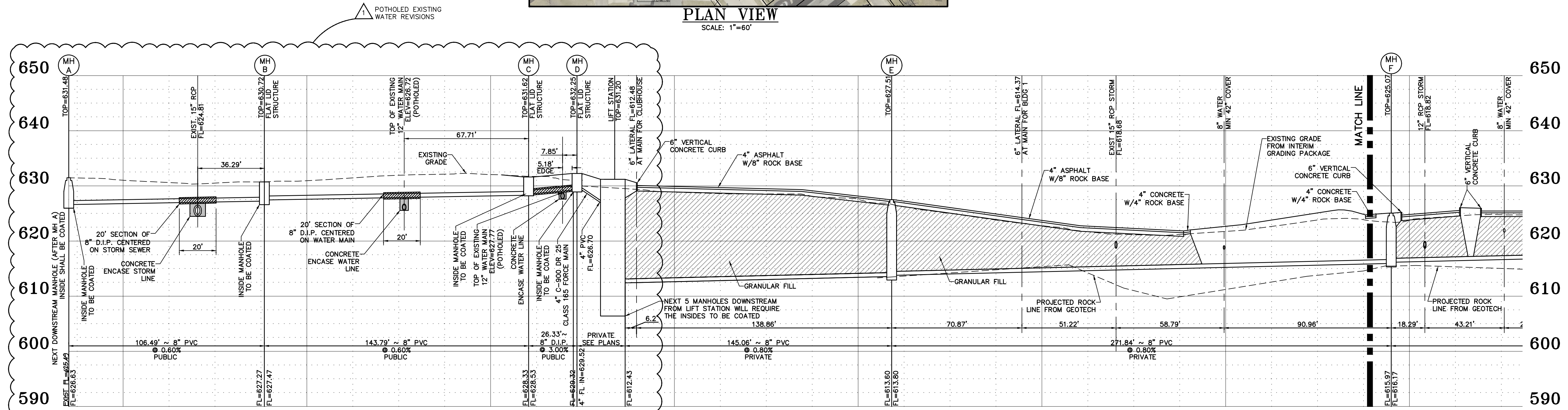

**SANITARY PROFILE**  
HORIZONTAL SCALE: 1"=30'  
VERTICAL SCALE: 1"=10'

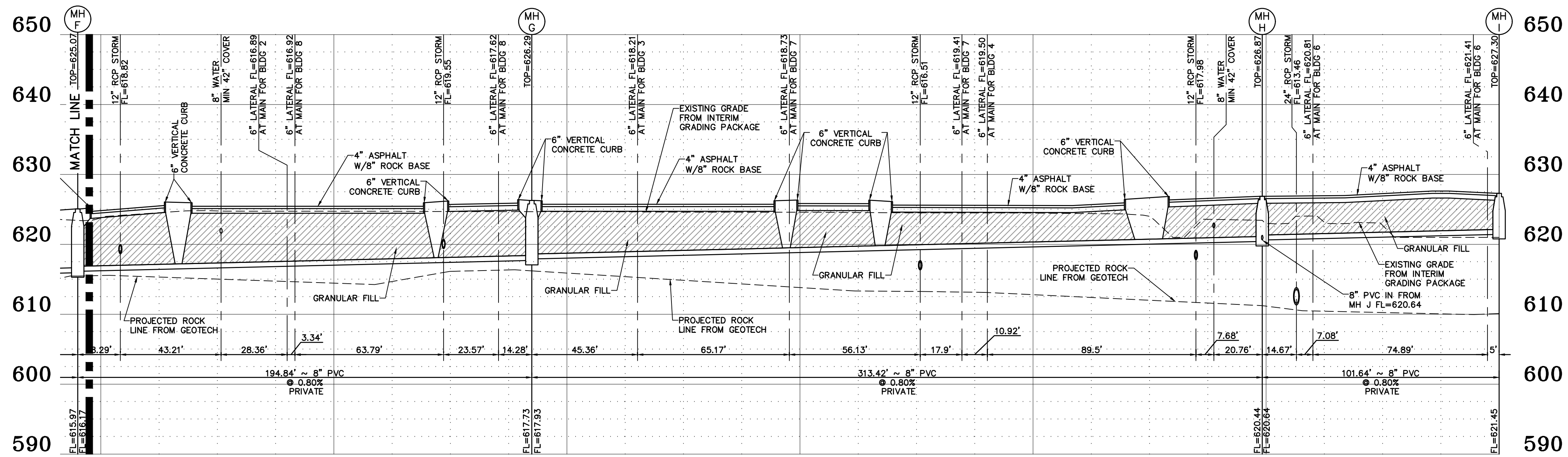

**SANITARY PROFILE**  
HORIZONTAL SCALE: 1"=30'  
VERTICAL SCALE: 1"=10'

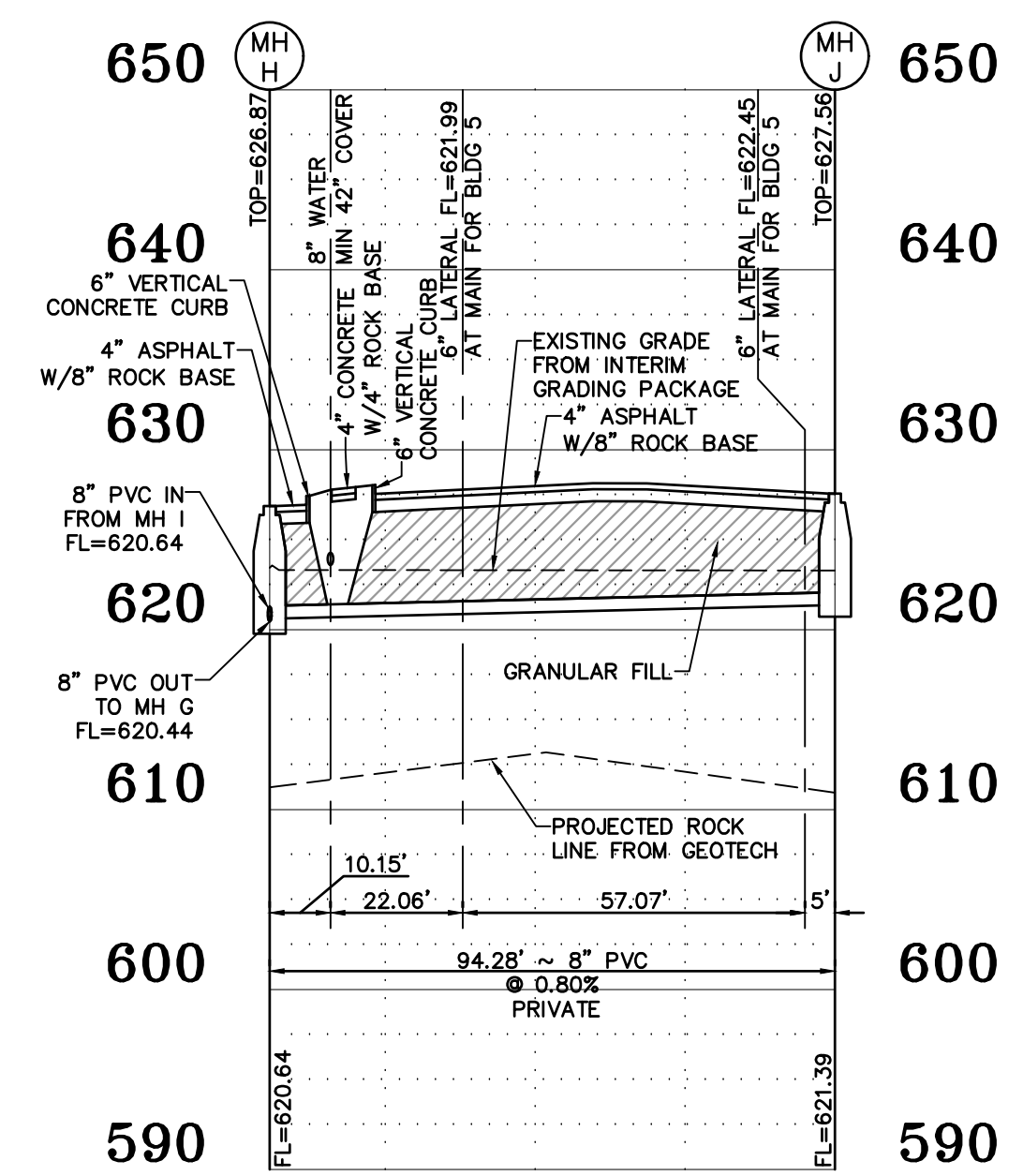

**SANITARY PROFILE**  
HORIZONTAL SCALE: 1"=30'  
VERTICAL SCALE: 1"=10'

**PROJECT TITLE:**  
THORNWOOD APARTMENTS  
THORNBUARY CROSSING DRIVE  
OF FALLON, MO 63366

**ENGINEERING  
PLANNING  
SURVEYING**  
221 Point West Blvd.  
St. Charles, MO 63301  
636-928-5552  
FAX 636-928-1718

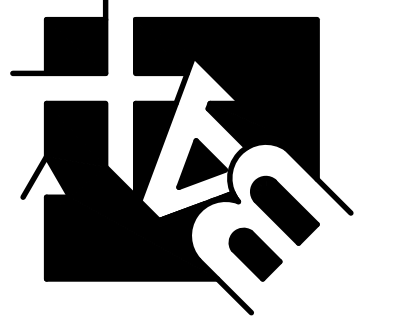

DISCLAIMER OF RESPONSIBILITY  
I hereby certify that the documents intended to be authenticated by my seal are limited to this sheet, and I hereby disclaim any responsibility for all other Drawings, Specifications, Estimates, Reports or other documents or instruments relating to or intended to be used for any part or parts of the architectural or engineering project or survey.



CLIFFORD L. HEITMANN  
Civil Engineer  
Engineers License E-29817

**REVISIONS**

07-25-24	CITY COMMENTS
08-15-24	CITY COMMENTS
10-7-24	POTHOLE WATER

Bax Engineering Company, Inc.  
Missouri State Certificate of Authority  
Engineering #000655  
Missouri State Certificate of Authority  
Surveying #000144

**Developer / Owner:**  
MRS TROMBONE LLC  
100 WOODCHASE LANE  
CHESTERFIELD, MO 6307  
314-469-0029

**SANITARY PROFILES**

**P+Z No.** 23-010426  
**Approval Date:** 1-4-24  
**City No.** #

**Page No.**  
13 of 34

I:\VAULT\SERVER\Civil\3d\Projects\19014\Construction\19014\Construction.dwg, ARCH full bleed D (24.00 x 36.00 inches), 1:1