

P:\10284 TRUM 025\DWG\OUTPUT\02 - PLAN AND PROFILE.dwg

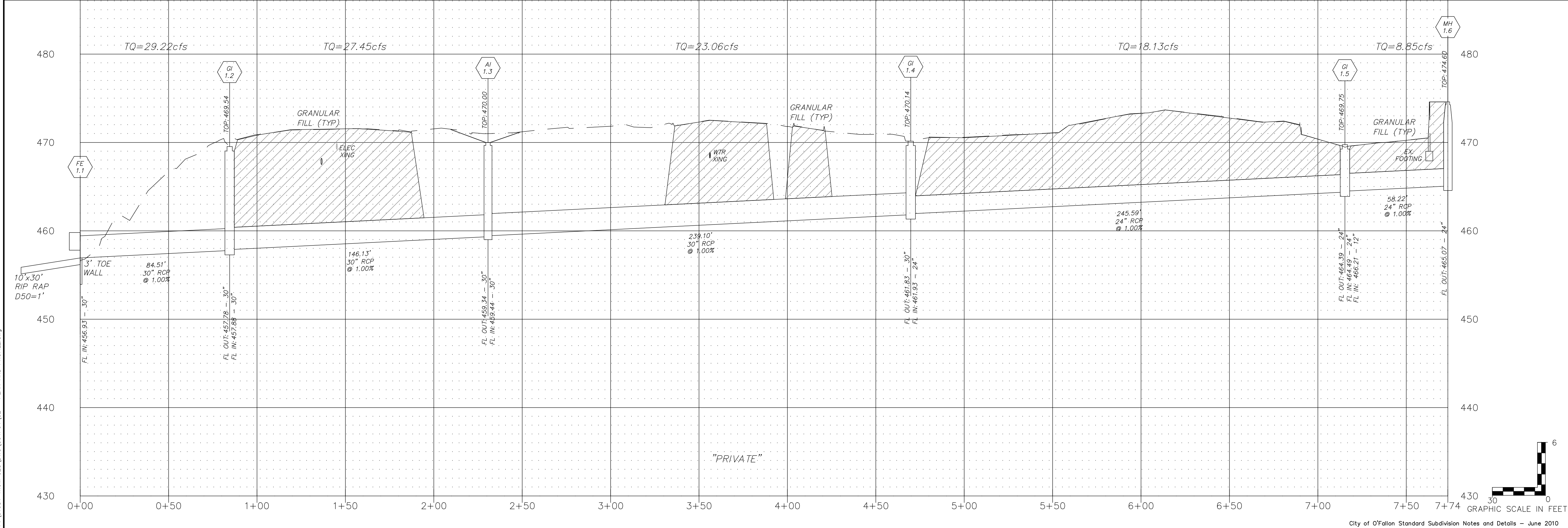
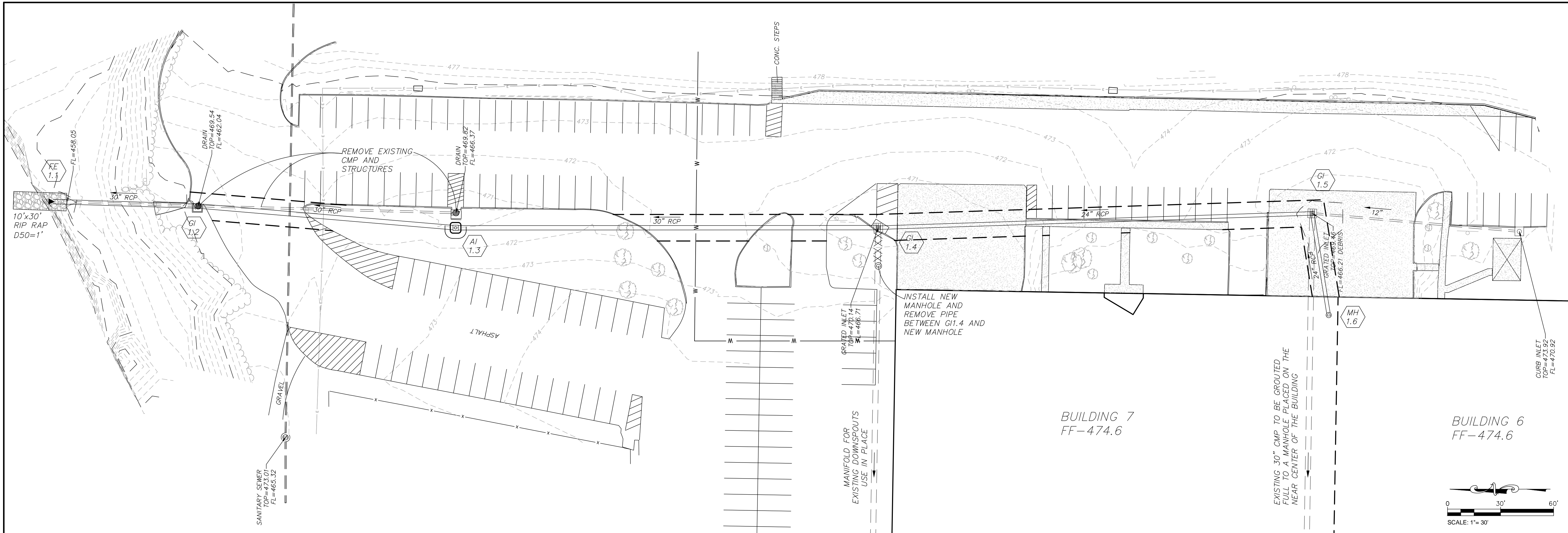

PROJECT TITLE
IMPROVEMENT PLANS
TRUE MANUFACTURING
BUILDING 6-9
PLAN AND PROFILE

PICKETT, RAY & SILVER, INC.
CIVIL ENGINEERING, LAND SURVEYING,
AND NATURAL RESOURCES SERVICES
 S.L. Pickett, P.E.
 2400 Professional Court
 St. Louis, MO 63107
 Phone (636) 397-1211 Fax (636) 397-1104
 www.prs.com 1-800-786-9516

ENGINEER'S AUTHENTICATION
 THE RESPONSIBILITY FOR PROFESSIONAL ENGINEERING LIABILITY ON THIS PROJECT IS HEREBY LIMITED TO THE SET OF PLANS AUTHENTICATED BY THE SEAL, SIGNATURE, AND DATE HEREINAFTER ATTACHED. RESPONSIBILITY IS EXCLUDED FOR ALL OTHER ENGINEERING PLANS INVOLVED IN THIS PROJECT AND SPECIFICALLY EXCLUDES DESIGN AFTER THE SEAL IS PLACED HEREON.
PICKETT, RAY & SILVER, INC. MO LICENSE #000000

KARL A. SCHOENKE, P.E.
 PROFESSIONAL ENGINEER LICENSE 2003015039

Developer / Owner Information
TRUE MANUFACTURING CO., INC.
 595 Arrow Lane
 O'Fallon, Missouri 63366
 Phone: 636-240-2400

P+Z No.
 File No. 17-012044
 Permit No. CSP17-000030
 Page No. **3** of **6**
 PLAN AND PROFILE

*** City Submittal Set *** 01/04/2018