

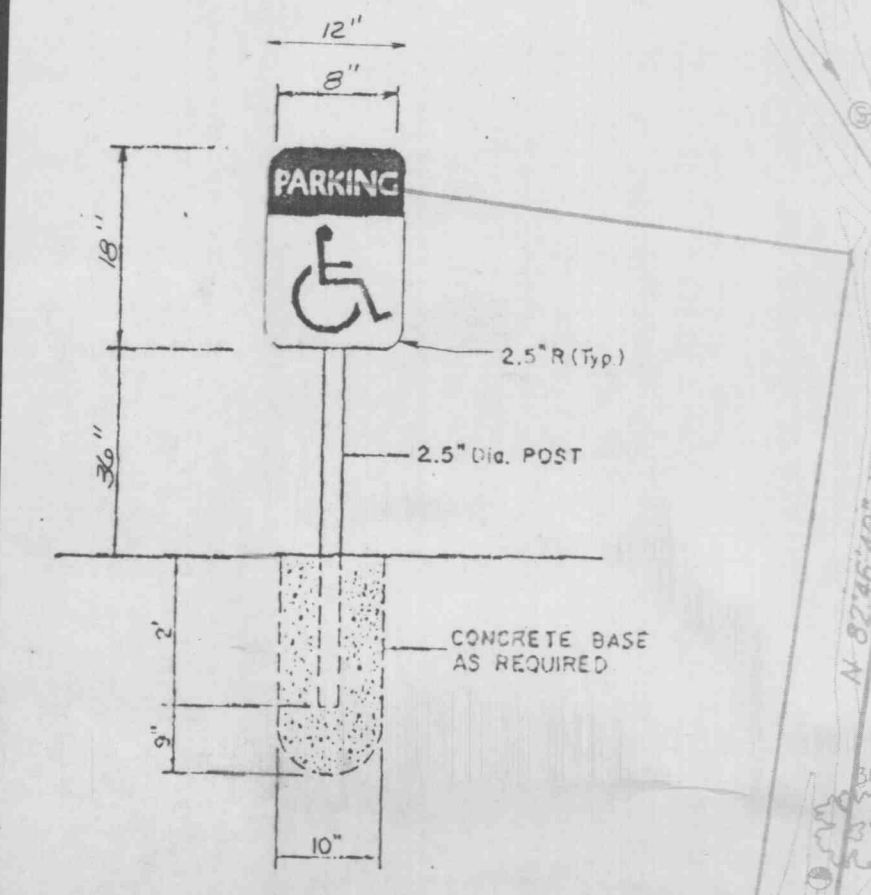

63366

NOTE: THIS SIGN IS SINGLE FACED WITH WHITE LETTERS & BORDER ON BLUE BACKGROUND



HANDICAPPED SIGN N.T.S.

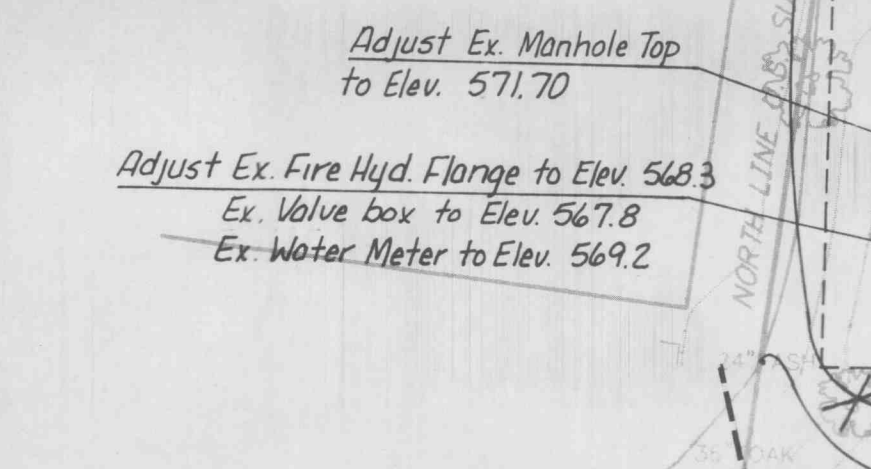

HANDICAP RAMP DETAIL N.T.S.

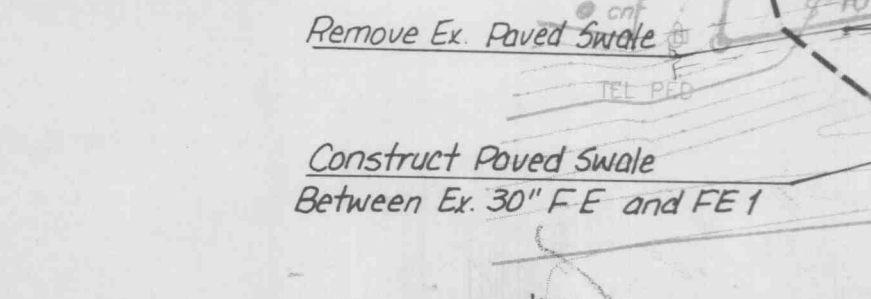

CONCRETE CURB & GUTTER DETAIL N.T.S.

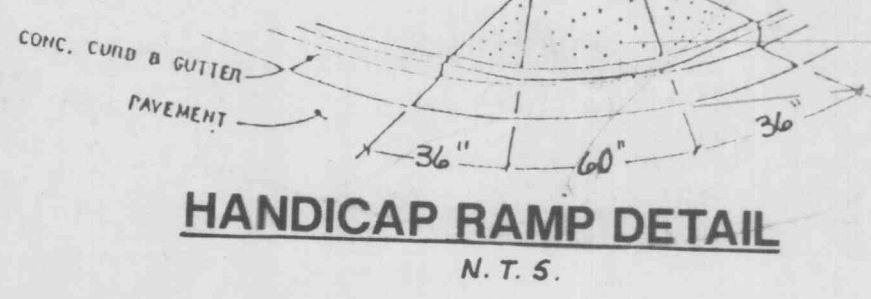

ASPHALT CURB & GUTTER DETAIL N.T.S.

OWNER/DEVELOPER: O'Fallon True Value Hardware
513 South Main Street
O'Fallon, Mo. 63366
Attn: Mr. Don Schappe & Mr. Fred Pund

BENCHMARK: Chisled on SW cor. sidewalk at South entrance Commerce Bank Elev. 568.77

Chisled "T" on edge walk South of the SE cor. of building (O'Fallon Health Center) Elev. 571.85

Curve Data
R=100.00'
Δ=11°00'00"
L=19.19'

NOTE:
Existing underground and overhead utilities and drainage structures have been plotted from available information and their locations must be considered approximate only. It is the responsibility of the contractor to notify the utility companies and to verify the locations of existing utilities before actual construction begins. Any discrepancies notes must be reported to the Engineer immediately.

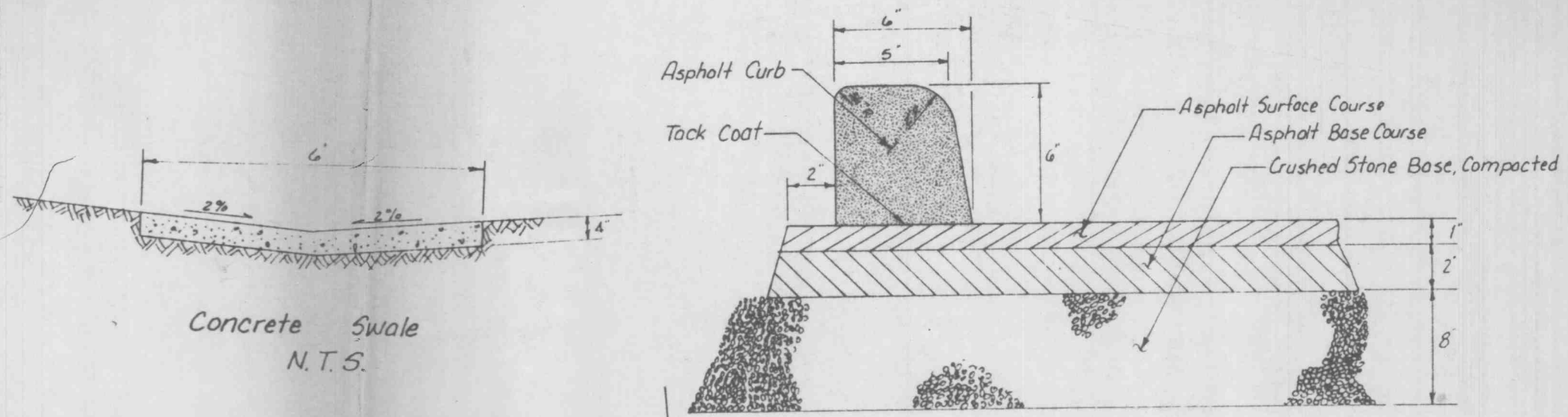

Asphalt Pavement and Curb Section N.T.S.

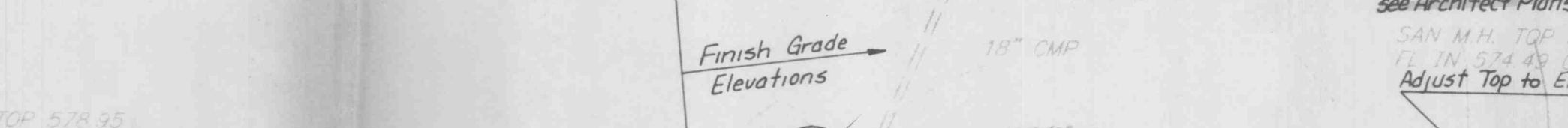

Retaining Wall Section N.T.S.

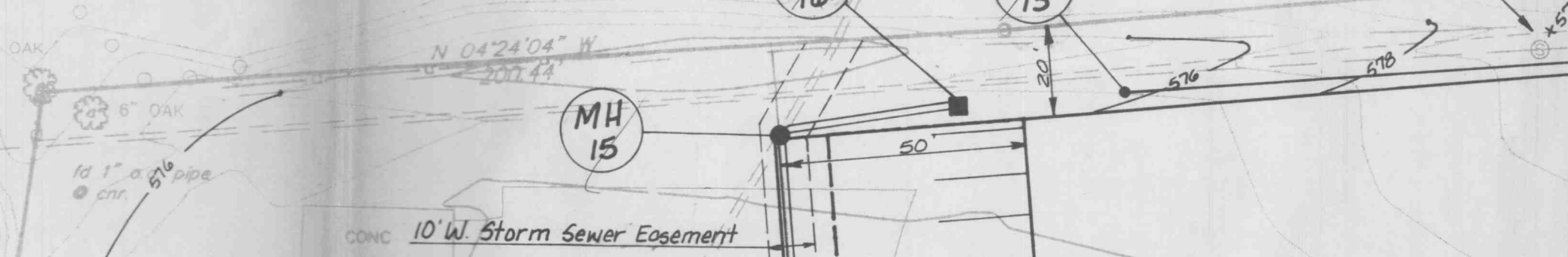

Concrete Pad for Trash Recepticals see Architects Plans



Proposed Building Finish Floor Elev. 575.3



Asphalt Parking Lot w/ Asphalt Curbs See Detail, This Sheet



4" W/ Conc. Sidewalk see detail, this sheet

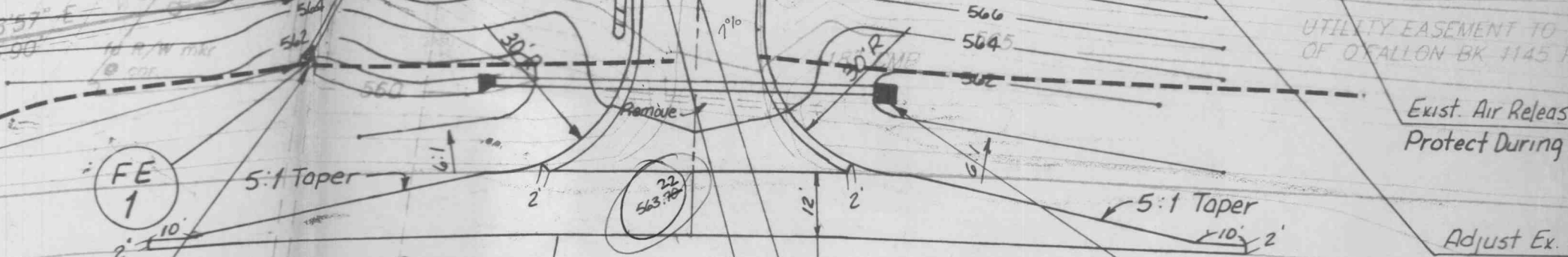

Siltation Control (Typ) see detail, this sheet

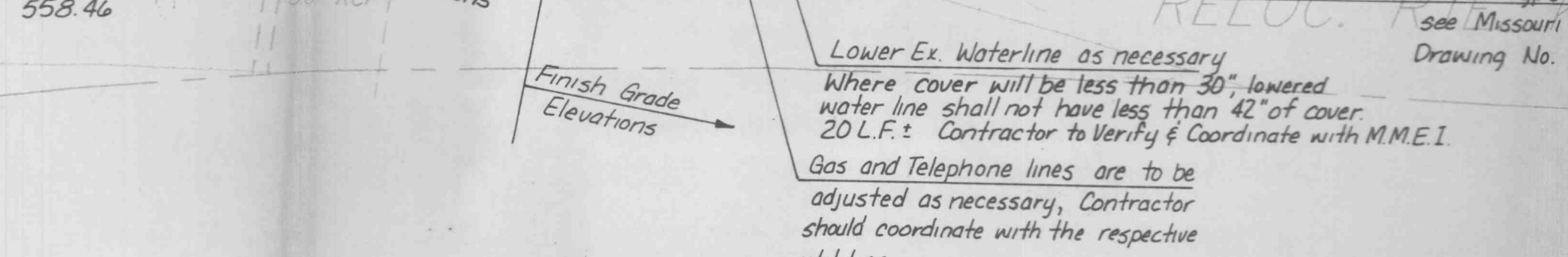

MHTC Type S-3 Drop Inlet see Missouri Standard Plans for Highway Construction, Jan. 1990 Drawing No. 60427C, Sheet 1 of 3

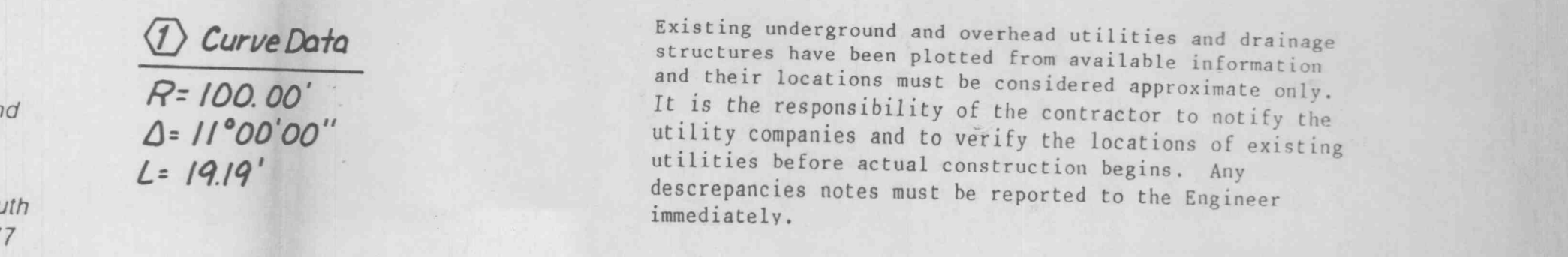

STRAW BALE DETAIL



Siltation Control Detail N.T.S.

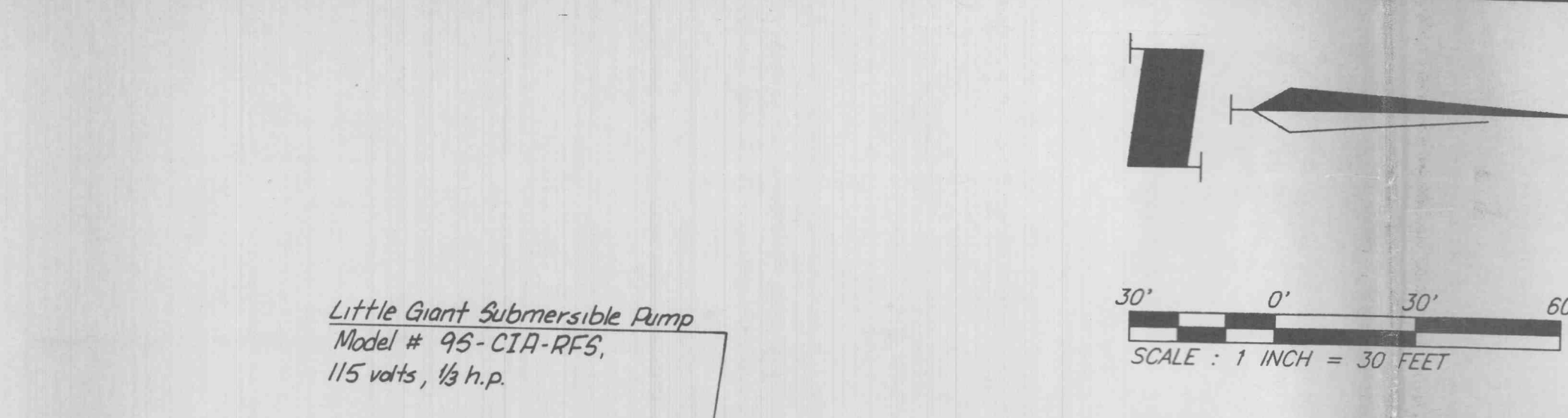

Little Giant Submersible Pump Model # 95-CIA-RFS, 115 volts, 1/8 h.p.

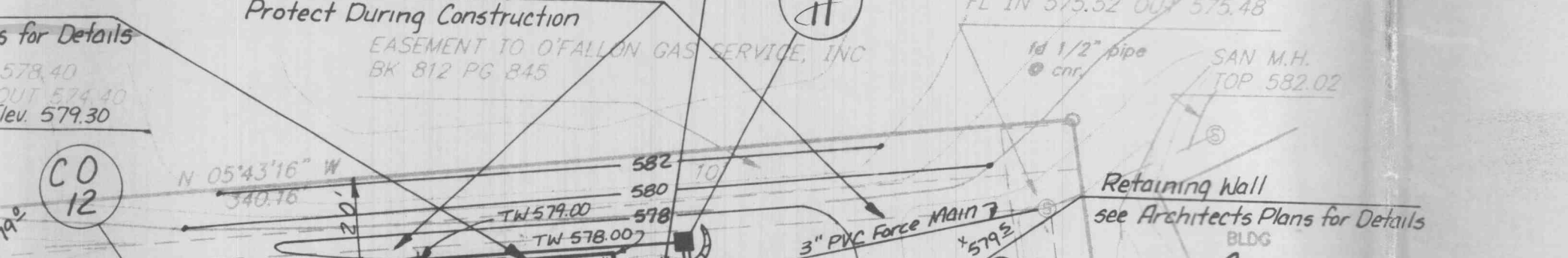

Exist. 8" PVC Sanitary Sewer, Protect During Construction

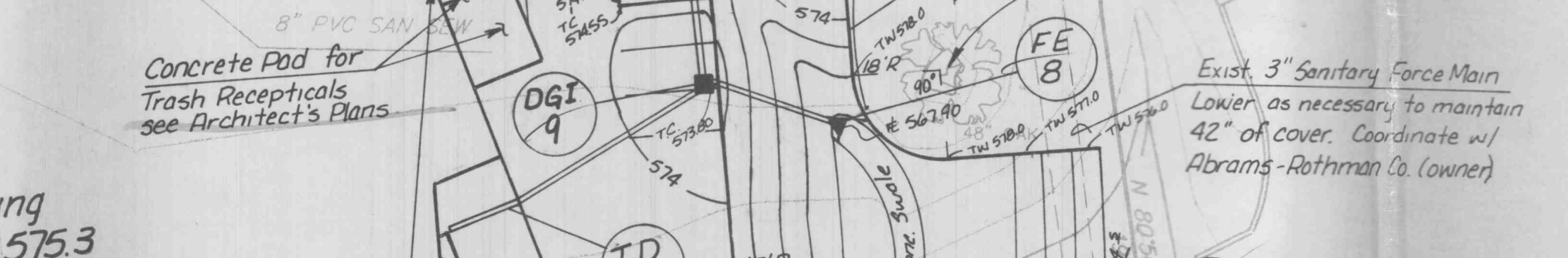

Concrete Pad for Trash Recepticals see Architects Plans



Truck Well w/ Conc. Slab see Architects Detail

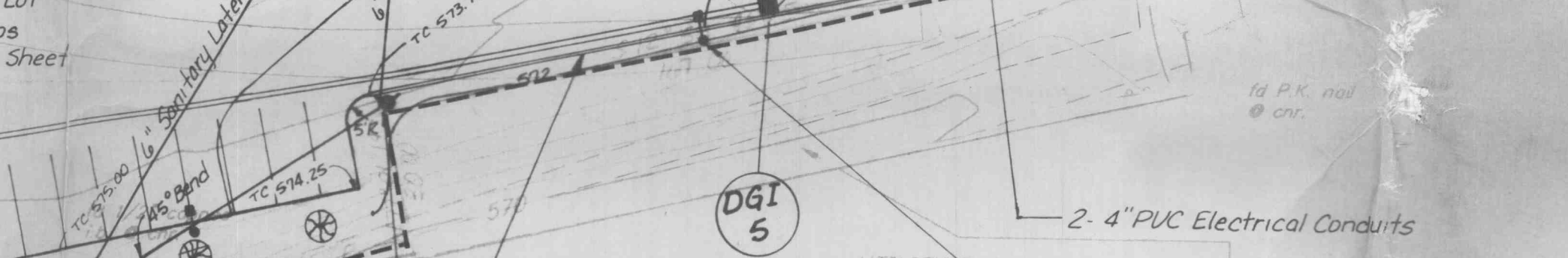

Type S Curb, 140 L.F. see detail, this sheet

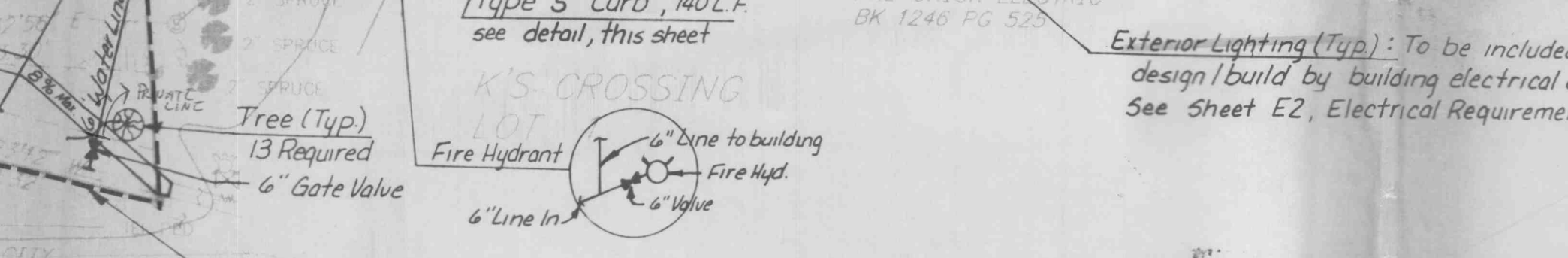

K'S CROSSING see detail, this sheet

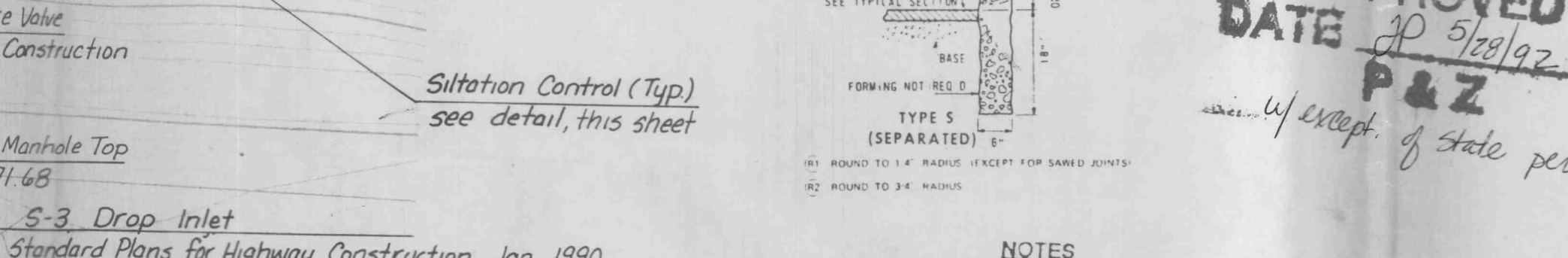

Fire Hydrant see detail, this sheet

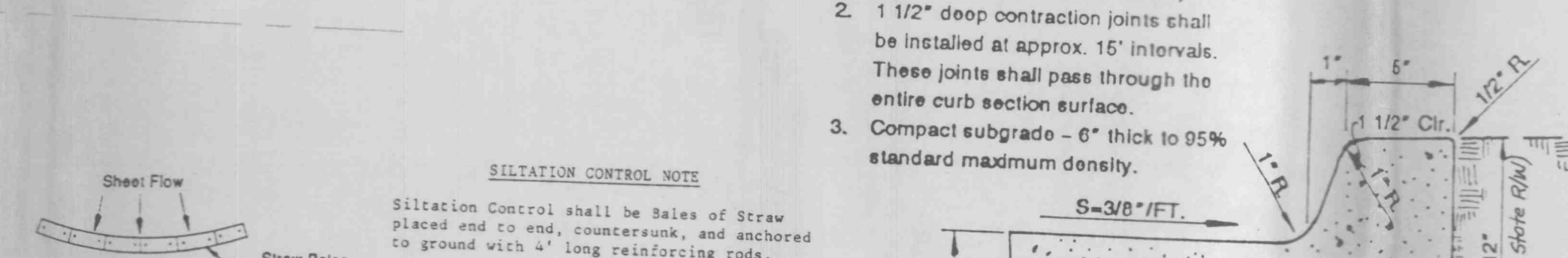

Siltation Control (Typ) see detail, this sheet

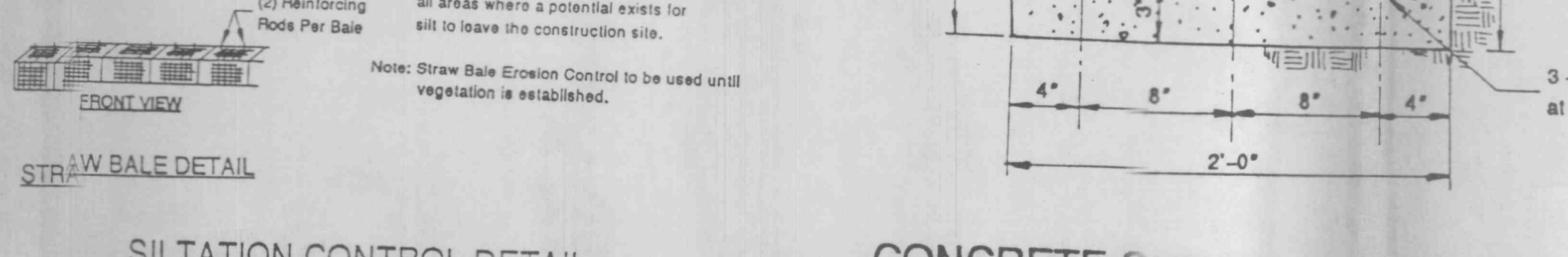

Siltation Control Detail N.T.S.

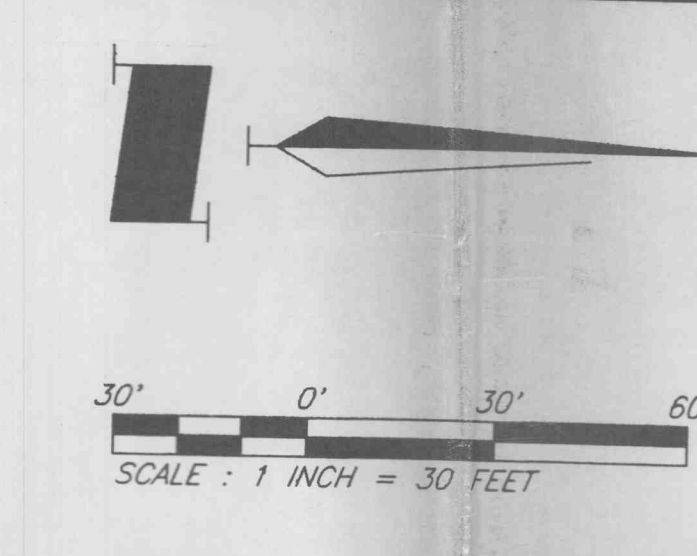

SCALE: 1 INCH = 30 FEET

GBA GEORGE BUTLER ASSOCIATES, INC. Engineers / Architects / Landscape Architects / Planners Kansas City, Mo. / Lenexa, Ka. / O'Fallon, Mo. / Ames, Ia. / Oklahoma City, Ok.		DATE: 3/19/92 DESIGN BY: PLL/MCV DRAWN BY: MCV PROJECT NO.: 6491
TRUE VALUE HARDWARE SITE PLAN O'FALLON, MO.		SHEET NO. G1 TOTAL SHEETS 6
REVISIONS Revised per MHTD & City of O'Fallon Comments		BY: MCV DATE: 4/3/92 MCV 4/22/92

- GENERAL NOTES
- Total area of property = 2.8963 Acres
 - Present Zoning C-2, General Business
 - Temporary Facilities: Light, Power, Water, and Toilet Facilities shall be provided by the General Contractor.
 - Protection: Each contractor shall protect his excavations: All excavations shall be kept free of water and lighted barricades shall be maintained.
 - Clean-Up: The General Contractor shall remove all debris from site. Tools, equipment, and scaffolding not in active use shall be removed.
 - Topsoil, sod, and debris to be removed from area of new construction. This includes existing concrete foundation and walks.
 - Excavate to produce an undisturbed soil bearing surface at required levels. Remove all soft spots in subgrade and fill with compacted granular fill.
 - Fill soils shall not contain organic material, vegetation, rubbish, clinders or frozen materials. Horizontal fills may be clay or granular fill. Remove all unacceptable or excess excavated material from site.
 - All existing underground utilities and services that are to remain are to be protected throughout construction.
 - Clayey Material: Deposit fill in 8" lifts, breakdown oversized lumps and mix to secure a uniform moisture content and compaction. After each lift has been spread and sprinkled if required, roll or tamp that lift uniformly over its entire area. Compact clayey fill to not less than 95% of maximum density at optimum moisture as determined by compaction tests.
 - Granular Material: Deposit fill in 1' lifts and compact as specified for granular materials. Pudding of granular material will not be permitted. Compact granular fill to not less than 95% of maximum density as determined by compaction tests.
 - All top, flowline and invert elevations shown have been established from the grading plan and/or topographic survey. The General Contractor shall verify all elevations upon grading completion to insure continuity with proposed and existing utilities.
 - All construction and materials required shall conform to the City of O'Fallon standards.
 - All reinforced concrete pipe to be Class II in unimproved areas. Class III shall be used under pavement.
 - All corrugated steel pipe shall be asphalt polymer, or aluminum coated, 16 gauge shall be installed in unimproved areas. In grade under pavement up to 42", 48" and above shall be 16 gauge in unimproved areas and 12 gauge under pavement. Corrugations shall be 2 1/2" x 1 1/2" up to 42" and 3" x 1" for 48" and above or equivalent for arch pipe.
 - All storm and sanitary trench backfills shall be water tested. Granular fill, compacted will be used under paved areas.
 - A 48" tall picket fence shall be constructed along the top of all retaining walls.
 - Gas, water and other underground utilities shall not conflict with the depth or horizontal location of existing and proposed sanitary and storm sewers, including laterals.
 - All filled places under buildings, proposed sanitary and storm sewer lines, and/or paved areas including trench backfills shall be compacted to 90% of maximum density as determined by the "Modified A.A.S.H.O. 150 Compaction Test" (ASTM D-1557). All tests will be verified by a Soils Engineer.
 - All grade shall be within 0.2 feet (more or less) of those shown on the grading plan.
 - No slope shall be greater than 3:1 and shall be either sodded or seeded and mulched.
 - All PVC water pipe shall have a minimum pressure rating of PR-200 or SDR-21.
 - All PVC sanitary sewer pipe shall be SDR-35 or equal with crushed stone bedding uniformly graded between 1" and 1 1/2" size. This bedding shall extend from 6" below the pipe to 12" inches above the top of the pipe.
 - Brick shall not be used on manholes.
 - The City of O'Fallon shall be notified at least 48 hours prior to construction of sanitary sewers for coordination and inspection.
 - All trees to be saved shall be protected during construction. Extreme care shall be taken to prevent soil compaction around the roots of existing trees, and no equipment or materials shall be stored within the dripline of trees to be saved.
 - Extreme care shall be taken when negotiating near trees to be saved. Root damage shall be kept to a minimum, but when it does occur, roots shall be sawcut.

APPROVED
DATE 5/22/92
P&Z
except of state permit

- NOTES
- #5 smooth dowels at expansion joints (tangent points on curve radius).
 - 1 1/2" deep contraction joints shall be installed at approx. 15' intervals. These joints shall pass through the entire curb section surface.
 - Compact subgrade - 6" thick to 95% standard maximum density.

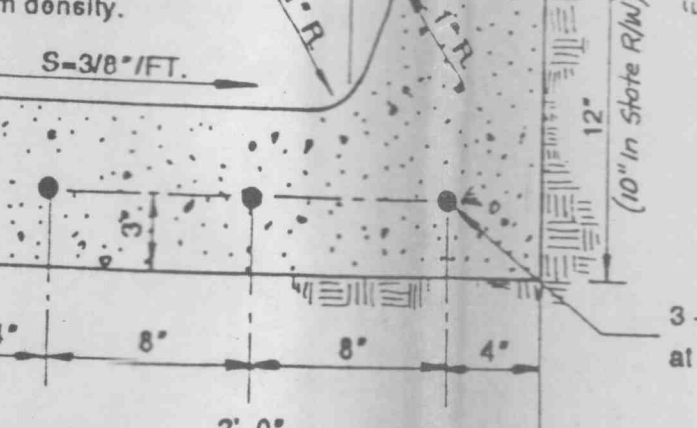

CONCRETE CURB & GUTTER DETAIL N.T.S.

This tract is served by:
Sewers - City of O'Fallon (9981) - 281-2058
Water - City of O'Fallon (9981) - 281-2858
Electric - Union Electric Company - 322-6203
Gas - St. Charles Gas Company - 535-7700
Telephone - GTE, Inc. - 327-3114
Fire - O'Fallon Fire Protection District - 272-3031

FILE APPROVED AS NOTED
5-29-92
Frank Dodson

