

SUBMITTALS			
A	04/21/05	ISSUED FOR REVIEW	ANP
0	05/03/05	ISSUED FOR CONSTRUCTION	MTG
1	05/27/05	REVISED PER CLIENT COMMENTS	FG

THE INFORMATION CONTAINED IN THIS SET OF DOCUMENTS IS PROPRIETARY BY NATURE. ANY USE OR DISCLOSURE OTHER THAN THAT WHICH RELATES TO US CELLULAR COMMUNICATIONS INC. IS STRICTLY PROHIBITED.

SITE NAME
CITY OF O'FALLON
 (USCC SITE NAME: ST. PAUL)
 321 FIRMA ROAD
 O'FALLON, MISSOURI 63366

SHEET TITLE
GRADING PLAN

SHEET NUMBER
A-4

NOTE:

FOR COORDINATE LOCATION OF TOWER COMPOUND, SEE DRAWING A-1.

GRADING NOTES:

1. STRIP THE GROUND OF ALL VEGETATION AND DEBRIS.
2. PROOF ROLL WITH LOADED TANDEM TRUCKS TO IDENTIFY SOFT SPOTS.
3. REMOVE SOFT SPOT MATERIAL AND COMPACT TO 95% AT STRUCTURE, 90% ELSEWHERE.
4. INSTALL GEOTEXTILE FABRIC ON PREPARED SUBGRADE.
5. SEE SPECIFICATIONS DRAWINGS FOR REQUIREMENTS OF BACKFILL MATERIAL.
6. MAINTAIN REASONABLE DUST CONTROL METHODS DURING CONSTRUCTION.
7. ENTIRE DRIVE LENGTH SHALL BE POSITIVE DRAINING DURING, AND AT COMPLETION OF CONSTRUCTION.

SILTTRATION NOTES:

1. SILTRATION CONTROL DEVICES TO REMAIN IN PLACE UNTIL ADEQUATE VEGETATION GROWTH INSURES NO FURTHER EROSION OF THE SOIL.
2. SILTRATION FENCES SHALL BE INSPECTED PERIODICALLY FOR DAMAGE AND FOR THE AMOUNT OF SEDIMENTATION WHICH HAS ACCUMULATED. REMOVAL OF SEDIMENT WILL BE REQUIRED WHEN IT REACHES 1/2 FENCE HEIGHT.
3. ATTACHMENT OF GEOTEXTILE FABRIC TO BE IN ACCORDANCE WITH THE MANUFACTURER'S RECOMMENDATIONS.
4. SILT FENCING TO BE USED AT ALL AREAS OF EXCAVATION.

FIRM PANEL NUMBER (#2918C0230F)

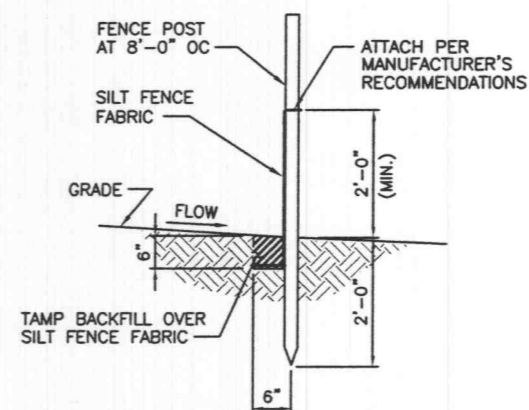

SILT FENCE DETAIL
NO SCALE

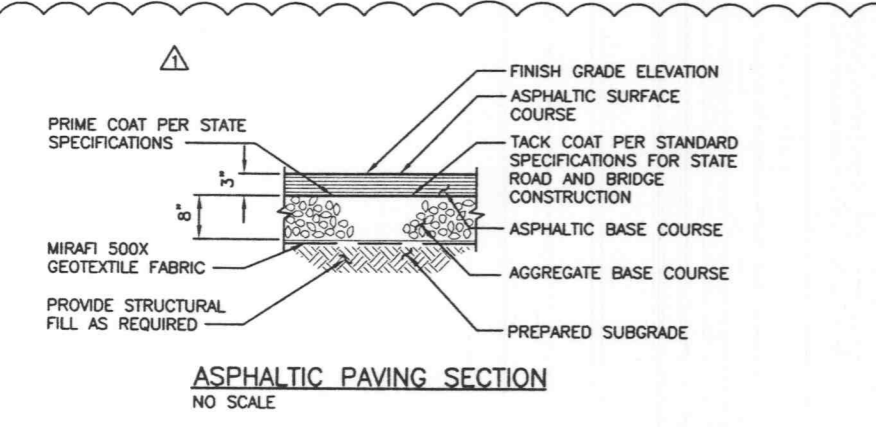
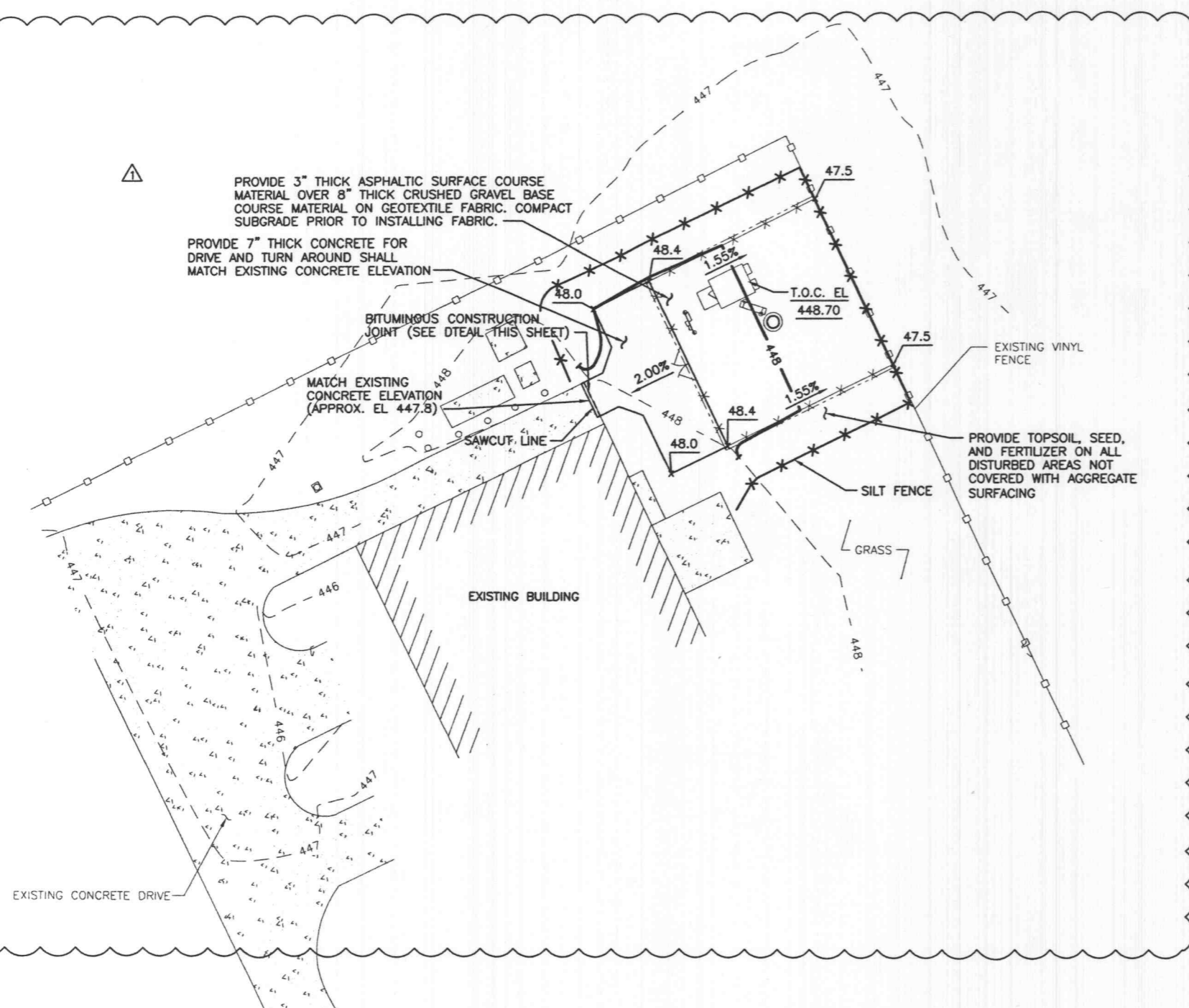

ASPHALTIC PAVING SECTION
NO SCALE

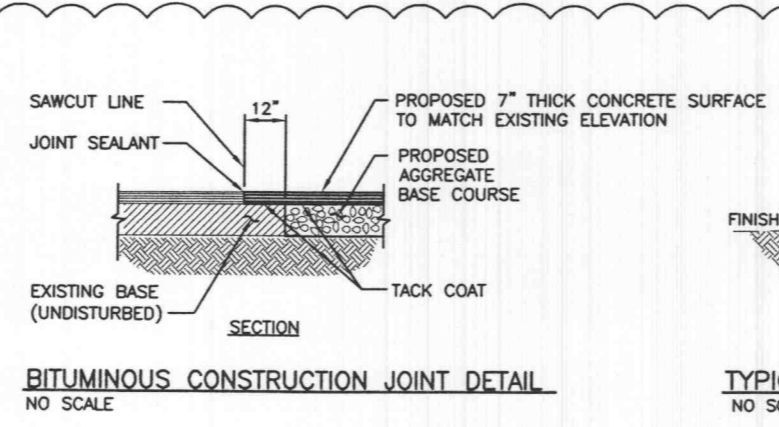

BITUMINOUS CONSTRUCTION JOINT DETAIL
NO SCALE

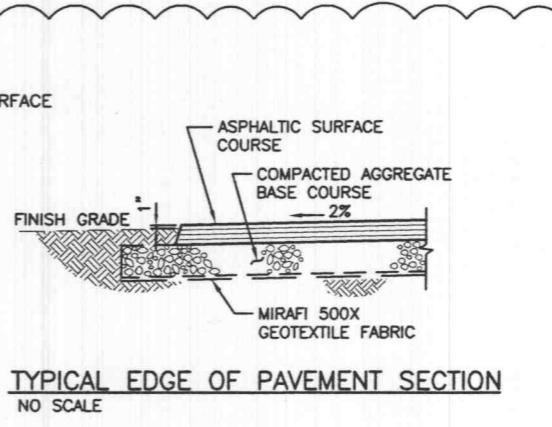

TYPICAL EDGE OF PAVEMENT SECTION
NO SCALE

