

NO.	DATE	DESCRIPTIONS
10-8-91	EP-5ET	

Joseph Kent Deaton, Inc.
 Consulting Engineers
 117
 Fenton, Missouri 63026
 314/343-4774
 K2 Consultants, Inc.
 Engineering Services
 Bloomington, Missouri 63827
 314/483-9728

PHOTOGRAPHIC STUDIO WAREHOUSE
 VENTURE STORES INCORPORATED
 1835 EAST TERRA
 CITY OF O'FALLON, MISSOURI

Farnsworth
 Reinhardt
 Polk, Inc.

architects & engineers
 144 W. Lockwood Ave.
 St. Louis, Mo. 63119
 Phone: (314)982-7900
 Fax: (314)982-1253

TITLE:
 HIGH BAY
 SPRINKLER PLAN
 DATE:
 PROJECT NO: 92106.1

SHEET:
 FP-1

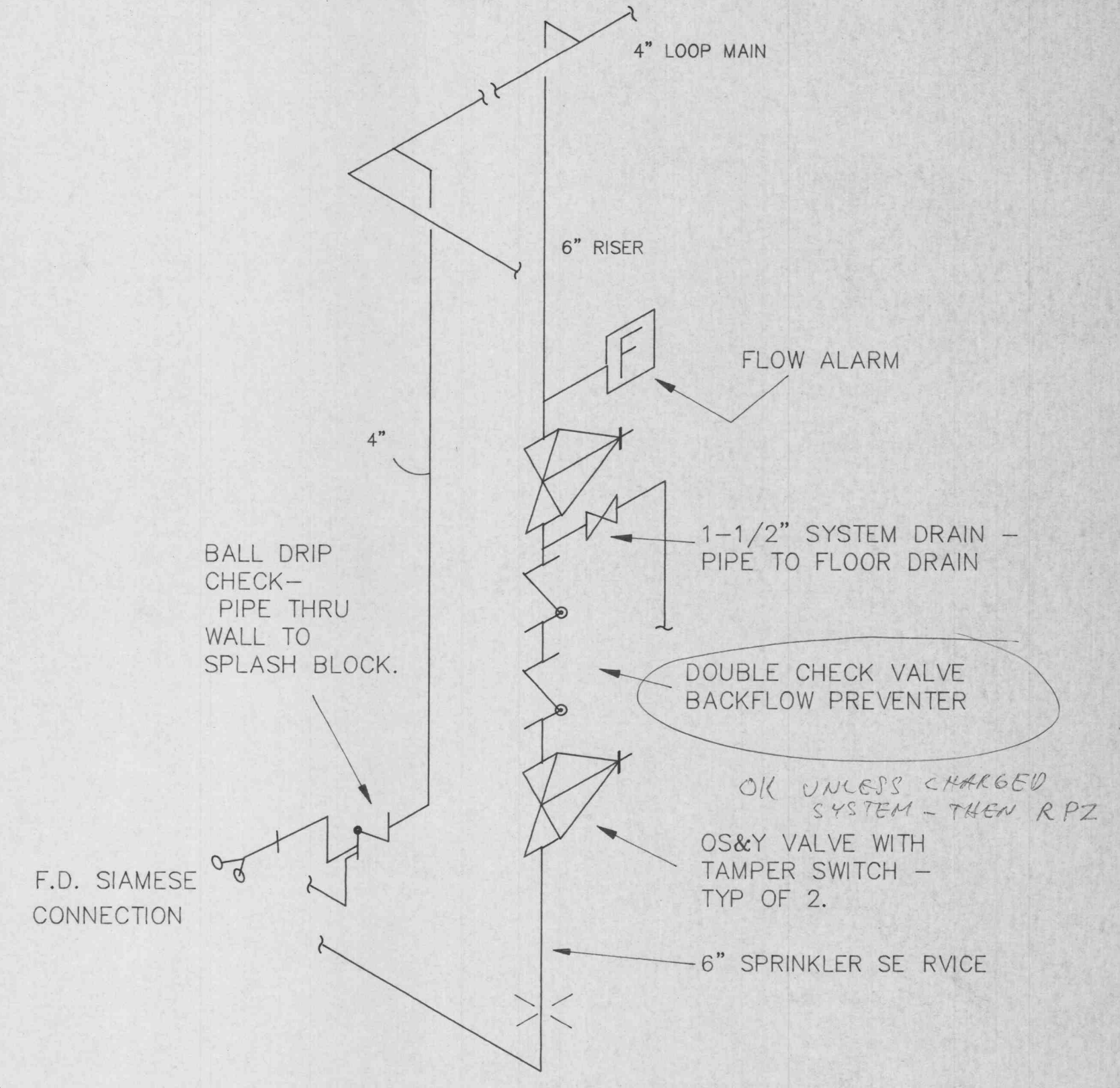
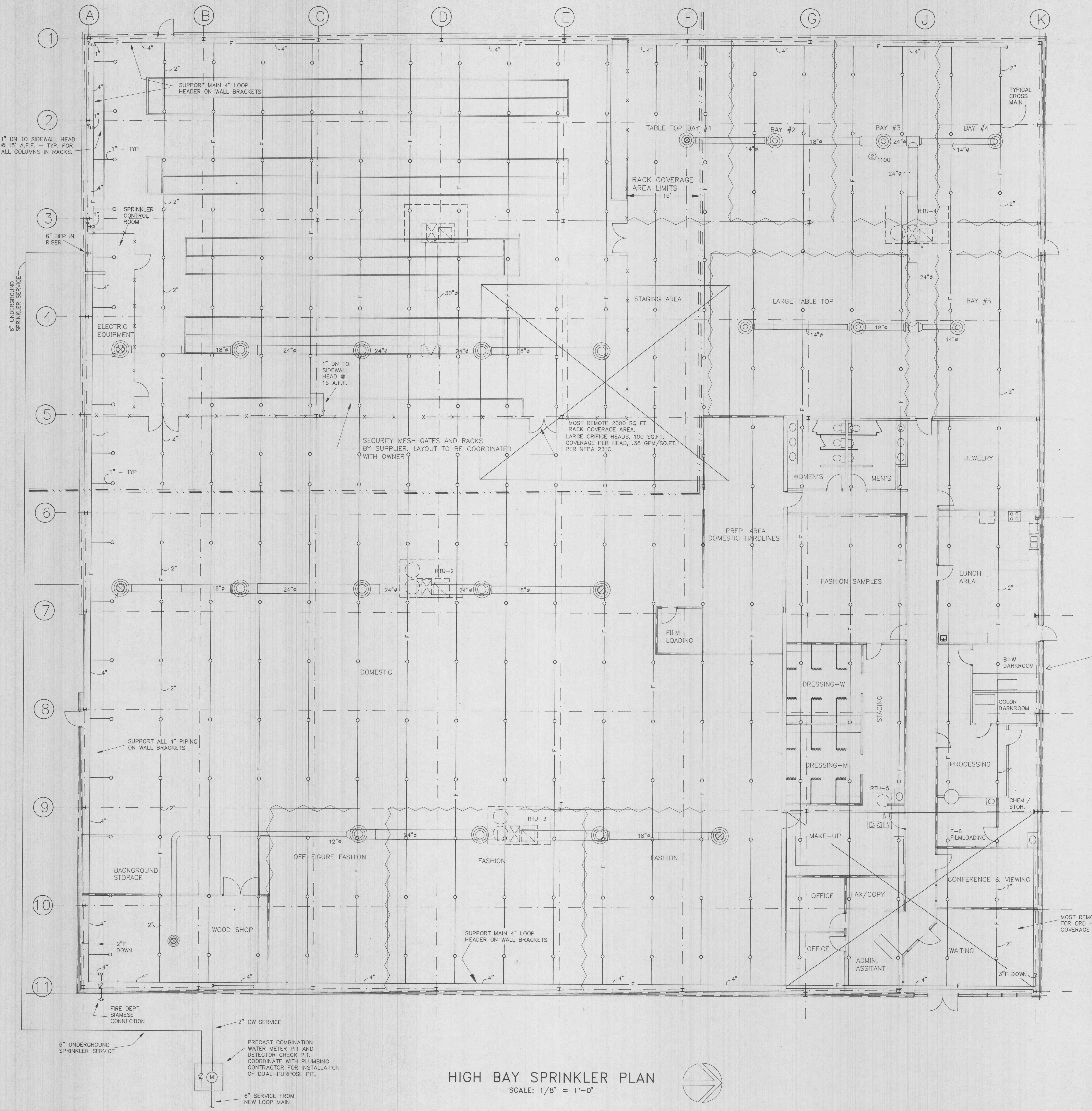

SPRINKLER RISER DIAGRAM
 NO SCALE

SPRINKLER SYSTEM DESIGN CRITERIA
 PIPING SHOWN IS BASED ON HYDRAULICALLY CALCULATED PIPE SIZING WITH 50 PSI RESIDUAL PRESSURE FROM NEW LOOP MAIN ASSUMED. CONTRACTOR SHALL FOLLOW THE GENERAL ARRANGEMENT INDICATED IN LAYING OUT INSTALLATION DRAWINGS. HYDRAULIC CALCULATIONS SHALL BE SUBMITTED WITH THE SHOP DRAWINGS SHOWING PROPER COVERAGE OF ALL AREAS. CONTRACTOR MAY MAKE CHANGES IN THE PIPING DESIGN TO ACCOMMODATE PREFERRED INSTALLATION ARRANGEMENT, PROVIDED THAT REQUIRED COVERAGE IS SUPPLIED FOR ALL AREAS.
 SAMPLE ROOM IS HIGH PILED RACK STORAGE - REQUIRED DENSITY .38 GPM/SQ.FT. PER NFPA 231C.
 OPEN AREAS ARE ORDINARY HAZARD, GROUP 2 - .19 GPM/SQ.FT.
 WOOD SHOP IS ORDINARY HAZARD, GROUP 2 - .19 GPM/SQ.FT.
 OFFICE AREA IS LIGHT HAZARD - .1 GPM/SQ.FT.

HIGH BAY SPRINKLER PLAN
 SCALE: 1/8" = 1'-0"