

Drawing name: K:\0312269_Springhurst\dwg\Improvements\2269\MPREC.DWG Plotted on Jan 30, 2006 - 8:40am Plotted by gester

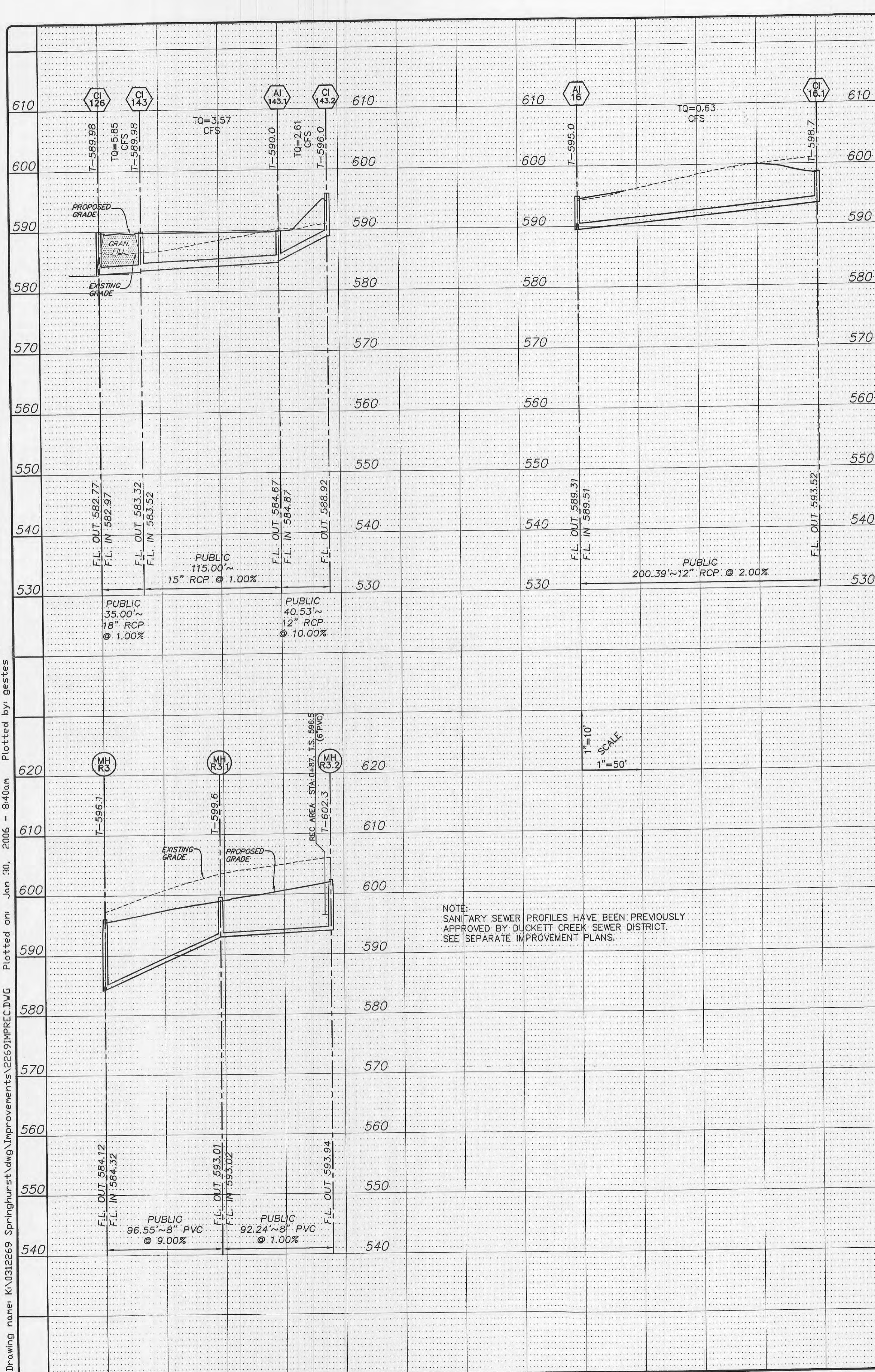

NOTE:
STORM SEWER PROFILES HAVE BEEN PREVIOUSLY
APPROVED BY THE CITY OF FALLON.
SEE SEPARATE IMPROVEMENT PLANS.

STDM SEWER HYDRAULICS

Job Name: THE VILLAGES AT SPRINGHURST
 Prepared by: [Name] Job No: 0312269 Sheet No: [Number]
 Date: [Date] Checked by: [Name] Revised: [Date]

Upper Str. No.	Lower Str. No.	Len. In	Q C.F.S.	Total Q C.F.S.	Pipe Size In.	Const. F.P.S.	V In Ft.	Hyd. Grade	Flow Line Elevation Upper	Flow Line Elevation Lower	Top of Structure Elevation Upper	Top of Structure Elevation Lower	Free Board	Hydraulic Grade Line Upper	Hydraulic Grade Line Lower	Frict. Loss Ft.	Curve Loss Ft.	Junc. Loss Ft.	Entr. Loss Ft.	Angle (S)	Turn Loss (S)	Capacity C.F.S.	Q/Cap.	Normal Depth Ft.
T 1432	AI 1431	40.53	2.61	2.61	18	9.99%	3.32	0.17	0.45	588.92	584.87	596.00	590.00	6.76	589.24	586.63	0.22	0.12	0.17	40	0.07	11.26	0.23	0.32
AI 1431	AI 143	115	0.96	3.57	15	1.00%	3.91	0.13	0.47	584.67	583.52	590.00	589.98	3.37	586.55	586.20	0.35	0.11	0.11	60	0.09	10.50	0.56	0.80
AI 143	CI 126	95	0.28	3.85	18	1.00%	3.31	0.17	1.00	583.32	582.97	589.98	589.98	3.78	586.08	585.97	0.11	0.15	0.15	45	0.33	66.72	0.71	1.86
CI 126	DCI 124	36.89	2.61	6.47	36	1.00%	6.73	0.70	33.48	582.77	581.16	589.98	589.32	4.01	585.47	585.16	0.31	0.10	0.10	10	0.09	66.80	0.75	1.92
DCI 124	CI 123	71.92	1.56	8.03	36	3.98%	7.32	0.83	43.07	581.39	578.53	589.10	586.45	4.22	584.70	584.27	0.43	0.04	0.04	70	0.50	33.01	0.39	1.29
CI 123	CI 122	27.5	0.57	8.60	36	1.00%	7.41	0.89	44.74	578.33	577.98	586.45	586.45	2.19	585.73	583.51	0.22	0.04	0.04	66	0.70	66.70	0.79	1.98
CI 122	T 120	1191	12	54.99	42	1.00%	5.72	0.51	27.89	575.59	575.47	583.92	583.50	4.76	579.16	579.12	0.04	0.08	0.08	25	0.15	100.61	0.55	1.82
MH 1191	T 16	1	0.63	6.12	12	2.00%	0.80	0.01	0.01	593.52	589.51	598.70	595.00	4.95	593.75	590.52	0.06	0.01	0.01	35	0.04	5.04	0.13	0.23
T 16	AI 15	15	2.13	8.25	12	3.00%	3.39	0.45	1.91	589.31	578.12	595.00	583.20	4.48	589.82	581.19	3.16	0.30	0.30	90	0.30	16.62	0.33	0.59
AI 15	MH 4	3	6.81	14.96	27	1.19%	6.06	0.57	13.73	574.32	574.00	582.20	576.25	1.57	579.96	579.80	0.16	0.00	0.00	33	0.84	33.84	0.71	1.40
MH 4	T 2	1	25.59	40.55	30	1.00%	5.21	0.42	10.80	572.38	571.80	580.22	574.30	5.69	574.53	574.30	0.23	0.00	0.00	41	0.02	41.02	0.62	1.43

NOTE: AI=Area Inlet, M=Manhole, T=Terminal Structure, CI=Curb Inlet, DCI=Double Curb Inlet, SCI=Skewed Curb Inlet, TP=Tangent Point, EP=End of Pipe, OS=Outfall Structure
 n=0.013 For RCP, 0.024 For CMP For Drainage Areas, P.I. & Bypass, See Drainage Area Map

 NOTE: AI=Area Inlet, M=Manhole, T=Terminal Structure, CI=Curb Inlet, DCI=Double Curb Inlet, SCI=Skewed Curb Inlet, TP=Tangent Point, EP=End of Pipe, OS=Outfall Structure
 n=0.013 For RCP, 0.024 For CMP For Drainage Areas, P.I. & Bypass, See Drainage Area Map

NOTE:
SANITARY SEWER PROFILES HAVE BEEN PREVIOUSLY
APPROVED BY DUCKETT CREEK SEWER DISTRICT.
SEE SEPARATE IMPROVEMENT PLANS.

1"=10'
1"=50'

ISSUE REMARKS/DATE
 1 09-23-05 FIRST SUBMITTAL
 2 11-22-05 REVISED PER CITY COMMENTS

PREPARED FOR:
THE VILLAGES AT SPRINGHURST, L.L.C.
 5091 NEW BAUMGARTNER ROAD
 ST. LOUIS, MISSOURI 63129
 (314) 487-8717

PREPARED BY:
THE STERLING CO.
 ENGINEERS & SURVEYORS
 5055 NEW BAUMGARTNER ROAD
 ST. LOUIS, MISSOURI 63129
 (314) 487-0440 FAX 487-8944
 E-Mail: Sterling@sterling-eng-sur.com

DRAWN: [Name] DESIGNED: [Name] CHECKED: [Name]

PROJECT: THE VILLAGES AT SPRINGHURST SHEET TITLE: SANITARY & STORM SEWER PROFILES

NO. 03 12 269 M.S.D. P# 3.1 SHEET OF

DIGITAL FILE LOCATION: SERVER=STERLING-2 0312269.dwg

SANITARY SEWER LATERALS SHALL BE 4" P.V.C. UNLESS NOTED OTHERWISE.

BASE MAP PC#2804