

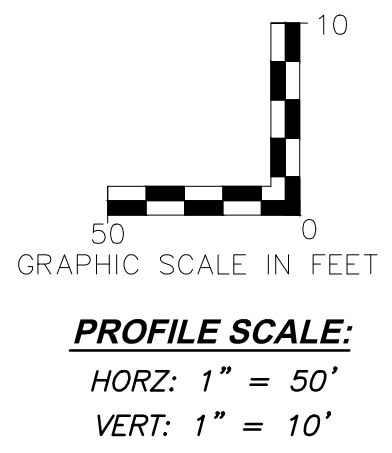

\\PFS-SBS201\Projects\44055\MCH0\dwg\Design\OUT\TRU\Improvement_Plan\05-14055_STREET_PROFILES.dwg

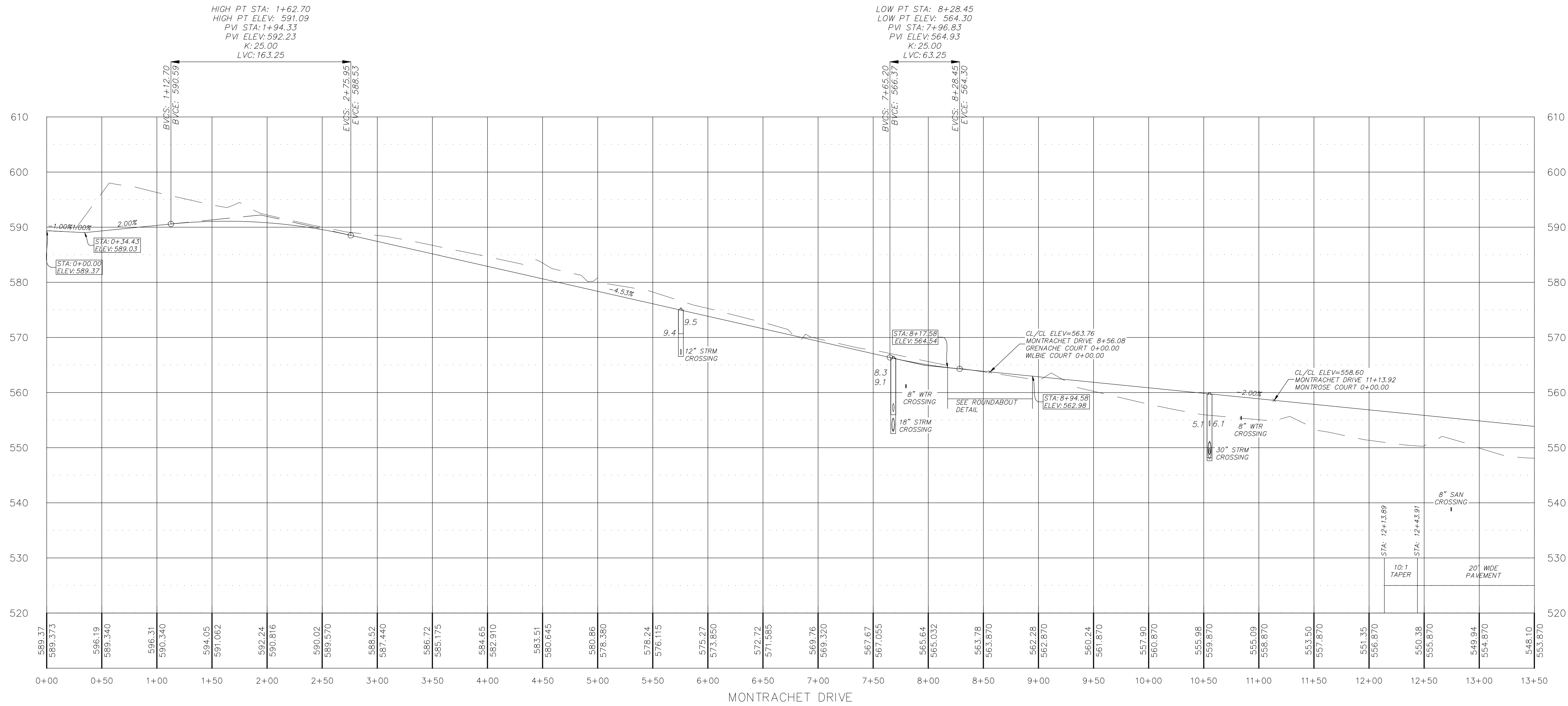

PROJECT TITLE
IMPROVEMENT PLANS
THE VILLAGES AT
MONTRACHET
STREET PROFILES

PICKETT, RAY & SILVER INC
CIVIL ENGINEERING, LAND SURVEYING,
AND NATURAL RESOURCES SERVICES
 St. Peters
 22 Richmond Center Court
 St. Peters, MO 63376
 Phone (636) 397-1211 Fax (636) 397-1104
 www.prs.com 1-800-708-3918

ENGINEER'S AUTHENTICATION
 THE RESPONSIBILITY FOR PROFESSIONAL ENGINEERING LIABILITY ON THIS PROJECT IS SEVERELY LIMITED TO THE SET OF PLANS AUTHENTICATED BY THE SEAL, SIGNATURE, AND DATE HEREON ATTACHED. RESPONSIBILITY IS DISCLAIMED FOR ALL OTHER ENGINEERING PLANS PROVIDED IN THIS PROJECT AND SPECIFICALLY EXCLUDES REVISIONS AFTER THIS DATE UNLESS REAUTHENTICATED.
PICKETT, RAY & SILVER, INC. MO
 LICENSE #0000000000

 01-25-16 ELECTRONIC SEAL
 KARL A. SCHOENIKE, P.E.
 PROFESSIONAL ENGINEER LICENSE 2003015039

Developer / Owner Information
MONTRACHET DEVELOPMENT LLC
 218 Chesterfield Towne Centre
 Chesterfield, Missouri 63005
 Phone: 636-530-6900

P+Z No. 15-15.01
City No. 15-742-SP
Page No. STREET PROFILES
22 of 63

DCSD APPROVED 11/30/15 PERMIT NUMBER 2015-2-005 CITY OF FALLON APPROVED 01/25/16 PWS #2 APPROVED 12/30/15