

MONTRACHET DRIVE AND SOUTH OUTER 364
SCALE 1"= 20'

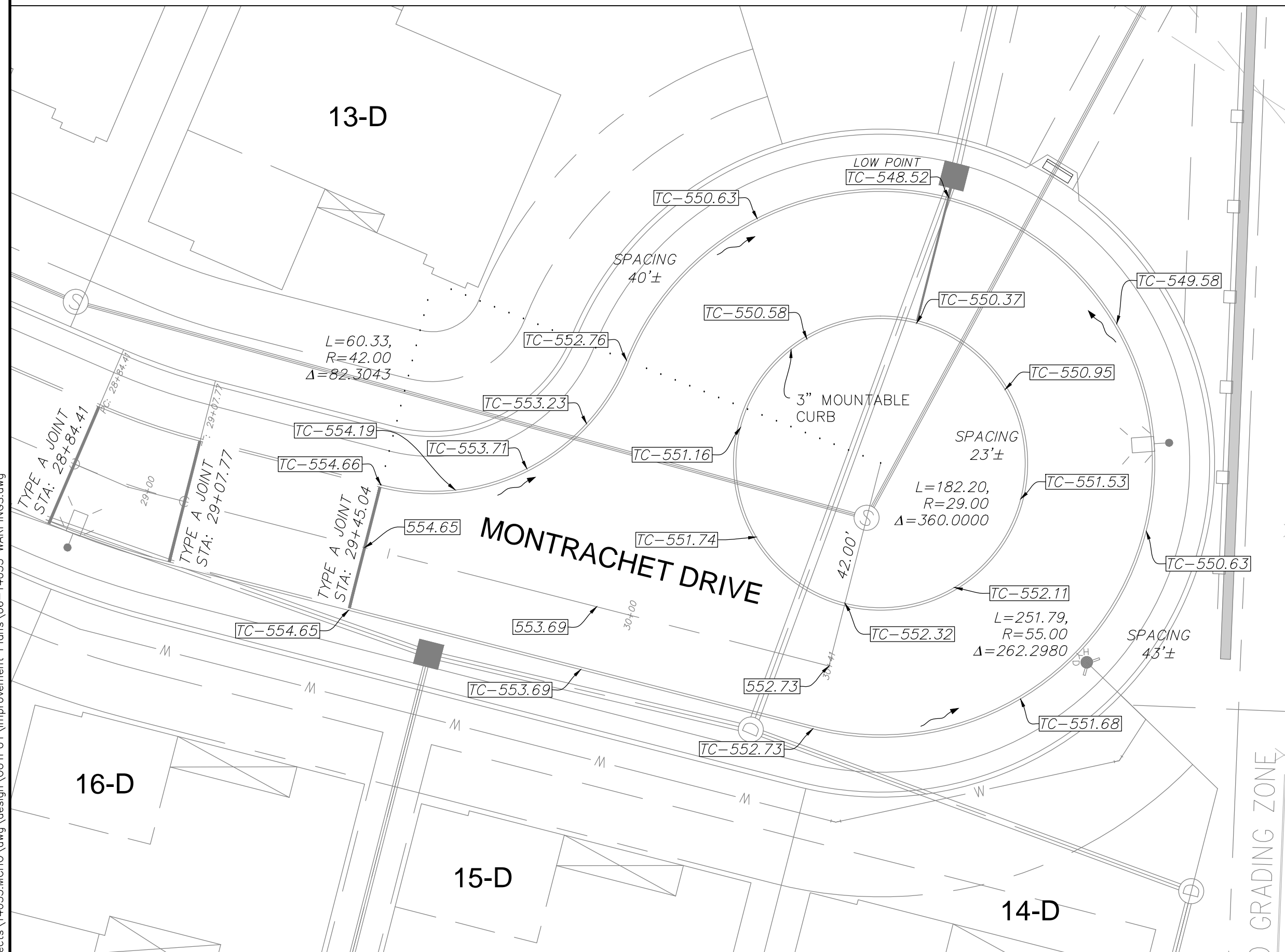

MONTRACHET DRIVE CUL-DE-SAC
SCALE 1"= 20'

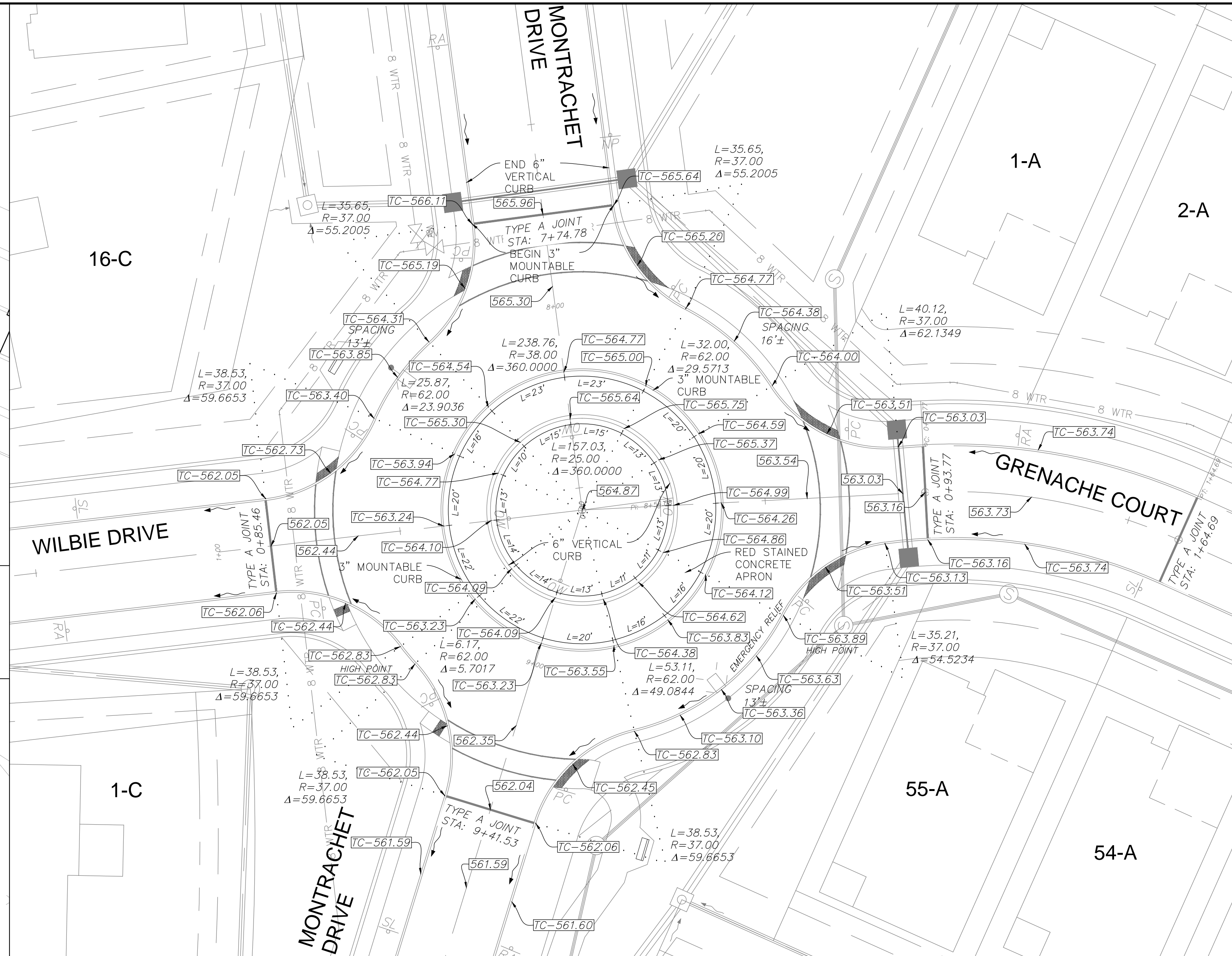

ROUND-A-BOUT
SCALE 1"= 20'

WARPING NOTES:

1. ALL SPOTS LABELED AS TC ARE TOP BACK OF CURB ELEVATIONS.
2. ALL OTHER SPOTS ARE PAVEMENT ELEVATIONS.
3. SPOT ELEVATIONS ARE SPACED AT THE QUARTER DELTA OF THE ROUNDINGS.
4. ALL CURBS ARE 3" (0.25') TALL, UNLESS OTHERWISE NOTED.

PROJECT TITLE
IMPROVEMENT PLANS
THE VILLAGES AT
MONTRACHET
PAVEMENT WARPINGS

PFS No. 14055MCHO00P
TASK 001 FIELD BOOK 1476

PICKETT, RAY & SILVER INC
CIVIL ENGINEERING, LAND SURVEYING,
AND NATURAL RESOURCES SERVICES

St. Peters
22 Richmond Center Court
St. Peters, MO 63376
Phone (636) 397-1211 Fax (636) 397-1104
www.prs.com 1-800-708-3818

ENGINEER'S AUTHENTICATION
THE RESPONSIBILITY FOR PROFESSIONAL ENGINEERING
LIABILITY ON THIS PROJECT IS SEVERELY LIMITED TO THE
SET OF PLANS AUTHENTICATED BY THE SEAL, SIGNATURE,
AND DATE HEREON ATTACHED. RESPONSIBILITY IS
DISCLAIMED FOR ALL OTHER ENGINEERING PLANS
INVOLVED IN THIS PROJECT AND SPECIFICALLY EXCLUDES
REVISIONS AFTER THIS DATE UNLESS REAUTHENTICATED.

PICKETT, RAY & SILVER, INC. MO
LICENSE #003326

Karl Anthony Schoenike
KARL ANTHONY SCHOENIKE
PROFESSIONAL ENGINEER
NUMBER PE-2003015038

01-25-16 ELECTRONIC SEAL
KARL A. SCHOENIKE, P.E.
PROFESSIONAL ENGINEER LICENSE 2003015038

Developer / Owner Information
MONTRACHET DEVELOPMENT LLC
218 Chesterfield Towne Centre
Chesterfield, Missouri 63005
Phone: 636-530-6900

P+Z No. 15-15.01
City No. 15-742-SP
Page No. PAVEMENT WARPINGS
26 of 63

\\PFS-5852011\Projects\14055MCHO\Design\CU\TRUP\Improvement Plans\06-14055 WARPINGS.dwg

DCSD APPROVED 11/30/15 PERMIT NUMBER 2015-2-005 CITY OF O'FALLON APPROVED 01/25/16 PWS #2 APPROVED 12/30/15