

\\PFS-5852011\Projects\14055\MCH0\Design\OUTPUT\Improvement Plans\07-14055 SANITARY PROFILES.dwg

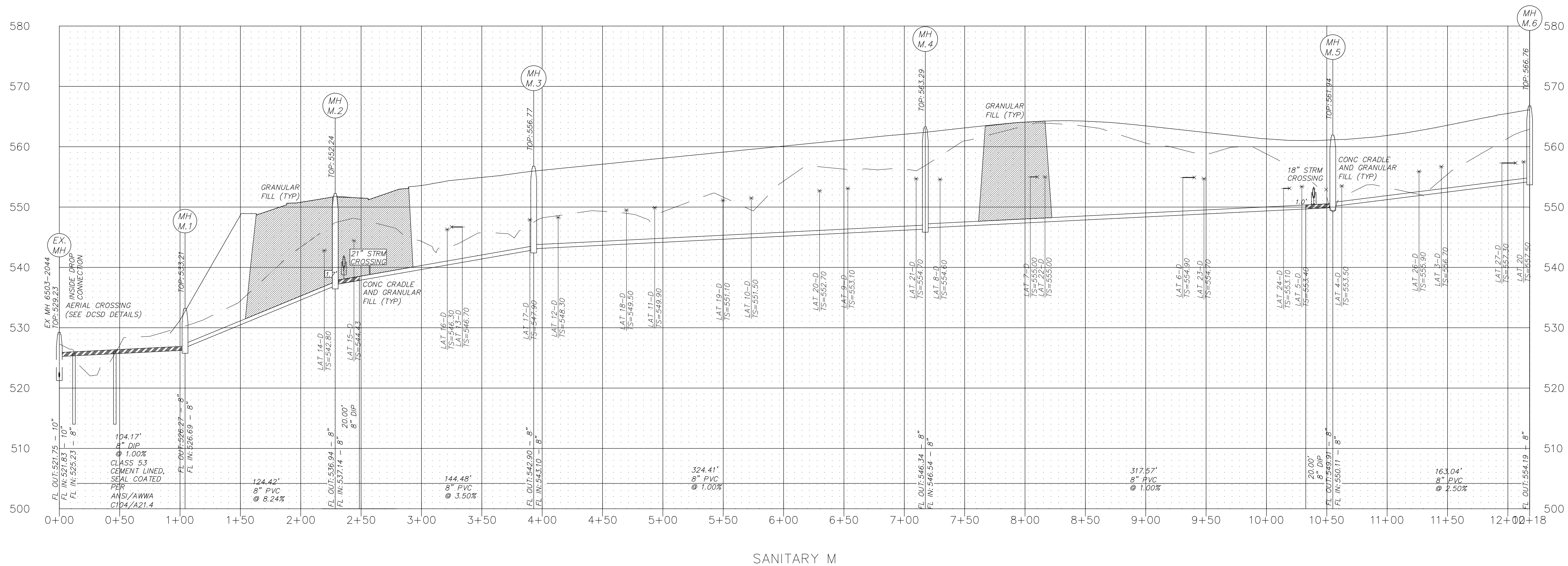

SANITARY M

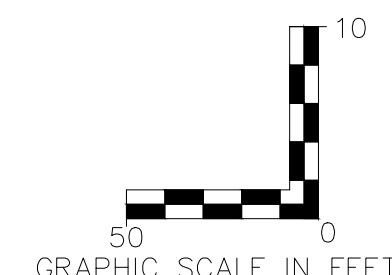

**PROFILE SCALE:**  
 HORIZ: 1" = 50'  
 VERT: 1" = 10'

**NOTES:**

- ALL SANITARY LATERAL AND SANITARY MAINS CROSSING UNDER PAVEMENT, IF TRENCHED, LIE WITHIN TEN (10) FEET OF THE EDGE OF PAVEMENT OR WITHIN THE 1:1 SHEAR PLANE SHALL BE BACKFILLED WITH GRANULAR MATERIAL (AGGREGATE) AND COMPACTED.
- IF THE STORM AND SANITARY SEWERS ARE PARALLEL AND IN THE SAME TRENCH OR OVERDIG, THE UPPER SHALL BE PLACED ON A SHELF AND THE LOWER SHALL BE BEDDED IN COMPACTED GRANULAR FILL TO THE FLOW LINE OF THE UPPER.
- WHEN STORM SEWERS PIPES WHICH CROSS OVER EXISTING OR PROPOSED SANITARY SEWER OR WATER MAIN TRENCH, PROVIDE COMPACTED GRANULAR BACKFILL FROM THE TOP OF THE SANITARY SEWER OR WATER MAIN TO THE BOTTOM OF THE STORM SEWER AND CONSTRUCT CONCRETE CRADLE TO THE RCP STORM SEWER PIPE AND CONCRETE ENCASE HDPE STORM SEWER PIPE WHEN IT IS MORE THAN 18 INCHES ABOVE THE SANITARY SEWER ACROSS THE FULL WIDTH OF THE TRENCH. WHEN THE STORM SEWER IS LESS THAN 18" SEPARATION, BOTH PIPES ARE TO BE ENCASED IN CONCRETE. PROVIDE TWENTY (20) FEET OF DUCTILE IRON PIPE WHERE THE SANITARY SEWER CROSSES OVER THE STORM SEWER TRENCH.
- ALL NEW SANITARY LATERALS SHALL BE CONSTRUCTED WITH A MINIMUM TWO (2) PERCENT SLOPE.
- ONE FULL SECTION OF WATER PIPE SHALL BE CENTERED OVER THE TRENCH AT ALL WATER MAIN CROSSINGS.
- EXISTING SANITARY SEWER SERVICE SHALL NOT BE INTERRUPTED.
- CONNECTIONS TO EXISTING SANITARY AND CONSTRUCTION OF NEW SANITARY SEWERS REQUIRES DCSD INSPECTION. CONTACT STEVE OVERBEY, DCSD CHIEF INSPECTOR, AT 636-441-1244 TO SCHEDULE INSPECTIONS. 48 HOURS ADVANCE NOTICE IS REQUIRED.

**PROJECT TITLE**  
 IMPROVEMENT PLANS  
 THE VILLAGES AT  
 MONTRACHET  
 SANITARY PROFILES

**PICKETT, RAY & SILVER INC**  
 CIVIL ENGINEERING, LAND SURVEYING,  
 AND NATURAL RESOURCES SERVICES  
 St. Peters  
 22 Richmond Center Court  
 St. Peters, MO 63376  
 Phone (636) 397-1211 Fax (636) 397-1104  
 www.prsinc.com 1-800-708-3818

**ENGINEER'S AUTHENTICATION**  
 THE RESPONSIBILITY FOR PROFESSIONAL ENGINEERING LIABILITY ON THIS PROJECT IS LIMITED TO THE SET OF PLANS AUTHENTICATED BY THE SEAL, SIGNATURE, AND DATE HEREON ATTACHED. RESPONSIBILITY IS DISCLAIMED FOR ALL OTHER ENGINEERING PLANS PROVIDED IN THIS PROJECT AND SPECIFICALLY EXCLUDES REVISIONS AFTER THIS DATE UNLESS REAUTHENTICATED.

**PICKETT, RAY & SILVER, INC. MO. LICENSE #000038**

*Karl Anthony Schoenike*  
 KARL ANTHONY SCHOENIKE  
 NUMBER  
 PE-2003015038  
 PROFESSIONAL ENGINEER

01-25-16 ELECTRONIC SEAL  
 KARL A. SCHOENIKE, P.E.  
 PROFESSIONAL ENGINEER LICENSE 2003015038

**Developer / Owner Information**  
 MONTRACHET DEVELOPMENT LLC  
 218 Chesterfield Towne Centre  
 Chesterfield, Missouri 63005  
 Phone: 636-530-6900

P+Z No. 15-15.01  
 City No. 15-742-SP

Page No.  
 SANITARY PROFILES  
 33 of 63

DCSD APPROVED 11/30/15 PERMIT NUMBER 2015-2-005 CITY OF O'FALLON APPROVED 01/25/16 PWS #2 APPROVED 12/30/15