

STORM 12

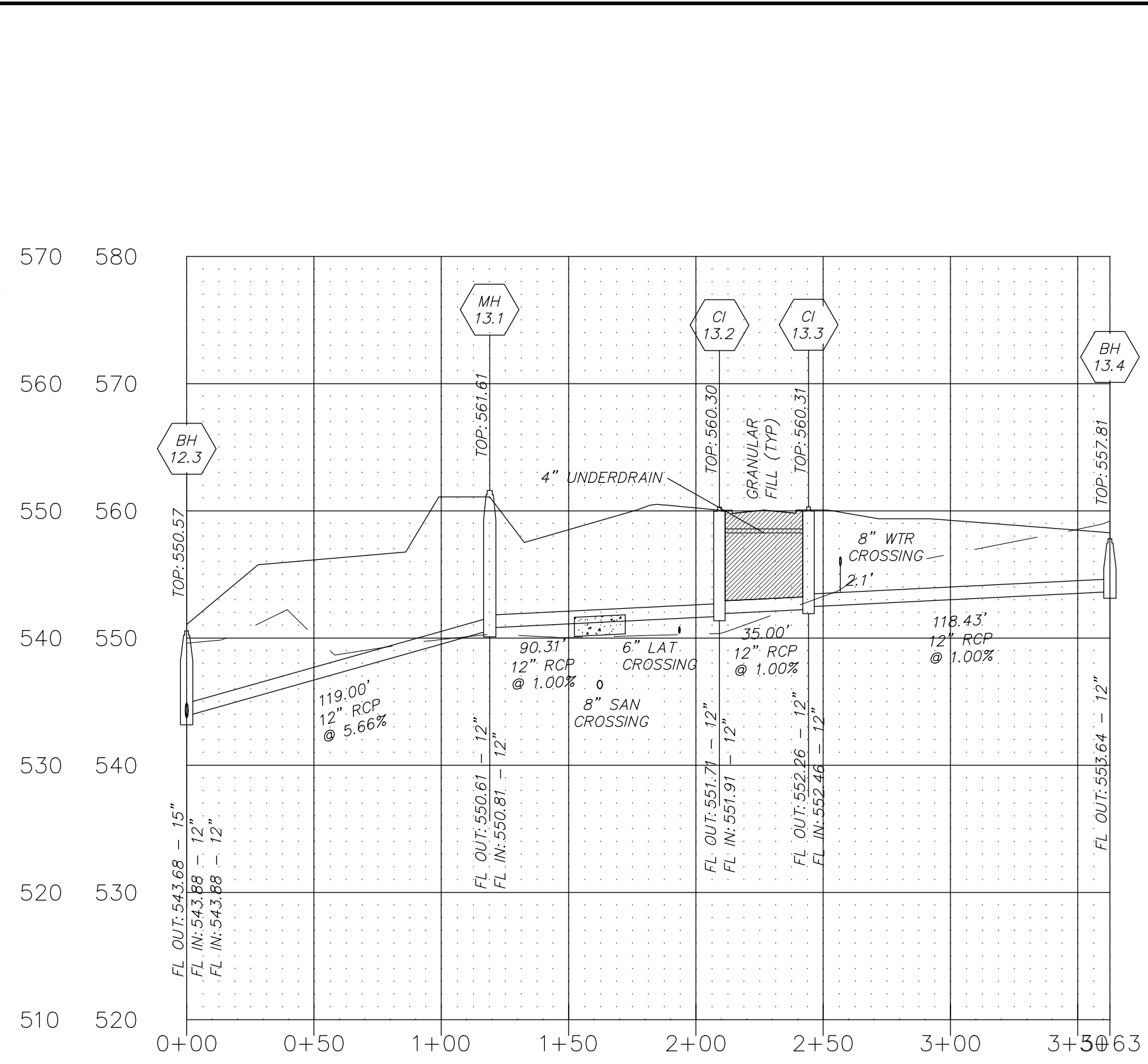

STORM 13

**LEGEND:**

- AI - AREA INLET
  - DAI - DOUBLE AREA INLET
  - BH - BEE HIVE GRATE INLET
  - CI - CURB INLET
  - FE - FLARED END SECTION
  - MH - MANHOLE
- TOP ELEVATION:**
- AI - TOP OF INLET STONE
  - DAI - TOP OF INLET STONE
  - BH - TOP OF THE INLET FRAME (R-2560-D5)
  - CI - TOP OF INLET STONE
  - MH - TOP OF FRAME AND COVER

**NOTES:**

ALL SANITARY LATERAL AND SANITARY MAINS CROSSING UNDER PAVEMENT, IF TRENCHED, SHALL BE BACKFILLED WITH GRANULAR MATERIAL (AGGREGATE) AND COMPACTED.

IF THE STORM AND SANITARY SEWERS ARE PARALLEL AND IN THE SAME TRENCH OR OVERDIG, THE UPPER SHALL BE PLACED ON A SHELF AND THE LOWER SHALL BE BEDDED IN COMPACTED GRANULAR FILL TO THE FLOW LINE OF THE UPPER.

WHEN STORM SEWERS PIPES WHICH CROSS OVER EXISTING OR PROPOSED SANITARY SEWER OR WATER MAIN TRENCH, PROVIDE COMPACTED GRANULAR BACKFILL FROM THE TOP OF THE SANITARY SEWER OR WATER MAIN Trench TO THE BOTTOM OF THE STORM SEWER AND CONSTRUCT CONCRETE CRADLE TO THE RCP STORM SEWER PIPE AND CONCRETE ENCASE HDPE STORM SEWER PIPE WHEN IT IS MORE THAN 18 INCHES ABOVE THE SANITARY SEWER ACROSS THE FULL WIDTH OF THE TRENCH. WHEN THE STORM SEWER IS LESS THAN 18" SEPARATION, BOTH PIPES ARE TO BE ENCASED IN CONCRETE. PROVIDE TWENTY (20) FEET OF DUCTILE IRON PIPE WHERE THE SANITARY SEWER CROSSES OVER THE STORM SEWER TRENCH.

ALL STORM SEWERS MUST MAINTAIN A MINIMUM OF 36" COVER OVER THE TOP OF PIPE.

ONE FULL SECTION OF WATER PIPE SHALL BE CENTERED OVER THE TRENCH AT ALL WATER MAIN CROSSINGS.

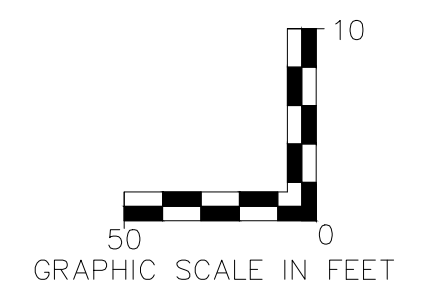

**PROFILE SCALE:**  
 HORIZ: 1" = 50'  
 VERT: 1" = 10'

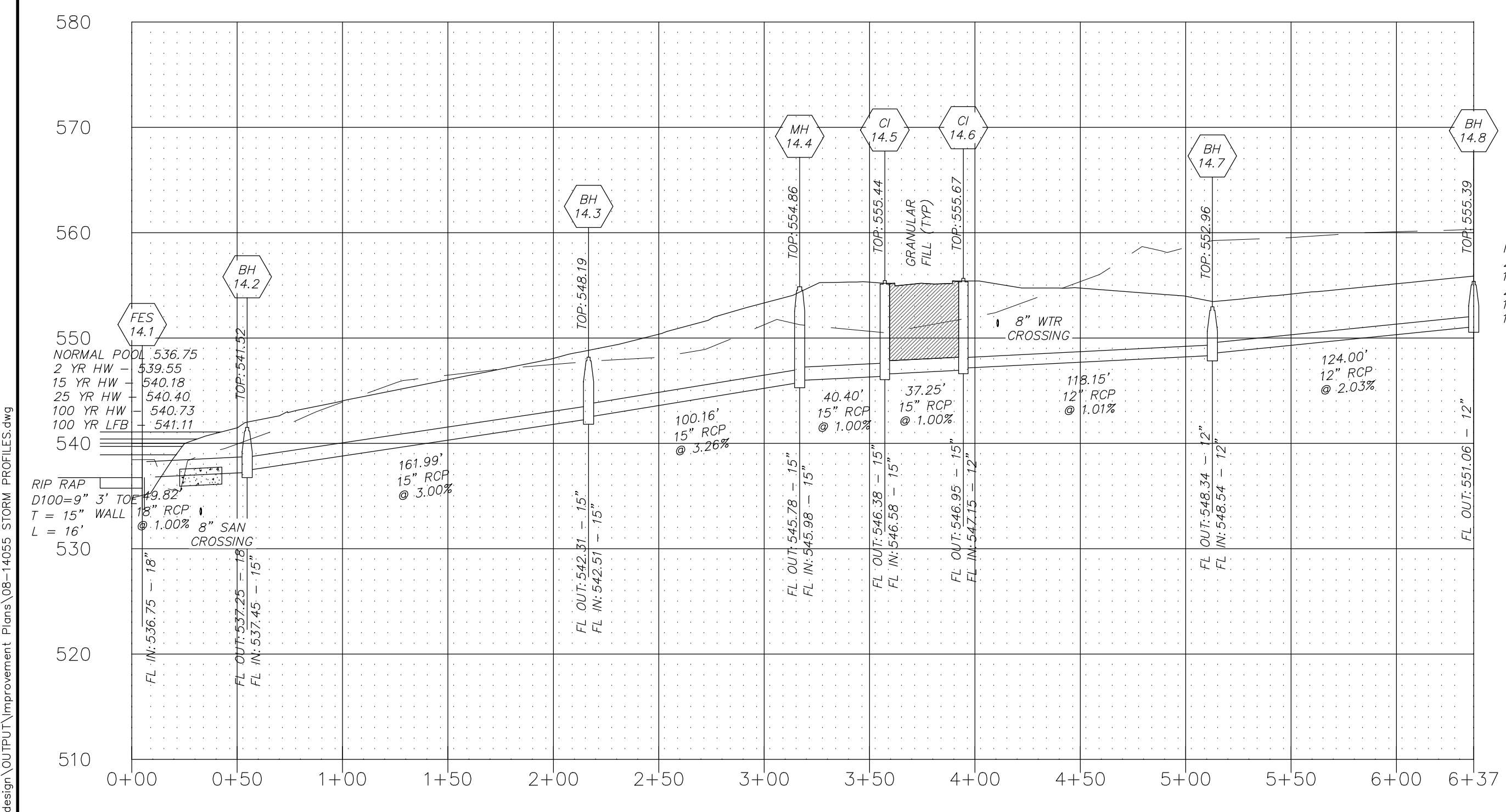

STORM 14

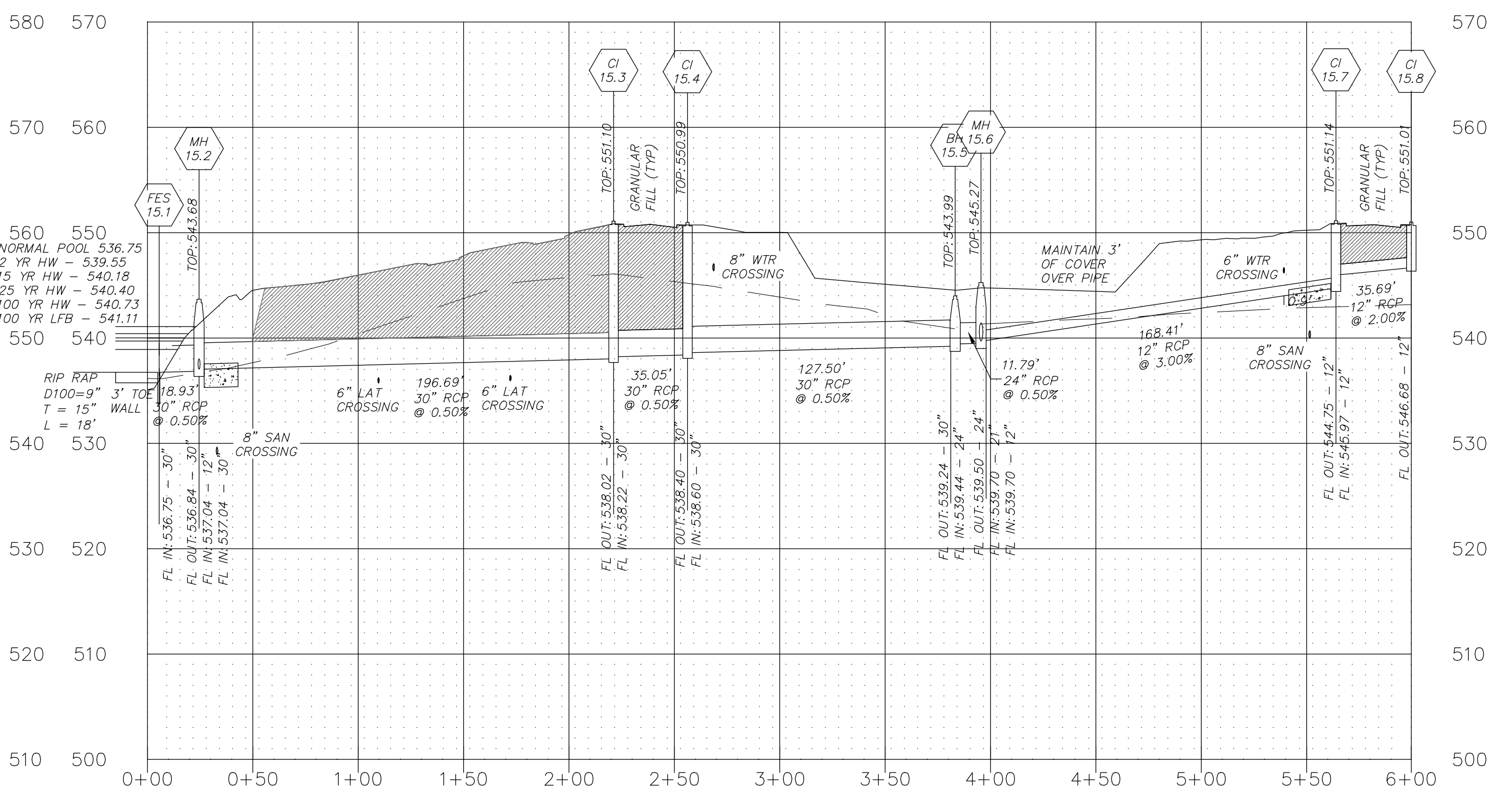

STORM 15

**PROJECT TITLE**  
 IMPROVEMENT PLANS  
 THE VILLAGES AT  
 MONTRACHET  
 STORM PROFILES

**PICKETT, RAY & SILVER INC**  
 CIVIL ENGINEERING, LAND SURVEYING,  
 AND NATURAL RESOURCES SERVICES  
 St. Peters, MO 63376  
 22 Richmond Center Court  
 St. Peters, MO 63376  
 Phone (636) 397-1211 Fax (636) 397-1104  
 www.prs.com 1-800-708-3818

**ENGINEER'S AUTHENTICATION**  
 THE RESPONSIBILITY FOR PROFESSIONAL ENGINEERING LIABILITY ON THIS PROJECT IS LIMITED TO THE SET OF PLANS AUTHENTICATED BY THE SEAL, SIGNATURE, AND DATE HEREON ATTACHED. RESPONSIBILITY IS DISCLAIMED FOR ALL OTHER ENGINEERING PLANS PROVIDED IN THIS PROJECT AND SPECIFICALLY EXCLUDES REVISIONS AFTER THIS DATE UNLESS REAUTHENTICATED.

**PICKETT, RAY & SILVER, INC. MO LICENSE #00000000**

*Karl Anthony Schoenike*  
 KARL ANTHONY SCHOENIKE  
 MISSOURI PROFESSIONAL ENGINEER  
 NUMBER RE-2003015038  
 01-25-16 ELECTRONIC SEAL  
 KARL A. SCHOENIKE, P.E.  
 PROFESSIONAL ENGINEER LICENSE 2003015038

**Developer / Owner Information**  
 MONTRACHET DEVELOPMENT LLC  
 218 Chesterfield Towne Centre  
 Chesterfield, Missouri 63005  
 Phone: 636-530-6900

P+Z No. 15-15.01

City No. 15-742-SP

Page No. 36 of 63  
 STORM PROFILES

PFS No. 14055MCH000R  
 TASK 001 FIELD BOOK 1476

CITY OF O'FALLON APPROVED 01/25/16

DCSD APPROVED 11/30/15 PERMIT NUMBER 2015-2-005

PWSD #2 APPROVED 12/30/15

\\PFS-5852011\Projects\14055MCH000R\Design\Output\Improvement Plans\08-14055 STORM PROFILES.dwg