

STORM 16

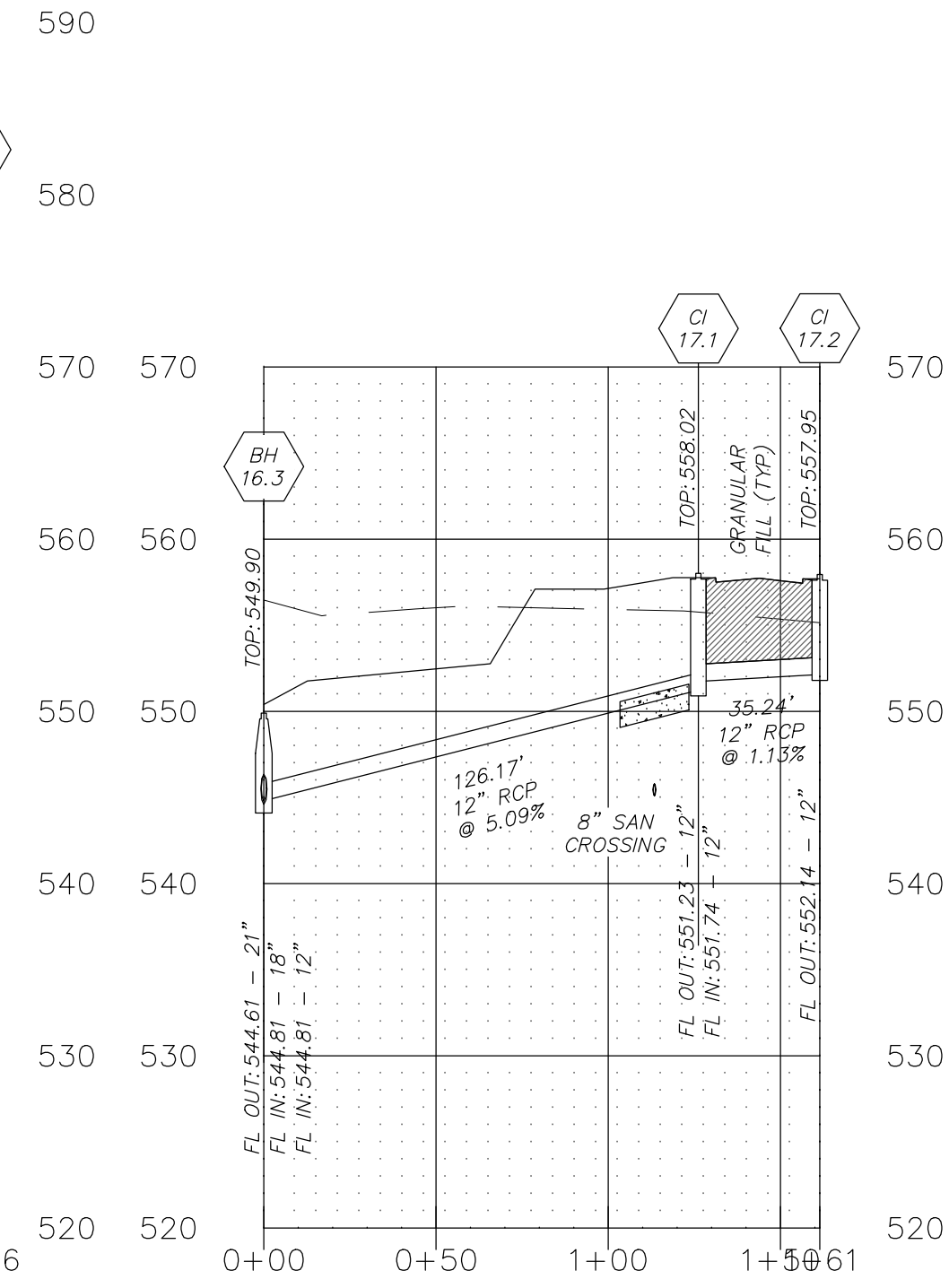

STORM 17

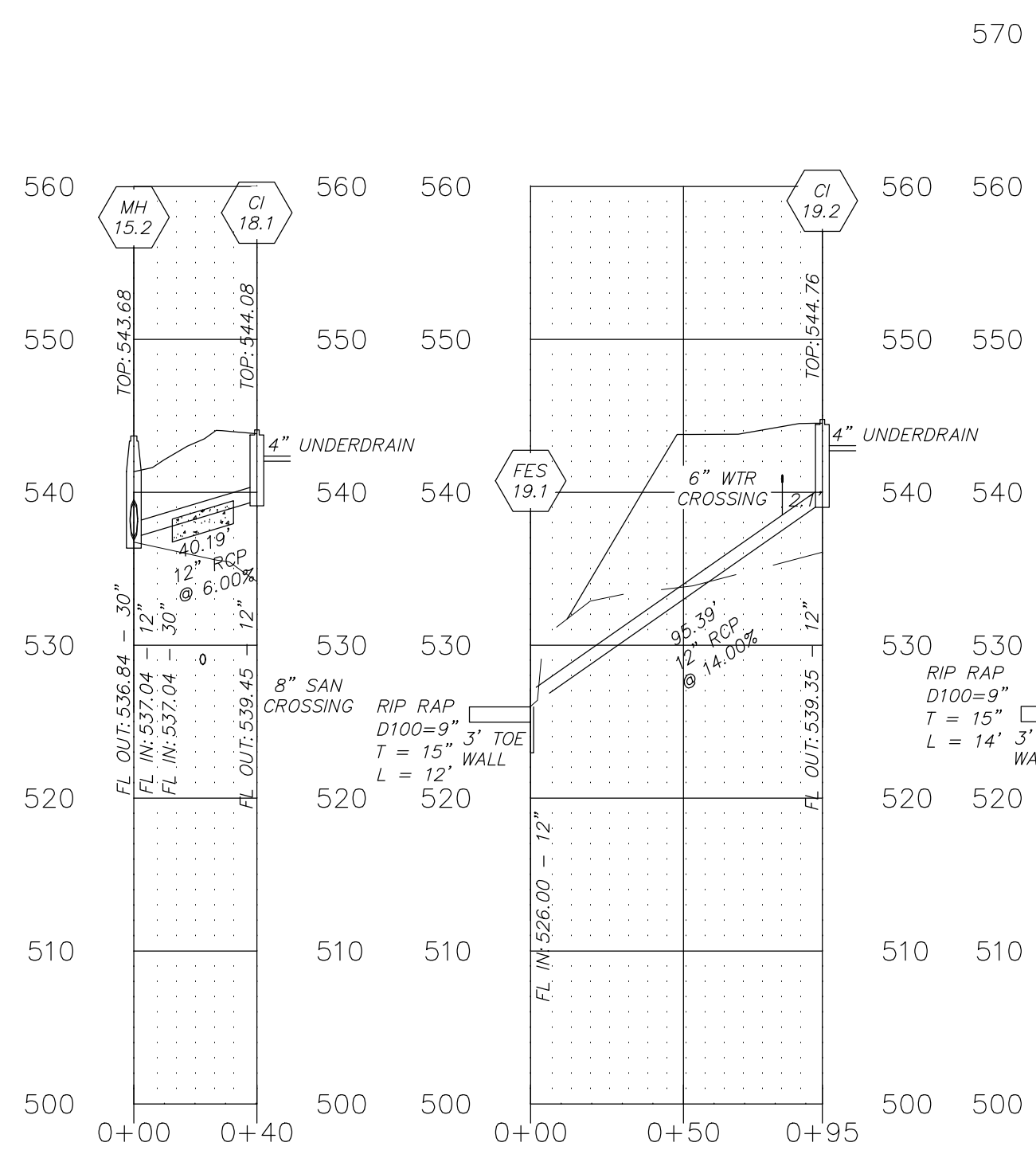
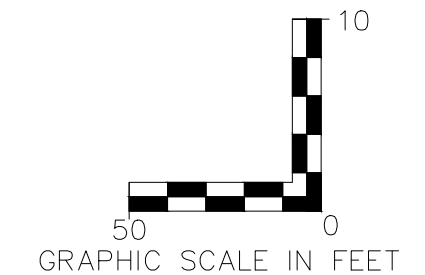

STORM 18

STORM 19

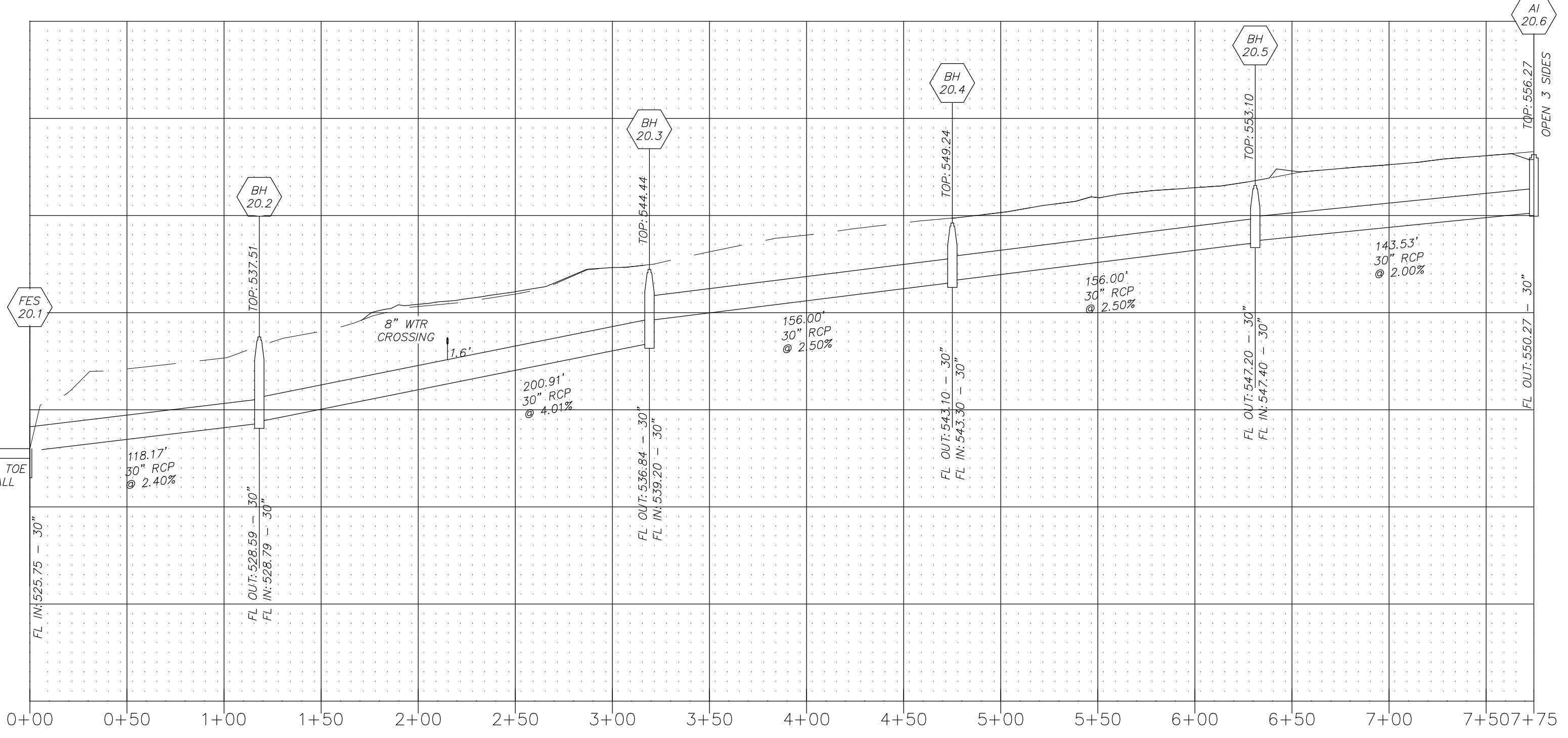

STORM 20

LEGEND:
 AI - AREA INLET
 DAI - DOUBLE AREA INLET
 BH - BEE HIVE GRADE INLET
 CI - CURB INLET
 FE - FLARED END SECTION
 MH - MANHOLE

TOP ELEVATION:
 AI - TOP OF INLET STONE
 DAI - TOP OF INLET STONE
 BH - TOP OF THE INLET FRAME (R-2560-D5)
 CI - TOP OF INLET STONE
 MH - TOP OF FRAME AND COVER

NOTES:
 ALL SANITARY LATERAL AND SANITARY MAINS CROSSING UNDER PAVEMENT, IF TRENCHED, SHALL BE BACKFILLED WITH GRANULAR MATERIAL (AGGREGATE) AND COMPACTED.
 IF THE STORM AND SANITARY SEWERS ARE PARALLEL AND IN THE SAME TRENCH OR OVERDUG, THE UPPER SHALL BE PLACED ON A SHELF AND THE LOWER SHALL BE BEDDED IN COMPACTED GRANULAR FILL TO THE FLOW LINE OF THE UPPER.
 WHEN STORM SEWERS PIPES WHICH CROSS OVER EXISTING OR PROPOSED SANITARY SEWER OR WATER MAIN TRENCH, PROVIDE COMPACTED GRANULAR BACKFILL FROM THE TOP OF THE SANITARY SEWER OR WATER MAIN Trench TO THE BOTTOM OF THE STORM SEWER AND CONSTRUCT CONCRETE CRADLE TO THE RCP STORM SEWER PIPE AND CONCRETE ENCASE HDPE STORM SEWER PIPE WHEN IT IS MORE THAN 18 INCHES ABOVE THE SANITARY SEWER ACROSS THE FULL WIDTH OF THE TRENCH. WHEN THE STORM SEWER IS LESS THAN 18" SEPARATION, BOTH PIPES ARE TO BE ENCASED IN CONCRETE. PROVIDE TWENTY (20) FEET OF DUCTILE IRON PIPE WHERE THE SANITARY SEWER CROSSES OVER THE STORM SEWER TRENCH.
 ALL STORM SEWERS MUST MAINTAIN A MINIMUM OF 36" COVER OVER THE TOP OF PIPE.
 ONE FULL SECTION OF WATER PIPE SHALL BE CENTERED OVER THE TRENCH AT ALL WATER MAIN CROSSINGS.

PROJECT TITLE
 IMPROVEMENT PLANS
 THE VILLAGES AT
 MONTRACHET
 STORM PROFILES

PICKETT, RAY & SILVER INC
 CIVIL ENGINEERING, LAND SURVEYING,
 AND NATURAL RESOURCES SERVICES

St. Peters
 22 Richmond Center Court
 St. Peters, MO 63376
 Phone (636) 397-1211 Fax (636) 397-1104
 www.prs.com 1-800-708-3918

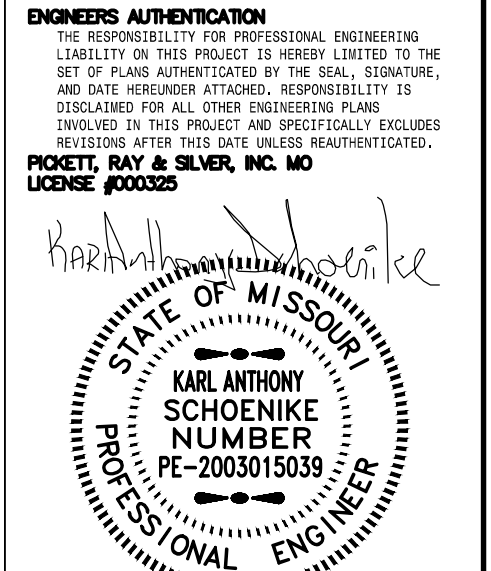

01-25-16 ELECTRONIC SEAL
 KARL A. SCHOENIKE, P.E.
 PROFESSIONAL ENGINEER LICENSE 2003015039

Developer / Owner Information
 MONTRACHET DEVELOPMENT LLC
 218 Chesterfield Towne Centre
 Chesterfield, Missouri 63005
 Phone: 636-550-6900

P+Z No. 15-15.01
City No. 15-742-SP

Page No.
 STORM PROFILES
 37 of 63

CITY OF O'FALLON APPROVED 01/25/16 PERMIT NUMBER 2015-2-005 DCSD APPROVED 11/30/15 APPROVED 12/30/15 PWS #2 APPROVED 12/30/15

\\PES-5852011\Projects\14055\MCH0\dwg\Design\OUTPUT\Improvement Plans\08-14055 STORM PROFILES.dwg