

\\PFS-5852011\Projects\14055\MCH000\Design\OUTPUT\Improvement Plans REVISED PHASE A\05-14055 STREET PROFILES.dwg

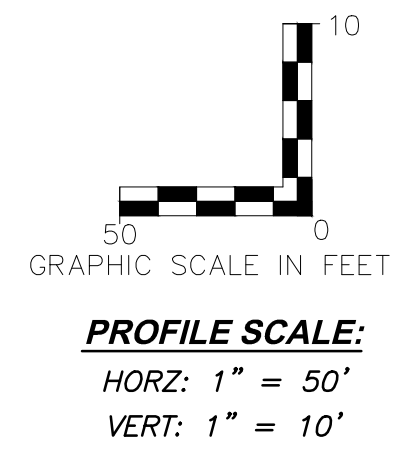

HIGH PT. STA: 2+50.17
HIGH PT. ELEV: 562.58
PVI STA: 2+50.17
PVI ELEV: 563.08
K: 25.00
LVC: 100.00

HIGH PT. STA: 7+75.00
HIGH PT. ELEV: 552.59
PVI STA: 8+00.00
PVI ELEV: 552.09
K: 25.00
LVC: 50.00

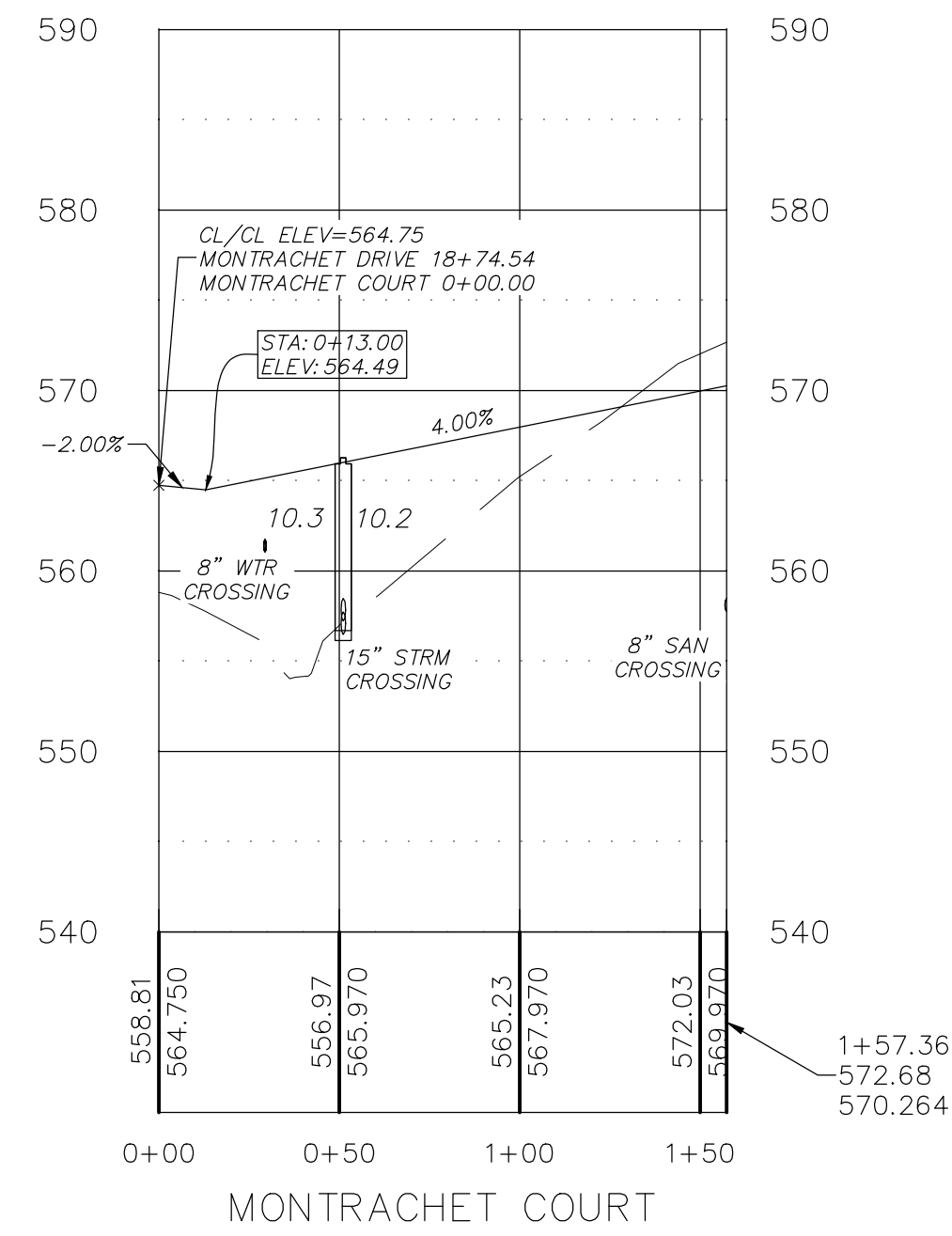
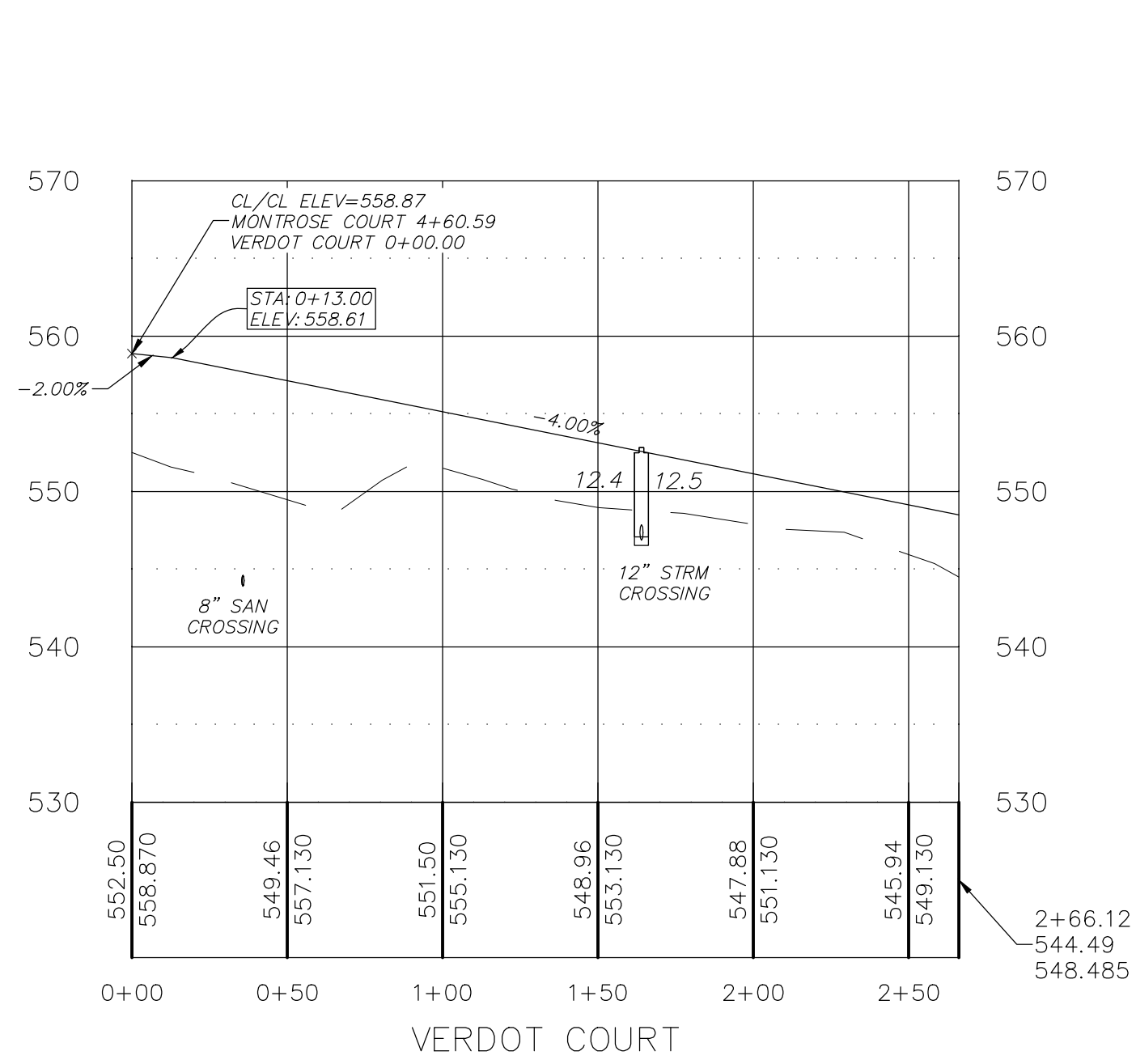
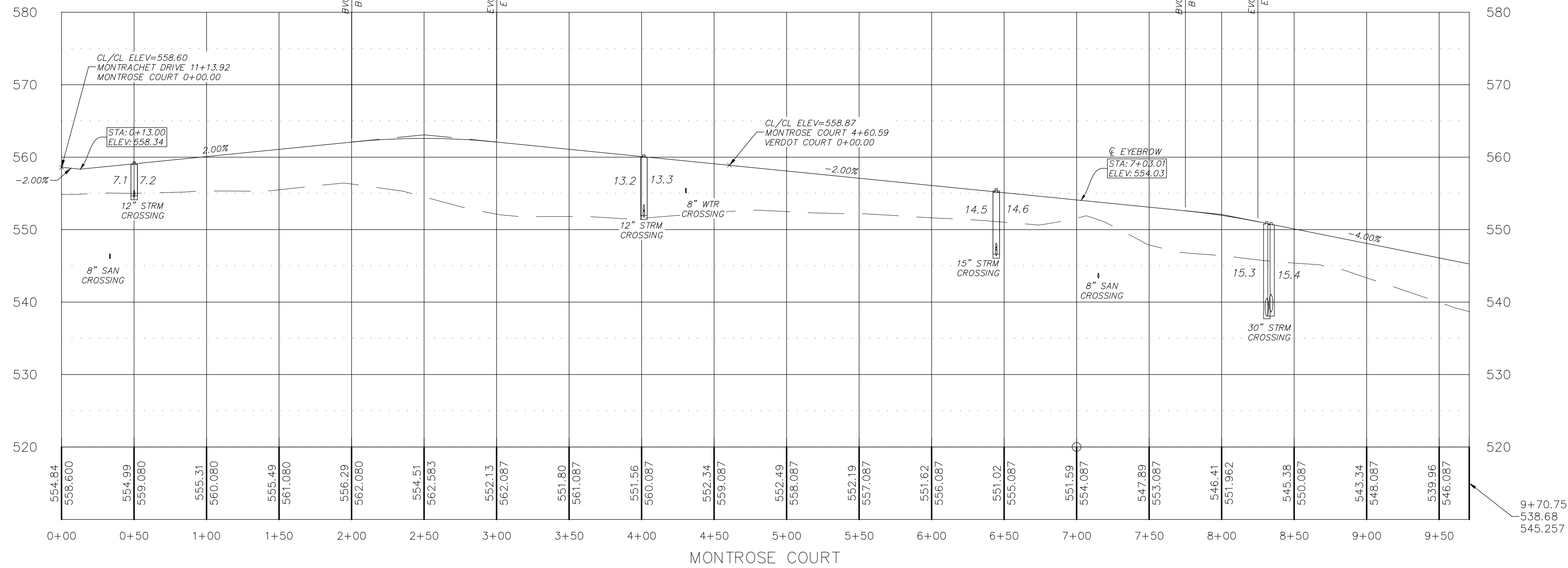

PROJECT TITLE
IMPROVEMENT PLANS
THE VILLAGES AT
MONTRACHET (REVISED)

STREET PROFILES
PFS No. 14055MCH000P
TASK 017 FIELD BOOK 1476

PICKETT, RAY & SILVER INC
CIVIL ENGINEERING, LAND SURVEYING,
AND NATURAL RESOURCES SERVICES

St. Peters
22 Richmond Center Court
St. Peters, MO 63376
Phone (636) 397-1211 Fax (636) 397-1104
www.prs3.com 1-800-708-3918

ENGINEER'S AUTHENTICATION
THE RESPONSIBILITY FOR PROFESSIONAL ENGINEERING LIABILITY ON THIS PROJECT IS LIMITED TO THE SET OF PLANS AUTHENTICATED BY THE SEAL, SIGNATURE, AND DATE HEREON ATTACHED. RESPONSIBILITY IS DISCLAIMED FOR ALL OTHER ENGINEERING PLANS INCORPORATED IN THIS PROJECT AND SPECIFICALLY EXCLUDES REVISIONS AFTER THIS DATE UNLESS REAUTHENTICATED.

PICKETT, RAY & SILVER, INC. MO
LICENSE # 000038

Karl Anthony Schoenike
STATE OF MISSOURI
KARL ANTHONY SCHOENIKE
NUMBER PE-2003015039
PROFESSIONAL ENGINEER
09/28/16

KARL A. SCHOENIKE, P.E.
PROFESSIONAL ENGINEER LICENSE 2003015039

Developer / Owner Information
MONTRACHET DEVELOPMENT LLC
218 Chesterfield Towne Centre
Chesterfield, Missouri 63005
Phone: 636-530-6900

P+Z No. 15-15.01
City No. 15-742-SP

Page No. STREET PROFILES
25 of 63

CITY OF O'FALLON REVISED PHASE A 09/28/2016