

**KEATON WOODS DRIVE**

SCALES:  
HORIZ. 1" = 40'  
VERT. 1" = 10'

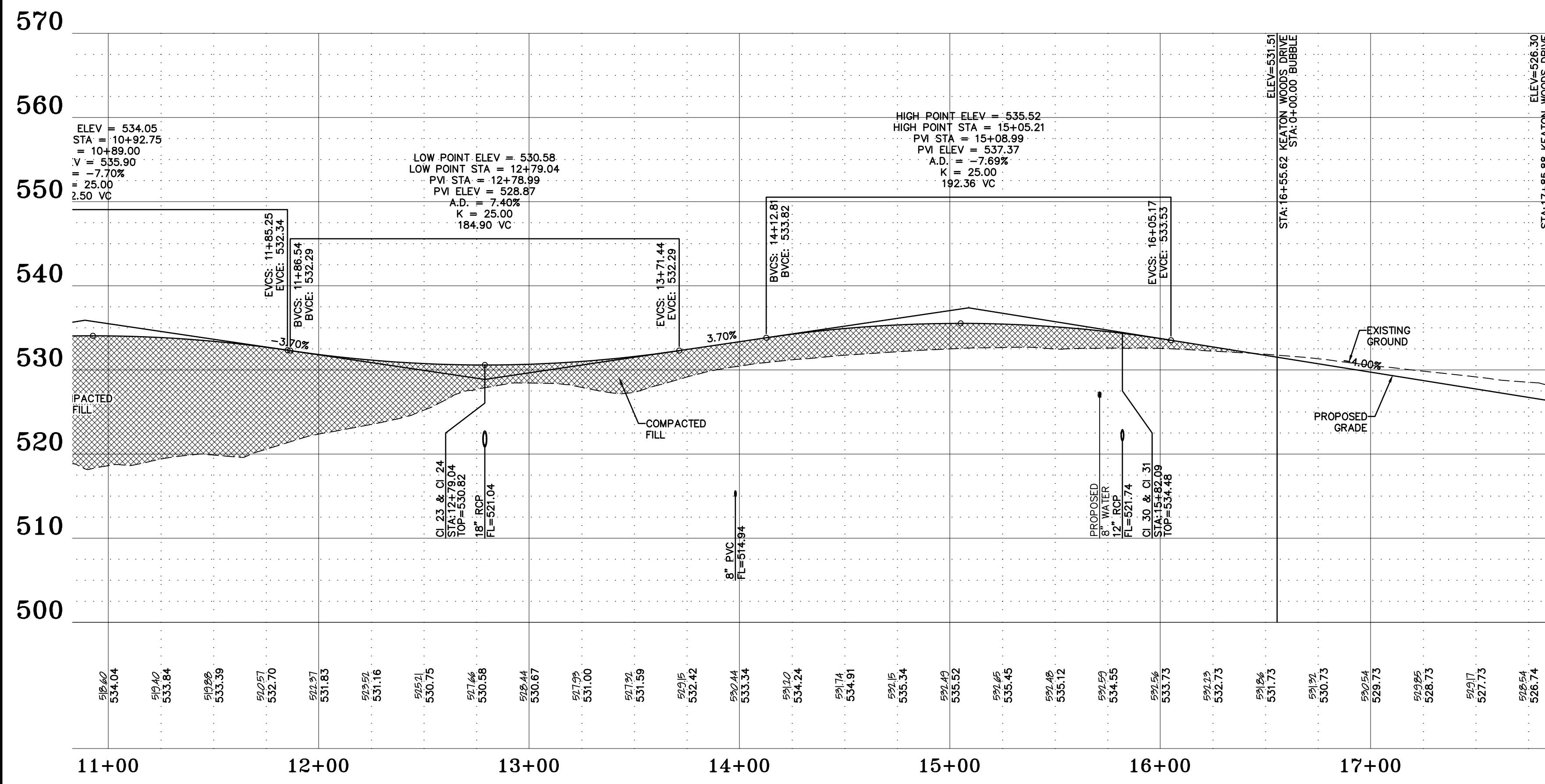

**KEATON WOODS DRIVE**

SCALES:  
HORIZ. 1" = 40'  
VERT. 1" = 10'

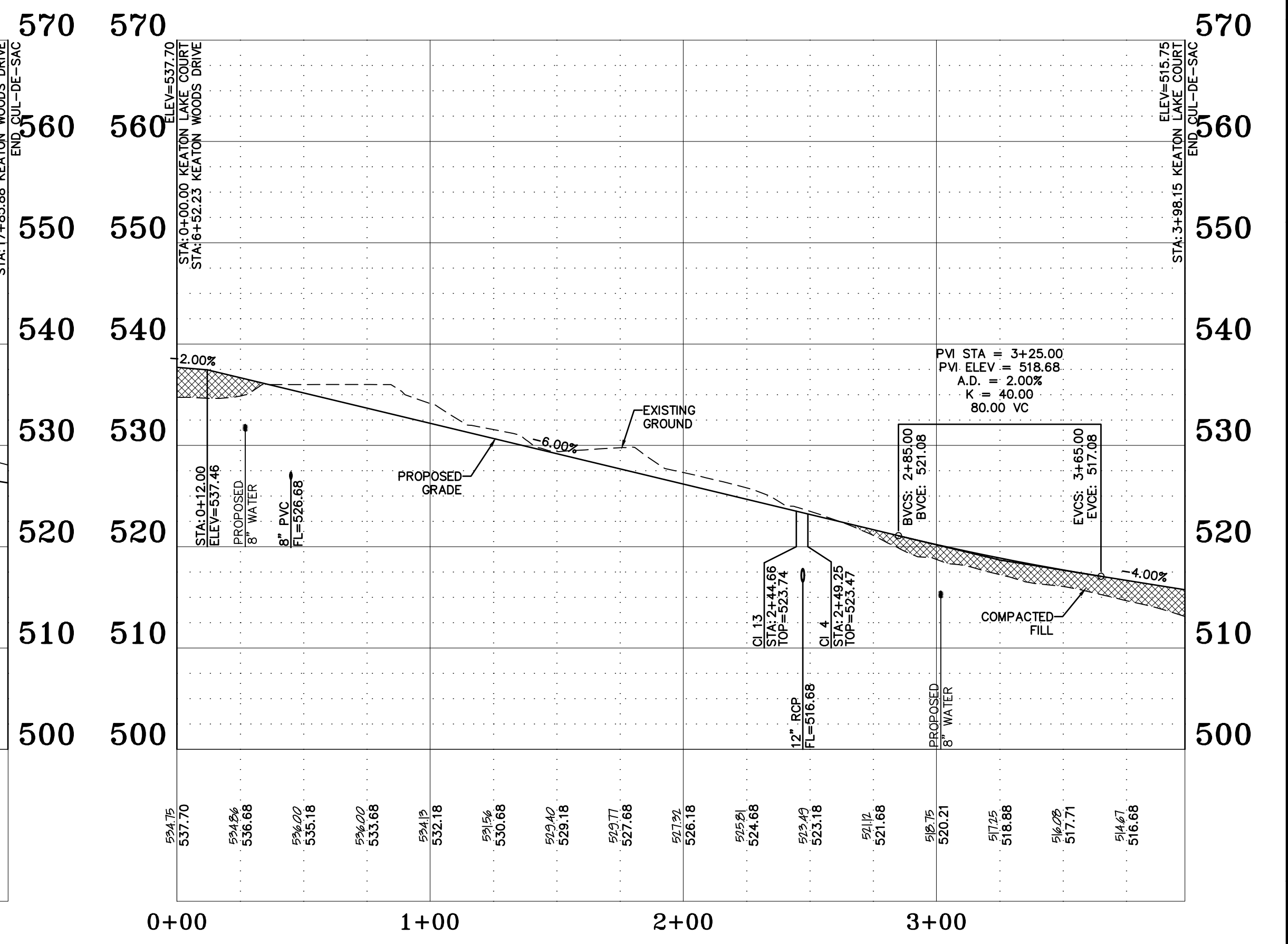

**KEATON LAKE COURT**

SCALES:  
HORIZ. 1" = 40'  
VERT. 1" = 10'

PROJECT TITLE:

**THE VILLAS AT  
KEATON WOODS**

ENGINEERING  
PLANNING  
SURVEYING  
221 Point View Blvd  
St. Charles, MO 63301  
636-928-5562  
FAX 928-1718

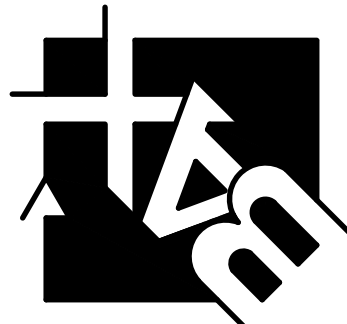

DISCLAIMER OF RESPONSIBILITY  
I hereby certify that the documents intended to be authorized by my seal are limited to this sheet, and I hereby disclaim any responsibility for all other drawings, specifications, estimates, reports or other documents or instruments relating to or intended to be used for any part or parts of the architectural or engineering project or projects.



Clifford L. Heitmann  
Civil Engineer  
E29817

Copyright 2018  
Box Engineering Company, Inc.  
Engineering Authority No. 000655  
Surveying Authority No. 000144  
All Rights Reserved

**REVISIONS**

02/20/17	CITY COMMENTS
03/17/17	CITY COMMENTS
09/20/18	CITY COMMENTS
11/06/18	CITY COMMENTS
12/14/18	CITY COMMENTS
12/28/18	CITY COMMENTS
06/11/21	CLIENT COMMENTS
03/01/22	CITY COMMENTS

Developer / Owner:  
Bridgewater Communities, Inc.  
P.O. Box 4607  
Chesterfield, Missouri 63005  
636-294-6020

**STREET PROFILES**

P+Z No. 18-003986  
June 7, 2018  
City No. #18-009384  
Permit #RSP18-000006

Page No.  
16 of 32