

CITY OF O'FALLON, MISSOURI WEST TERRA WATER MAIN EXTENSION

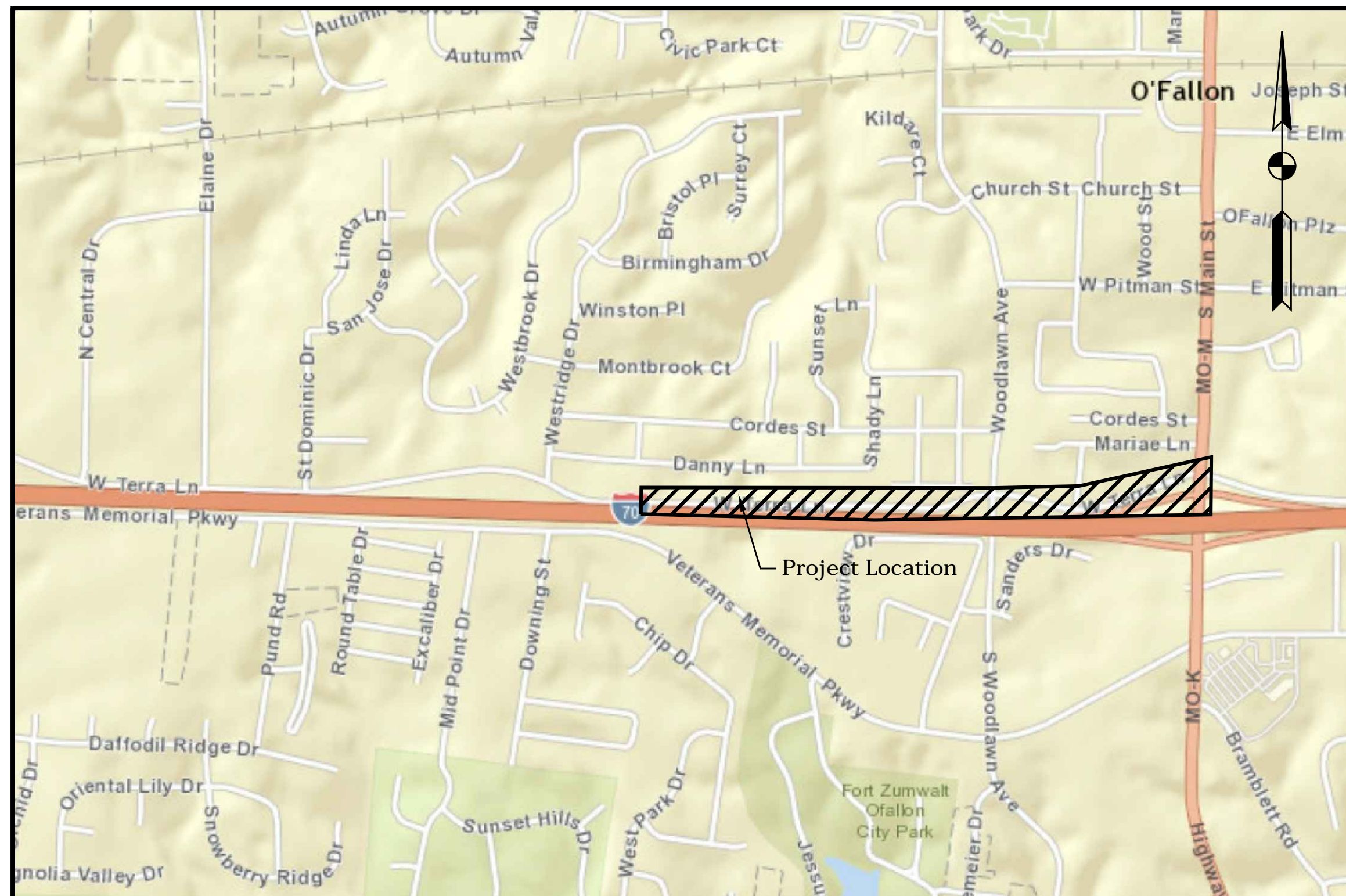

Plan View

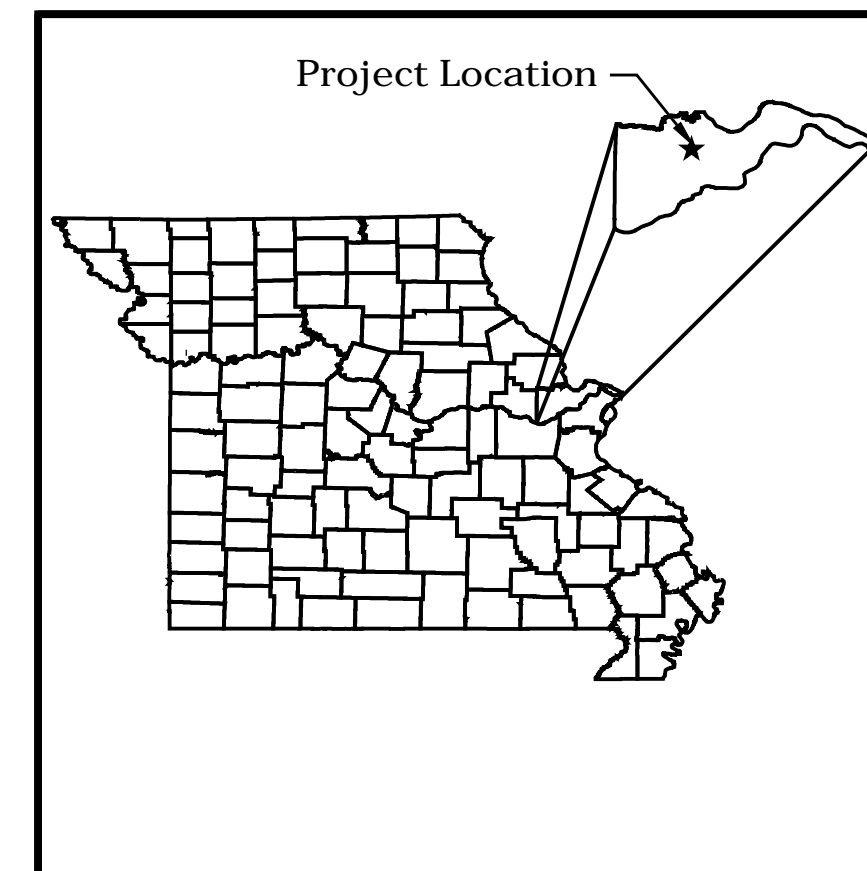

Locator Map

Benchmarks Project

THE HORIZONTAL COORDINATE SYSTEM AND VERTICAL DATUM FOR THIS DRAWING WAS ADOPTED FROM CONTROL POINTS TAKEN FROM AN ELECTRONIC DRAWING PROVIDED BY THE CITY OF O'FALLON.

THE HORIZONTAL AND VERTICAL RELATIONSHIP BETWEEN THE POINTS PROVIDED BY THE CITY OF O'FALLON WAS VERIFIED BY GPS OBSERVATIONS USING A CELLULAR EQUIPPED TRIMBLE R8 GNSS ROVER AND TRIMBLE TSC3 DATA COLLECTOR.

TO THE BEST OF OUR KNOWLEDGE, THE HORIZONTAL COORDINATES IN THIS DRAWING MEET THE ACCURACY STANDARDS OF THE CURRENT MISSOURI MINIMUM STANDARDS FOR PROPERTY BOUNDARY SURVEYS (20 CSR 2030-16) AS AN URBAN CLASS SURVEY.

ADDITIONALLY, TO THE BEST OF OUR KNOWLEDGE, PROJECT ELEVATIONS UTILIZE THE NAVD 88 VERTICAL DATUM AND ARE REFERENCED TO NGS MONUMENT "F-149" WITH A PID OF JC0547. SAID MONUMENT HAS A PUBLISHED ELEVATION OF 163.447M (542.80 FT). F-149 IS DESCRIBED AS A STANDARD DISK, STAMPED F 149 1955 AND SET IN THE TOP OF A CONCRETE POST PROJECTING 6 INCHES ABOVE THE GROUND AND LOCATED IN THE SOUTHWEST CORNER OF THE O'FALLON CITY HALL PROPERTY, 40 FEET EAST OF MAIN STREET (HIGHWAY M) AND 45 FEET NORTH OF THE CENTERLINE OF MAIN RAILROAD TRACK.

Point #	Northing	Easting	Elevation	Description
451	1081390.5460	759789.1640	593.7200	BM-CUT SQUARE ON BASE OF LIGHT STANDARD
453	1081747.7490	762347.7450	573.8970	BM-CUT SQUARE ON CONCRETE CURB
454	1081673.1180	763161.1050	546.9600	BM-CUT SQUARE ON CONCRETE CURB
470	1081451.6130	761091.3830	596.9220	BM-CROSS CUT ON WEST RIM OF SANITARY MANHOLE

Legend

	FLARED END SECTION		TREE
	GRATED INLET		BUSH
	CURB/AREA INLET		TREE STUMP
	STORM SEWER MANHOLE		FOUND MONUMENT
	SANITARY SEWER MANHOLE		CROSS
	ELECTRIC METER		YARD DRAIN
	GAS METER		CLEANOUT
	WATER METER		DOWNSPOUT
	GAS DRIP		L.A. LANDSCAPED AREA
	GAS VALVE		FOUND MONUMENT
	WATER VALVE		FOUND CROSS
	FIRE HYDRANT		CONCRETE
	MAILBOX		ASPHALT
	SIGN		GRAVEL
	POWER POLE		ELECTRIC BOX
	GUY WIRE		ELECTRIC TRANSFORMER
	LIGHT STANDARD		TRAFFIC CONTROL BOX
	MAILBOX		TELEPHONE CABLE PEDESTAL
	UTILITY BOX		TELEPHONE BOX
	TRAFFIC SYMBOL		
	GAS LINE MARKER		
	FIBER OPTIC MARKER		

Sheet Index

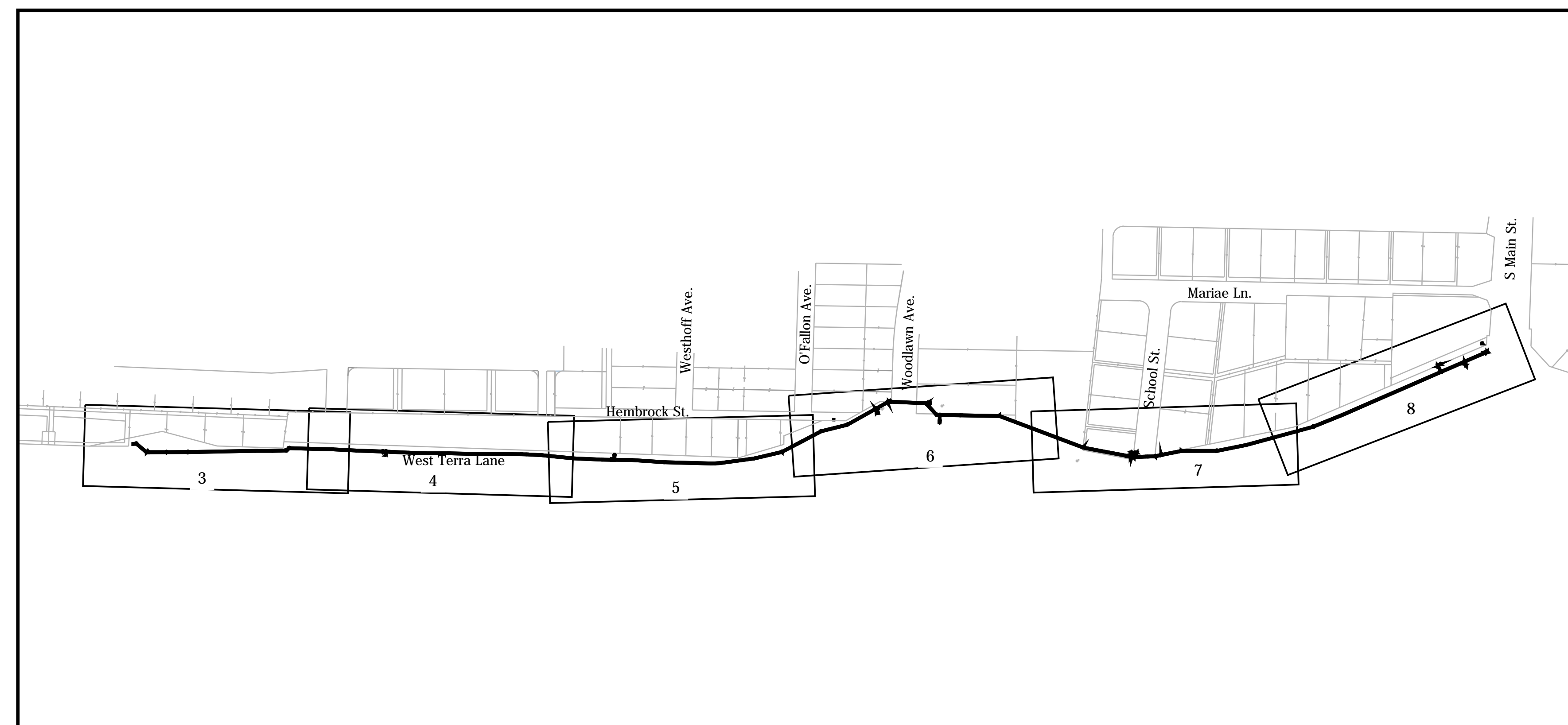

Utility Contacts

Sanitary Sewers
City of O'Fallon
100 N. Main St.
O'Fallon, MO, 63366
Contact: 636-281-2858

Water
City of O'Fallon
100 N. Main St.
O'Fallon, MO, 63366
Contact: 636-281-2858

Storm Sewer
City of O'Fallon
100 N. Main St.
O'Fallon, MO, 63366
636-281-2858

Electric
Ameren UE
200 Callahan Road
Wentzville, MO, 63385
636-639-8312

Gas
Laclede Gas Company
8400 Graham Road
St. Louis, MO, 63134
314-522-2297

Telephone
Century Tel
1151 Century Tel Dr.
Wentzville, MO, 63385
636-332-7261

Fire District
O'Fallon Fire Protection District
119 E. Elm St.
O'Fallon, MO, 63366
636-272-3493

Drawing Index

Sheet #	Sheet Title
1	TITLE SHEET
2	GENERAL NOTES
3	LINE A - SHEET 1 OF 6
4	LINE A - SHEET 2 OF 6
5	LINE A - SHEET 3 OF 6
6	LINE A - SHEET 4 OF 6
7	LINE A - SHEET 5 OF 6
8	LINE A - SHEET 6 OF 6
9	WATER MAIN DETAILS - SHEET 1 OF 2
10	WATER MAIN DETAILS - SHEET 2 OF 2

* City of O'Fallon Construction work hours per City Ordinance 3429 as shown in Section 500.420 of the Municipal Code of the City of O'Fallon are as follows:

October 1 through May 31
7:00 A.M. To 7:00 P.M. Monday Through Sunday
June 1 Through September 30
6:00 A.M. To 8:00 P.M. Monday Through Friday
7:00 A.M. to 8:00 P.M. Saturday and Sunday

PROJECT TITLE

CITY OF O'FALLON, MISSOURI
WEST TERRA WATER MAIN
EXTENSION



ENGINEER SIGNATURE
BLOCK



12/22/2016

TITLE SHEET

CITY OF O'FALLON WATER DISTRIBUTION

Page No.

1