

WABASH WOODS WAY

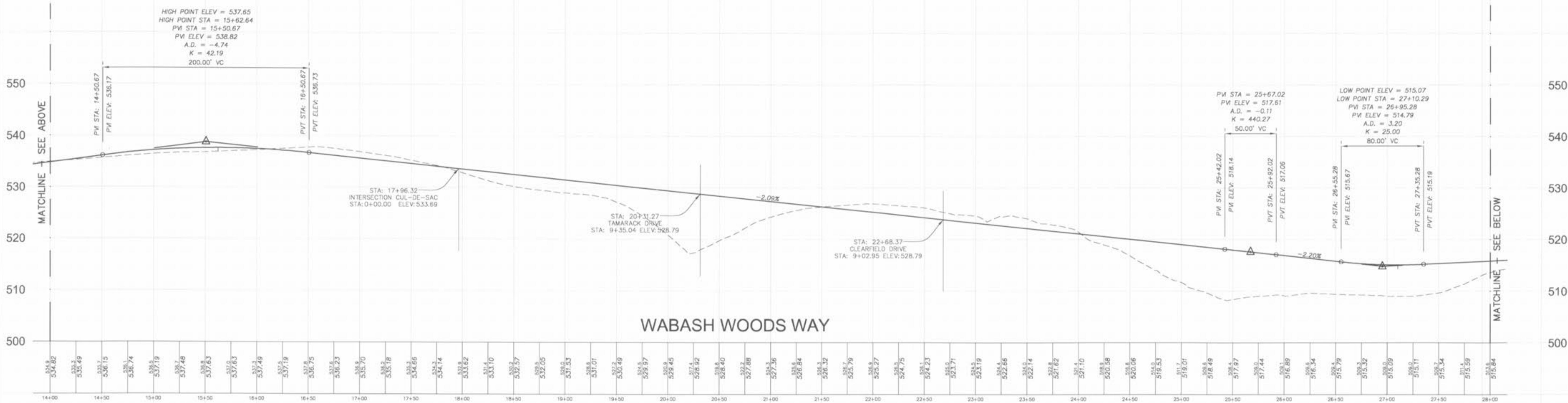

WABASH WOODS WAY

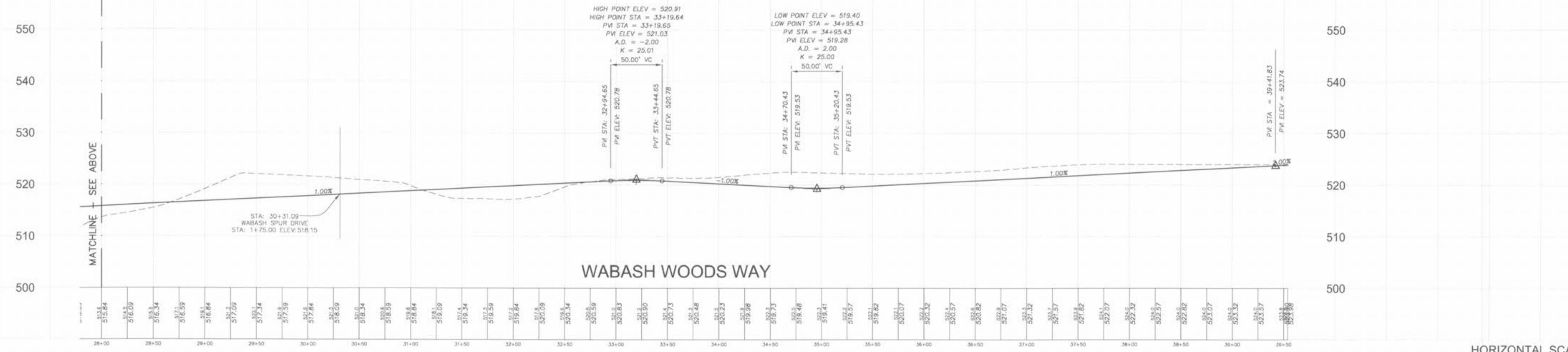

WABASH WOODS WAY

HORIZONTAL SCALE: 1" = 50'
VERTICAL SCALE: 1" = 10'



ISSUE	DATE	REMARKS
1	1/25/05	Submitted to city for review.
2	6/15/05	Revised per city's review.
3	7/29/05	Revised per city's review.

PREPARED BY:
LIBERTY ENGINEERING, L.L.C.
P.O. Box 2 - Collinsville, MO 63338 Phone: (636) 244-5333
RESIDENTIAL - COMMERCIAL - MUNICIPAL

PREPARED FOR:
KAPLAN DEVELOPMENT, LLC
P.O. BOX 940
ST. PETERS, MO 63376
(636) 946-8971

PROJECT:
WABASH WOODS PHASE ONE
STREET PROFILES

PROJECT NO:
04021-00
DESIGNED BY:
DRAWN BY:
CHECKED BY:
SHEET NO: **14** OF **31**