

SCALES:
HORIZONTAL: 1"= 50'
VERTICAL: 1"= 10'

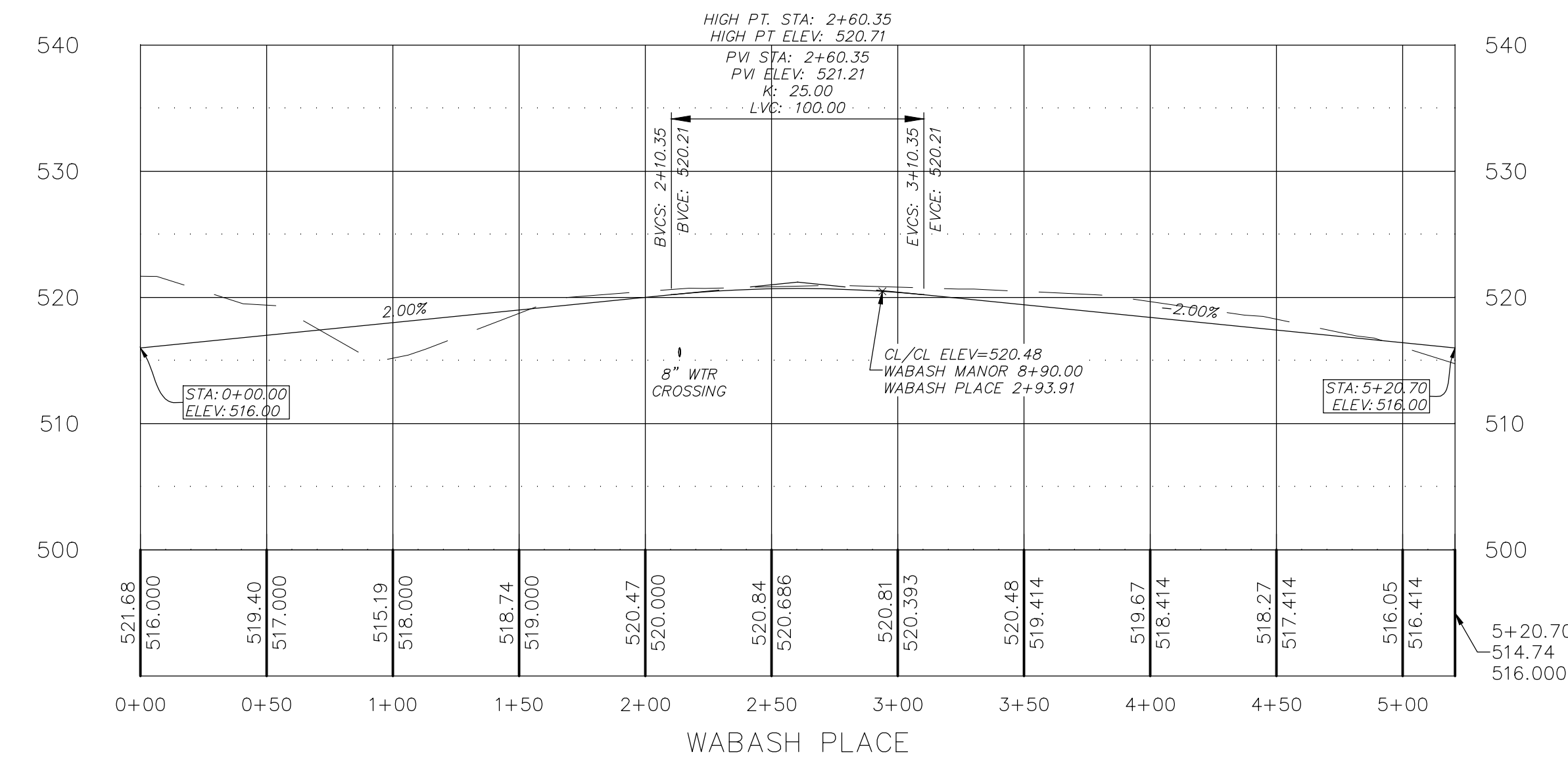
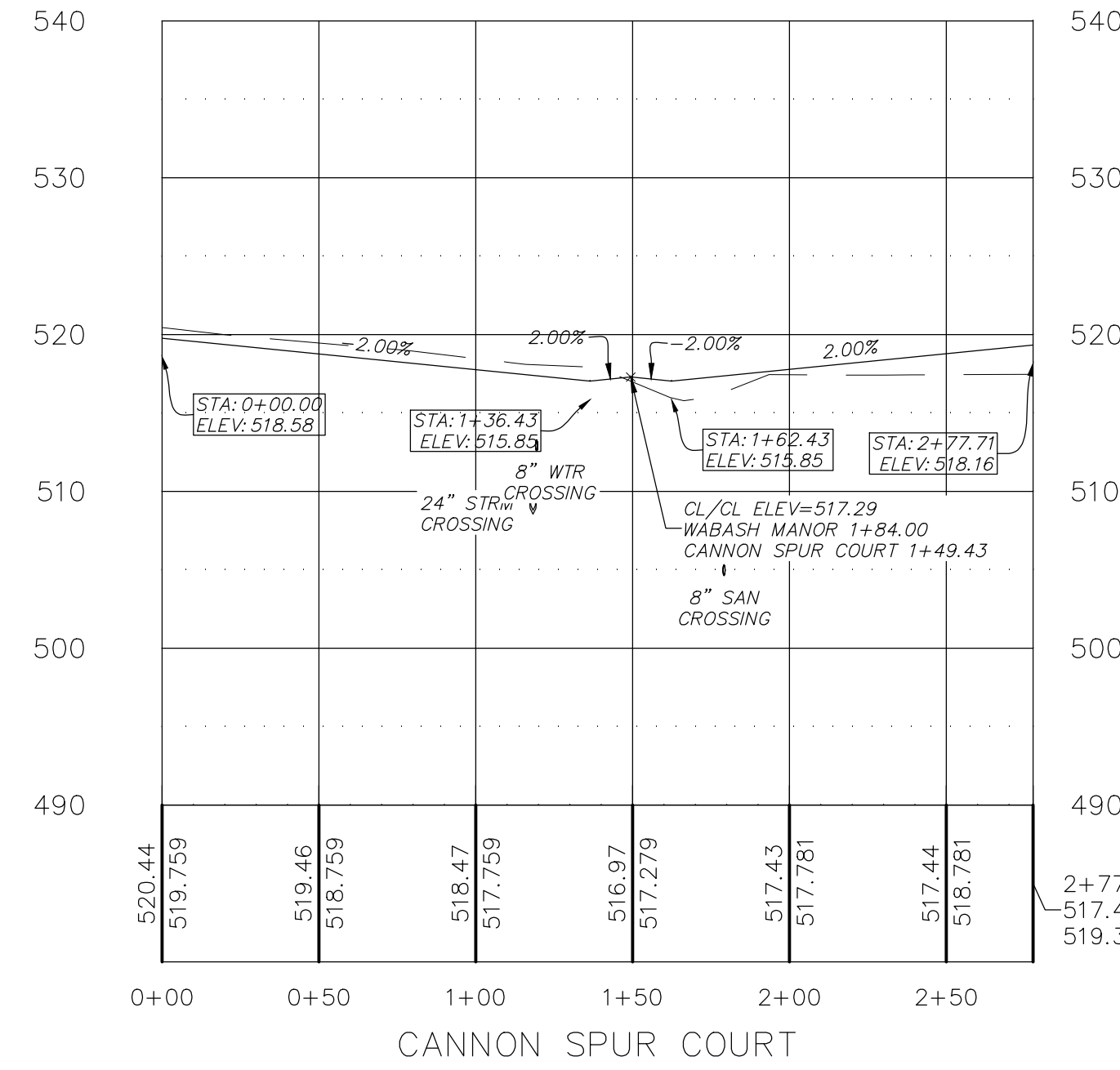

PROJECT TITLE
IMPROVEMENT PLANS
WABASH WOODS
PHASE TWO
STREET PROFILES

PPS No. 15014KAPD.00R
TASK 002

PICKETT, RAY & SILVER INC
CIVIL ENGINEERING, LAND SURVEYING,
AND NATURAL RESOURCES SERVICES

St. Peters
22 Richmond Center Court
St. Peters, MO 63376
Phone (636) 397-1211 Fax (636) 397-1104
www.prs3.com 1-800-708-3918

ENGINEER'S AUTHENTICATION
THE RESPONSIBILITY FOR PROFESSIONAL ENGINEERING
LIABILITY ON THIS PROJECT IS HEREBY LIMITED TO THE
SET OF PLANS AUTHENTICATED BY THE SEAL, SIGNATURE,
AND DATE HEREON ATTACHED. RESPONSIBILITY IS
DISCLAIMED FOR ALL OTHER ENGINEERING PLANS
ISSUED IN THIS PROJECT AND SPECIFICALLY EXCLUDES
REVISIONS AFTER THIS DATE UNLESS REAUTHENTICATED.

PICKETT, RAY & SILVER, INC. MO
LICENSE #000336

KARL A. SCHOENIKE
STATE OF MISSOURI
KARL ANTHONY
SCHOENIKE
NUMBER
PE-2003015039
PROFESSIONAL ENGINEER

03/02/16
ELECTRONIC SEAL
KARL A. SCHOENIKE, P.E.
PROFESSIONAL ENGINEER LICENSE 2003015039

Developer / Owner Information

LK PROPERTIES II, LLLP
PO Box 340
St. Peters, Missouri 63376

P+Z No.
20100.04
City No. 15-639-SP

Page No.
STREET PROFILES
07 of 24

\\PRS-SBS2011\PROJECTS\15014KAPD\DWG\OUTPUT\05 STREETS.DWG

*** O'FALLON FOR APPROVAL *** 03/02/16 ***