

DRAINAGE SCHEDULE

STRUCTURE NUMBER	STRUCTURE TYPE	TOP CASTING	INVERT OUT	INVERT IN	PIPE LENGTH (FEET)	PIPE TYPE	PERCENT SLOPE
1	OUTLET	-	521.00	521.00	-	-	-
1-2	THRU WALL	-	-	-	18'	36" RCP	0.00%
2	SUMPED STREET	537.35	521.00**	521.00	-	-	-
2-3	INLET (MSD #25)	-	-	-	107'	36" RCP	0.00%
3	GRATE	539.65	521.00	521.00	-	-	-
3-4	INLET	-	-	-	69'	36" RCP	0.00%
4	DOGHOUSE	540.70	521.00	522.45*	-	-	-
-	JUNCTION BOX	-	-	-	-	-	-
5	DOGHOUSE	541.23	532.56* (10" TRUCK DOCK)	-	-	-	-
-	JUNCTION BOX	-	-	-	-	-	-
6	SUMPED AREA	536.83	521.92**	522.02*	-	-	-
-	INLET (MSD #35)	-	-	-	-	-	-
7	DOGHOUSE	533.92	527.06*	527.06*	-	-	-
7-8	JUNCTION BOX	-	-	-	19'	24"	0.54%
8	OUTLET CONTROL	534.78	527.16	527.20	-	-	-
8-9A	STRUCTURE	-	-	-	7'	24"	0.00%
9A	UNDERGROUND	-	527.20(9A)	-	-	-	-
9A-9B	DETENTION	-	-	-	1,020'	72" CPP	0.068%
9B	UNDERGROUND	-	-	527.89(9B)	-	-	-
9B-10	DETENTION	-	-	-	24'	24"	1.00%
10	SUMPED DOGHOUSE	535.84	528.13**	528.23*	-	-	-
-	JUNCTION BOX	-	-	-	-	-	-
11	SUMPED STREET	537.00	532.85**	-	-	-	-
-	INLET (MSD #25)	-	-	-	-	-	-
12	DOGHOUSE	540.70	528.55*	534.51(13)	-	-	-
12-13	JUNCTION BOX	-	-	-	49'	18"	2.01%
13	GRATE	539.60	535.50	-	-	-	-
-	INLET	-	-	-	-	-	-

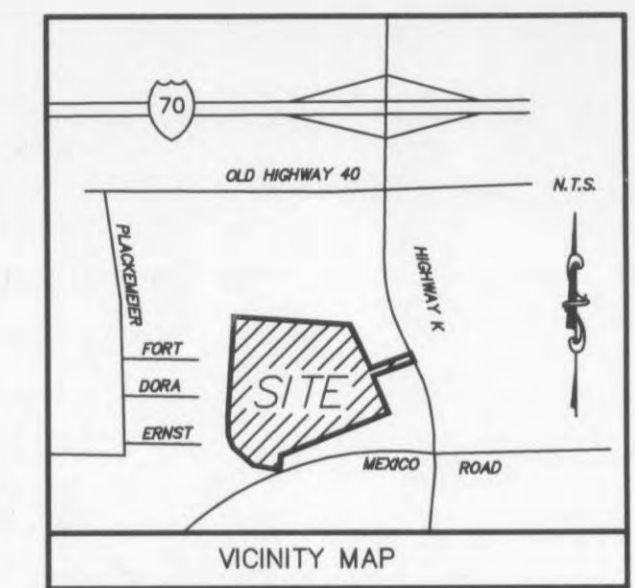

GRADING/DRAINAGE PLAN LEGEND

- STORM SEWER PIPING
- JUNCTION BOX/STORM MANHOLE
- DRAINAGE STRUCTURE INDICATOR
- SLOPE ARROW
- ▭ CONCRETE FLUME
- ⊕ RIP-RAP APRON
- STREET INLET MSD NO. 25
- SINGLE GRATE INLET
- ▭ DOUBLE GRATE INLET
- TC = TOP OF CURB
- TP = TOP OF PAVEMENT
- TW = TOP OF WALL
- FG = FINISH GRADE
- SW = SIDEWALK
- CITY OF FALLON ACCESS EASEMENT

WATER QUALITY BMP SCHEDULE

STRUCTURE NUMBER	STRUCTURE TYPE	WATER QUALITY DEVICE	TOP CASTING	INVERT OUT	INVERT IN	PIPE SIZE	SUMP INVERT
2	SUMPED STREET	SNOUT	537.35	521.00	521.00	36"	513.50
-	INLET (MSD #25)	-	-	-	-	-	-
6	SUMPED AREA	SNOUT	536.83	521.92	522.02*	42"	513.17
-	INLET (MSD #35)	-	-	-	-	-	-
10	SUMPED DOGHOUSE	SNOUT	535.84	528.13	528.23*	24"	523.13
-	JUNCTION BOX	-	-	-	-	-	-
11	SUMPED STREET	SNOUT	537.00	532.85	-	18"	529.10
-	INLET (MSD #25)	-	-	-	-	-	-

HIGH PLASTIC CLAY ARE PRESENT ON SITE AND WILL NOT BE ALLOWED WITHIN THE UPPER 2 FEET OF THE FLOOR SLABS, PERIMETER FOOTING, OR BACKFILL OF RETAINING WALL.

UNDERCUTTING AND RECOMPACTION OR REPLACEMENT OF EXISTING MATERIAL MAY BE NECESSARY FOR INSTALLATION OF RETAINING WALLS.

EXISTING CONDITIONS LEGEND

- Q.I. Grated Inlet
- C.I. Curb Inlet
- D.C.I. Dual Curb Inlet
- E.M. Electric Meter
- F.M. Flared End
- F.H. Fire Hydrant
- FM Flowline
- GM Gas Meter
- GV Gas Valve
- LS Light Standard
- M.H. Manhole
- PVC Poly Vinyl Chloride
- RCP Reinforced Concrete Pipe
- VCP Vitrified Clay Pipe
- T Top
- U.P. Utility Pole
- BM Bench Mark
- W.M. Water Meter
- W.V. Water Valve
- F.F. Fence Line
- T Telephone Line
- OC Overhead Electric
- SS Sanitary Sewers
- UE Underdrain Electric
- W Water Line

NOTES:
 * APPROXIMATE ELEVATION OF EXISTING IMPROVEMENTS. CONTRACTOR TO FIELD VERIFY AND NOTIFY ENGINEER OF ANY DISCREPANCIES.
 ** INVERT OUT IS NOT BOTTOM OF STRUCTURE. REFER TO WATER QUALITY BMP SCHEDULE FOR SUMP ELEVATION.

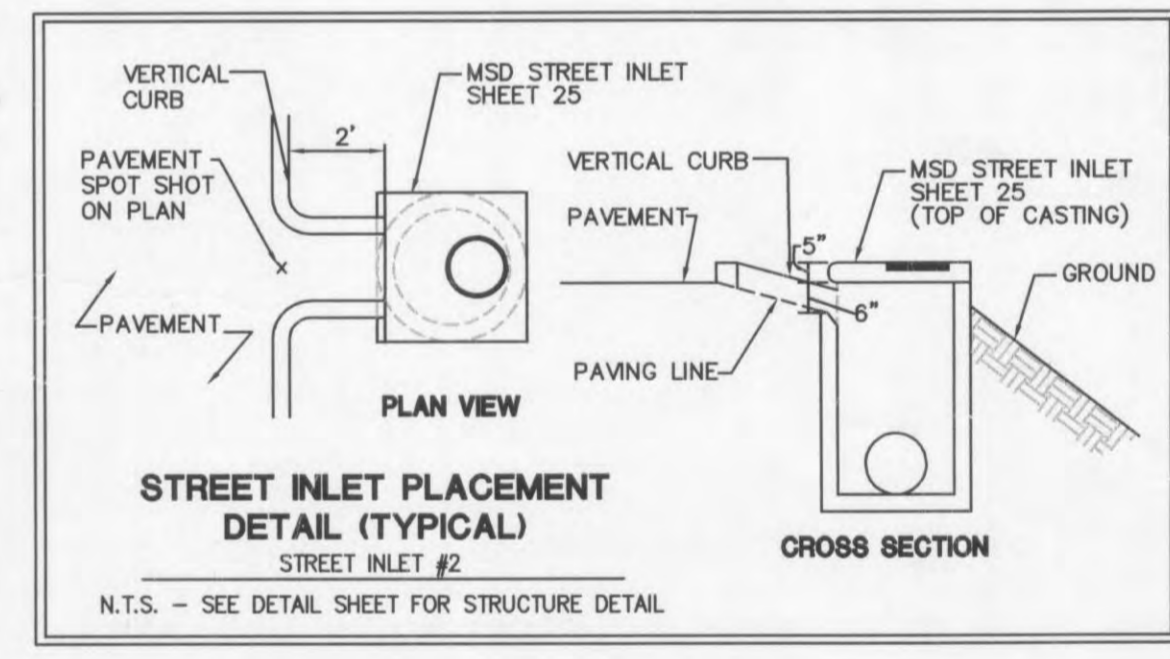
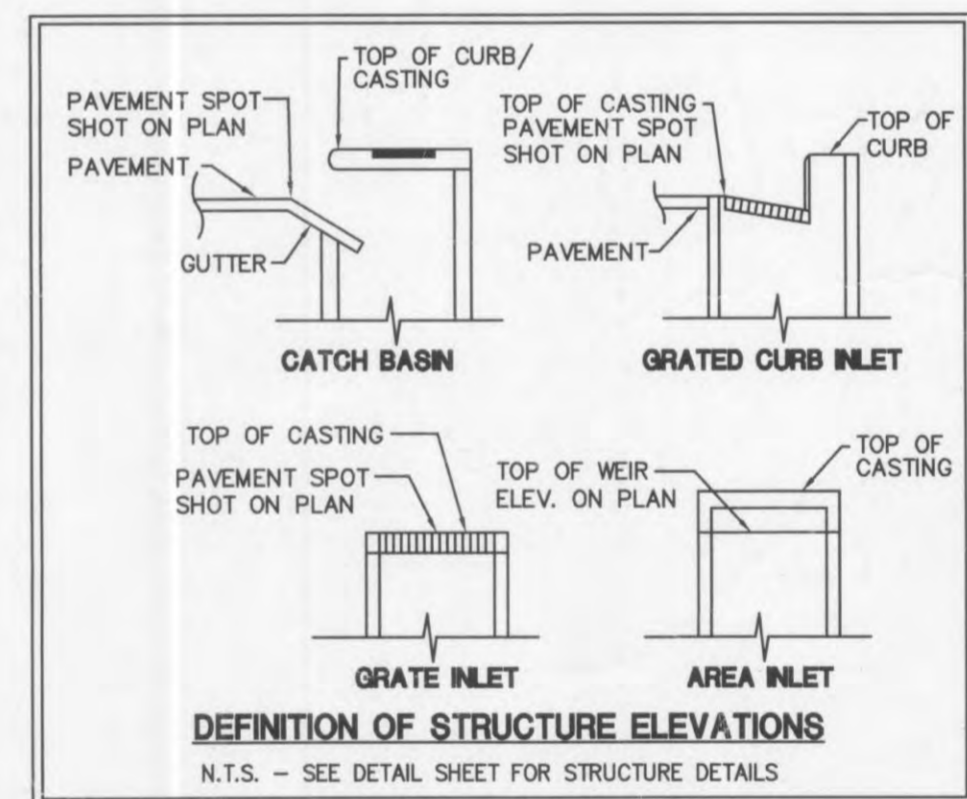

CONTRACTOR TO PROVIDE SHOP DRAWINGS FOR UNDERGROUND DETENTION SYSTEM SEALED BY A PROFESSIONAL ENGINEER LICENSED IN THE STATE OF MISSOURI FOR REVIEW AND APPROVAL PRIOR TO INSTALLATION.

REFER TO SHEET ST-1 FOR GRANULAR FILL REQUIREMENTS FOR STORM SEWER

LIME MODIFICATION CAN NOT BE USED TO STABILIZE HIGH PLASTIC MATERIAL.

REFER TO SHEET C-2 FOR FOUNDATION SUBSURFACE PREPARATION REQUIREMENTS

REFER TO SHEET C-N FOR SITE GRADING NOTES

PLANNING AND DEV. DEPT. FILE NO.: 00-109.02
 DATE OF PLANNING APPROVAL: 09/06/2007

GRADING PLAN

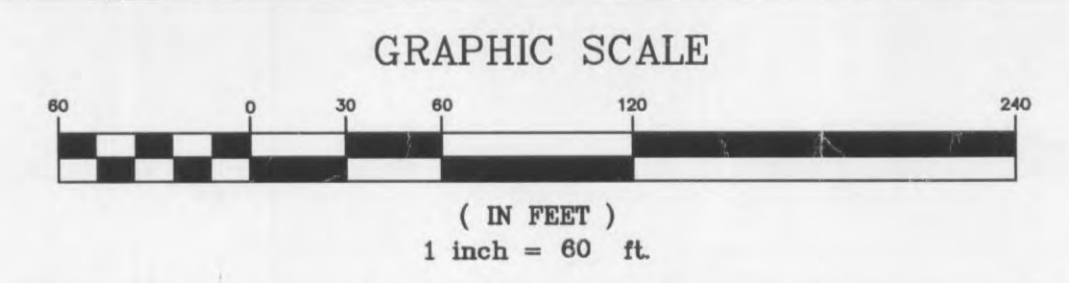

OWNER-
 THE O'FALLON DEVELOPMENT, L.L.C.
 2127 INNERBELT BUSINESS CENTER DR.
 SUITE 200
 ST. LOUIS, MISSOURI 63114
 CONTACT: MR. DARREN RIDENHOUR
 (314) 429-0900
 (314) 429-0999

CONTRACTOR SHALL PROVIDE AS-BUILT SURVEY SEALED BY A MISSOURI RLS FOR ALL NEW STORM SEWER LINES, DETENTION FACILITIES, SANITARY SEWER LINES AND WATER LINES AT LEAST 30 DAYS PRIOR TO POSSESSION.

CONTRACTOR SHALL PROVIDE LEVELING, WHERE NECESSARY, TO ACHIEVE THE PROPOSED GRADES SPECIFIED ON THE GRADING PLAN. CONTRACTOR SHALL INCLUDE ALL COSTS IN BASE BID. REFER TO PAVING PLAN.



Wolverton & Associates
 Consulting Engineers + Land Surveyors
 6745 Sugarloaf Parkway • Suite 100 • Duluth, Georgia 30097
 Phone: (770) 447-8999 • Fax: (770) 447-9070
 WWW.WOLVERTON-ASSOC.COM



PROPOSED EXPANSION TO WAL-MART #2616-04
 O'FALLON POINTE CENTRE
 O'FALLON, MISSOURI 63366
 BY: WAL-MART REAL ESTATE BUSINESS TRUST

REVISIONS
 1. ADDENDUM 6
 6/18/06

DRAWN BY CER
 CHECKED BY DMW
 DATE 05/30/2007
 SCALE 1" = 60'
 JOB No. 06-107
 SHEET NUMBER

C-2A
 EDDS : 6112