

N/F
HARVEST PROPERTIES, INC.
1324/1875

REVISIONS	BY
AUGUST 22, 2007	RWM
DEC. 6, 2007	RWM
APRIL 28, 2008	RWM
MAY 27, 2008	RWM

landscape TECHNOLOGIES
 67 George Clark Dr.
 St. Charles, Missouri 63304
 (636) 928-4260
 (636) 928-4563
 Fax: (636) 928-4563



WAL-MART # 2616-04
 LC-120A-NGR-OR
 134,455 S.F. (EXISTING)
 C-195E-GR-OR
 210,637 S.F. (PROPOSED)

ONE STORY CONCRETE
 BLOCK BUILDING

SEE PLANTING DETAIL
 SHEET L-4

SEE PLANTING DETAIL
 SHEET L-4

SOUTH WOODLAWN AVENUE

EXISTING BUILDING OFFICE

OUTLOT D

LOT 1

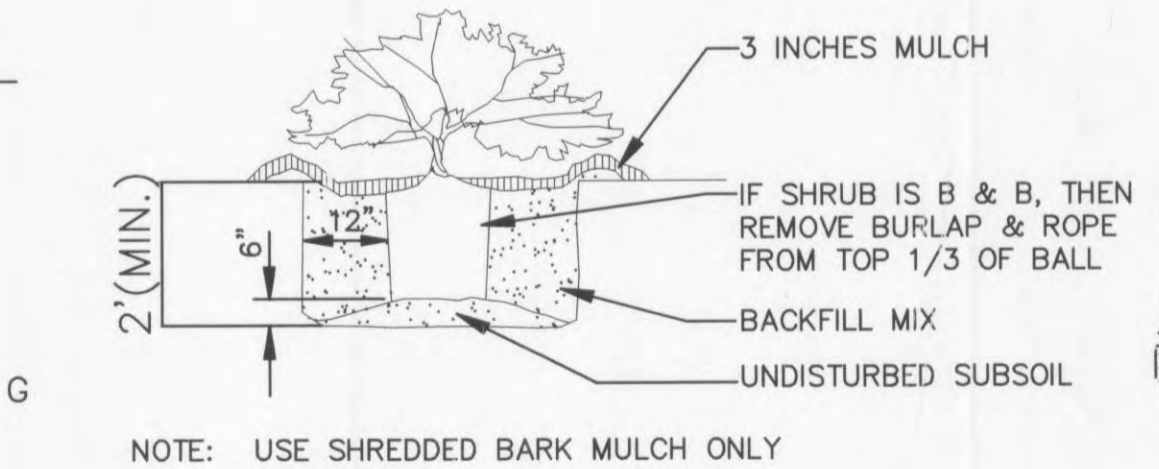
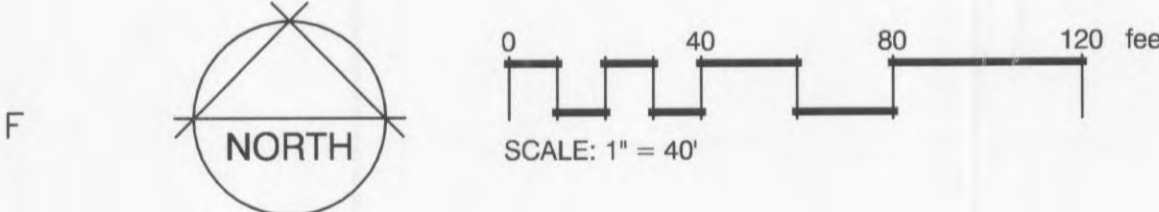

SHRUB PLANTING
 N.T.S.

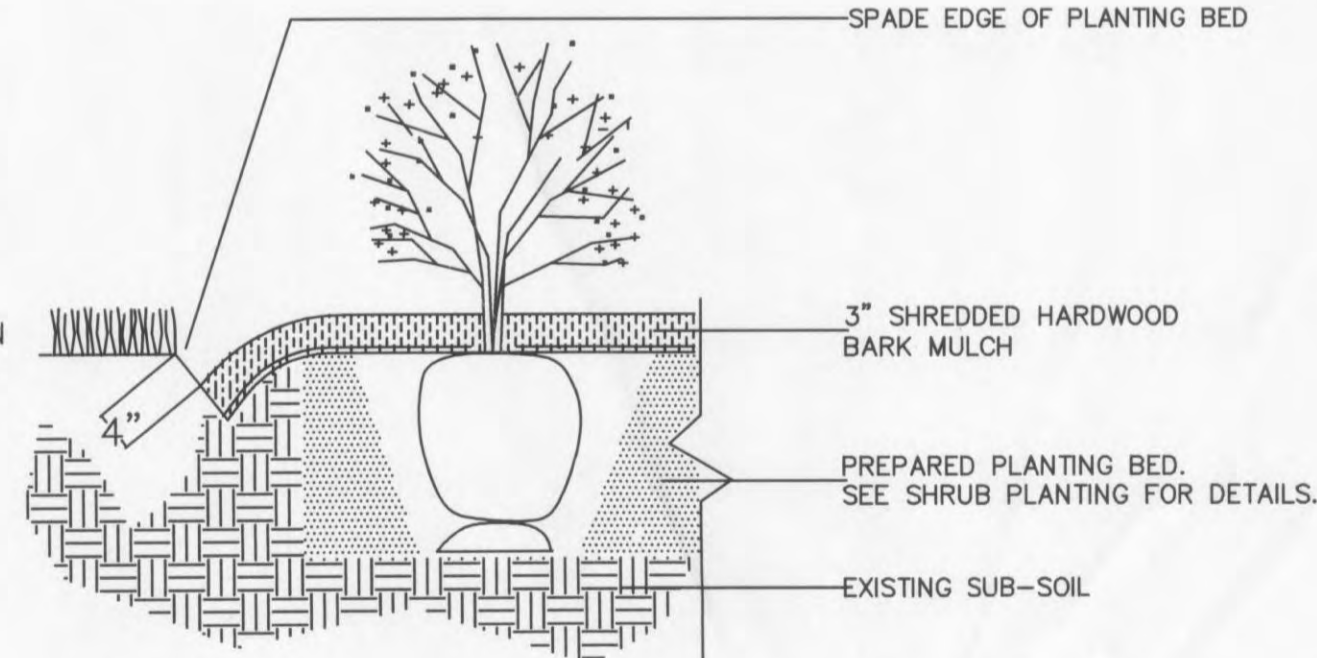

SPADE-CUT EDGE DETAIL
 N.T.S.

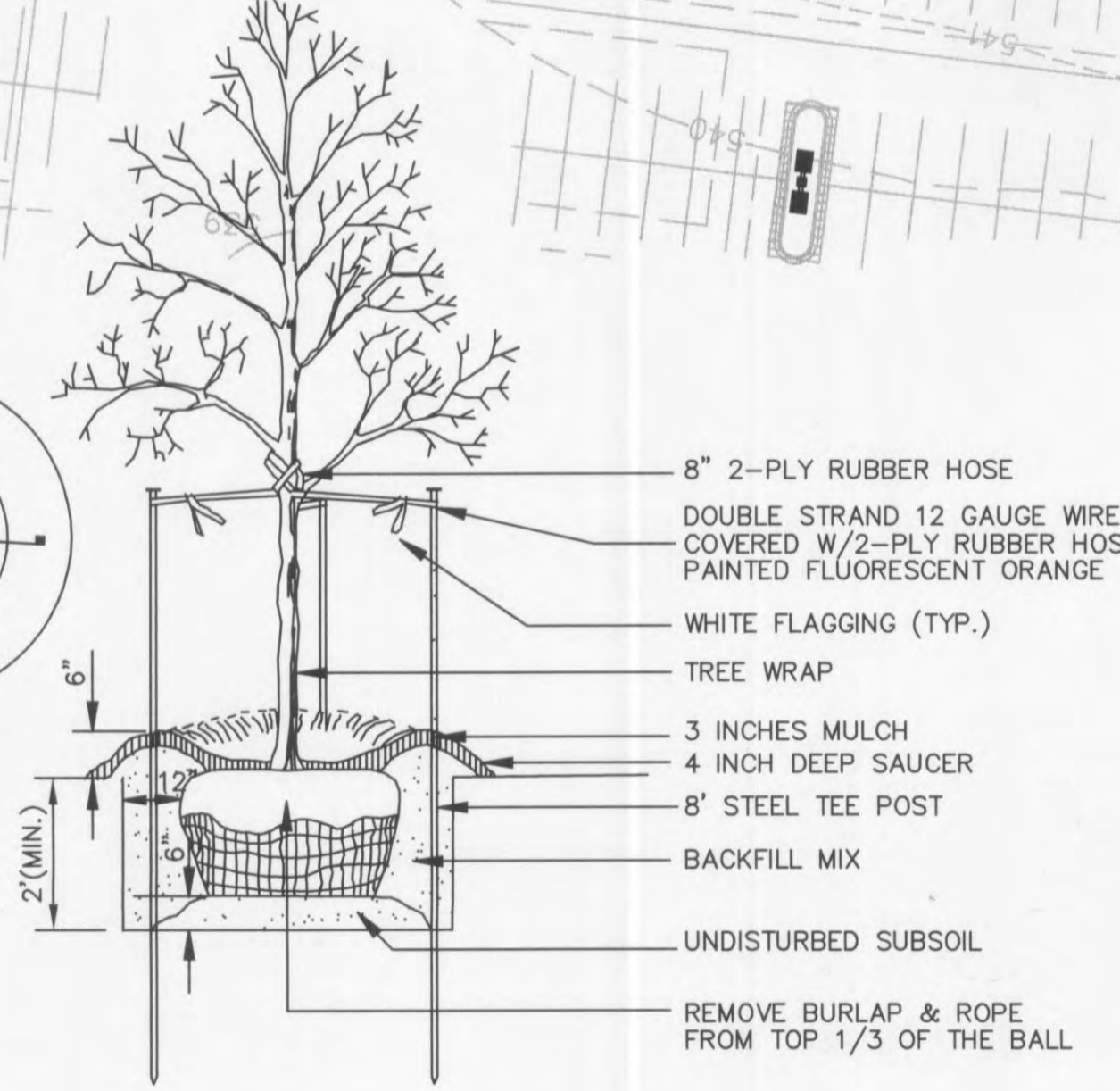

DECIDUOUS TREE PLANTING
 N.T.S.

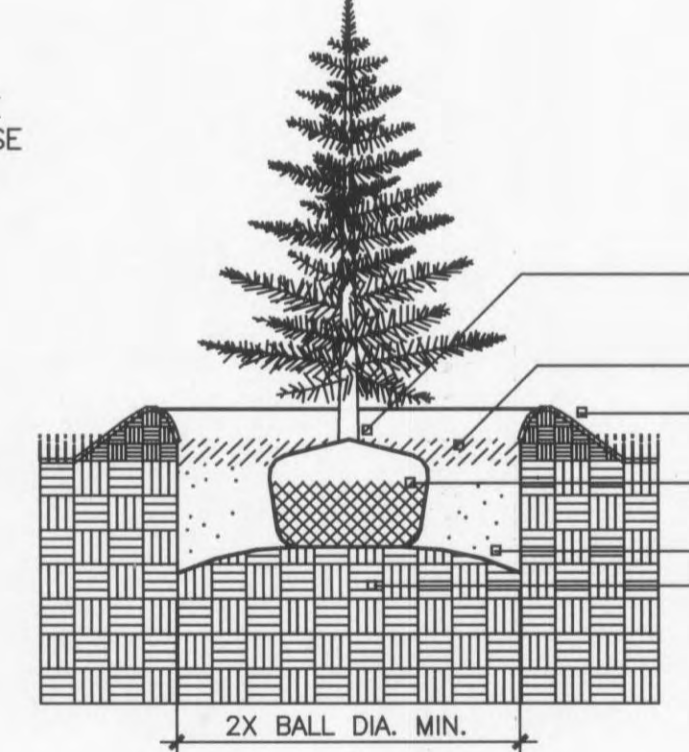

EVERGREEN TREE PLANTING
 N.T.S.

STATE OF MISSOURI
 REGISTERED LANDSCAPE ARCHITECT
 RANDALL W. MARSH
 NUMBER 019
 5/27/08

PLANTING PLAN FOR THE PROPOSED
O'Fallon Pointe
 O'FALLON, MISSOURI

DRAWN	RWM
CHECKED	RWM/SJB
DATE	JUNE 11, 2007
SCALE	1"=40'-0"
JOB No.	2006-229
SHEET	L-2

OF FOUR SHEETS