

Job No. 157-07
 Date: 1/16/08
 Scale: 1"=20'
 Drawn by: BEC
 Design by: BEC
 Approved by: CMB
 File Name: PLN

REVISIONS

12-4-07	MDOT
5-12-08	PED. CROSSING SIGNS

WAL-MART
 Save money. Live better.
 PROPOSED EXPANSION TO WAL-MART #2616-04

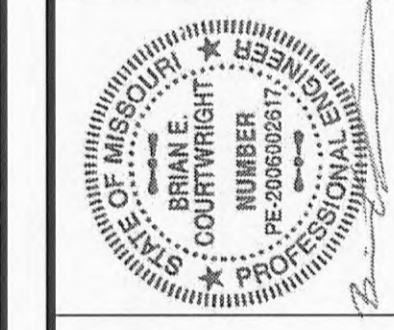

CBB Crawford, Bunte, Brammeier
 Traffic and Transportation Engineers
 St. Louis, Missouri/Glen Carbon, Illinois
 314-878-6644 618-656-2612
 Fax: 314-878-5876 E-Mail: cbb@cbbtraffic.com

ROADWAY PAVEMENT MARKING PLAN
 MO ROUTE K
 @ COMMERCIAL ENTRANCE
 O'FALLON, MISSOURI

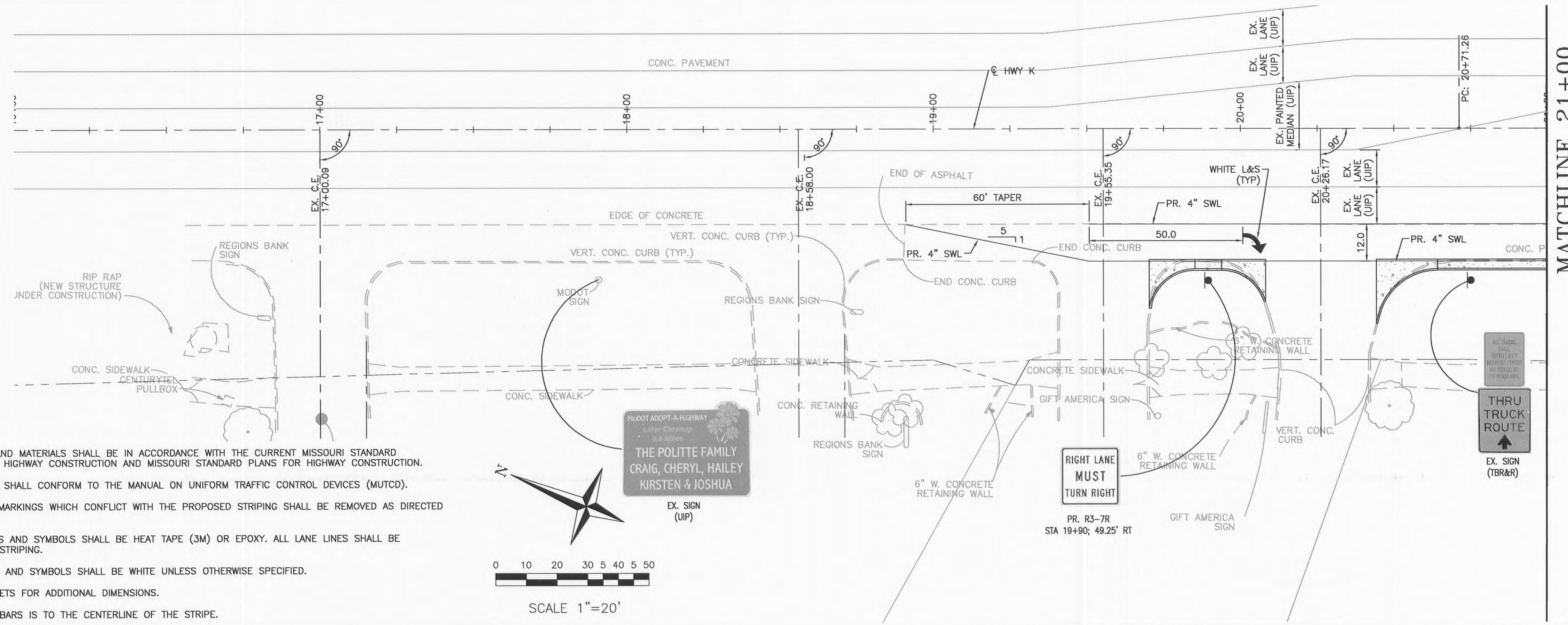

- NOTES
- 1) ALL CONSTRUCTION AND MATERIALS SHALL BE IN ACCORDANCE WITH THE CURRENT MISSOURI STANDARD SPECIFICATIONS FOR HIGHWAY CONSTRUCTION AND MISSOURI STANDARD PLANS FOR HIGHWAY CONSTRUCTION.
 - 2) PAVEMENT MARKINGS SHALL CONFORM TO THE MANUAL ON UNIFORM TRAFFIC CONTROL DEVICES (MUTCD).
 - 3) EXISTING PAVEMENT MARKINGS WHICH CONFLICT WITH THE PROPOSED STRIPING SHALL BE REMOVED AS DIRECTED BY THE ENGINEER.
 - 4) STOPBARS, YELDBARS AND SYMBOLS SHALL BE HEAT TAPE (3M) OR EPOXY. ALL LANE LINES SHALL BE WATERBORNE PAINT STRIPING.
 - 5) ALL ARROWS, WORDS AND SYMBOLS SHALL BE WHITE UNLESS OTHERWISE SPECIFIED.
 - 6) REFER TO PLAN SHEETS FOR ADDITIONAL DIMENSIONS.
 - 7) STATIONING ON STOPBARS IS TO THE CENTERLINE OF THE STRIPE.

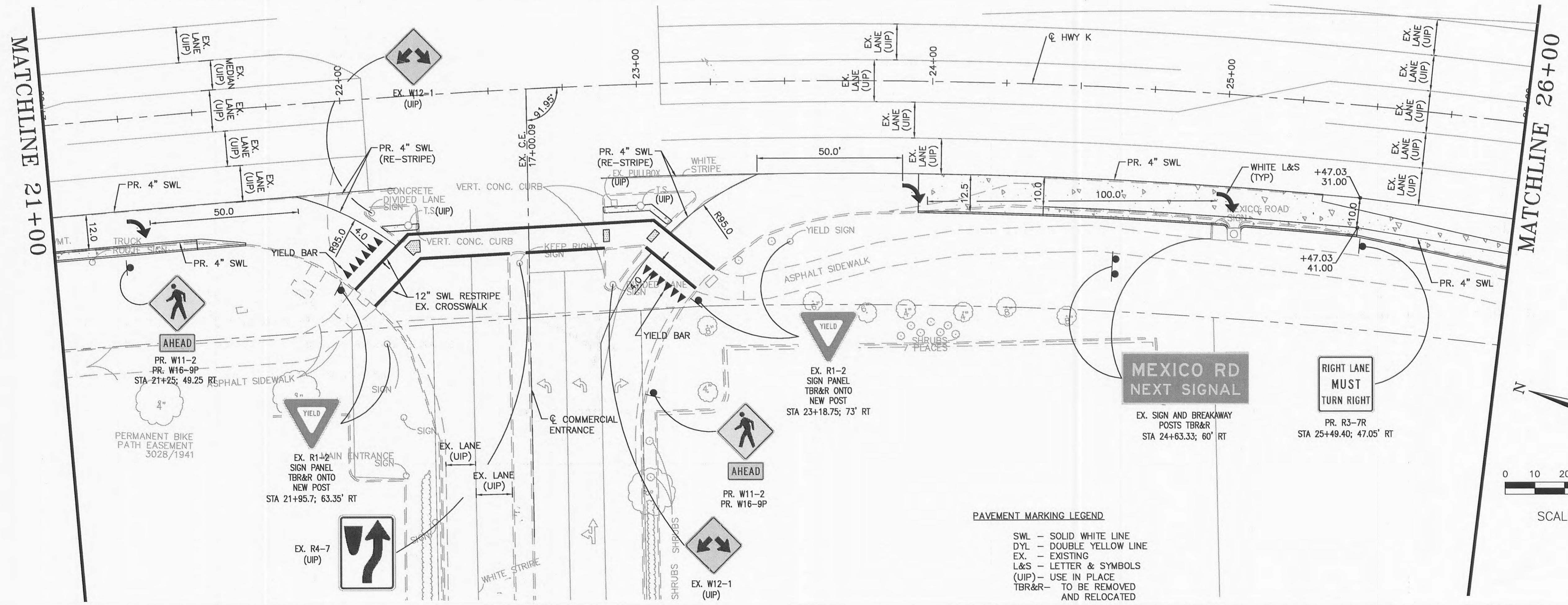

PAVEMENT MARKING LEGEND

- SWL - SOLID WHITE LINE
- DYL - DOUBLE YELLOW LINE
- EX - EXISTING
- L&S - LETTER & SYMBOLS
- (UIP) - USE IN PLACE
- TBR&R - TO BE REMOVED AND RELOCATED