

30 20 10 0 10 20 30 40 50 30 20 10 0 10 20 30 40 50

Location	Project Number	Year	Sheet Number	Total Sheets
O'Fallon, Mo	2065	1981	56	88

DATE _____
BY _____
FINAL SURVEY PLOTTED _____
NOTE BOOK NO. _____
AREAS CHECKED _____

DATE _____
BY _____
ORIGINAL SURVEY PLOTTED _____
NOTE BOOK NO. _____
AREAS CHECKED _____

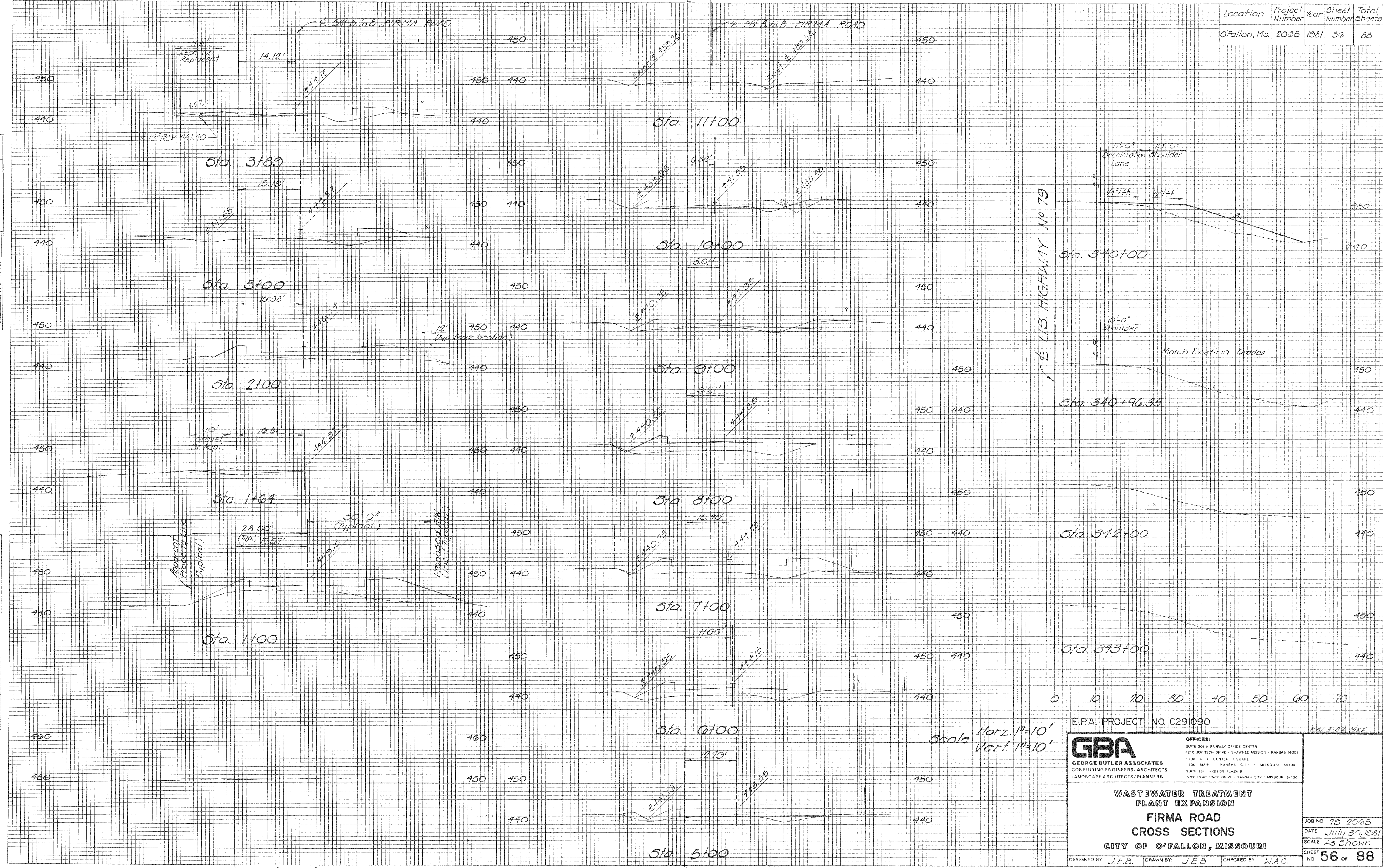

E LIS. HIGHWAY NO 79

E.P.A. PROJECT NO. C291090 Rev. 3/82 MKK

GBA
 GEORGE BUTLER ASSOCIATES
 CONSULTING ENGINEERS / ARCHITECTS
 LANDSCAPE ARCHITECTS / PLANNERS

OFFICES:
 SUITE 305-A FAIRWAY OFFICE CENTER
 4210 JOHNSON DRIVE / SHAWNEE MISSION / KANSAS 66205
 1100 CITY CENTER SQUARE
 1100 MAIN / KANSAS CITY / MISSOURI 64105
 SUITE 134 LAKESIDE PLAZA B
 6700 CORPORATE DRIVE / KANSAS CITY / MISSOURI 64120

**WASTEWATER TREATMENT PLANT EXPANSION
 FIRMA ROAD
 CROSS SECTIONS
 CITY OF O'FALLON, MISSOURI**

DESIGNED BY J.E.B. DRAWN BY J.E.B. CHECKED BY W.A.C.

JOB NO 75-2065
 DATE July 30, 1981
 SCALE As Shown
 SHEET NO 56 of 88