

DATE: _____
 BY: _____
 SURVEYED: _____
 NOTE BOOK: _____
 ALIGNMENT CHECKED: _____
 RT. OF WAY CHECKED: _____
 NO. _____

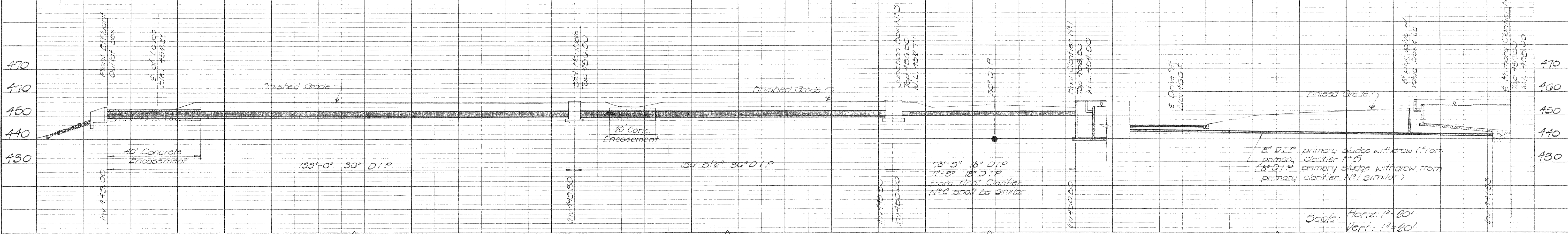

DATE: _____
 BY: _____
 SURVEYED: _____
 NOTE BOOK: _____
 GRADES CHECKED: _____
 B. M.'S NOTED: _____
 STRUCTURE NOTINGS CHECKED: _____
 NO. _____

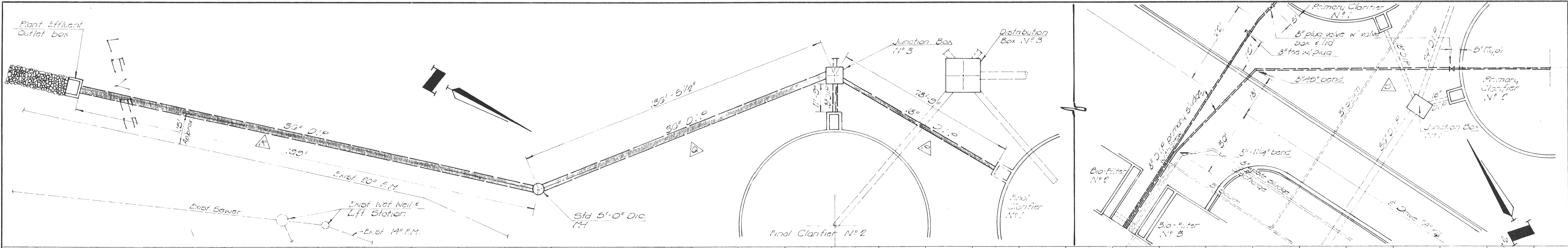
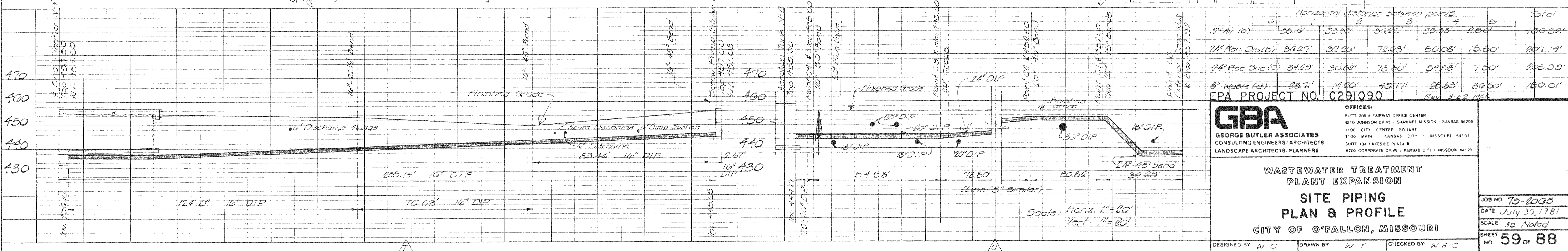
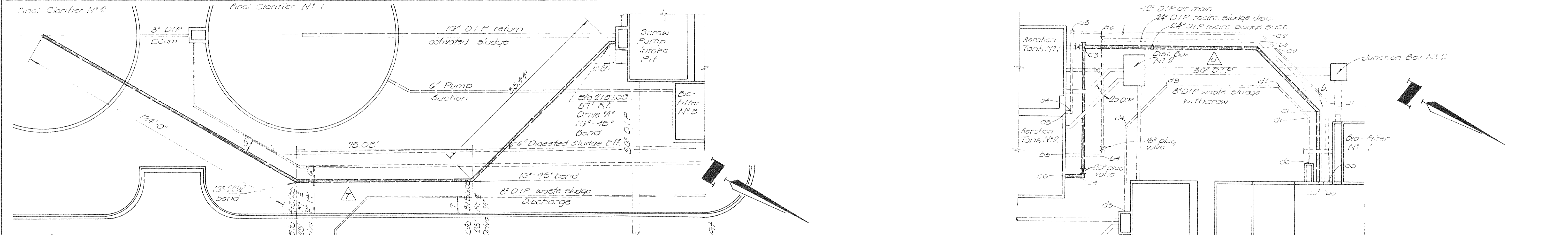

Horizontal distance between points		Total				
1	2	3	4	5	6	
24" Air (a)	36.74'	33.60'	64.25'	35.98'	2.60'	109.32'
24" Rec. Dis. (a)	36.97'	32.24'	78.03'	50.08'	15.80'	203.14'
24" Rec. Suction (a)	34.29'	30.82'	78.80'	54.58'	7.80'	200.29'
8" Waste (a)	23.71'	14.20'	13.77'	26.83'	36.60'	150.01'

EPA PROJECT NO. C291090

GBA
 GEORGE BUTLER ASSOCIATES
 CONSULTING ENGINEERS, ARCHITECTS
 LANDSCAPE ARCHITECTS/PLANNERS

OFFICES:
 SUITE 305-A FAIRWAY OFFICE CENTER
 4210 JOHNSON DRIVE / SHAWNEE MISSION, KANSAS 66205
 1100 CITY CENTER SQUARE
 1100 MAIN / KANSAS CITY, MISSOURI 64105
 SUITE 134 LAKESIDE PLAZA #
 8700 CORPORATE DRIVE / KANSAS CITY, MISSOURI 64120

WASTEWATER TREATMENT PLANT EXPANSION

SITE PIPING PLAN & PROFILE

CITY OF O'FALLON, MISSOURI

DESIGNED BY N.C. DRAWN BY N.Y. CHECKED BY W.A.C.

JOB NO. 70-2005
 DATE July 30, 1981
 SCALE As Noted
 SHEET NO. 59 OF 88