

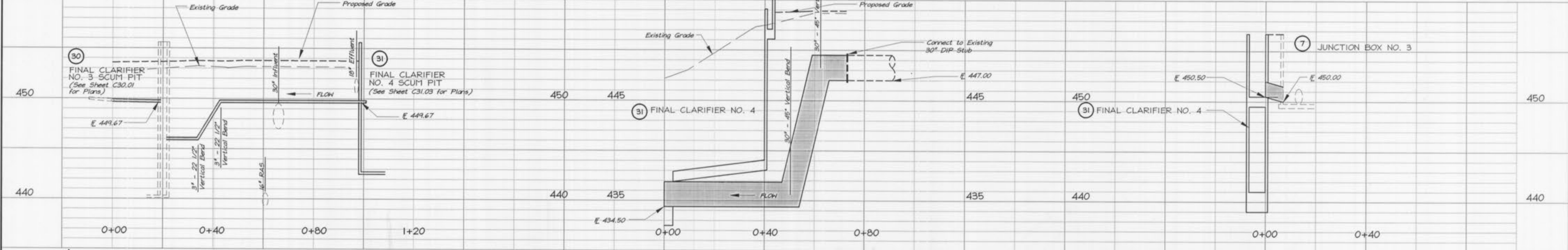

The existence and location of any underground utility pipes, lines, or structures shown on these drawings are obtained by a search of the available records. The contractor is required to take due precautionary measures to protect the utility lines shown, and all other lines not of record or not shown on these drawings by verification of their location in the field prior to the initiation of the actual portion of work. Contractor shall immediately repair any damaged utility caused by his activities at no additional cost to Owner.

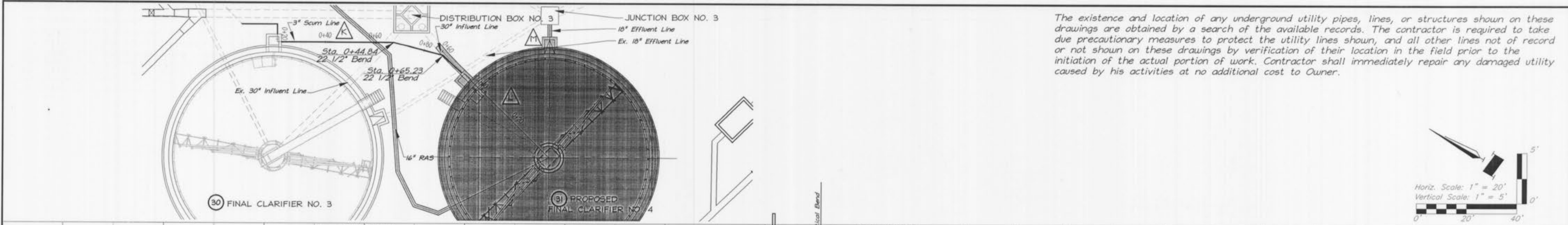

FINAL CLARIFIER NO. 4 - 3' SCUM LINE **FINAL CLARIFIER NO. 4 - 30' INFLUENT LINE** **FINAL CLARIFIER NO. 4 - 18' EFFLUENT LINE**

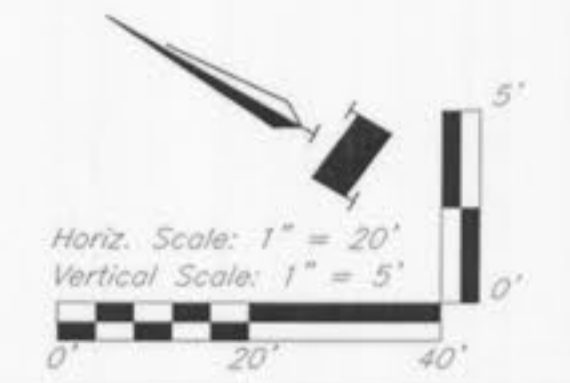
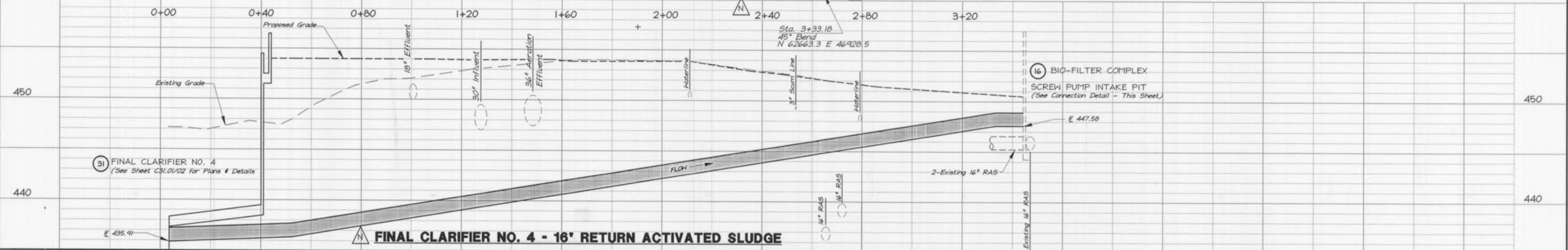
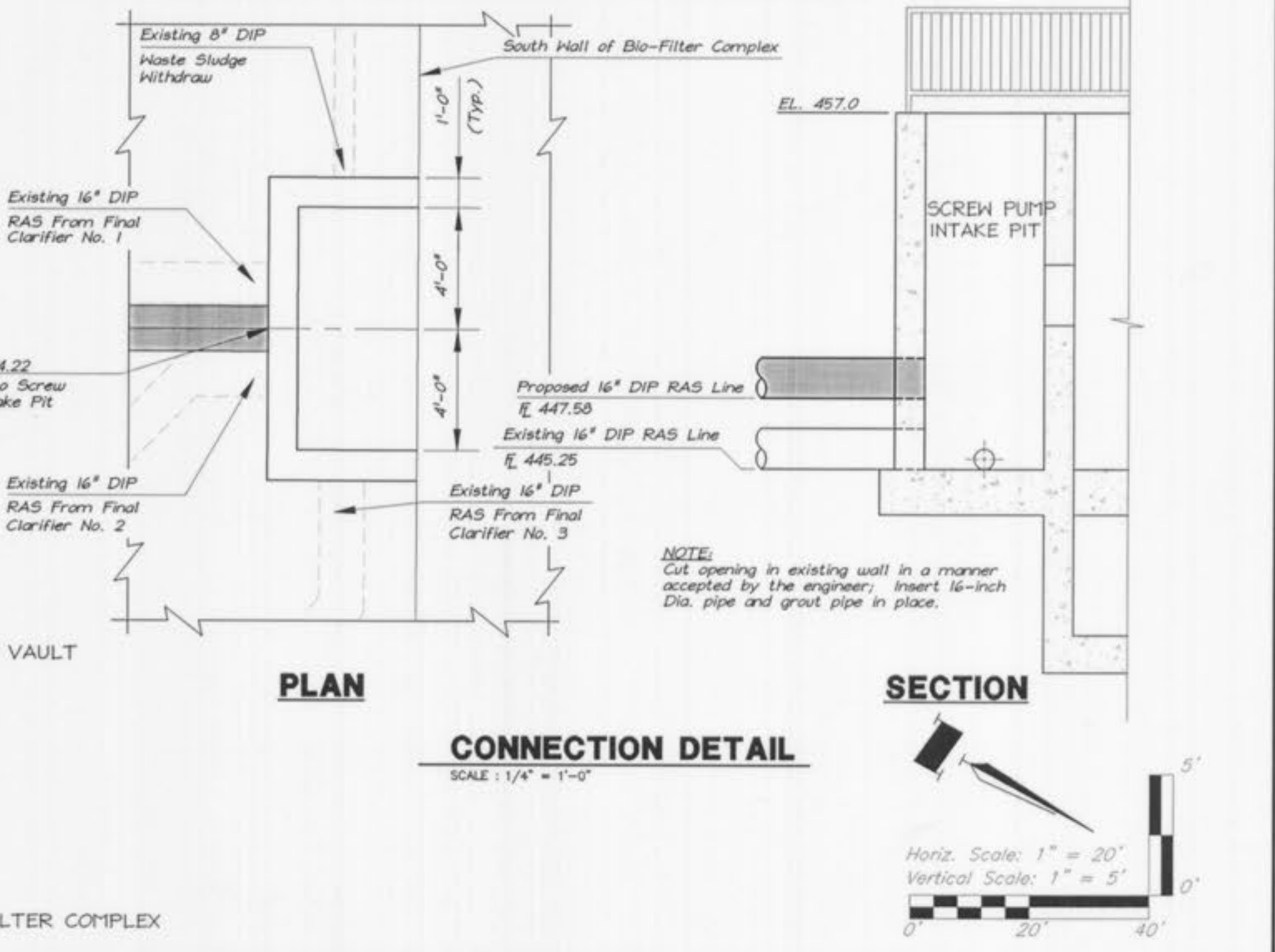
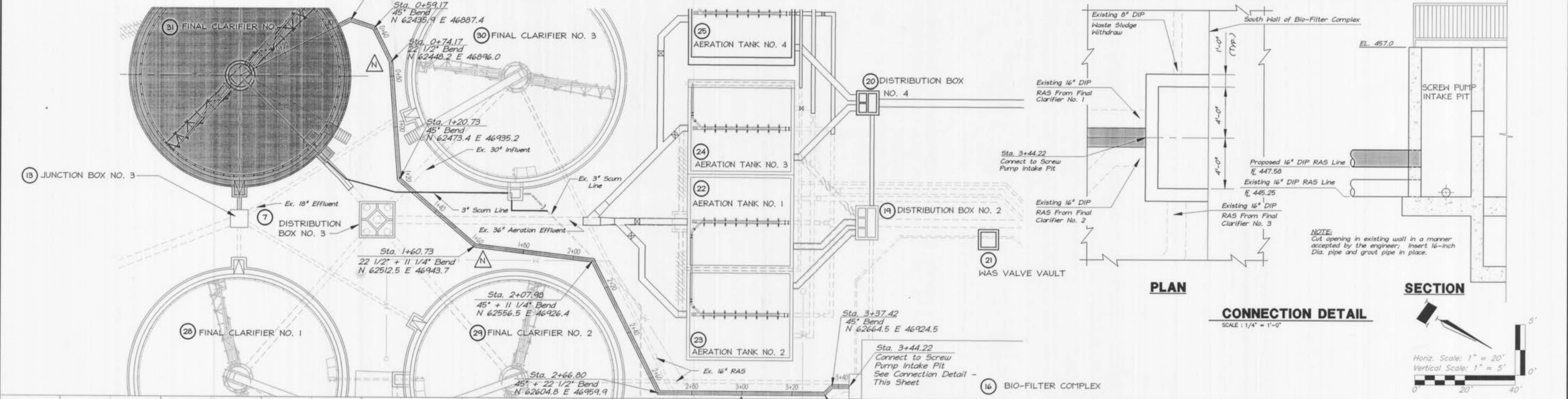

FINAL CLARIFIER NO. 4 - 16' RETURN ACTIVATED SLUDGE