

JAMB REINFORCING SCHEDULE				
WALL SIZE	WALL HEIGHT	OPENING WIDTH	EXTERIOR WALL REINFORCEMENT	INTERIOR WALL REINFORCEMENT
12"	<=18'-0"	<=7'-0"	1-#5 EF	1-#5 EF
		<=12'-0"	2-#5 EF	1-#5 EF
		<=4'-0"	1-#6 EF	1-#5 EF
		<=7'-0"	1-#6 EF	1-#5 EF
	<=20'-0"	<=12'-0"	3-#6 EF	1-#5 EF
		<=4'-0"	1-#6 EF	1-#5 EF
		<=7'-0"	2-#6 EF	1-#5 EF
		<=12'-0"	3-#6 EF	2-#5 EF
8"	<=13'-0"	<=4'-0"	1-#5 EF	1-#5 EF
		<=7'-0"	1-#6 EF	1-#5 EF
		<=12'-0"	3-#6 EF	1-#5 EF
		<=4'-0"	1-#6 EF	1-#5 EF
	18'-0"	<=7'-0"	2-#7 EF	2-#5 EF
		<=4'-0"	2-#5 EF	2-#5 EF
		<=8'-0"	2-#6 EF	2-#6 EF
		<=13'-0"	2-#7 EF	2-#7 EF

- NOTES:
- WALL HEIGHT IS DISTANCE FROM BOTTOM OF MASONRY WALL TO THE LOCATION OF TOP LATERAL SUPPORT.
  - THE SCHEDULED REINFORCING SHALL BE PLACED WITH ONE BAR AT EACH FACE OF THE WALL. ONLY ONE PAIR OF BARS SHALL BE PLACED IN EACH CELL.
  - AN INTERIOR WALL IS A WALL IN WHICH NO PORTION OF THE WALL IS EXPOSED TO THE EXTERIOR.
  - AT LOCATIONS WHERE WALLS CANTILEVER ABOVE THE TOP LATERAL SUPPORT, THE WALL HEIGHT FOR ABOVE SCHEDULE SHALL BE THE GREATER OF THE HEIGHT IN NOTE 1 OR DOUBLE THE DISTANCE FROM LATERAL SUPPORT TO THE TOP OF THE WALL.
  - REINFORCE JAMBS AS INDICATED UNLESS NOTED OTHERWISE ON THE DRAWINGS.

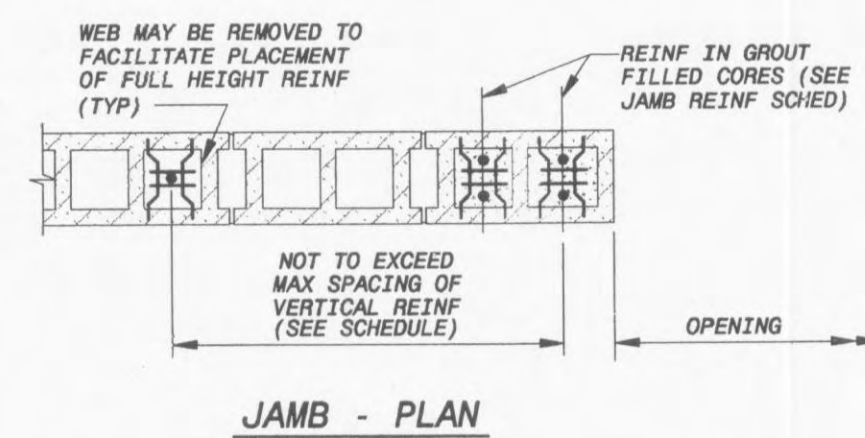

TYPICAL MASONRY JAMB PLAN AND SCHEDULE  
NO SCALE

LINTEL SCHEDULE			
WALL SIZE	OPENING WIDTH	LINTEL DEPTH	LONGITUDINAL REINFORCEMENT
12"	<=4'-0"	0'-8"	2-#5
	<=8'-0"	1'-4"	2-#5
	<=12'-0"	2'-0"	2-#6
	<=16'-0"	2'-0"	2-#6
	<=20'-0"	2'-8"	2-#7
8"	<=4'-0"	0'-8"	2-#5
	<=8'-0"	1'-4"	2-#5
	<=15'-0"	2'-0"	2-#5

- NOTES:
- BEAR ALL LINTELS A MINIMUM 2'-0" AT EACH END.
  - REINFORCE LINTELS AS INDICATED ABOVE UNLESS NOTED OTHERWISE ON THE DRAWINGS.

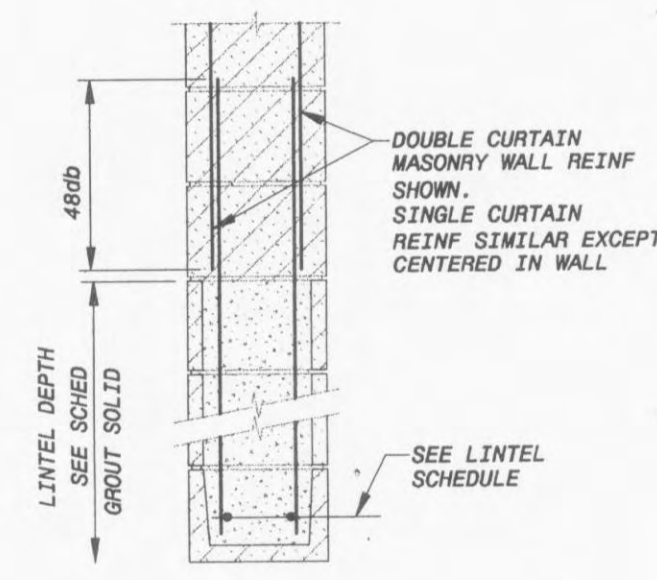

TYPICAL MASONRY LINTEL SECTION AND SCHEDULE  
NO SCALE

GENERAL NOTES

- THE DETAILS ON THIS SHEET ARE APPLICABLE TO ALL CONCRETE MASONRY CONSTRUCTION. SPECIAL NOTES, SECTIONS AND DETAILS SPECIFICALLY NOTED ON THE DESIGN DRAWINGS SHALL BE APPLICABLE IN LIEU OF THESE TYPICAL DETAILS, EXCEPT THAT REINFORCEMENT SHALL NOT BE LESS THAN THE TYPICAL REINFORCEMENT REQUIRED.
- FOR MISCELLANEOUS APPURTENANCES INCLUDING EMBEDMENTS, BRACING, STEEL OR PRECAST LINTELS, VENEER, FLASHING, WEEPS, INSULATION, SEALING, CAULKING AND EMBEDDED PIPE AND ELECTRICAL CONDUIT, SEE THE DESIGN DRAWINGS.
- MASONRY SHALL BE CONSTRUCTED WITH SLEEVES AS REQUIRED TO ACCOMMODATE PASSAGE OF PENETRATING PIPING, CONDUIT AND DUCT BANKS INDICATED ON THE CIVIL, MECHANICAL AND ELECTRICAL DRAWINGS.
- Ø DENOTES REINFORCING BAR DIAMETER. UNØ DENOTES 'UNLESS NOTED OTHERWISE'.
- SPECIAL INSPECTION IS REQUIRED FOR ALL MASONRY.
- WORK THIS DRAWING WITH THE TYPICAL MASONRY WALL REINFORCING DRAWING.

CONFORMED TO CONSTRUCTION RECORDS	2	NO.	BY	CHK	APP
ADDENDUM	1				
DATE		REVISED			
CYONET ID: 97515-300-S-T0000105		REVISIONS AND RECORD OF ISSUE			
DATE					
SAVED: BOWI4813, 3/25/2003 3:11:55 PM					
DWG VER #: 7.0					
PLOTTED: 1/14/2004 10:23:23 AM					
USER: BOWI4813					

\*THIS DRAWING WAS ORIGINALLY APPROVED FOR CONSTRUCTION BY WILLIAM F. RILEY ON 10/08/01 AND SEALED BY WILLIAM F. RILEY, A LICENSED PROFESSIONAL ENGINEER IN THE STATE OF MISSOURI, NO. E-20756\*



CITY OF O'FALLON, MISSOURI  
WATER TREATMENT PLANT  
STRUCTURAL MASONRY LINTEL AND JAMB REINFORCING DETAILS

DESIGNED: WFR  
DETAILED: LWF  
CHECKED: MER  
APPROVED: WFR  
DATE: 10/8/01

PROJECT NO.  
97515

I4  
SHEET 42 OF 96