

SOUTH ENTRANCE - PLAN VIEW
SCALE: 1" = 10'

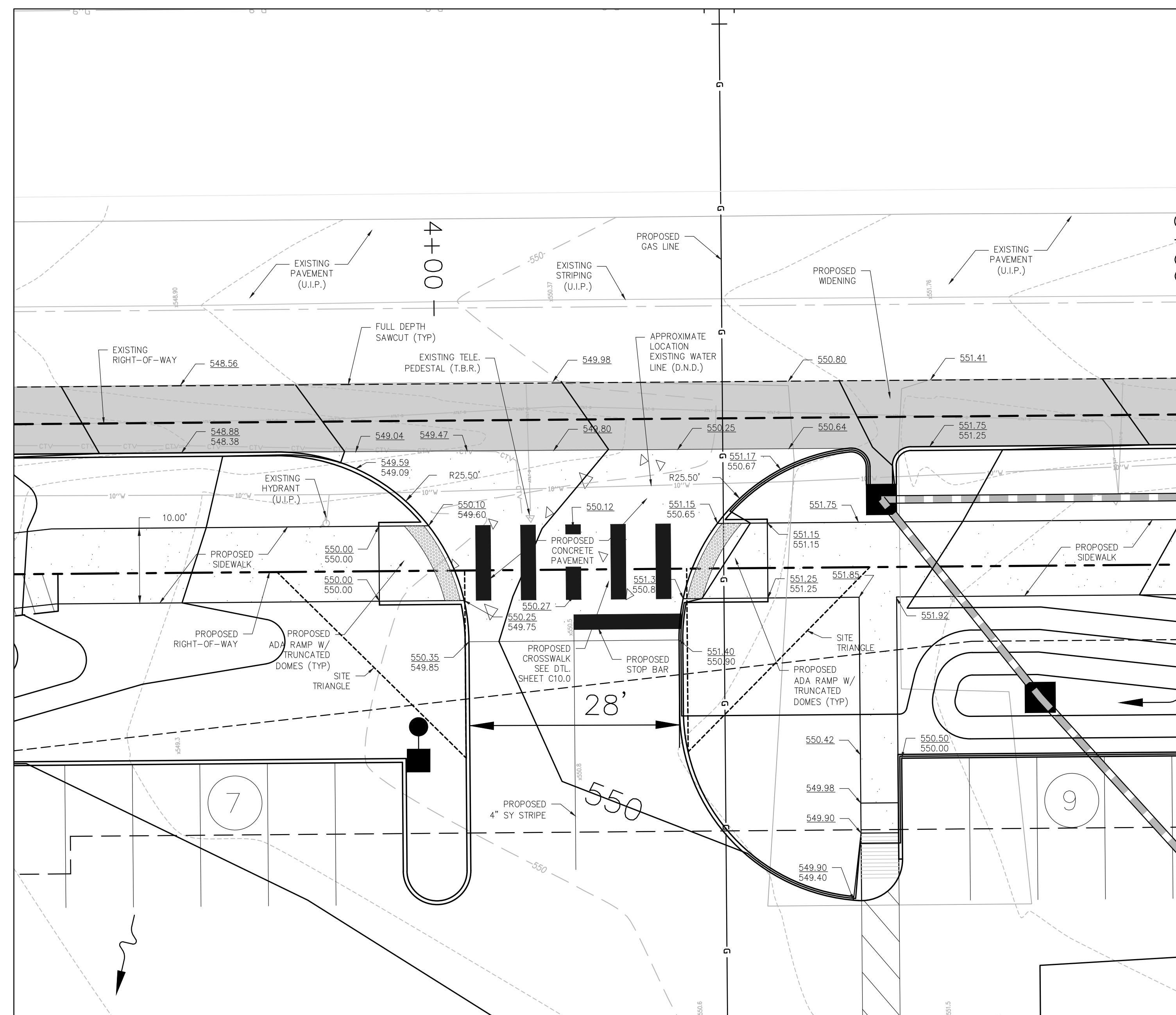

NORTH ENTRANCE - PLAN VIEW
SCALE: 1" = 10'

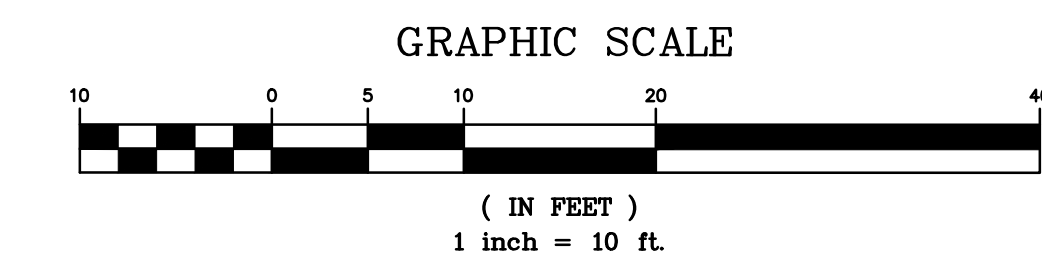

GENERAL NOTES

1. ALL WORK WITHIN RIGHT-OF-WAY SHALL BE PER CITY OF O'FALLON STANDARDS AND SPECIFICATIONS.
2. CONTRACTOR TO FULL DEPTH SAWCUT AND REMOVE EXISTING PAVEMENT, SIDEWALK AND/OR CURBS AS NECESSARY TO CONSTRUCT IMPROVEMENTS.
3. CONTRACTOR SHALL NOTIFY ENGINEER OF DISCREPANCIES PRIOR TO ENTRANCE, CURB CUT AND/OR ADA RAMP INSTALLATION.
4. CONTRACTOR SHALL LOCATE ALL EXISTING UTILITIES INCLUDING PUBLIC & PRIVATE LIGHTING CONDUITS, IRRIGATION LINES AND COMMUNICATIONS LINES PRIOR TO REMOVAL AND REPLACEMENT OF EXISTING PAVEMENTS AND SIDEWALKS.

STRIPING AND PAVEMENT MARKING LEGEND	
ACRYLIC WATERBORNE PAINT	
SY	= SOLID YELLOW PVMT MARKING
DSY	= DOUBLE SOLID YELLOW PVMT MARKING
IY	= INTERMITTENT YELLOW PVMT MARKING
SW	= SOLID WHITE PVMT MARKING
IW	= INTERMITTENT WHITE PVMT MARKING
STOP BAR	= 24" SOLID WHITE PVMT MARKING
CROSS WALK	= 36" SOLID WHITE PVMT MARKING
ARROWS	= SOLID WHITE PVMT MARKING

TYPICAL STRIPING NOTES:

1. TURN ARROWS SHALL CONFORM TO MDDOT STANDARDS PER STANDARD DRAWINGS AND SPECIFICATIONS.
2. STOP BARS TO BE 24" WIDE, LENGTH AS SHOWN ON PLAN.
3. ALL PROPOSED STRIPING AND PAVEMENT MARKINGS SHALL BE IN ACCORDANCE WITH THE MANUAL FOR UNIFORM TRAFFIC CONTROL DEVICES, LATEST EDITION.
4. ALL PUBLIC ROADWAY PAVEMENT MARKINGS (WELDON SPRING ROAD) SHALL BE THERMOPLASTIC. ALL ON-SITE PARKING LOT STRIPING SHALL BE PAINTED.
5. ALL CROSS-WALK STRIPING SHALL USE HIGH-VISIBILITY PAVEMENT MARKINGS.

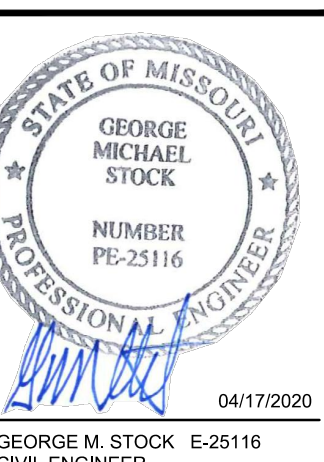

REVISIONS:

1	01/16/2020	- 60% PRINTING
2	02/14/2020	- PERMIT SET
3	03/25/2020	- REVISED PER OWNER / CITY UTILITY COMMENTS
4	04/17/2020	- AGENDUM A

DRAWN BY:	C.M.S.	CHECKED BY:	C.M.S.
DATE:	01/16/2019	JOB NO.:	219-6494