

LIGHTING LEGEND

	CONTROLLER, LIGHTING		LED-A LUMINAIRE
	CONTROLLER, LIGHTING (EXISTING)		LED-B LUMINAIRE
	WOOD POST		LED-C LUMINAIRE
	POWER SUPPLY		P.S. POWER SOURCE
	JUNCTION BOX		PULL BOX (EXISTING)
	PULL BOX CONCRETE TYPE 1		PULL BOX CONCRETE TYPE 2
	PULL BOX PREFORMED TYPE 1		PULL BOX PREFORMED TYPE 2
	CONDUIT, RIGID (TRENCH)		CONDUIT, RIGID (PUSHED)
	CONDUIT, RIGID (MEDIAN)		CONDUIT, RIGID (BRIDGE)
	CONDUIT, RIGID (EXISTING)		CABLE-CONDUIT (EXISTING)
			CABLE-CONDUIT

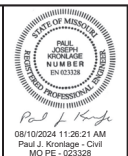
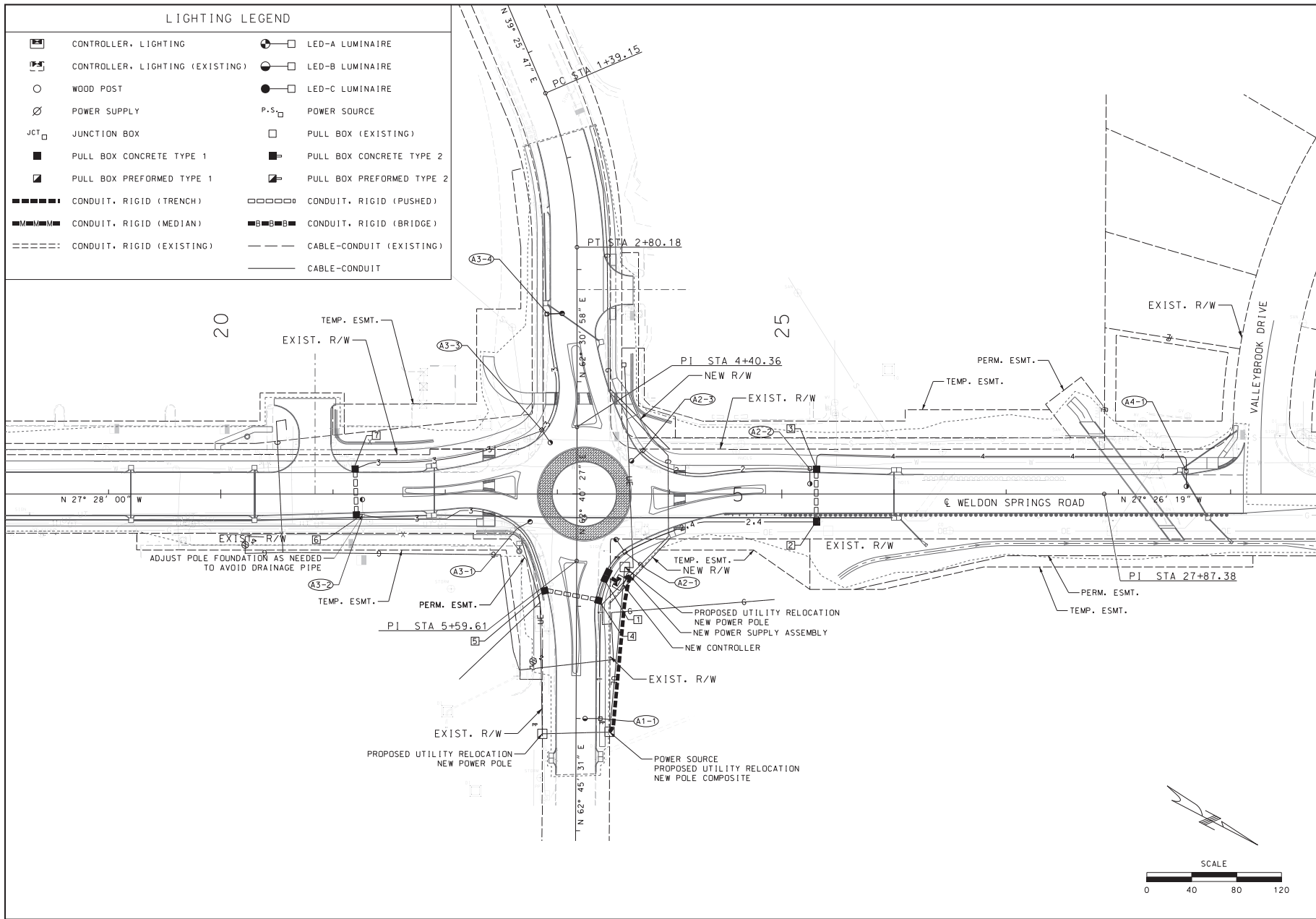

DATE PREPARED
8/8/2024

DISTRICT STATE
39 MO

ROUTE
WELDON SPRING

DA JOB NO.
221150

EW GATEWAY ID.
7209-22

PROJECT NO.
CMAO-7302 (691)

BRIDGE NO.
N/A

DATE	DESCRIPTION

EF&K MOEN
Civil Engineering Design
13033 WILSON ROAD, SUITE 200
BELLAMY, MD 21038
Phone: 301.343.0336
Fax: 301.343.0337
Missouri Certificate of Authority: 00078



CITY OF FALLON, MISSOURI
100 NORTH MAIN STREET
FALLON, MO 63366
Tel: 636-239-5996

LIGHTING PLAN
SHEET 1 OF 2

IF A SEAL IS PRESENT ON THIS SHEET IT HAS BEEN ELECTRONICALLY SEALED AND DATED.