

REVISIONS	BY
JULY 22, 2008	RHM

landscape TECHNOLOGIES
 67 Jacobs Creek Drive
 St. Charles, Missouri 63043
 (636) 928-2200
 Fax: (636) 928-4595

PLANTING PLAN FOR THE PROPOSED
Wendy's Restaurant
 OF FALLON, MISSOURI

DRAWN	R. HARRIS
CHECKED	RHM
DATE	JULY 1, 2008
SCALE	1"=20'-0"
JOB No.	2008-175
SHEET	L-1

OF ONE SHEET

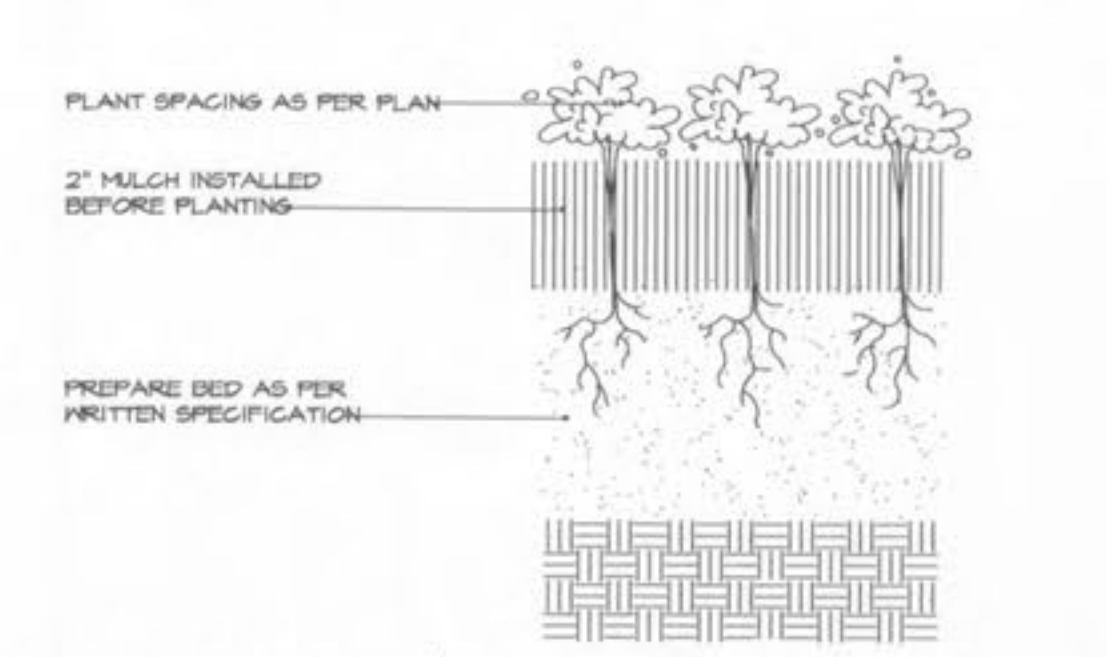
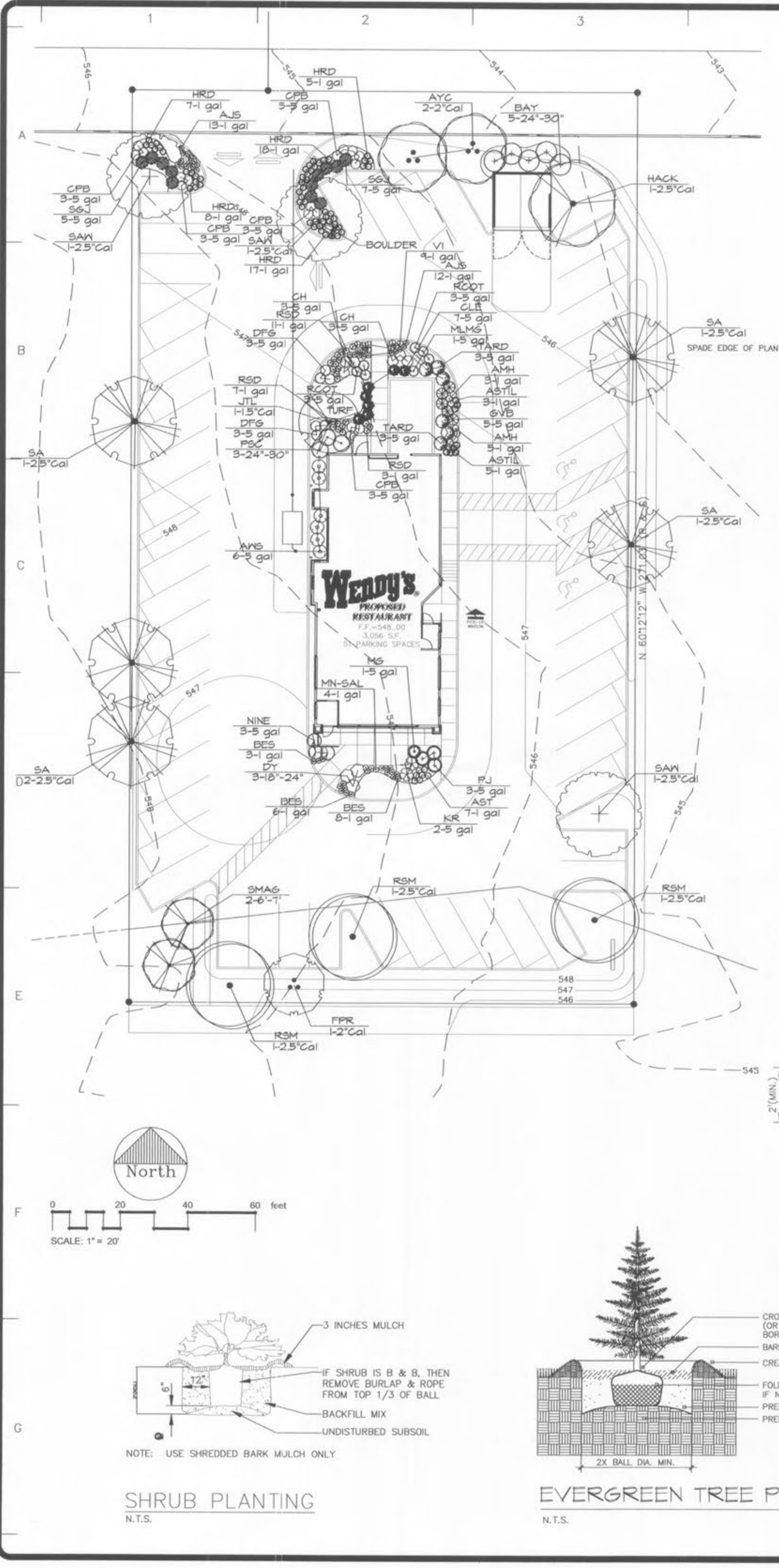

PERENNIAL / ANNUAL PLANTING
N.T.S.

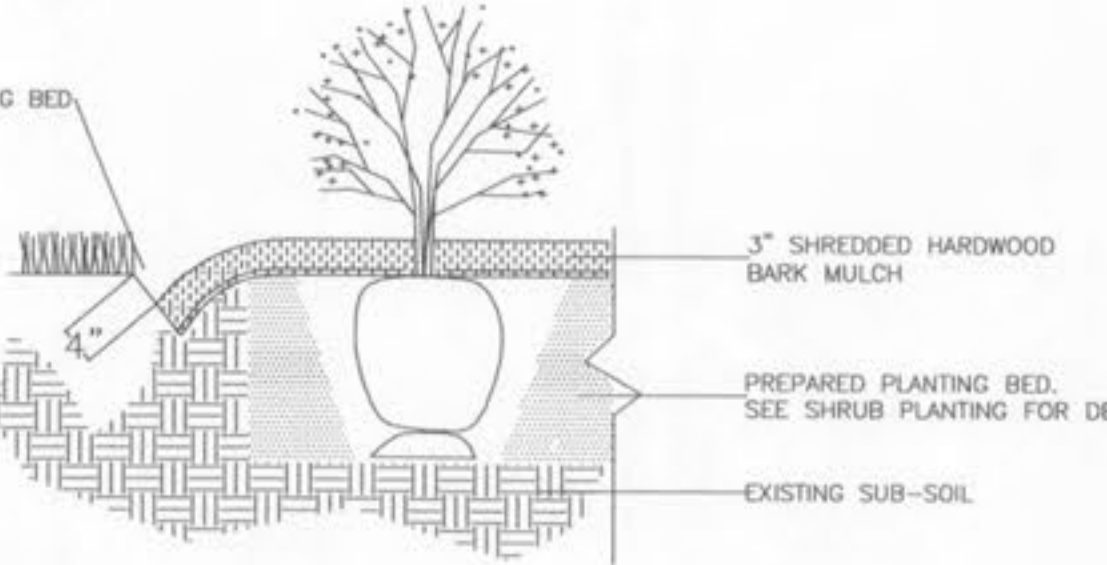

SPADE-CUT EDGE DETAIL
N.T.S.

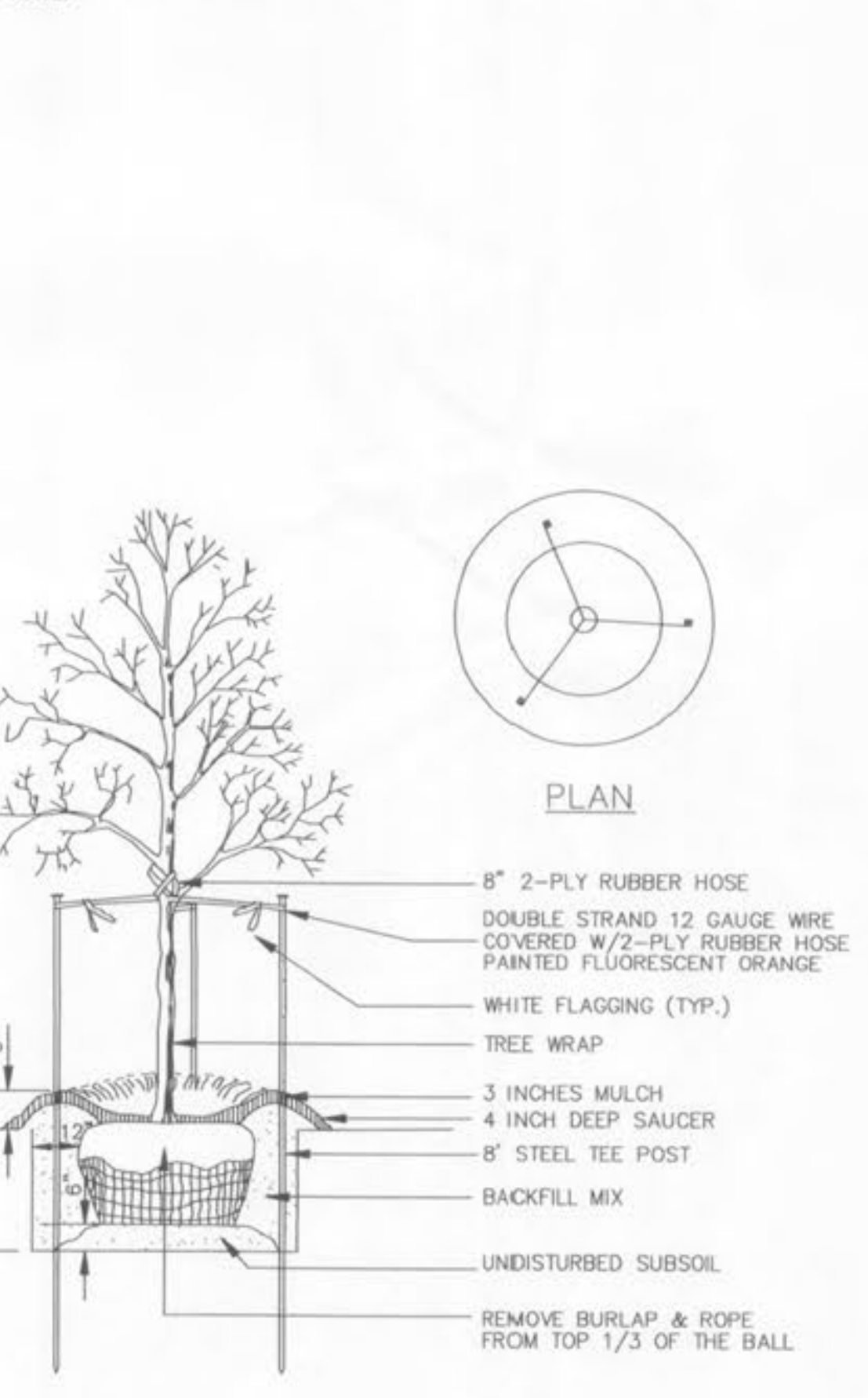

NOTE: USE SHREDDED BARK MULCH ONLY
DECIDUOUS TREE PLANTING
N.T.S.

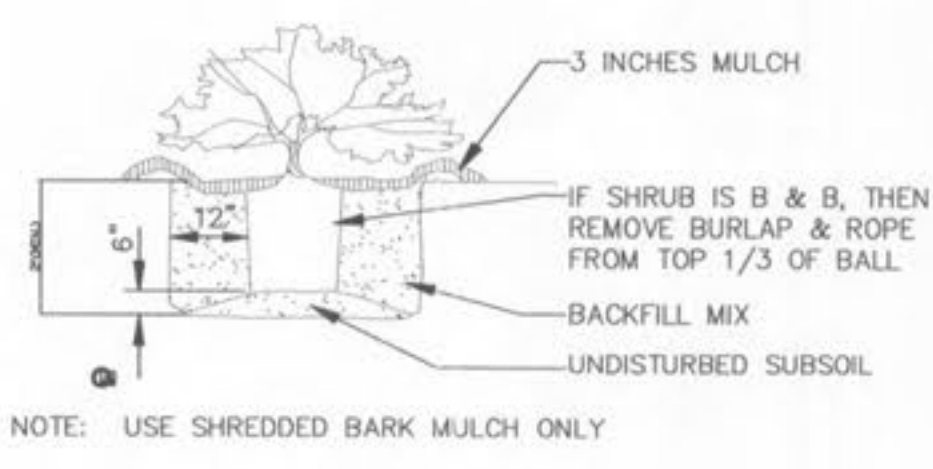

NOTE: USE SHREDDED BARK MULCH ONLY
SHRUB PLANTING
N.T.S.

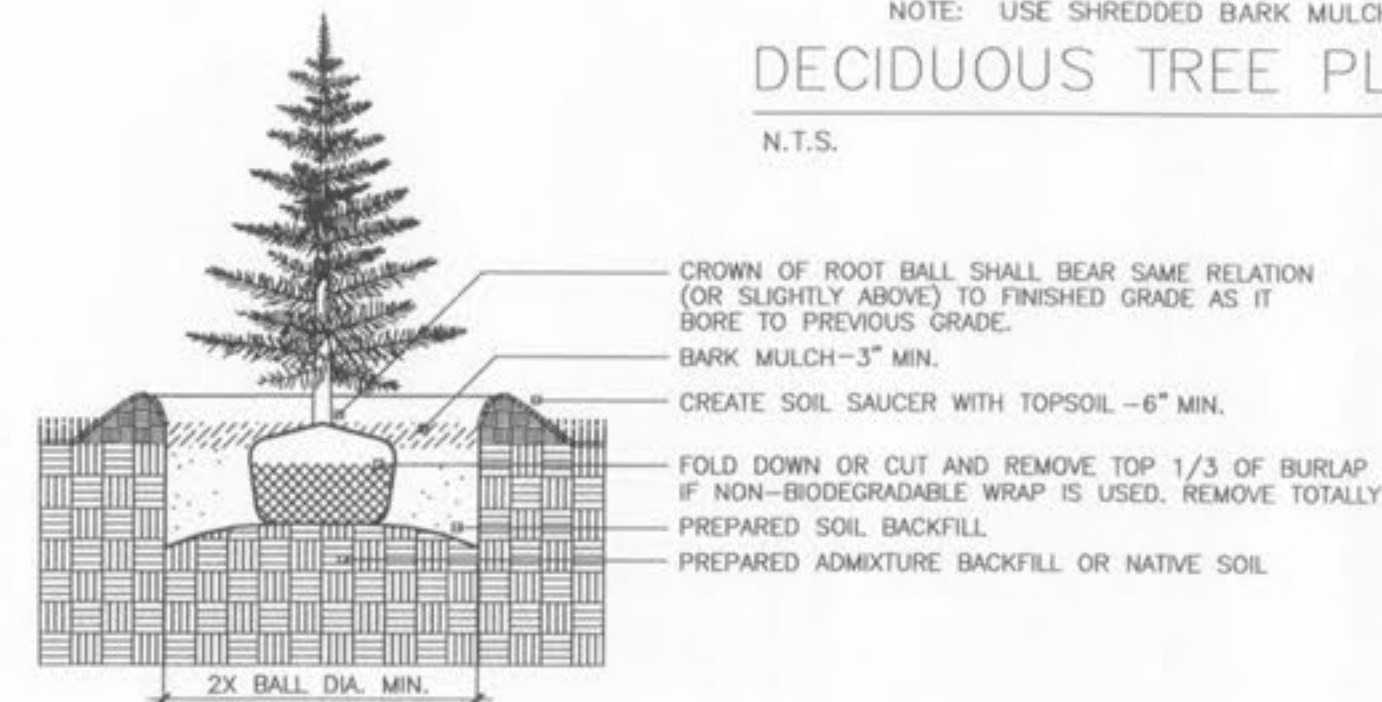

EVERGREEN TREE PLANTING
N.T.S.

LANDSCAPE GUIDELINE SPECS:

GENERAL:

- All natural vegetation shall be maintained where it does not interfere with construction or the permanent plan of operation. Every effort possible shall be made to protect existing structures or vegetation from damage due to equipment usage. Contractor shall at all times protect all materials and work against injury to public. The landscape contractor shall be responsible for any coordination with other site related work being performed by other contractors. Refer to architectural drawings for further coordination of work to be done.
- Underground facilities, structures and utilities must be considered approximately only. There may be others not presently known or shown. It shall be the landscape contractor's responsibility to determine or verify the existence of and exact location of the above (call 1-800-DIG-8115).
- Plant material are to be planted in the same relationship to grade as was grown in nursery conditions. All planting beds shall be cultivated to 6" depth minimum and graded smooth immediately before planting of plants. Plant groundcover to within 12" of trunk of trees or shrubs planted within the area.
- It shall be the landscape contractor's responsibility to:
 - Verify all existing and proposed features shown on the drawings prior to commencement of work.
 - Report all discrepancies found with regard to existing conditions or proposed design to the landscape architect immediately for a decision.
 - Specify the locations of all proposed plant material and obtain the approval of the owner's representative or landscape architect prior to installation.
- Items shown on this drawing take precedence over the material list. It shall be the landscape contractor's responsibility to verify all quantities and conditions prior to implementation of this plan. No substitutions of types or size of plant materials will be accepted without written approval from the landscape architect. Provide single-stem trees unless otherwise noted in plant schedule.
- All plant material shall comply with the recommendations and requirements of ANSI Z601 'American Standards for Nursery Stock'.
- It shall be the contractor's responsibility to provide for inspection of the plant material by the Landscape Architect prior to acceptance. Plants not conforming exactly to the plant list will not be accepted and shall be replaced at the landscape contractor's expense.
- All bids are to have unit prices listed. The Owner has the option to delete any portion of the contract prior to signing the contract or beginning work. This will be a unit price contract.
- All plant material to be transplanted according to guidelines set by AAN standards. Transplanted material will not be guaranteed by the landscape contractor.

INSURANCE:

- The landscape contractor shall submit certificates of insurance for workman's compensation and general liability.

MULCH:

- All mulch to be shredded oak bark mulch at 3" depth (after compaction) unless otherwise noted. Mulch shall be clean and free of all foreign materials, including weeds, mold, deleterious materials, etc.
- No plastic sheeting or filler fabric shall be placed beneath shredded bark mulch beds. Hyrax fabric shall be used beneath all gravel mulch beds.
- Edge all beds with spade-cut edge unless otherwise noted.

PLANT SCHEDULE

TREES	QTY	BOTANICAL/COMMON	SIZE
RSM	3	Acer rubrum 'Franksred' / 'Red Sunset' Maple	2.5"Cal
HACK	1	Celtis occidentalis / Common Hackberry	2.5"Cal
SA	5	Fraxinus pennsylvanica 'Summit' / Summit Ash	2.5"Cal
SAW	3	Quercus acutissima / Santooth Oak	2.5"Cal

FLOWERING TREES	QTY	BOTANICAL/COMMON	SIZE
FFR	1	Garcia canadensis Forest Pansy TM / Forest Pansy Redbud	2"Cal
SMAG	2	Magnolia X soulangiana / Saucer Magnolia	6'-7'
AYC	2	Prunus yedoensis 'Afterglow' / Afterglow Yoshino Cherry	2"Cal
JTL	1	Syringa reticulata 'Ivory Silk' / Ivory Silk Japanese Tree Lilac	1.5"Cal

SHRUBS	QTY	BOTANICAL/COMMON	SIZE
CPB	17	Berberis thunbergii 'Crimson Pygmy' / Crimson Pygmy Barberry	5 gal
GVB	5	Buxus 'Green Velvet' / Green Velvet Boxwood	5 gal
CLE	7	Clethra alnifolia 'Hummingbird' / Hummingbird Summersweet	5 gal
RCOT	6	Cotoneaster horizontalis / Rock Cotoneaster	5 gal
TARD	6	Hydrangea paniculata 'Tardiva' / Tardiva Hydrangea	5 gal
CH	6	Ilex meserveae 'China Boy/Girl' TM / China Boy/Girl Holly	5 gal
SSJ	12	Juniperus chinensis 'Sea Green' / Sea Green Juniper	5 gal
FJ	3	Juniperus procumbens 'Nana' / Procumbens Juniper	5 gal
BAY	5	Myrica pennsylvanica / Northern Bayberry	24"-30"
NINE	3	Physocarpus opulifolius 'Diabolo' TM / Diabolo Purple Ninebark	5 gal
PSC	3	Prunus X cistena / Purple Sand Cherry	24"-30"
AWS	6	Spiraea bumalda 'Anthony Waterer' / Anthony Waterer Spirea	5 gal
DY	3	Taxus media 'Densiformis' / Dense Yew	18"-24"

ANNUALS/PERENNIALS	QTY	BOTANICAL/COMMON	SIZE
AST	7	Aster novae-angliae 'Purple Dome' / Purple Dome Aster	1 gal
ASTIL	8	Astilbe arendellii 'Deutschland' / Astilbe	1 gal
HRD	55	Hemerocallis hybrid 'Happy Returns' / Happy Returns Daylily	1 gal
RSD	21	Hemerocallis hybrid 'Red Stella' / Red Stella Daylily	1 gal
AMH	8	Hosta fortunei 'Albo Marginata' / Albo Marginata Hosta	1 gal
VI	4	Iris pallida 'Variegata' / Variegated Iris	1 gal
BES	17	Rudbeckia fulgida 'Goldsturm' / Goldsturm Black-eyed Susan	1 gal
MN-SAL	4	Salvia nemorosa 'May Night' / May Night Salvia	1 gal
AJS	25	Sedum 'Autumn Joy' / Autumn Joy Sedum	1 gal

GRASSES	QTY	BOTANICAL/COMMON	SIZE
MG	1	Miscanthus sinensis 'Gracillimus' / Maiden Grass	5 gal
MLMG	1	Miscanthus sinensis 'Morning Light' / Morning Light Maiden Grass	5 gal
DFG	6	Pennisetum alopecuroides 'Hameln' / Dwarf Fountain Grass	5 gal

ROSES	QTY	BOTANICAL/COMMON	SIZE
KR	2	Rosa 'Knockout' / Knockout Rose	5 gal