

**NOTES:**  
 1. ON A CORNER LOT, NOTHING SHALL BE ERRECTED, PLACED, PLANTED OR ALLOWED TO GROW IN SUCH A MANNER AS TO MATERIALLY IMPEDE VISION BETWEEN A HEIGHT OF THREE (3) AND FIFTEEN (15) FEET ABOVE THE GRADES WITHIN THE SIGHT TRIANGLE AREA AS SHOWN ON THESE PLANS. ADDITIONALLY, NOTHING SHALL BE ERRECTED, PLACED, PLANTED OR ALLOWED TO GROW IN A MANNER TO MATERIALLY IMPEDE THE LINE OF SIGHT NECESSARY FOR SAFE TRAVEL ALONG PUBLIC ROADWAYS.  
 2. \* - DENOTES POSSIBLE EXTENDED FOUNDATION REQUIRED FOR HOUSE DUE TO SEWER ZONE OF INFLUENCE.

ISSUE	DATE / REMARKS
1	6-10-2016 Initial Submittal
2	9-1-2016 PWSO #2 & DCSD Comments
3	10-24-16 City Comments
4	11-15-16 DCSD Comments
5	12-12-16 City Comments
6	12-28-16 DCSD Comments
7	1-18-17 PWSO #2 Comments
8	1-26-17 Fire District Comments
9	1-27-17 City Comments
10	3-1-17 City Comments
11	4-10-16 Removed Eyebrow

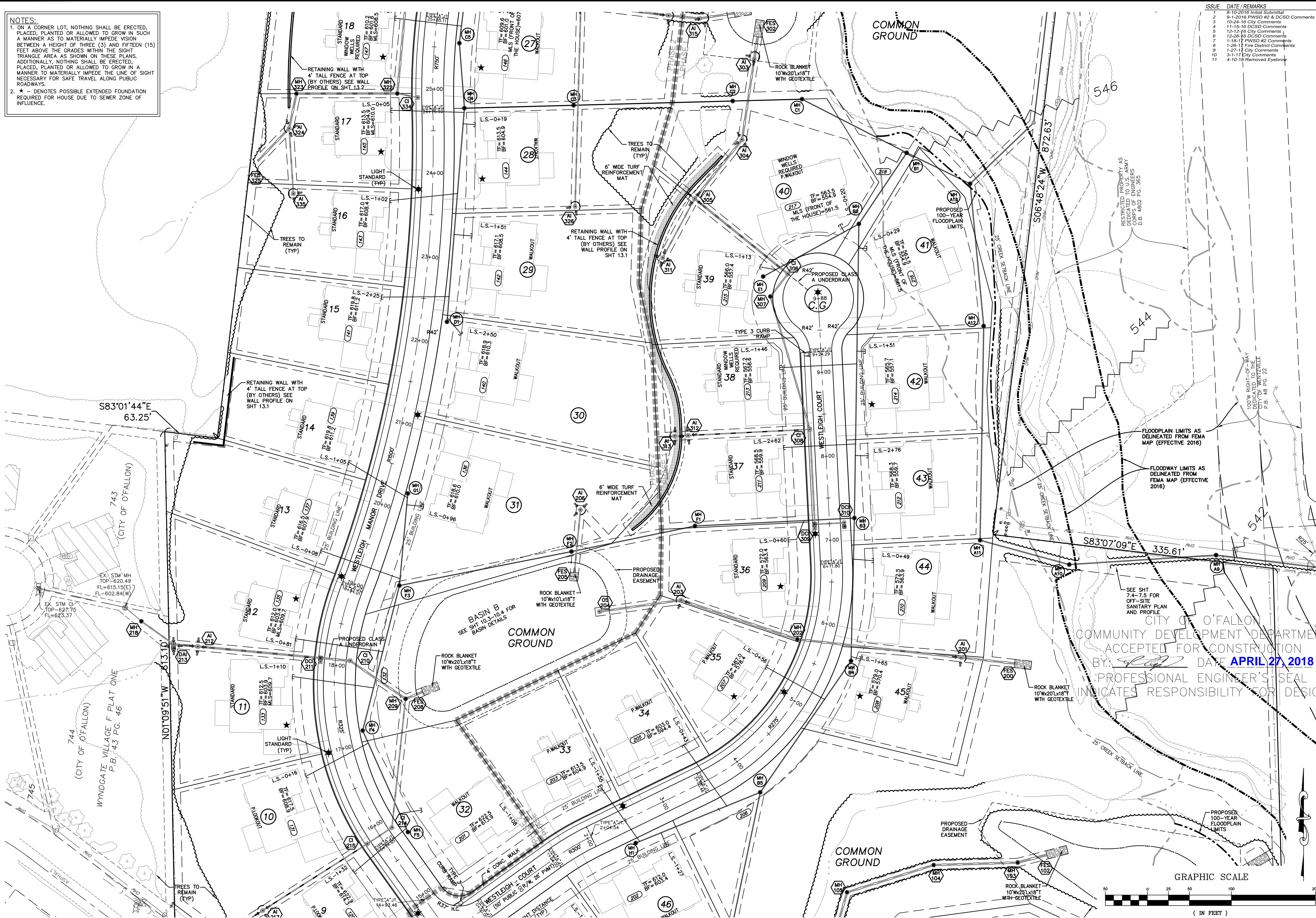

PROJECT TITLE

**WESTLEIGH**

**THE STERLING CO.**  
 ENGINEERS & SURVEYORS  
 5065 New Baumgartner Road  
 St. Louis, Missouri 63129  
 Ph 314-487-0440 Fax 314-487-8944  
 www.sterling-eng-sur.com  
 Corporate Certificate of Authority #001348

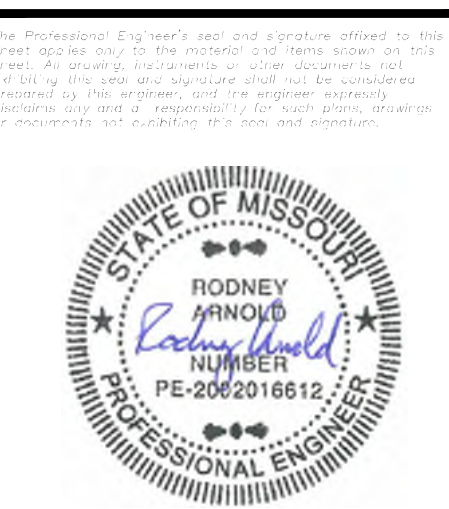

Date: 4/25/2018  
 RODNEY ARNOLD  
 LICENSE # PE-2002016612  
 Civil Engineer

Lombardo Homes of St. Louis, LLC  
 2299 Technology Drive, Suite 150  
 O'Fallon, Missouri 63368  
 Ph. (636) 265-2710  
 Fax (636) 695-3195  
 www.lombardohomesstlouis.com

SITE PLAN

CITY OF O'FALLON  
 COMMUNITY DEVELOPMENT DEPARTMENT  
 ACCEPTED FOR CONSTRUCTION  
 BY: [Signature] DATE: **APRIL 27, 2018**  
 PROFESSIONAL ENGINEER'S SEAL  
 INDICATES RESPONSIBILITY FOR DESIGN

P-Z No. P&Z NO  
 City No. 15-162-SP  
 Date: 4/25/2018  
 Job No. 14-10-348

Page No.  
**4.2**