

Drawing name: V:\1410248\Missouri\TracDrawings\Engineering\Improvements\0248 IMP-Sanitary.dwg Printed on: Apr 25, 2018 - 12:10pm Plotted by: emakob

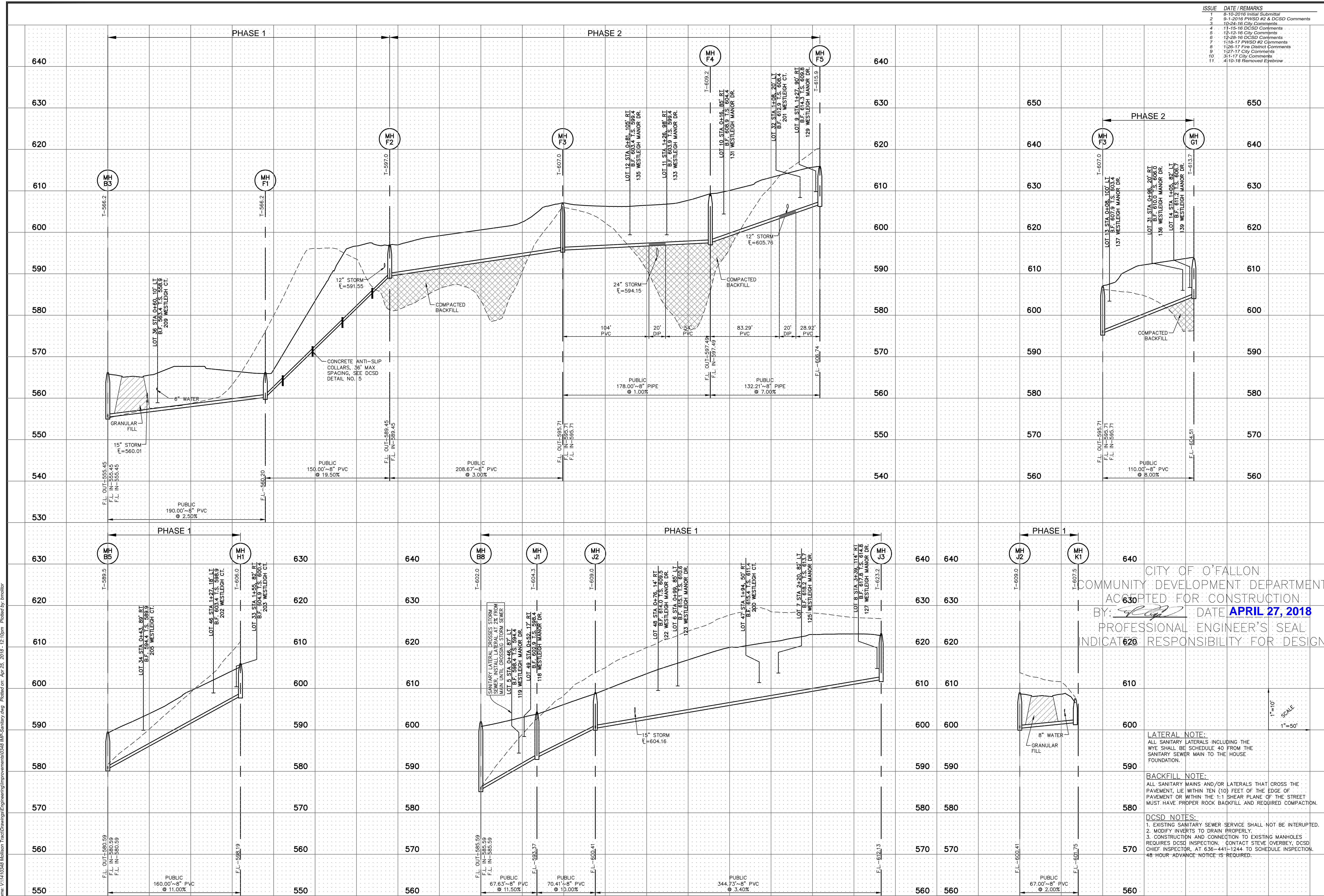

ISSUE	DATE / REMARKS
1	6-10-2016 Initial Submittal
2	9-1-2016 PWSO #2 & DCSD Comments
3	10-24-16 City Comments
4	11-15-16 DCSD Comments
5	12-15-16 City Comments
6	12-28-16 DCSD Comments
7	11-18-17 PWSO #2 Comments
8	1-26-17 Fire District Comments
9	1-27-17 City Comments
10	3-1-17 City Comments
11	4-10-18 Removed Eyeball

CITY OF O'FALLON
 COMMUNITY DEVELOPMENT DEPARTMENT
 ACCEPTED FOR CONSTRUCTION
 BY: *[Signature]* DATE: **APRIL 27, 2018**
 PROFESSIONAL ENGINEER'S SEAL
 INDICATING RESPONSIBILITY FOR DESIGN

LATERAL NOTE:
 ALL SANITARY LATERALS INCLUDING THE
 NYC SHALL BE SCHEDULE 40 FROM THE
 SANITARY SEWER MAIN TO THE HOUSE
 FOUNDATION.

BACKFILL NOTE:
 ALL SANITARY MAINS AND/OR LATERALS THAT CROSS THE
 PAVEMENT, LIE WITHIN TEN (10) FEET OF THE EDGE OF
 PAVEMENT OR WITHIN THE 1:1 SHEAR PLANE OF THE STREET
 MUST HAVE PROPER ROCK BACKFILL AND REQUIRED COMPACTION.

DCSD NOTES:
 1. EXISTING SANITARY SEWER SERVICE SHALL NOT BE INTERRUPTED.
 2. MODIFY INVERTS TO DRAIN PROPERLY.
 3. CONSTRUCTION AND CONNECTION TO EXISTING MANHOLES
 REQUIRES DCSD INSPECTION. CONTACT STEVE OVERBEY, DCSD
 CHIEF INSPECTOR, AT 636-441-1244 TO SCHEDULE INSPECTION.
 48 HOUR ADVANCE NOTICE IS REQUIRED.

PROJECT TITLE
WESTLEIGH

THE STERLING CO.
 ENGINEERS & SURVEYORS
 5065 New Baumgartner Road
 St. Louis, Missouri 63129
 Ph 314-487-0440 Fax 314-487-8944
 www.sterling-eng-survey.com
 Corporate Certificate of Authority #001348

STATE OF MISSOURI
 RODNEY ARNOLD
 LICENSE # PE-2002016612
 Civil Engineer

Date: 4/25/2018
 RODNEY ARNOLD
 LICENSE # PE-2002016612
 Civil Engineer

Lombardo Homes of St. Louis, LLC
 2299 Technology Drive, Suite 150
 O'Fallon, Missouri 63368
 Ph (636) 265-2710
 Fax (636) 695-3195
 www.lombardohomesstlouis.com

SANITARY PROFILES

P+Z No. P&Z NO
City No. 15-162-SP
Date: 4/25/2018
Job No. 14-10-348

Page No.
7.3

IMP