

Drawing name: K:\D\0302021 LOEFFLER TRACT\Improvement\2012\imp.dwg Plotted on: Jun 18, 2004 - 2:14pm Plotted by: cschoefer

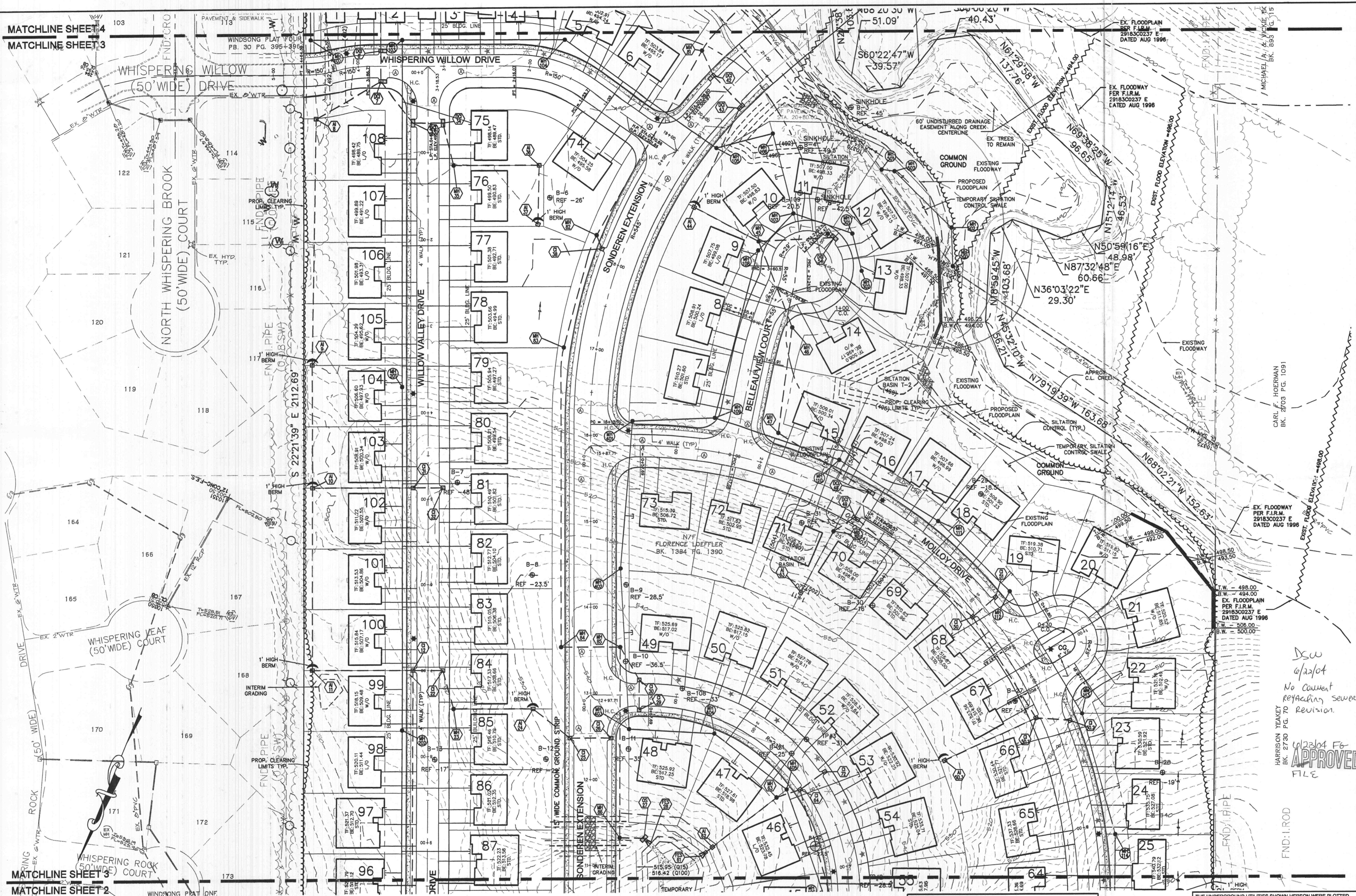

MATCHLINE SHEET 4  
MATCHLINE SHEET 3

MATCHLINE SHEET 3  
MATCHLINE SHEET 2

GRAPHIC SCALE

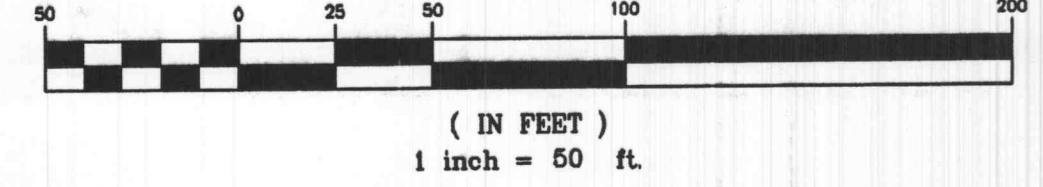

TF: DENOTES TOP OF FOUNDATION ELEVATION  
 BE: DENOTES BASEMENT FLOOR ELEVATION.  
 W/O DENOTES WALK OUT LOT  
 L/O DENOTES LOOK OUT LOT  
 STD DENOTES STANDARD LOT  
 \* DENOTES SPECIAL DRIVEWAY JOINT FILLER INSTALLATION PER ST. CHARLES COUNTY HIGHWAY DEPT. DETAIL C502.05  
 \* DENOTES LOTS WHERE STREETS ARE SUSCEPTIBLE TO MOVEMENT  
 ◎ TYPE A EXPANSION JOINT LOCATION

THE UNDERGROUND UTILITIES SHOWN HEREON WERE PLOTTED FROM AVAILABLE INFORMATION AND DO NOT NECESSARILY REFLECT THE ACTUAL EXISTENCE, NONEXISTENCE, SIZE, TYPE, NUMBER OR LOCATION OF THESE OR OTHER UTILITIES. THE GENERAL CONTRACTOR SHALL BE RESPONSIBLE FOR VERIFYING THE ACTUAL LOCATION OF ALL UNDERGROUND UTILITIES, SHOWN OR NOT SHOWN, AND SAID UTILITIES SHALL BE LOCATED IN THE FIELD PRIOR TO ANY GRADING, EXCAVATION OR CONSTRUCTION OF IMPROVEMENTS. THESE PROVISIONS SHALL IN NO WAY ABSOLVE ANY PARTY FROM COMPLYING WITH THE UNDERGROUND FACILITY SAFETY AND DAMAGE PREVENTION ACT, CHAPTER 319, RSMo

BASE MAP

ISSUE	REMARKS/DATE
1	09/15/03 - Final
2	12/17/03 - Submitted
3	01/12/04 - Final Submittal

PREPARED FOR:  
**WHISPERING L.L.C.**  
 5091 NEW BAUMGARTNER ROAD  
 ST. LOUIS, MISSOURI 63129  
 (314) 487-6717

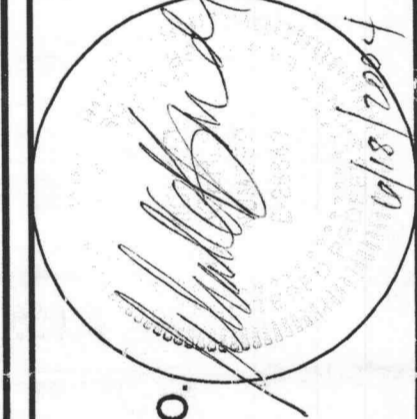

THE **STERLING** CO.  
 ENGINEERS & SURVEYORS  
 5095 NEW BAUMGARTNER ROAD  
 ST. LOUIS, MISSOURI 63129  
 (314) 487-0440 FAX 487-8944  
 E-Mail: Sterling@sterling-eng-survey.com

DRAWN: [Signature]  
 DESIGNED: [Signature]  
 CHECKED: [Signature]

PROJECT: **WHISPERING WOODS**  
 SHEET TITLE: **SANITARY SEWER REVISION**

NO.	03	02	021
M.S.D.			
PH#			
DIGITAL FILE LOCATION			
SERVER:STERLING2			
02111P.dwg			
SHEET			
	1		
OF			2

HARRISON YEAKY  
 BK. 2730 PG. 70  
 6/23/04 Fg  
**APPROVED**  
 FILE