

# THE WILCOXEN BUILDING

## SITE PLAN

A TRACT OF LAND BEING PART OF SECTION 4  
TOWNSHIP 46 NORTH, RANGE 3 EAST  
ST. CHARLES COUNTY, MISSOURI

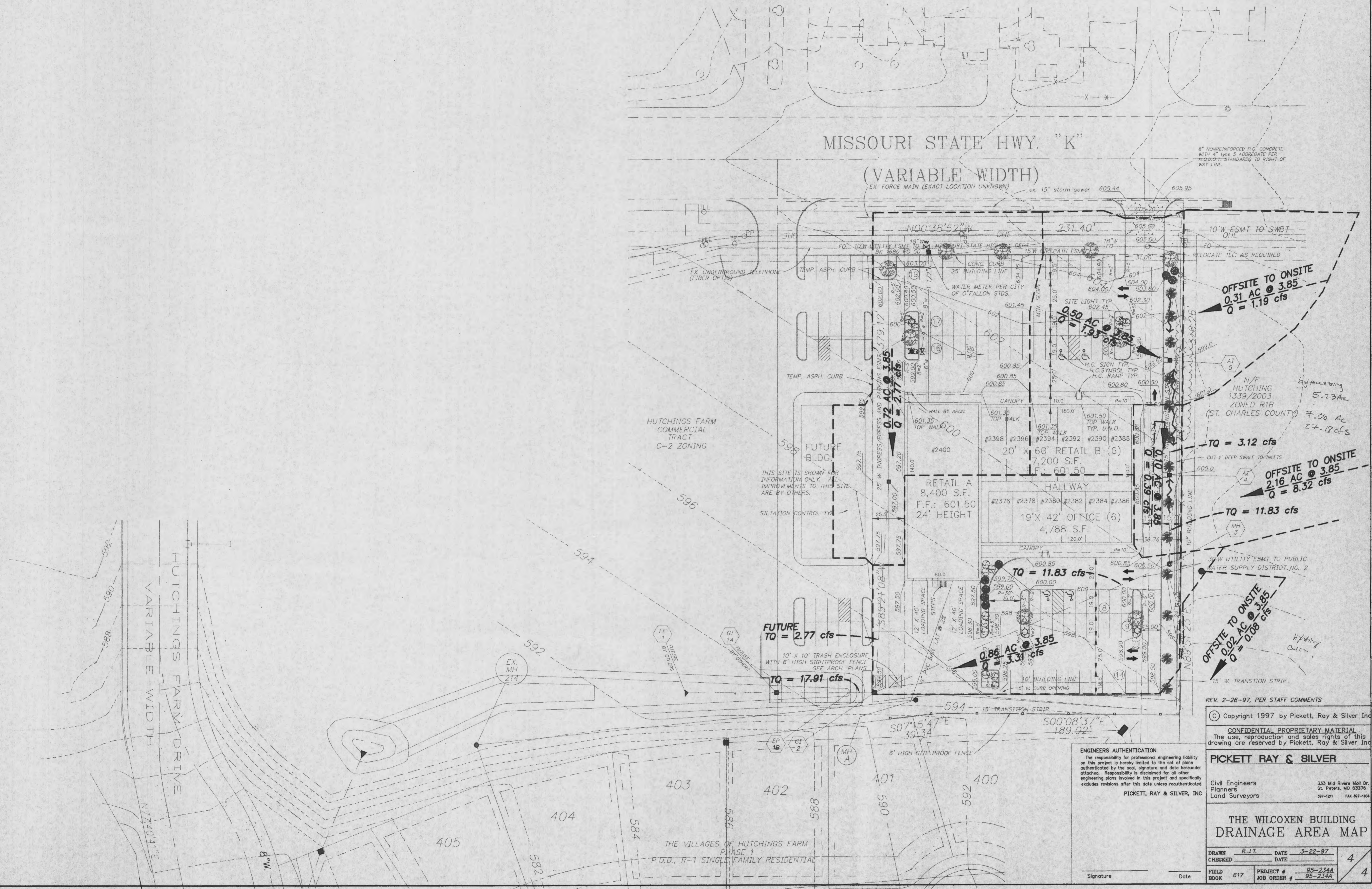
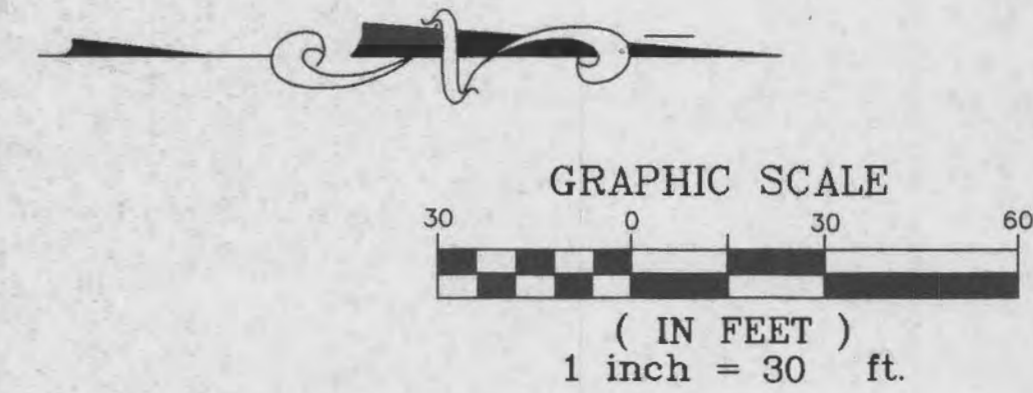

OFFSITE TO ONSITE  
0.31 AC @ 3.85  
Q = 1.19 cfs

OFFSITE TO ONSITE  
2.16 AC @ 3.85  
Q = 8.32 cfs

OFFSITE TO ONSITE  
0.02 AC @ 3.85  
Q = 0.08 cfs

FUTURE  
TQ = 2.77 cfs

TQ = 17.91 cfs

TQ = 11.83 cfs

TQ = 11.83 cfs

REV. 2-26-97, PER STAFF COMMENTS

© Copyright 1997 by Pickett, Ray & Silver Inc

CONFIDENTIAL PROPRIETARY MATERIAL  
The use, reproduction and sales rights of this drawing are reserved by Pickett, Ray & Silver Inc

PICKETT RAY & SILVER

Civil Engineers  
Planners  
Land Surveyors

333 Mid Rivers Mall Dr.  
St. Peters, MO 63376  
397-1211 FAX 397-1104

THE WILCOXEN BUILDING  
DRAINAGE AREA MAP

DRAWN	R.J.T.	DATE	3-22-97
CHECKED		DATE	
FIELD BOOK	617	PROJECT #	95-234A
		JOB ORDER #	95-234A

ENGINEERS AUTHENTICATION  
The responsibility for professional engineering liability on this project is hereby limited to the set of plans authorized by the seal, signature and date hereunder attached. Responsibility is disclaimed for all other engineering plans involved in this project and specifically excludes revisions after this date unless reauthorized.

PICKETT, RAY & SILVER, INC

Signature \_\_\_\_\_ Date \_\_\_\_\_